

BELLEFONTAINE CEMETERY

LOGAN CO. LAKE TWP.

OFFICIAL PROJECT NOS. 465-42-3-467 & 665-42-3-232

ACRES 30

PAGES 9

LEGEND

HISTORY

- ① REVOLUTIONARY WAR
- ⑩ WAR OF 1812
- ⑯ WAR WITH MEXICO
- ⑲ CIVIL WAR
- ⑳ SPANISH-AMERICAN WAR
- ⑳ WORLD WAR

46-5-1



SCALE 1"=80'

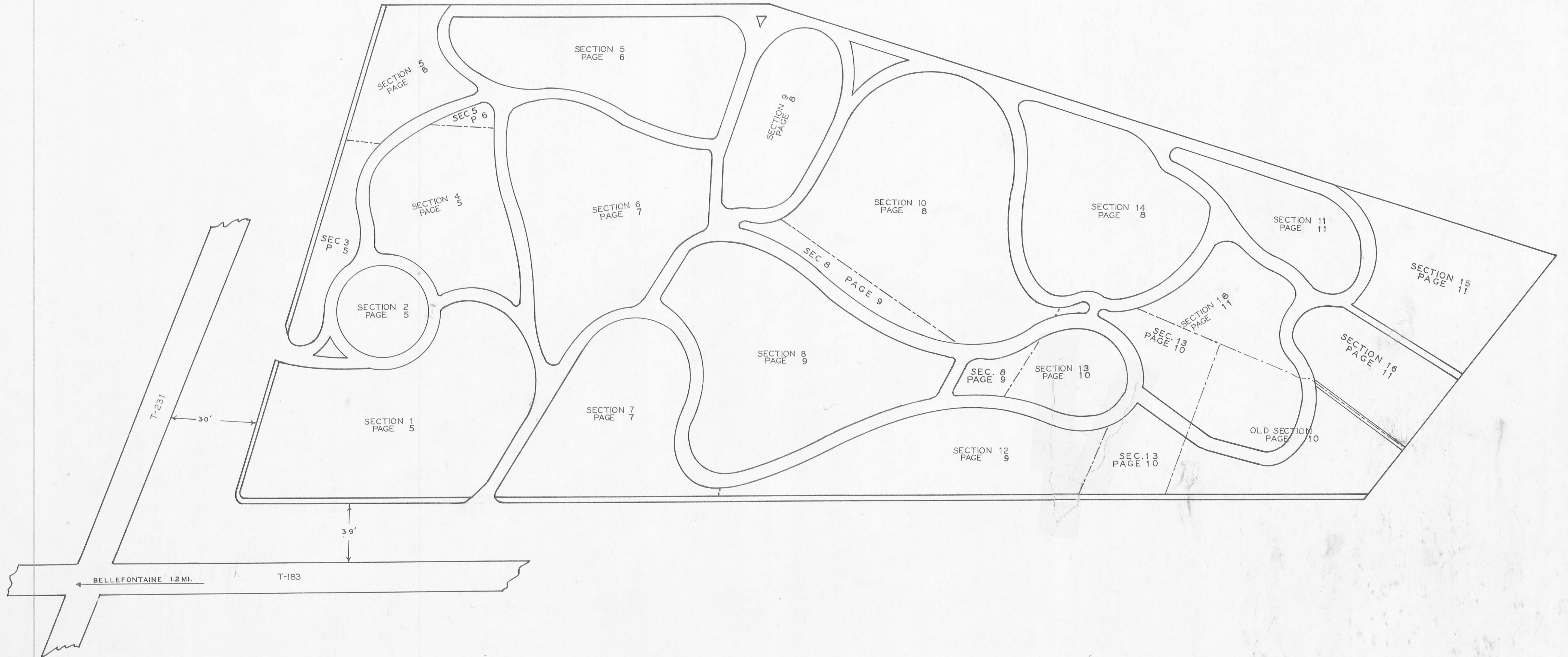

NOTE:-
LOT NUMBERS ARE ORIGINAL.
SECTION NUMBERS ARE ARBITRARY.

NAME	SEC	L	G	W	NAME	SEC	L	G	W	NAME	SEC	L	G	W
ACKLES JAMES	1	475	5	19	EASTON JAMES	4	1047	8	19	HOFFMAN JOHN	1	510	15	19
AILES EDWARD B.	3	660	18	31	ELDER JUSTIN	4	501	4		HOLMES JAMES	1	446	17	19
ARNOLD GEORGE W.	1	410	19		EVANS J. W.	1	508	21	19	HUFFMAN JOHN	4	501	11	19
ASHMEAD S. W.	1	446	16	19	EVANS W. R.	1	508	7	19	IVINS ISAAC	2	542	2	19
BASS ARMOR	4	1068	8	19	FICHTHORN JOHN A.	1	475	11	19	JOHNSON GEORGE P.	2	566	13	19
BATCH F. O.	575	3	19		FOULK JACOB H.	1	767	7	19	KERR ROBERT S.	1	475	8	19
BENNETT JOSHUA	575	6	19		FOX FRANK	1	763	8	19	KISER ISIAH	4	1068	16	19
BENNETT CHARLES E.	597	9	25		GARDNER I. R.	4	501	9	19	KOOGLE MILTON	1	535	1	19
BENNETT JOHN Q. A.	597	11	19		GLASBY LEWIS	4	1067	5	19	LADD JOHN W.	4	1068	17	19
BENNETT LUCIUS C.	597	2	25		GOOD JOHN W.	4	1068	11	19	LLOYD WILLIAM H.	1	507	14	19
BENNETT LUCIUS C.	597	19			HANOLD JAMES	4	483	6	19	LONGBRAKE JOSEPH	4	1046		19
BERNDT AUGUST	442	20	19		HARRIS RICHARD	4	1068	19	19	LOWE JOSEPH	4	1068	14	19
BOSWELL WILLIAM	4	512	5	19	HERRON ROBERT	1	535	8	19					
BOTKIN THEODOSIUS	1	780	8	19	HILL GEORGE	1	538	10	19					
BUTLER ISAAC B.	3	654	7	19										

NAME	SEC	L	G	W	NAME	SEC	L	G	W
MALONE JAMES	4	1068	20		PAUGH RICHARD	4	501	12	19
MARQUIS WILLIAM	1	447	21	10	PHENEGAR JACOB	4	1068	10	19
MCCOLLOCH S. A.	1	448	8	19	POLLOCK JOHN	4	472	22	10
MCLAUGHLIN CHARLES	1	411	1	19	POWERS ESIE	4	471	16	19
MILLER HENRY JR.	1	471	17	16					
MOORE HENRY C.	2	566	9	19	RANKIN DAVID F.	2	566	16	19
MORE HAMILTON	4	501	1	19	REED OTTIS	4	1093	16	19
MORE ISAAC	4	1067	6		REED WALTER F.	4	1093	17	31
MYERS W. A.	4	1068	24	19	RICKETS WILLIAM A.	1	757	2	19
					RIDDLE JOHN M.	1	444	14	19
					RIDDLE WILLIAM B.	1	444	10	19
					RILEY FLOYD W.	4	1093	16	31
					RITCHEY DAVID F.	4	1068	18	19
					RITCHEY MARION	4	1067	9	19
					ROBINSON JAMES	4	1126	4	10
					ROBINSON WILLIAM	4	1126	7	16
					ROBERTS HIRAM	4	501	10	19
					RUTLEDGE HENRY M.	1	755	7	19
					RUTTER H. C.	1	448	16	19

CAMPBELL JOHN G.	2	603	14	19
CAMPBELL J. Q. A.	2	629	10	19
CAMPBELL QUINCY A.	2	605	2	31
CARSON WILLIAM J.	1	440	7	19
CARTER SAMUEL	1	478	10	10
CARVER ZEMAS	4	501	7	
CHAMBERLAIN ED. R.	1	412	6	19
CONKLIN EDWARD B.	2	596		19
CONRY THOMAS	4	501	8	19
COOKE ROBERT W.	1	473	13	31
COOLEY I. B.	1	477	12	
COOPER JAMES	1	412	4	16
COPE GEO. W.	4	501	6	19
COSTIN JOHN J. P.	1	507		19
COWOOD SAM E.	4	512	7	
CRETCHER W. H.	1	448	14	19
CULVER EARL B.	1	756	4	31
DEVER BENJAMIN	1	442	17	10
DILL JOHN W.	4	1072	10	31
Emerson Harold Brown	2	599	5	



SUPPLEMENTARY LIST

CAMPBELL CHARLES D.	2	605	12	25
CAMPBELL WILFRED B.	2	629	12	25
CLASSON THOMAS S.	2	567	4	19
LEONARD NATHANIEL	1	477	21	
LOWERY JAMES K.	3	677	14	
WESSER CLAUDE J.	3	683	7	
Fite Virgil P.	4	1096	7	
Darringer Robert B.	3	1120	1	

LEGEND
 SEC= SECTION L=LOT R=ROW
 G=GRAVE W=WAR
 * = POSITION UNKNOWN

NAME	SEC	L	G	W
ALLEN CHARLES E.	5	421	19	
ANGEL JAMES	5	460	19	
ANGEL WILLIAM	5	460	19	
BASS LEVI	5	524	1	19
BELL CHARLES W.	5	1519	6	19
BOYD JOHN T.	5	456	19	
BOWMAN JOHN W.	5	397	19	
BREASTON ROBERT J.	5	493	10	19
CARSON FINLEY K.	5	398	19	
CLEMEN JOHN H. F.	5	647	19	
CRANE BARTLEY	5	1483	9	19
DAY JOHN	5	619	4	19
DICKEY JAMES A.	5	398	2	19
EBRITE JAMES M.	5	1505	8	19
EMERSON J. D.	5	421	11	19
ELLIOTT ALEXANDER	5	367	11	19
FOLSOM CHAS. J.	5	1523	10	19
GOFF BEN B.	5	1454	10	19
GRAYSON GEORGE	5	586	9	31
HAMPTON RANDOLPH	5	645	6	19
HEFFNER JOSEPH F.	5	1506	19	
HILL THAD E.	5	1471	6	31
KERSEY ROBERT E.	5	617	4	19
KIRKPATRICK JAMES	5	335	19	
MASON LEVI	5	618	19	
MORRIS JOHN W.	5	615	19	
NEWSOME ROBERT	5	666	4	19

NAME	SEC	L	G	W
RICHEY ANDREW R.	5	491	14	19
ROBERTS LEWIS	5	522	6	19
ROYER GEORGE W.	5	457	5	19
SMITH GEORGE W.	5	1485	12	25
SPELLMAN WILLIAM H.	5	490	12	19
STEWART JAMES	5	644	7	19
STEWART S. H.	5	618	21	
WEAVER PATRICK	5	648	6	19
WHEELER E. J.	5	424	7	19
WILLIAMS EDWARD	5	615	8	25
WONDERS MAX E.	5	1505	6	31

SUPPLEMENTARY

LONG FRANK	5	1076	8	
MILLER JOHN M.	5	1440	3	
Huskins Arthur	5	1447	2	
Harmon Roy	5	343	1	
Smith Kenneth I.	5	1533	1	



LEGEND
 SEC-SECTION L-LOT
 R-ROW G-GRAVE W-WAR

NAME	SEC	L	R	G	W
ADAMS DAVID	6	403		1	25
ADAMS JEREMIAH	6	403		4	19
ALLMON SAMUEL E.	6	416		8	19
ALLMON FRANK J.	6	416		17	25
ARION LEWIS	7	381			19
BEATTY C. B.	6	405		2	19
BEATTY J. J.	6	405		8	19
BOWERSOCK DAVID	7	352		5	19
BUCKWALTER JOHN N.	7	289		17	19
CAMPBELL JAMES S.	7	388			19
CAMPBELL JOHN G.	7	388		13	19
CASE FRANK S.	6	1019		3	19
COLE JOSEPH	6	455			19
COLTON ROBERT	7	290			19
COOK CHARLES J.	7	386			19
COULTER JOHN A.	6	1020		5	19
COVINGTON PERRY P.	6	1028		7	19
CROCKETT ROBERT	7	324		18	19
CROUSE GEORGE W.	7	354			19
ELLIS HAROLD GLEE	6	1035		1	31
ENGLISH ALFRED E.	6	372		7	19
FARIS HARVEY R.	6	394		7	19
FARIS WM. D.	6	394		21	19
FLICKINGER EDWARD	6	359		4	19
GREEN SHEPHERD	6	416		10	19
GRIFFIN ALFRED E.	6	1011		13	19
HAMILTON JAMES G.	7	292		5	19
HARBAUGH GEORGE W.	7	311		5	19
HARBAUGH HENRY C.	7	311		5	19
HARNER GEO. S.	7	321		4	19
HARTLEY ARON O.	7	353			19
HORN GEO. A.	7	354		16	19
HORN JOHN A.	7	344		8	19
HOWBERT A. R.	7	311		19	19
HUBER DANIEL J.	7	379		14	19
HUTCHINS THOMAS L.	6	1021		7	19
JORDAN Wilbur Stuart	6	360			

NAME	SEC	L	G	W
IRWIN THOMAS	7	376	5	10
JACKSON IRWIN S.	7	284	4	19
JEFFERS CLYDE E.	6	1060	12	31
JOHNSTON A. M.	7	282	4	19
JOHNSTON ROBERT F.	7	282	11	19
JORDAN JAMES S.	6	360	2	19
KAUFFMAN SILAS R.	7	344	13	19
KELLY DAVID	7	344	14	19
KELLY RUBEN B.	7	378	9	19
KEMPER JOHN H.	7	379	19	19
KEMPER RAY	7	352	20	31
KERR JAMES	7	312	11	10
KIRKPATRICK JOHN	7	343	22	10
KIRKPATRICK SAMUEL	7	343		19
KLEINOEHL WILHELM	6	420	20	33
LANE CHARLES	7	386	8	19
LANE CORY L.	6	1031	12	25
LANE WM. H.	7	386	4	19
LOEBBOROW G. W.	6	1007	11	19
LORD RICHARD S. C.	7	354	8	33
MARQUIS THOMAS	7	322	11	1
MCCLUOP WILLIAM	7	354	1	10
MCCLURE WILLIAM P.	7	386	19	19
MSPHERSON A. H.	7	346	5	19
MSPHERSON WALTER D.	7	347	3	19
MILLER JOHN N.	6	1004		19
MONROE JOHN	7	346		19
MOORE L. G.	7	354	17	
NIVEN WILLIAM B.	6	418	17	19
PATTERSON JOHN B.	6	360	21	19
PRATER C. KNOWLTON	6	392	5	25

NAME	SEC	L	G	W
REID FRANZ G.	6	1036	7	31
RIFE JOHN R.	7	315	5	19
ROBERTS JOHN	7	387	22	19
SEAMAN GEO. N.	7	313	6	19
SEAMAN WM.	7	313	4	19
SHAW HENRY	6	1014	2	19
SHERMAN ALMAN	7	384	7	19
SMITH JAMES K.	7	356	21	19
SMITH MICHAEL	7	356	6	19
SMITH SAMUEL	6	392	2	19
STELZIG JOHN E.	6	1030	3	25
STOVER EDWARD	7	390	19	19
SWAN JOS. S.	7	354	9	19
SWEET JOHN O.	6	1023	14	19
TAYLOR THOMAS O.	7	345	9	19
THOMPSON JOHN F.	7	320	5	19
WILGUS JAMES A.	6	402	4	19
WILLIAM I. M.	6	402	13	19



SCALE 1"=20'

LEGEND
 SEC.-SECTION G-GRAVE
 L-LOT R-ROW W-WAR

N A M E	SEC	L	G	W
ABRAHAM RICHARD F.	14	1752	9	31
ADAMS ALFRED	10	166	21	19
ADAMS GEORGE	10	166		19
BUCHANAN CLINTON C.	9	302	6	19
CARR RAYMOND M.	14	1733	13	31
CRAWFORD JOSEPH	10	219		2
DENNEY MARION	10	1584	9	31
DETRICK VIRGIL R.	10	1634	12	31
DOWNES JESS W.	10	100	9	19
Gray William Henry	10	1438		

PARK

SEC. 14

SEC. 9

SECTION 10

N A M E	SEC	L	G	W
EMERY JACOB C.	10	141	6	19
GILL DAVID W.	10	191	9	
GOFF JOB S.	10	146	18	19
GREGG JOHN H.	9	332	16	19
GREEN BENJAMIN P.	10	216	4	19
GUTHRIE CYRIL A.	14	1770	6	31
HAMILTON CLAUDE M.	14	1761	9	31
HORN HENRY J.	9	330	2	19
IRWIN JAMES	10	192	8	10
IRWIN WILLIAM S.	10	192		19
JACKSON MONROE	10	216	6	19
KELLISON WILLIAM H.	10	1686	3	19
KENNEDY ROBERT P.	10	195	21	19
KERR HAROLD R.	10	1654	6	
LAWRENCE JOS. H.	10	122	5	19
LAWRENCE WM.	10	122	6	
MACLEARY J. H. P.	10	103	19	
MAKKEE HORACE G.	10	101	22	19
MILLER DAVID J.	10	142	14	19
MILLER GLENN D.	10	142	6	31
MILLER JACOB	10	142	1	10
MILLER WILLIAM H. H.	10	142		19
PATTERSON S. WYLIE	10	102		10
POTTS ELAM P.	10	243	21	
POWELL PERRY E.	14	1794	1	25
PRICE JOHN A.	10	185	1	19
REED REUBEN M.	9	302	2	19
ROACH WALLACE W.	10	120	22	19
ROYER C. WARREN	10	1655	8	31
SMITH GEORGE D.	10	1654	1	31
SNODDY ABNER	10	242	2	19
SOUTHARD W. S.	10	84	15	19
SPEECE REX S.	10	1685	8	31
STAIRWALT ANDREW JR.	10	218	8	19
STAIRWALT ANDREW SR.	10	218	11	19
SWAN GUY H.	10	169	19	31
UNDERWOOD BENJ. M.	10	216	4	19
WARREN JOHN P.	9	1549		19
WHITEHILL JAMES M.	10	122	19	19
WEST SAMUEL H.	10	122	20	25

SCALE 1"=20'

LEGEND
 SEC.-SECTION L-LOT
 G-GRAVE R-ROW W-WAR



NAME	SEC	L	G	W
ALLEN HOMER	8	138	19	
ANDERSON JOHN W.	8	294	6	19
ANDERSON MILTON	8	294	19	
ARNOLD DAVID	12	110	18	19
BAIRD ELI L.	12	91	17	19
BASSETT RUBIN C.	8	98	3	19
BEAL CALVIN	8	175	2	19
BERGSCHICKER FLOYD H.	8	327	21	31
BLESSING FRANK S.	8	98	19	19
BOWMAN C. C.	12	157	12	19
BOWMAN D. D.	12	157	13	19
BROWN JACOB K.	12	80	16	19
BUCKWALTER ELAM	8	278	7	19
BRYANT ALDEN U.	12	41	2	
BYERS JOHN WILSON	8	177	15	19
BYERS SAMUEL	8	177	7	19
CASEBOLT ROBERT	12	74	8	10
CHANDLER WILLIAM	12	77	19	
COST JOHN P.	8	174	19	
CRIDER JACOB	8	277	8	19

NAME	SEC	L	G	W
DAILEY SIMON W.	8	262	11	19
DOW PETER	12	133	5	19
EADS ISAAC N.	8	293	5	19
EARICK GEORGE W.	8	309	9	19
EDWARDS JOSEPH	8	251	7	19
FULTON JAMES S.	8	246	19	19
GALBREATH JOHN M.	8	207	5	19
GRAY JOHN A.	8	296	11	19
HAMER DANIEL	8	307	7	19
HOGG JOHN	8	159	26	19
HOVER GEO. M.	8	197	4	19
HUBBELL R. S.	12	55	11	19
IRWIN THOMAS	8	117	1	19
JACKSON JOHN	8	176	7	19
JACKSON NELSON H.	8	150	5	19
JACKSON WM. S.	8	176	21	
JONES PHILANDER	12	76	13	19

NAME	SEC	L	G	W
KEER JOHN K.	8	80	25	19
KEMPER DAVID	8	209	8	19
KENNEDY OLIVER	12	114	13	19
KERR WM.	8	80	14	10
KNOX JOHN	8	202	16	10
LAMB HARRIS JAMES	8	252	12	31
LAMB ROBERT	8	252	19	
LEISTER HENRY S.	8	147	9	19
LEISTER PETER	8	147	1	10
LEMON JAMES S.	8	203	21	19
MECLURE WM.	12	76	11	10
MECOY JAMES P.	12	88	5	10
MCCRACKEN GEO. C.	8	204	1	19
MCCRACKEN JOHN M.	8	204	7	19
MGINNIS J. FRANK	12	91	4	19
MELAIN WILLIAM	8	294	17	19
MELAUGHLIN JOHN	12	73	12	10
MELAUGHLIN WM. B.	12	58	2	19

NAME	SEC	L	G	W
MAKIN ABRAHAM	12	181	4	31
MEREDITH B. F. L.	8	209	13	19
MILLER JOHN B.	8	150	10	16
MILLER JOHN F.	8	185	19	
MILLNER D. R.	12	57	4	19
MOON WM. H.	8	259	15	19
MOORE JAMES K.	8	80	5	16
MOORE JOS. H.	8	80	3	19
MOORE WM.	8	80	6	10
MORROW JAMES M.	8	164	11	19
MYERS BENJ. F.	12	132	21	19
MYERS GEORGE F.	12	132	4	19
MYERS GEORGE W.	8	221	14	19
MYERS WILLIAM C.	12	155	5	19

NAME	SEC	L	G	W
ODOR ROBERT	12	57	3	19
PATTERSON JAMES G.	8	117	9	19
PATTERSON J. W.	8	175	11	19
PATTERSON WM. T.	8	202	11	19
PORTER CHARLES W.	8	176	13	19
POWELL JOHN	8	163	1	10
POWELL J. C.	12	132	26	19
POWELL WM.	12	110	6	19
PRATT JOHN W.	8	201	9	19
RANKIN JAMES	12	59	11	19
RANKIN SAMUEL	8	200	19	19
REED JOHN	12	136	7	19
REYNOLDS DAVID R.	8	149	10	19
RICHERSON JOHN T.	12	93	21	19
ROBINSON CLARENCE	12	55	3	31
ROBINSON JAMES	12	136	4	19
ROEBUCK WALTER S.	12	111	19	
ROOF DANIEL	8	308	5	19
ROOF HARRY	8	308	15	19

NAME	SEC	L	G	W
SCARFF W. D.	8	189	19	19
SHADE GUY E.	8	288	5	31
SHAW PRESLEY	8	249	6	19
SHORT JAMES D.	12	94	10	19
SHELLENBARGER J. S.	12	41	10	19
SHRIVER J. J.	8	277	17	19
SHUFFLETON JAMES W.	12	91	8	19
SKINNER RICHARD L.	8	138	20	19
SMITH JOSIAH D.	8	211	4	19
SMITH LAFAYETTE	8	184	19	19
STAFFORD ANDREW J.	12	131	2	19
STAFFORD JAMES K. P.	12	131	5	19
STAMATS PETER	12	109	14	19
STARR S. CAPT.	12	130	7	19
STARR WM. D.	12	130	19	19
STEVENSON DAVID M.	12	41	3	19
STEVENSON GILBERT M.	8	185	21	19
STEVENSON JOS. V.	12	113	4	19
STEVENSON LEMUEL	8	211	21	19
STOKES WM.	8	215	20	19
STRONG DANIEL G.	8	309	6	19
SWEET SIMEON	8	150	19	19

NAME	SEC	L	G	W
THOMPSON EDW. S.	12	91	9	31
VAN METER HENRY	8	224	16	19
WALKER WM.	8	106	9	10
WILKINS AMOS	12	71	7	19
WILKINS J. M.	12	71	4	19
WILKINS J. R.	12	71	6	19
WILKINS SYLVANUS	12	71	5	19
WILKINS S. M.	12	71	6	19
WILKINS THOMAS J.	12	71	3	19
ZIMMERMAN KARL E.	8	213	4	31

SUPPLEMENTARY LIST

FUSON HERBERT L.	12	181		31
CRATTY JAMES H.	8	309	22	19
CRATTY SAMUEL H.	8	309	11	
CLARK THOMAS	12	55	18	19
HERZBERG PHILLIP	8	138	6	
HUMPHREY JOSEPH A.	8	164	9	19
KAB GEORGE	8	86	12	19
KERR FRANK E.	8	80	23	
KROSKOP EDWARD M.	12	113	17	19
LAMB HARRIS JAMES	8	252	7	
LANE JEHAL SR.	8	210	16	19
BAILEY GEO. W.	8	274	9	19

Entered in the World 26 3-12-25

LEGEND
 SEC.-SECTION G-GRAVE
 L-LOT R-ROW W-WAR

SCALE 1"=20'

SECTION 8

SECTION 12

N A M E	SEC	L	R	G	W
AKEY WINFIELD S.	13	64			19
ARMSTRONG JOHN W.	13	47		18	19
BARNETT EPHRIAM	13	47		1	19
BOLEN G. WASHINGTON	13	40		6	19
CARTER WM. R.	13	61		8	19
CHAMBERLIN ALONZO	13	9			19
CULP JOSEPH	13	38			19
DENNY RICE W.	13	24		13	19
DOW DAVID L.	13	32		3	19
DOW ROBERT	13	32		11	19
DOW SIMPSON L.	13	22		5	19
ELLIOTT JOHN W.	13	8		14	19
ELLSWORTH WILLIAM OLD			11	5	19
FLEMING HENRY C.	13	30			19
FRY JOHN	13	45		20	19
FURGSON WILLIAM	13	64		13	19
GREGG WM.	13	27		10	19
GROSS AARON	13	69		7	19
HANKINSON WM. H.	13	27		6	
HIATT TOWNSEND E.	13	69		9	
HIPPLE JOHN	13	10		2	19
JACOBS ROBERT POPE	13	36		21	19
JOSLIN WM. Y.	13	53		16	19
KERR ANDREW	13	1		7	19
KERR JOHN	13	1		1	10
LEMON DAVID E.	13	69		3	19
LOWE EDMUND B.	13	9		11	19
LOWE HERMAN	13	9		9	25
MARSHALL WM. M.	13	34		16	19
MITCHELL MELVIN B.	13	37		15	25
REED LEANDER OLD				90	19
ROSE BENJAMIN	13	17		15	19
SCOTT DAVID L.	13	21		2	19
SKEEN DAVID J.	13	52		2	19
STILLWELL JOHN A.	13	45		18	19
STINSON JAMES	13	5		11	19
STOUGH WILLIAM N.	13	23		9	19
STROTHER W. H. H.	13	9		2	19
WHITMORE WILLIAM H.	13	25			19
WILLIAMS ENOCH P.	13	16		2	19
WILLIAMS HUGH	13	26		5	19
WILLIAMS WILLIAM R OLD				82	19
ZEARING ISAAC N.	13	67		10	19

SUPPLEMENTARY

LOWE JAMES M.	13	9		10	
MC CLAREN WILLIAM	13	5		22	
MC PHERSON JAMES	13	34		5	

SCALE 1"=20'

LEGEND
 SEC.-SECTION G-GRAVE
 L-LOT R-ROW W-WAR

SECTION 13

OLD SECTION

SECTION 11

SECTION 15

SECTION 16



 SCALE 1"=20'