

EAST LIBERTY CEMETERY

LOGAN CO. PERRY TWP.

OFFICIAL PROJECT NOS. 465-42-3-467 & 665-42-3-232

5 ACRES

4 PAGES

LEGEND

- ① REVOLUTIONARY WAR
- ⑩ WAR OF 1812
- ⑩ WAR WITH MEXICO
- ⑩ CIVIL WAR
- ⑩ SPANISH AMERICAN WAR
- ⑩ WORLD WAR

HISTORY

46-10-1

T-129

7-129

1.8 MI.

30'

T-10 EAST LIBERTY 7MI.

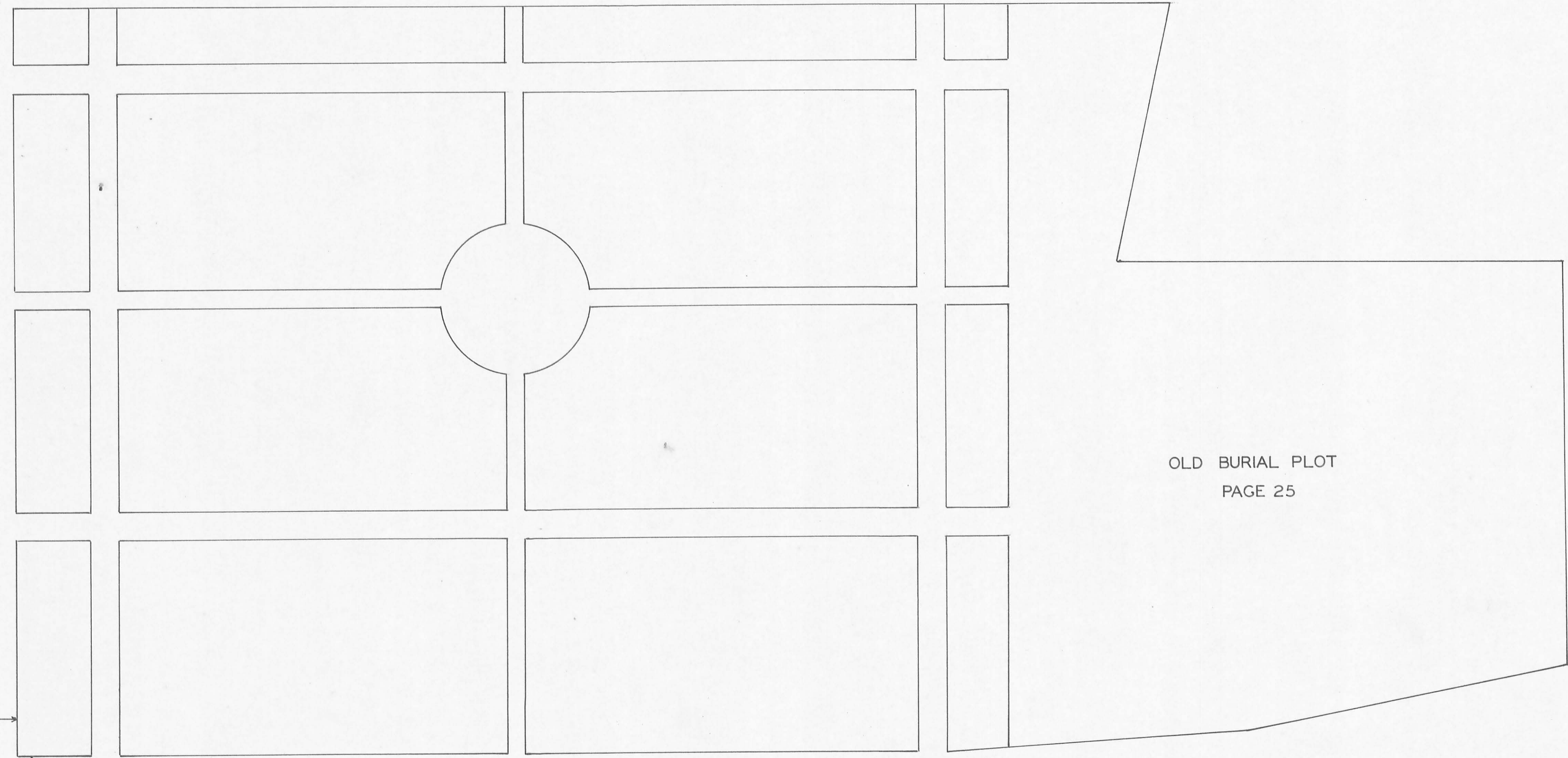



OLD BURIAL PLOT
PAGE 25

NEW SECTION PAGE 26

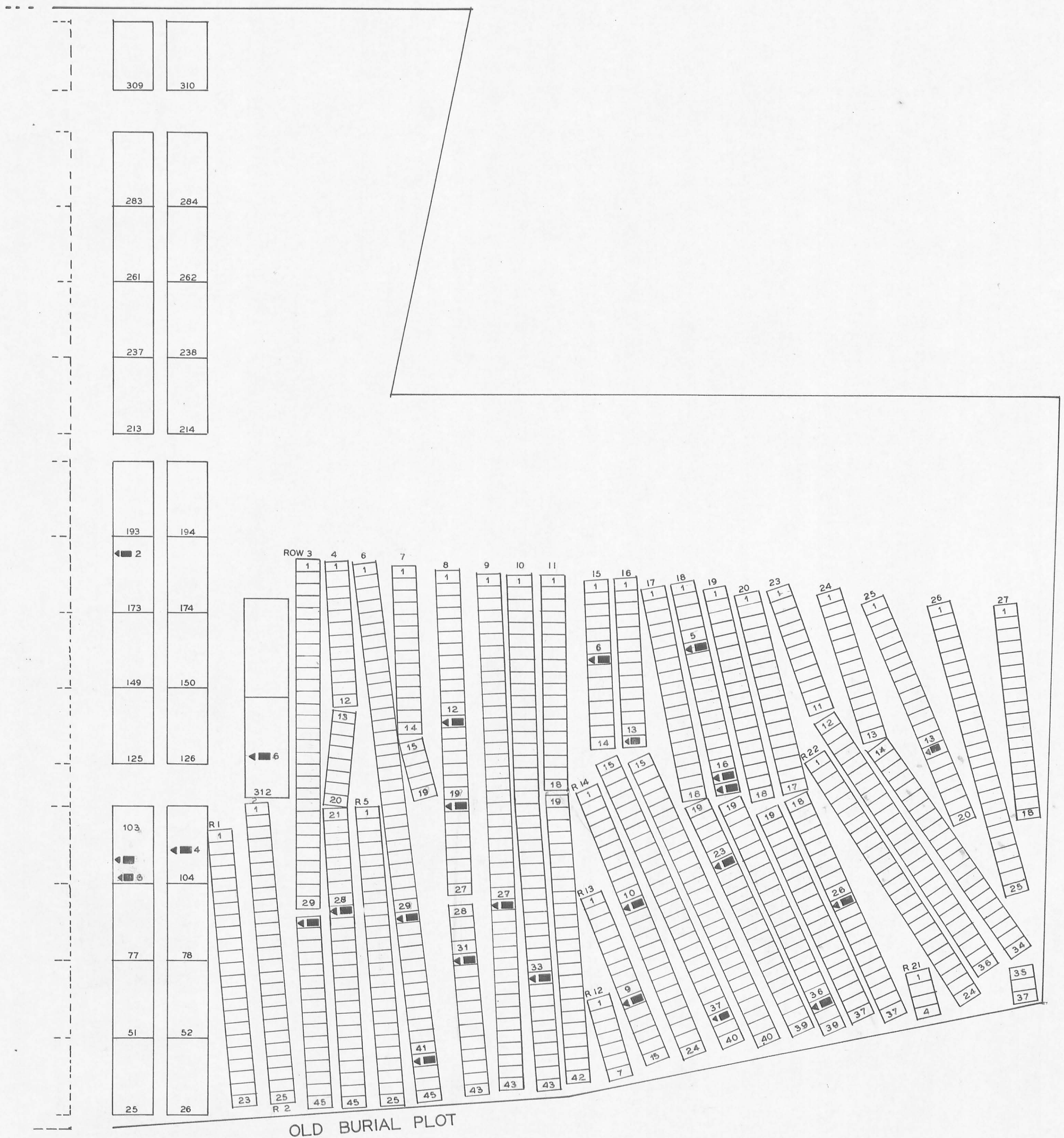

 SCALE 1"=30'

NAME	SEC	L	R	G	W
AKINS HENRY C	18		37	10	
AMSPOKER SAMUEL	15		7	19	
ASHER CORTEZ H	15		38		
BRAIN ROBERT			16	14	
BUSHONG JOHN	103		6	19	
BUSHONG MILTON	104		4	19	
CHAMBERLAIN ISAAC		10	34		
CHAMBERLAIN J B		9	28	19	
DOW WILLIAM D		17	24	19	
EMBREY GEORGE		3	30	19	
GRAHAM WILLIAM H		10	34	16	
HAINES JOHN W	312		6	19	
HAINES SAMUEL		18	6	10	
HAMILTON JAMES W		25	14		
HARVY DANIEL A		14	11	19	
HEATH ALB'T G		8	32	19	
HEATH JESSE		8	13	19	
HEATH JOHN		8	20	10	
JAMES EDWIN DONALD		18	18	31	
SHARP DAVID R		6	30	19	
SMITH ISAAC M		20	27	19	
SMITH JOHN D		4	29		
THOMAS WEBSTER	173		2		
TURNER LOUIS C		18	17		
WATKINS SAMUEL M		13	10	19	
WELCH NATHANIEL C		6	42	19	

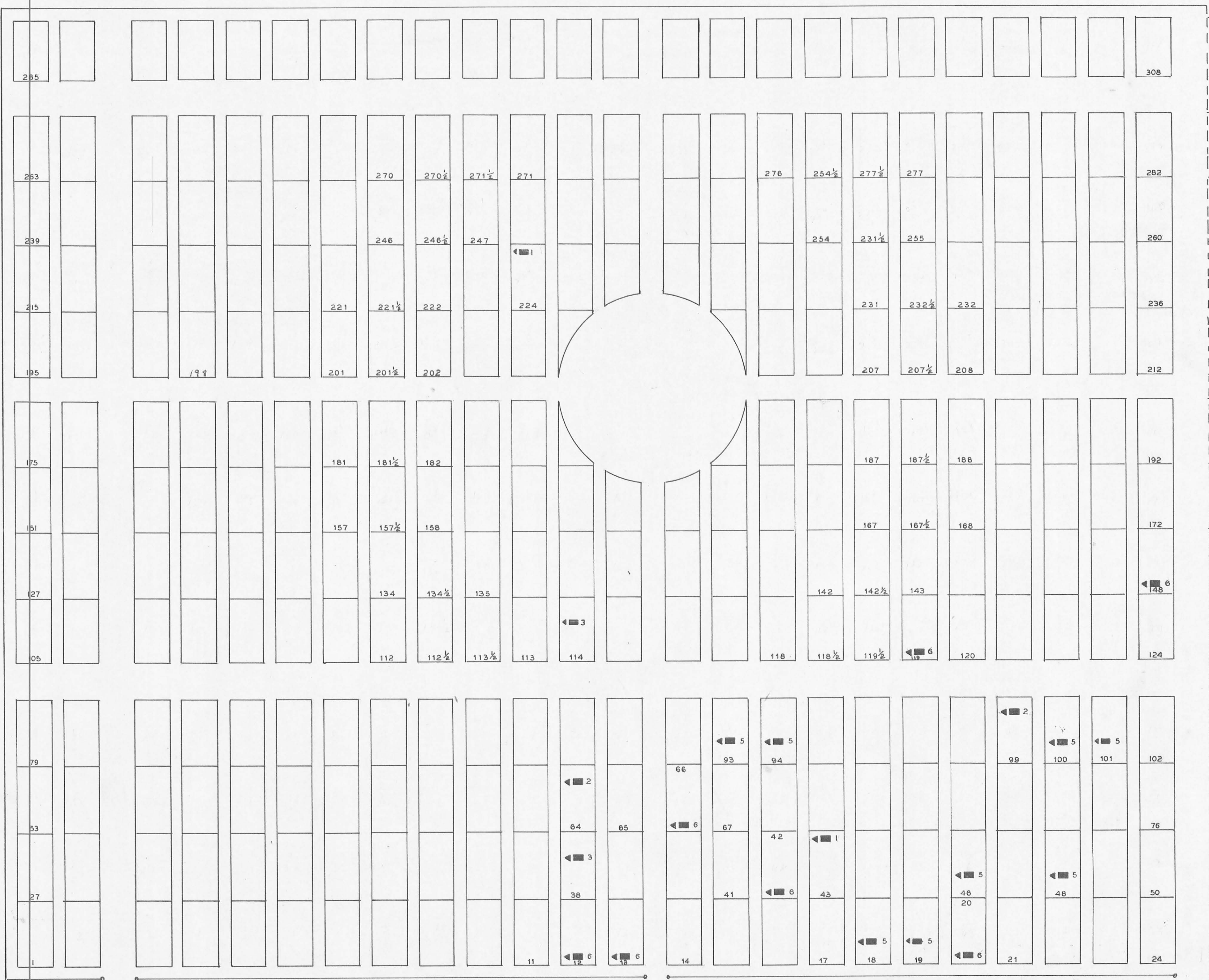

 SCALE 1"=20'

LEGEND
 SEC= SECTION L=LOT R=ROW
 G=GRAVE W=WAR
 X=POSITION UNKNOWN





 SCALE 1"=20'

NAME	SEC	L	R	G	W
ATHA WASHINGTON	38			3	19
AUSTIN JOSIAH	13			6	19
AUSTIN SAMUEL	18			5	19
BALLINGER LEMUEL H.	93			5	19
BRUGLER ISAIAH	94			5	19
CHAMBERLAIN CORWIN	19			5	
CHAMBERLAIN HARRISON H	42			6	19
CHAMBERLAIN ROSCOE	43			1	19
EDWARDS JAMES	64			2	19
GREEN JOHN A.	48			5	19
HARDING GEORGE W.	114			3	19
HEATH MARTIN W.	99			2	19
HUMPHREYS DANIEL G.	224			1	19
INSKEEP JOHN D.	46			5	19
REA DAVID	20			6	19
SHARP WEBSTER	12			6	19
SKIDMORE ALONZO	119			6	19
SMITH JAMES M.	101			5	
SMITH R. R.	100			5	19
VAN VOORHIS CALEB B.	66			6	19
WREN JOHN S.	148			6	19
<i>Haines John Jacob</i>					<i>199</i>

LEGEND
 SEC=SECTION L=LOT R=ROW
 G=GRAVE W=WAR

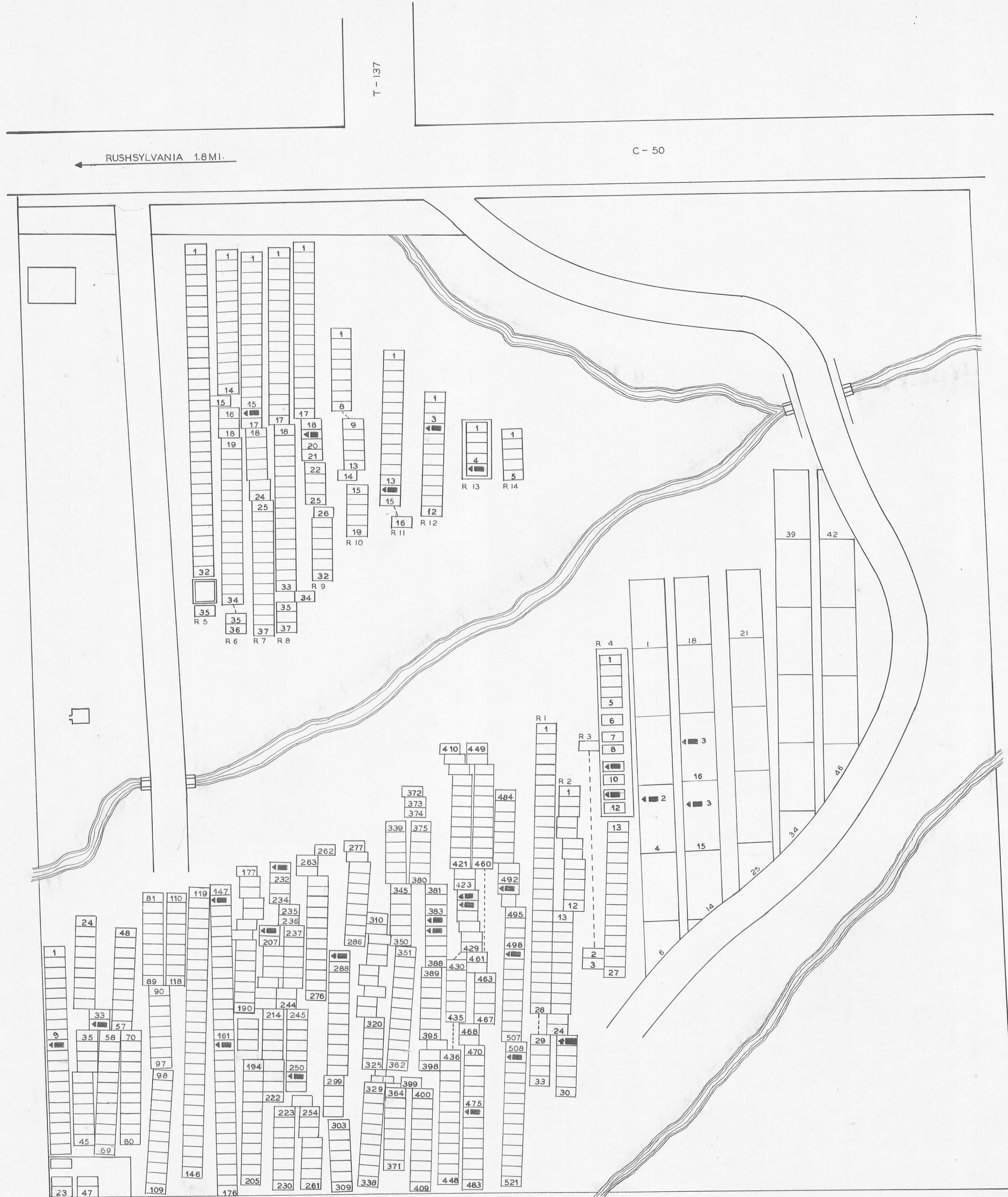
NEW SECTION



NAME	SEC	L	R	G	W
ANGLE ABRAM W.				499	19
BROCKERMANN GLENN T.		4		11	31
BROWN JAMES M.				287	19
BRUGLER LEVI K.		4		2	
CORWIN JARVIS D.				493	19
DAY WILLIAM				384	19
FAUCETT W. L.		7		16	19
FOUT FRANCIS		12		4	19
HATCHER JOHN C.		16		3	19
HIGGINS FRANCIS M.		15		3	19
HOCKETT WILLIAM		11		14	19
JOHNSON JACOB				206	10
KAUTZMAN JOHN C.				385	19
KNOWLES JOHN L.		4		9	18
LAKE WM. B.				10	19
LAWSON ISOM		3		5	19
NORMAN HERBERT N.				476	19
ODER BEN F.				148	19
PREDMORE DAN				34	19
ROSEBRUGH ROBERT				425	19
STEPHENSON LEWIS H.				162	19
STRATTON WM.				251	19
STRATTON W				509	19
WILLIAMS FLAVIUS J.				231	19
SUPPLEMENTARY LIST					
ROBERTS JOHN J.				9	19
ROSBROUGH DAVID				424	
KNOWLES LEVI		2		25	

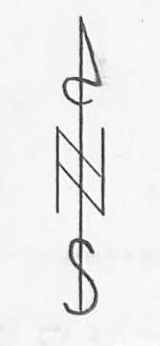

EQUALITY CEMETERY

LOGAN CO. RUSHCREEK TWP.

OFFICIAL PROJECT NOS. 465-423-467 & 665-423-232

LEGEND	HISTORY
① REVOLUTIONARY WAR	
⑩ WAR OF 1812	
⑯ MEXICAN WAR	
⑲ CIVIL WAR	
⑳ SPANISH AM. WAR	
㉓ WORLD WAR	

SCALE 1" = 20' ACRES 1.2

FAIRVIEW CEMETERY

LOGAN CO. LIBERTY TWP.

OFFICIAL PROJECT NOS 465-42-3-467 & 665-42-3-232

77 ACRES

7 PAGES

LEGEND

HISTORY

- ① REVOLUTIONARY WAR
- ⑩ WAR OF 1812
- ⑯ WAR WITH MEXICO
- ⑲ CIVIL WAR
- ⑳ SPANISH AMERICAN WAR
- ㉑ WORLD WAR

46-6-1

SCALE 1"=50'

NORTH ADDITION
PAGE 32

SECTION F
PAGE 32

VACANT

SECTION G
PAGE 32

PARK

PARK

SECTION E
PAGE 31

C-5

SECTION C
PAGE 30

SECTION B
PAGE 30

SECTION A
PAGE 30

SECTION B
PAGE 30

ODD ROW
PAGE 30

PARK

PARK

VACANT

SECTION H
PAGE 33

SECTION D
PAGE 30

VACANT

T - 191

1 MI.

U.S. - 68

WEST LIBERTY .5 MI.

SCALE 1"=20'

SCALE 1"=20'

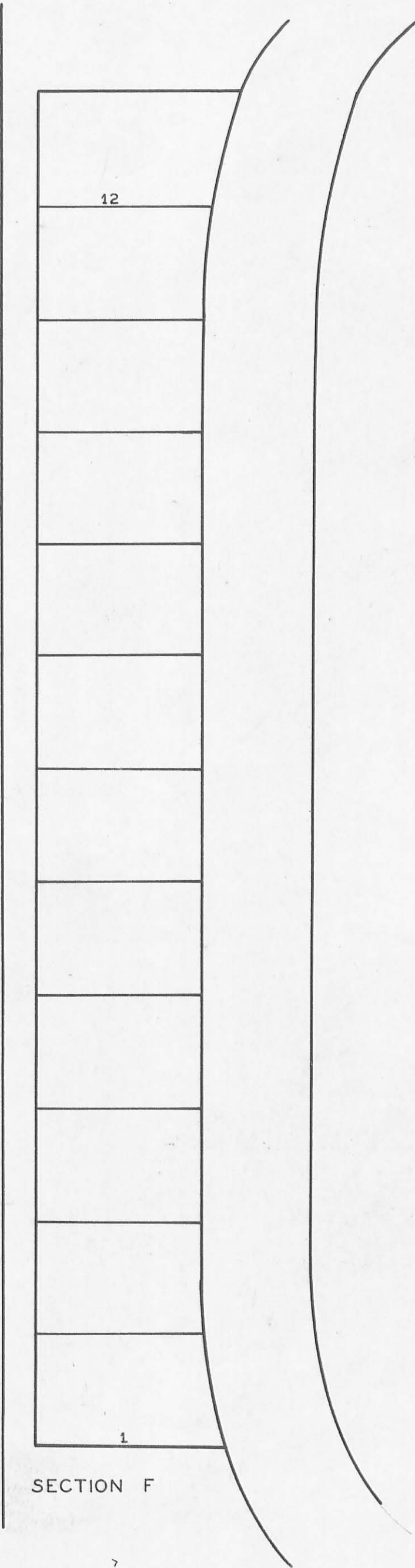
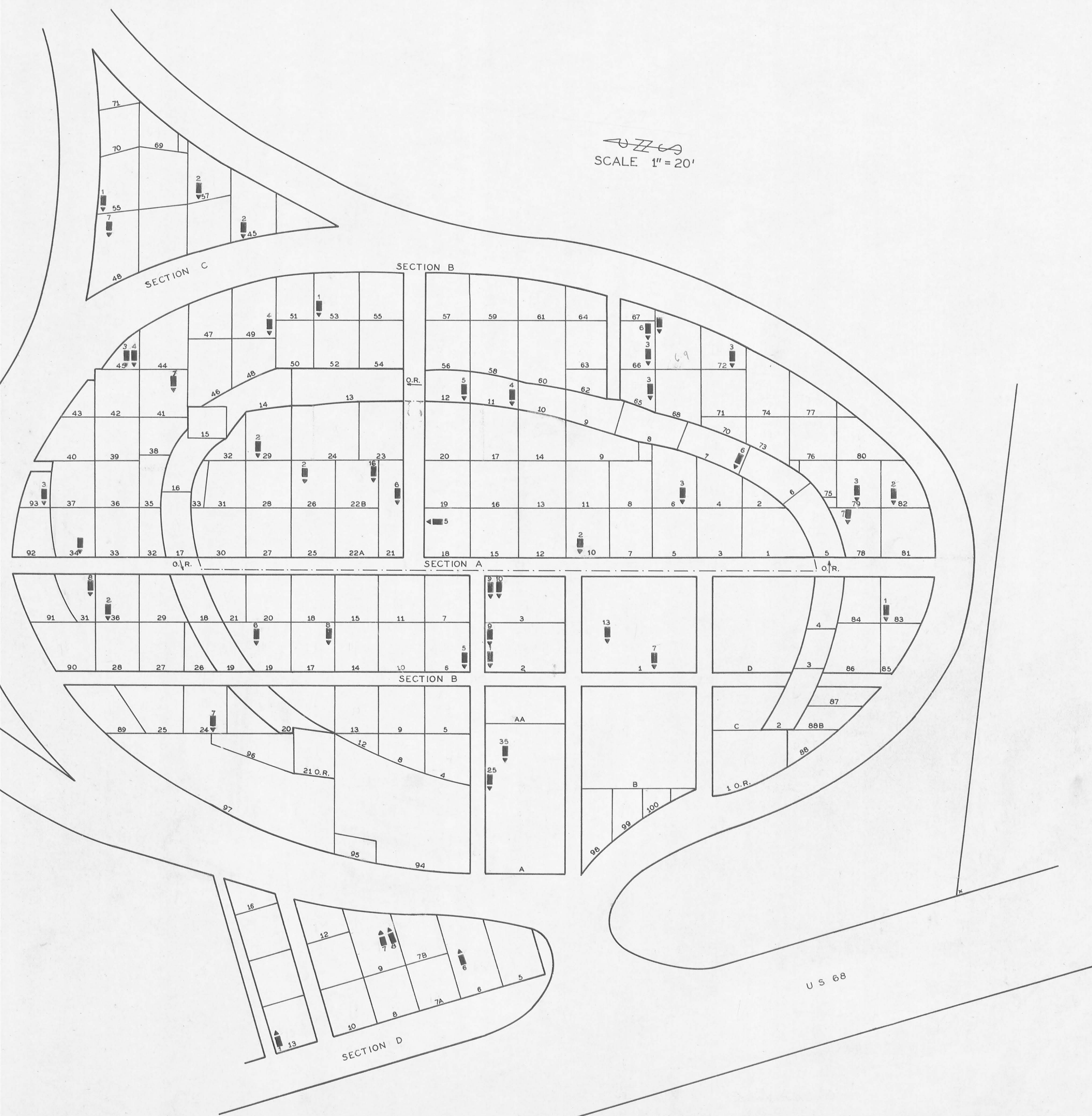

NAME	SEC	L	R	G	W
ARDEN HENRY	D	6		6	19
BROWN J W	C	48		7	
BURGESS ROBERT	B	31		8	19
CORBIN HEZEKIAH	B	A		35	19
DARLINGTON C E	B	1		7	19
DONNALL DAVID	C	57		2	19
DORN HENRY	A	22-B		16	19
EARSON JOHN	D	9		7	19
EVANS MILBY L	B	34		3	19
EWING JAMES A	B	82		2	19
FISHBOUGH JOHN T	A	6		3	19
GARWOOD FRENCH A	B	49		4	19
GORDON J.H.H. LIEUT.	A	10		2	19
GORTON GEORGE W	B	1		13	19
GRUBER G W	B	17		8	
HEYL ARTHUR A.	B	24		7	
JACKSON AMOS	A	26		2	10
LEONARD B.B.	B	41		7	
M ^C CLAY CHARLES M	A	15		5	19
MILLER C G	B	3		10	19
PATTERSON H B	B	36		2	19
PETTY WILLIAM F	B	A		25	19
RUSSEL W S	B	69		5	19
SHOEMAKER JNO	B	72		3	19
SHOOTTS JOSEPH	OR	11		4	19
SHUMATE GEO F	D	13		1	19
SMITH J B	B	83		1	19
SMITH J M	A	21		6	19
STANAGE THOMAS	B	3		9	1
STOUT ABRAHAM	B	19		6	19
TAYLOR JAMES M	B	65		3	19
TAYLOR JOHN	B	6		5	10
TAYLOR JOHN R	B	66		6	19
TAYLOR OLIVER P	B	2		1	19
TAYLOR SAMUEL W	B	2		9	19
TAYLOR WALLACE	OR	12		5	19
TAYLOR WM	B	66		3	19
THOMAS ALBERT D	OR	7		6	19
THOMAS BYRON J	B	45		3	19
THOMAS MILTON F	B	45		4	19
TOWEY JOHN C	B	93		3	19
UNDERWOOD REESE J	A	29		2	19
VAN VINKLE JACOB	C	55		1	
* WILLIAMS GEORGE H					
WILLIAMS ELLIS M	B	79		3	19
ZIEGLER C L	C	45		2	19
ZIEGLER DANIEL	B	53		1	19
ZWISLER JOS	D	9		8	19
Grimes Ralph	A	78		7	
Jordan Orville R.	-	-		-	-

LEGEND
 SEC=SECTION L=LOT R=ROW
 G=GRAVE W=WAR
 *=POSITION UNKNOWN

NAME	SEC	L	R	G	W
BALLINGER SAMUEL	E	13		15	19
BLAYLOCK JAMES	E	42		1	19
BOWERS DAVID M.	E	7		2	31
CHAPIN ALONZO H.	E	86A		8	19
CHETWOOD GEORGE	E	81		4	19
DORN NICHOLAS	E	117		8	19
ELEYET R. A.	E	107A		8	19
FISHBOUGH WILLIAM	E	3		7	19
FISHER WM. F.	E	2		3	19
FULWIDER JOHN R.	E	32C		7	19
GREEN MACAGIE	E	124		12	19
GRIBBLE JAMES W.	E	61B		9	19
GRUBBS PERRY	E	30A		7	19
HARMISH DAVID	E	64		15	19
HANGER HENRY H.	E	32A		21	19
HENDERSON HENRY	E	41B		15	19
HENDERSON LEVI M.	E	41B		6	19
HILL HUGH A.	E	76		24	19
HULSIZER WM.	E	12		16	19
HUPP G. W.	E	29		15	19
KEITH H. B.	E	19B		10	19
KITCHEN JAMES	E	21		15	19
LAKIN D. C.	E	80		13	19
LINGRELL OTHO H.	E	118		9	31
LONGFELLOW O. P.	E	18A		11	19
MC DONALD EBENEZER	E	16		13	10
MC DONALD MAJOR J. E.	E	39		13	19
MILLER CHAS. J.	E	65		14	19
MILLER OLIVER S.	E	33		1	19
MILLER STEPHEN H.	E	106		8	19
MILLER THEO. F.	E	33		11	19
MUSTAINE HERMAN L. E.	E	53A		20	31
NEWSON FRANCIS O. E.	E	107C		23	19
PINE G. W.	E	10		3	19
RAFF JEREMIAH R.	E	99C		21	19
REAMS JOSIAH F.	E	75B		24	19
REAMS ROBERT	E	75A		22	19
ROLAND HENRY W.	E	99B		3	16
SECRIST VIRGIL H.	E	108		8	31
SHEAFFER WM. H.	E	86B		1	19
STANLEY ALFRED	E	28		16	19
SULLIVAN BENJ. C.	E	60		11	19
TAYLOR G. W.	E	78		12	19
THOMAS JAMES A.	E	12		20	19
WALKER DANIEL	E	72		15	19
WHITE G. W.	E	4		6	19
WHITE T. E.	E	4		7	19
WILLIAMS JOHN W.	E	54A		6	19
WILLIAMS LUCIAN A.	E	64A		23	19
YODER SAMUEL W.	E	66		9	19
RAFF HENRY B.	E	127		7	19
RUDISELL JAMES W.	E	29		5	19
Keith Ross Smith	E(1)	113			



SECTION E

SCALE 1" = 20'

SCALE 1" = 20'

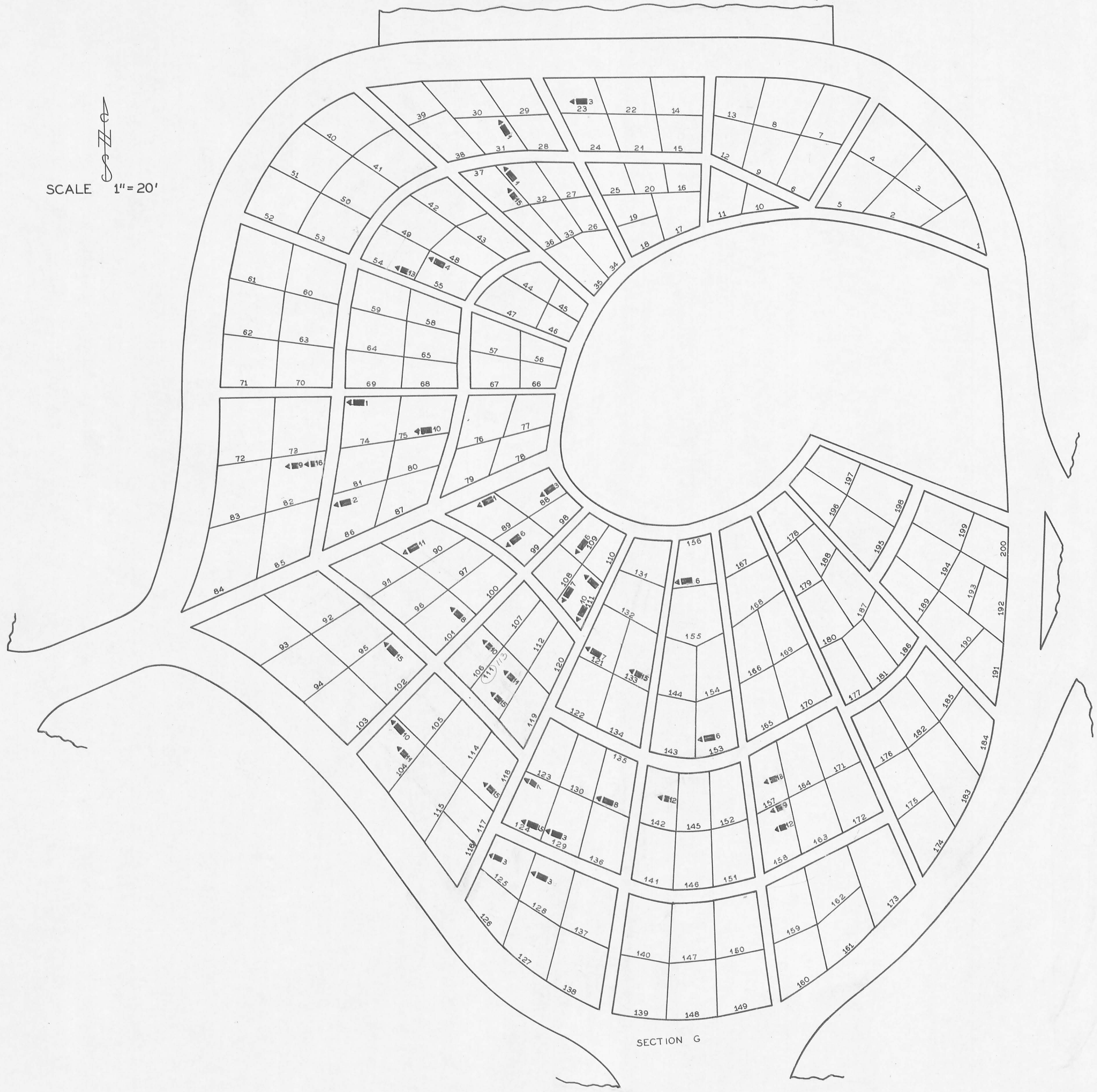

NAME	SEC	L	R	G	W
BAILEY GEORGE F.	G	111		10	19
BOYER JOHN A.	G	99		6	
CROCKETT HOUSTON A.	G	82		9	19
CROFT JAMES WILSON.	G	157		13	31
DANNER WILLIAM W.	G	133		15	
DAVIS GEORGE R.	G	158		9	19
DAVIS JEFFERSON C.	G	158		12	19
DECK JACOB HAMILTON.	G	86		2	19
DEREMER ABRAM.	G	90		14	19
DICUS JAS. F.	G	88		3	19
EVANS NIAS L.	G	32		1	19
FORSYTH JAMES N.	G	142		12	19
GRIBBLE JOSEPH A.	G	141		7	19
HALE DAVID B.	G	101		8	19
HARRIS BENJ. F.	G	143		15	19
HOWARD PERRY C.	G	153		6	19
HOWELL WALTER W.	G	23		3	19
JONES W M.	G	31		4	19
KING GEO W.	G	141		10	25
KIRKWOOD JOHN S.	G	75		10	19
LANCE JOSHUA N.	G	82		16	19
MC CASLAND HUGH.	G	109		6	49
MC DONALD JAS. K.	G	37		15	
PARK MADDISON M.	G	106		10	19
RICHMAN JOHN.	G	125		3	19
SMITH ENOCH A.	G	104		11	25
SMITH WILLIAM W.	G	104		1	19
SPELLMAN THOMAS J.	G	113		11	19
STEINBERGER JOSEPH D.	G	156		6	19
SUTPHIN JOHN F.	G	89		1	
THATCHER JONATHAN.	G	55		4	19
WALKER OLIVER W.	G	135		8	19
WALLACE DAVID P.	G	54		13	49
WATKINS JOHN W.	G	128		3	19
WILLIAMS WILLIAM M.	G	102		15	19
WILLIAMSON WM F.	G	116		15	19
WOODARD C W.	G	121		7	19
WHEELER ELISHA	G	129		3	
KINNAN WILLIAM C.	G	74		1	
KEITH WALTER A.	G	124		15	19
Keith Samuel Robert	G	124		7	-

SECTION G

LEGEND
 SEC-SECTION L-LOT R-ROW
 G-GRAVE W-WAR
 *-POSITION UNKNOWN

NAME	SEC	L	R	G	W
ELEYET CLAYTON	H	12		3	31
HOWARD LEW E	H	157		1	31
KAYLOR ADAM	H	96			1
M ^o GOVERN CHARLES	H	51		2	31
RAFF LEVI S	H	79		2	19
SCOTT WM	H	10		4	19
SKIDMORE HERMAN	H	20		3	31
WHITMAN JOHN M	H	143			3
YODER ELMER C	H	72		2	31

SCALE 1" = 20'



SECTION H

LEGEND
 SEC=SECTION L=LOT R=ROW
 G=GRAVE W=WAR
 X=POSITION UNKNOWN

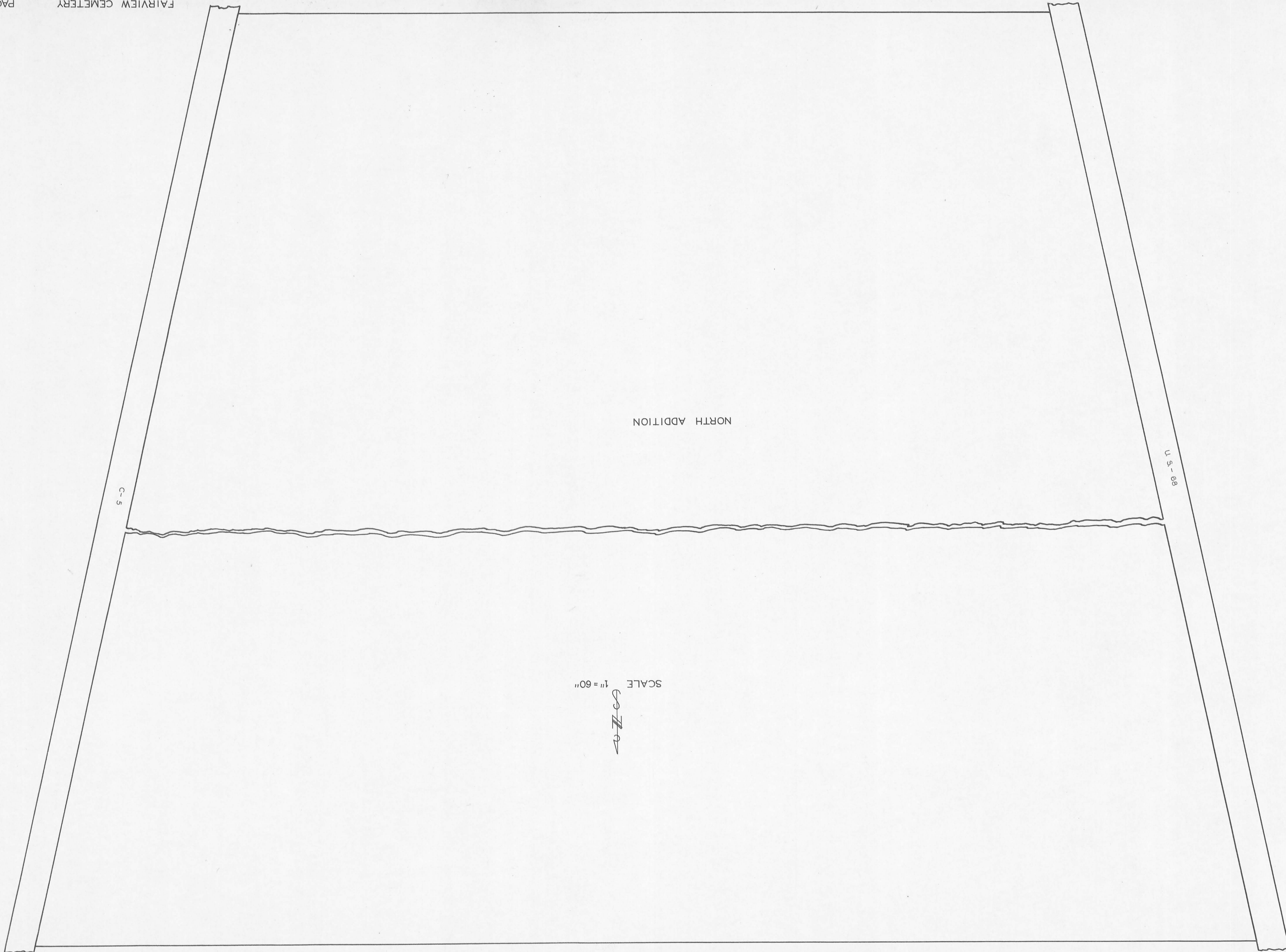

NORTH ADDITION

C-5

U.S.-68

SCALE 1" = 60'
N