

PLAT CAB. B SLIDE 91A

# ANNEXATION TO THE VILLAGE OF LAKEVIEW, OHIO

31.231 ACREAGE    27 SECTION    6 S TOWNSHIP    8 E RANGE    STOKES TOWNSHIP    LOGAN, OHIO COUNTY

DANIEL R. HURLEY, ETAL  
D.B. 383/372  
ORIG. 40.0 AC. TRACT

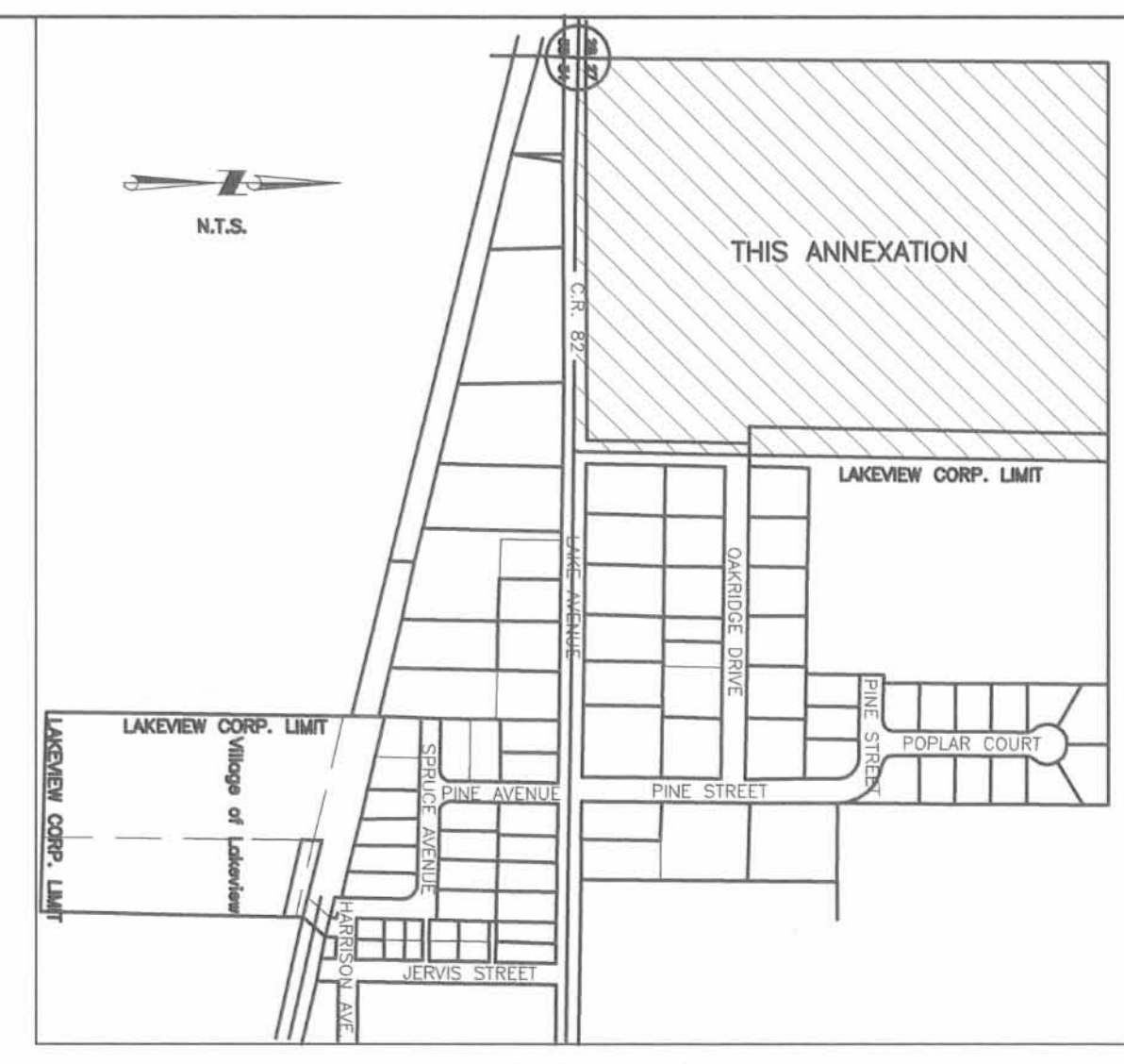

VICINITY MAP

### LEGAL DESCRIPTION

#### ANNEXATION OF 31.231 ACRES TO LAKEVIEW

BEING A PART OF A 1.670-ACRE TRACT OF LAND OWNED BY THE VILLAGE OF LAKEVIEW AS DESCRIBED IN DEED BOOK 317, PAGE 885, A PART OF A 11.329-ACRE TRACT OF LAND OWNED BY S & S FINE HOMES LTD. AS DESCRIBED IN OFFICIAL RECORD 703, PAGE 439 AND ALL OF THE 29.362-ACRE TRACT OF LAND OWNED BY S & S FINE HOMES LTD. AS DESCRIBED IN OFFICIAL RECORD 700, PAGE 908 OF THE LOGAN COUNTY RECORDS, SITUATE IN THE SOUTHWEST QUARTER OF SECTION 27, TOWN 6 SOUTH, RANGE 8 EAST, STOKES TOWNSHIP, LOGAN COUNTY, OHIO AND BEING MORE FULLY DESCRIBED AS FOLLOWS:

Beginning at a P.K. nail found at the southwest corner of the southwest quarter of said Section 27, also being on the centerline of County Highway 82;

thence, North 00°-10'-00" East, 1357.30 feet, along the west line of said quarter section and the east line of the Daniel R. Hurley, etal original 40 acre tract as described in Deed Book 383, Page 372 to a 5/8" iron pin found;

thence, South 89°-19'-56" East, 1006.24 feet, along the south line of the Todd M. Fetter 78.780 acre tract as described in Official Record 374, Page 10 to a point on the existing Village of Lakeview corporation line, passing for reference an iron pin found at 928.37 feet;

thence, South 00°-19'-57" West, 1352.01 feet, along the said existing corporation line and through said 11.329 acre and 1.670 acre tracts to a point at the intersection of the centerline of Oakridge Drive and the centerline of County Highway 82, also being on the south line of said southwest quarter of Section 27;

thence, North 89°-38'-00" West, 1002.29 feet, along the south line of said quarter section and the centerline of County Highway 82 to the place of beginning.

Containing a total of 31.231 acres more or less to be annexed with 0.303 acres more or less being a part of the 1.670 acre tract of land owned by the Village of Lakeview as described in Deed Book 317, Page 885, 1.566 acres being a part of the 11.329 acre tract of land owned by S & S Fine Homes Ltd. and 29.362 acres being the entire tract of land owned by S & S Fine Homes Ltd.

The bearing of South 89°-19'-56" East is based on the westerly extension of the north line of The Woods of Lakeview Phase 1 as recorded in Plat Cabinet B, Slide 27B at the Logan County Recorder's Office.

The above description was prepared by Wesley D. Goubeaux, Ohio Professional Surveyor Number 8254, based on existing surveys on file and deeds of record.

S & S FINE HOMES, LTD.  
O.R. 700/908  
29.362 AC.

31.231 AC. TOTAL  
TO BE ANNEXED

TODD M. FETTER  
O.R. 374/10  
78.78 AC.

### APPROVAL BY VILLAGE OF LAKEVIEW COUNCIL

THIS ANNEXATION ACCEPTED AND APPROVED BY THE COUNCIL OF THE VILLAGE OF LAKEVIEW THIS 6 DAY OF July, 2004 BY ORDINANCE NO. 04-22

*Rya A. Shultz*  
MAYOR  
*Linda K. Miller*  
CLERK  
*Dennis Hanford*  
PRESIDENT OF COUNCIL

### APPROVAL BY VILLAGE OF LAKEVIEW PLANNING COMMISSION

THIS ANNEXATION ACCEPTED AND APPROVED BY THE PLANNING COMMISSION OF THE VILLAGE OF LAKEVIEW THIS 27 DAY OF June, 2004

*Rya A. Shultz*  
PLANNING DIRECTOR

### APPROVAL BY LOGAN COUNTY ENGINEER

THIS PLAT REVIEWED AND APPROVED  
THIS 18 DAY OF August, 2004.

*Scott C. Allen*  
LOGAN COUNTY ENGINEER

### APPROVAL BY LOGAN COUNTY COMMISSIONERS

THE ANNEXATION OF THIS AREA WAS APPROVED THIS 27<sup>th</sup> DAY OF April, 2004 BY RESOLUTION NO. 170-04

*John Jeser*  
LOGAN COUNTY COMMISSIONER  
*David Knight*  
LOGAN COUNTY COMMISSIONER  
*John Bayless*  
LOGAN COUNTY COMMISSIONER

PREAPPROVAL *Jan C. Davis* 3-26-04  
PLAT CHECKED *Jan C. Davis* 8-30-04  
TRANSFERRED THIS 30<sup>th</sup> DAY OF August, 2004  
*Michael E. Godwin*  
AUDITOR, LOGAN COUNTY, OHIO

RECORDED IN PLAT CABINET B,  
SLIDE 91A, RECEIVED FOR RECORD  
AT 9:26 O'CLOCK A M  
THIS 31<sup>st</sup> DAY OF August, 2004  
*Linda Hanson*  
RECORDER, LOGAN COUNTY, OHIO

THE BEARING OF S 89°-19'-56" E IS BASED ON THE WESTERLY EXTENSION OF THE NORTH LINE OF THE WOODS OF LAKEVIEW, PHASE 1, LOGAN CO. RECORDER'S PLAT CAB. B, SLIDE 27B.

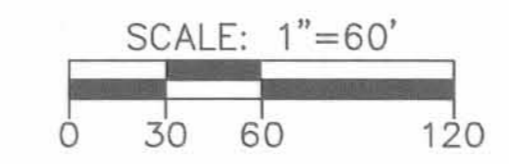

### LEGEND

- 5/8" IRON PIN FOUND
- ⊕ P.K. NAIL FOUND
- ⊗ RAILROAD SPIKE FOUND

I HEREBY CERTIFY THAT ALL MEASUREMENTS TO BE IN ACCORDANCE WITH LAND SURVEYS AND DEEDS OF RECORD.

*Wesley D. Goubeaux* 2/24/2004  
WESLEY D. GOUBEAUX, P.S. #8254 DATE

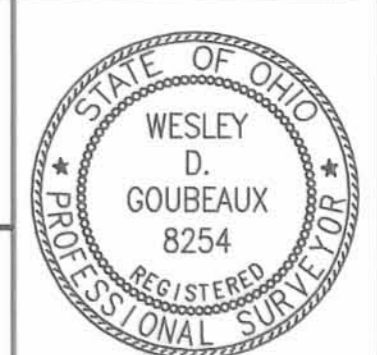

**CHOICE ONE ENGINEERING**  
440 E. HOEWISHER ROAD  
SIDNEY, OHIO 45365  
(937) 497-0200 • FAX (937) 497-0300  
www.choiceoneengineering.com

date: 02-24-2004 drawn by: jmk job number: LOGLAK0305