



See notes to me
 Ante pages 98 & 99.

- A 1 is Costis N.W. cor 112.6
- " A " " S.W. "
- " D " " S.E. "
- " 5 " " N.E. "
- " A " Smiths N.W. "
- " B " " S.W. "
- " C " " S.E. "
- " D " " N.E. "
- " B " Sudduths N.W. "
- " 3 " " S.W. "
- " 4 " " S.E. "
- " 5 " " N.E. "

102
8541

Survey No. 605. Surveyed for Samuel
 Supler of Perrytown
 Ship Logan county, Ohio March 4th 1848
 Part of Military Survey No. 5089 on
 the waters of Mill creek, as follows:
 Beginning at a stone in the west
 line of a tract of land conveyed to
 John Bushong Sr. by D. Weather and
 in the present location of the road
 leading from Zanesfield to Newton
 * also at the S.E. corner of a lot of land
 now owned by Lewis Fisher. Thence
 S. $1/2$ N. 103 poles to a stone at Black ash
 and small wash crossing a Branch at
 9 poles. Thence S 87° W. 184 Poles to a stone
 at 2 Beeches S.E. corner of Baldwin. Thence
 N $7/2$ E. 115 $1/4$ poles to a stone in north side of
 the aforesaid road at 2 Beeches and Sugar
 (all down) crossing the aforesaid Branch at
 24 poles. Thence S 87° W. 146 poles to a stone
 along said road and on the line between
 the lands of S. B. Milguy and S. Supler to
 Milguy's S.E. corner. Thence S 89° W. E 34 poles
 to the Beginning corner, containing 122
 Acres and 136 Perches

Wm. Fisher Esq. C. Hayes Sur. Le. Ohio
 Jacob Humphrey Esq. Ch. ex. s.

See plat on page 106.

N.B. the above is for Samuel Supler indivisibly

Survey N^o 606

March 4th 1848

103

In pursuance of the following notice I proceeded on the above date to take depositions to perpetuate evidence and establish corners

March 4th 1848

Mr Isaac Johnson Sir you
"are hereby notified that the Surveyors of"
"Logan county is now present to take depo-"
"sitions and establish the corners to our land"
"if you wair your right to 20 days' notice"
"in this matter, you will attend with us"
"in the proceedings" if not you will hereby
"take notice that said matter will be"
"attended to at the expiration of 20 days from"
"the date hereof on the premises -"

(Signed) "William Fisher"
"Samuel Supler"

"I hereby wair my right to the 20 days' notice"
"required by law in this matter, and ack-"
"nowledge service (of the notice)"
(Signed) Isaac Johnson

By request of the above named Saml
Supler and W. Fisher I proceeded on the above
date to take depositions and establish corners
and Lewis Bushong being first duly sworn
testified as follows -

Q. By Supler - What do you know about the
original corner of a tract of land deeded
to John Bushong Sr. by Duncan McArthur
and wife?

Ans. My father told me that an Ash and
Hickory was the corner, i.e. S.W. corner

Q. By same, Who was your father?

A. John Bushong,

Q By same. How long since your father told you this?

A. About 11. or 12 years.

Q By same. Was it since your father sold the land?

Ans. No: before.

Mr. Souton was present at the taking of the foregoing deposition but did not ask any questions. (Signed) Lewis Bushong.
In accordance with the foregoing deposition and the old lines I placed a stone at the S. W. corner of the Bushong tract. (now owned by Isaac Johnson) and S. E. corner of Saml. Supler's land from which a Black Ash bears S 57 N 20 links and White Ash 8 1/2 E 30 - present at time Lewis Bushong, Jacob Humphrey, Isaac Johnson, Mrs. Fisher Esq and Lewis Fisher. Thence run S 7 1/2 E. crossing a branch at 7 1/4 poles and Supler's North East corner at 103 and between the lands of Lewis Fisher and Isaac Johnson to Mrs. Fisher's S. W. corner and S. Johnson's N. W. corner. where Alex. McCorary and Lewis Bushong were sworn and testified as follows.

1st Alex. McCorary

Q By Mrs. Fisher. What do you know about John Bushong and James Bushong's corner and their division line?

Ans. I was along with them when they planted their corner and agreed upon a division line;

Q. How long since they planted the corner and agreed to said line?

Ans. About 23 years ago

Q By same. Did they always adhere to said line and corner?

Ans. They did. to the best of my recollection
Note, Mr Johnson was present at the examination
but did ^{not} cross-examine

(Signed) Alexander McCreary

Lewis Bushong testified as follows-

Q. By W. Fisher. What do you know respecting
the establishment of the corner between Geo.
and James Bushong's land in Military Survey
No. 5089?

Ans. They agreed to a corner in the west line
of their land about 22 years ago at 2 Blk.
ashes and Elm and built a fence on the
line between their land which still re-
mains on said ground and neither of them
ever claimed either way from said fence

(Signed) Lewis Bushong

In accordance with the foregoing testimo-
ny and the original line which I run,
I proceeded in the presence of Alex. McCreary
Lewis Bushong, Isaac Johnson Lewis Fishler
and Wm. Fisher to plant a stone at the west
end of the aforesaid fence and exactly in
the W. line of the Bushong tract of land - and
S 20° from a B. Ash stump said to be by McCreary
one of the B. Ashes called for in the deeds of Geo.
and Jas. Bushong - the variation of the west line
of said tract is at present 33° minutes from the
meridian -

C. Hayes Sur. S. C. Ohio

Alex. McCreary }
Wm. Fisher Sr. } Ch. Crs.

See notes of Supter's tract
on ante page 102.

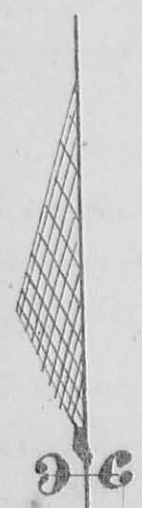

Stone
A. W. Warner

Stone
L. Fisher
S. M. corner
25.12

Stone
Supter's
W. B. corner

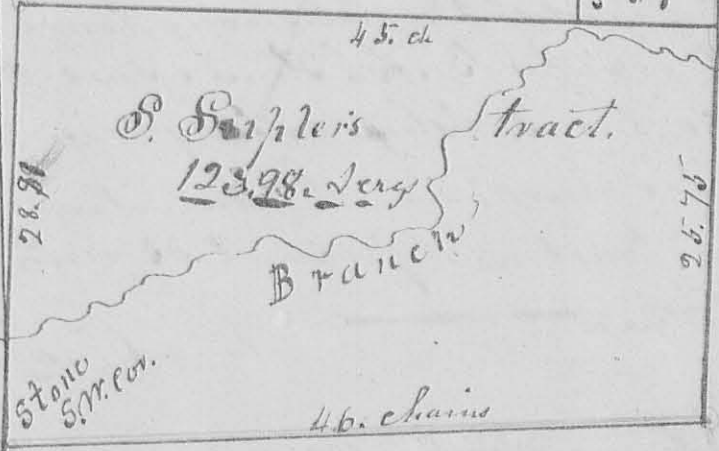

Line run to establish corner of

Stone Mrs Fisher
S. M. corner

N.W. corner
Bushong tract

Bu-shong

Stone S. M. corner
Bushong land
S. E. corner same
Supter.

Scale 1 1/2 chs. to an Inch.

Survey No 607 } March 13th 1848 ✓ 107
 Surveyed Sect 31 T4 R. 14-

8542

Between the Miami River for Joseph Moore
 Sgt. for Patrick Moore, James S. Dawson agent
 for Wm. Brewster and Henry Blinn,
 as follows to wit beginning at the N.W. cor-
 ner of said section at W Oak 20 S. S 21 N. 30 links
 and Hickory 16 S. S. N 14 N 65 links thence
 N 89 1/2 E. 85.68 chains crossing state road at
 40.50 chains Rail Road at 47 chains McKays
 creek at 72.25 chains Free Turnpike at 72.
 75 chains to a post in a prairie, N. Oak
 24 S. S. S 12 1/2 E. 106 links distant, thence
 S 10 N. 83.25 chains passing a qrs. corner
 made by Sam. Hopkins Reg., at 41. chains
 to a Black Oak corner tree, S. E. corner
 of said section thence N 88 1/2 W 86.50 chains
 crossing R.R. at 42.50 chains old state Road at
 44.50 chains and McKays creek at 52.25 ch.
 to a White Oak S. S. N 62 W. 18 links dist, thence
 N 1 1/2 E. 80.20 chains crossing a prairie at 7 ch.
 and pond at 31.50 chains to the beginning
 containing 703.52 Acres. which I subdivide
 as follows to wit Beginning at a stake in centre
 of the N line of said section at a N. Oak S 58 1/2 W
 S 12 S. S. 39 links and White Oak 20 S. S. N. 33 E. 28 links
 thence S 30 W 80.75 chains passing centre
 at a stake Bitter Elm ^{29 W} S. ²⁰ 7.6 links
 Small Hickory 4 S. S. ^{29 W} ²⁰ 7.6 links to a stake
 thence S 88 1/2 E. 21.75 ch. crossing R. Road to ^{29 W} ²⁰ ^{20 1/2 E} ¹⁷⁵
 Oak 24 S. S. ^{55 1/2 W} ²⁰ 50 links N. O. 20 S. S. ^{20 1/2 E} ¹⁷⁵
 links thence N 42 E. 40.37 chains to N. O. 14 S. S.
 S 66 1/2 W 45 links N. O. 16 S 20 1/2 E. 55 links thence
 N 89 1/2 W. 21.75 chains crossing McKays creek at 15.75 ch
 and R. Road 16.75 thence between P. Moore on the N. and
 H. Blinn on the S. to stake at the centre of the

N. 29° W 20

Section Bitter Elm S.E. ~~7. 6 1/2 A.~~ ^{links} ~~27~~ ^{Hickory}
 4 S. S. ~~4 2 1/2 E~~ ^{43 7/8} ~~34~~ ⁴⁷ links, thence S 1/2 N 40. 87
 chains to the beginning containing 87.80 acres -
 This last piece was surveyed for H. D. Blinn
 further see plat hereto attached -

O. Hayes Sur. S. C. Ohio

Geo. W. Grindle
 Tho. S. Linker & others

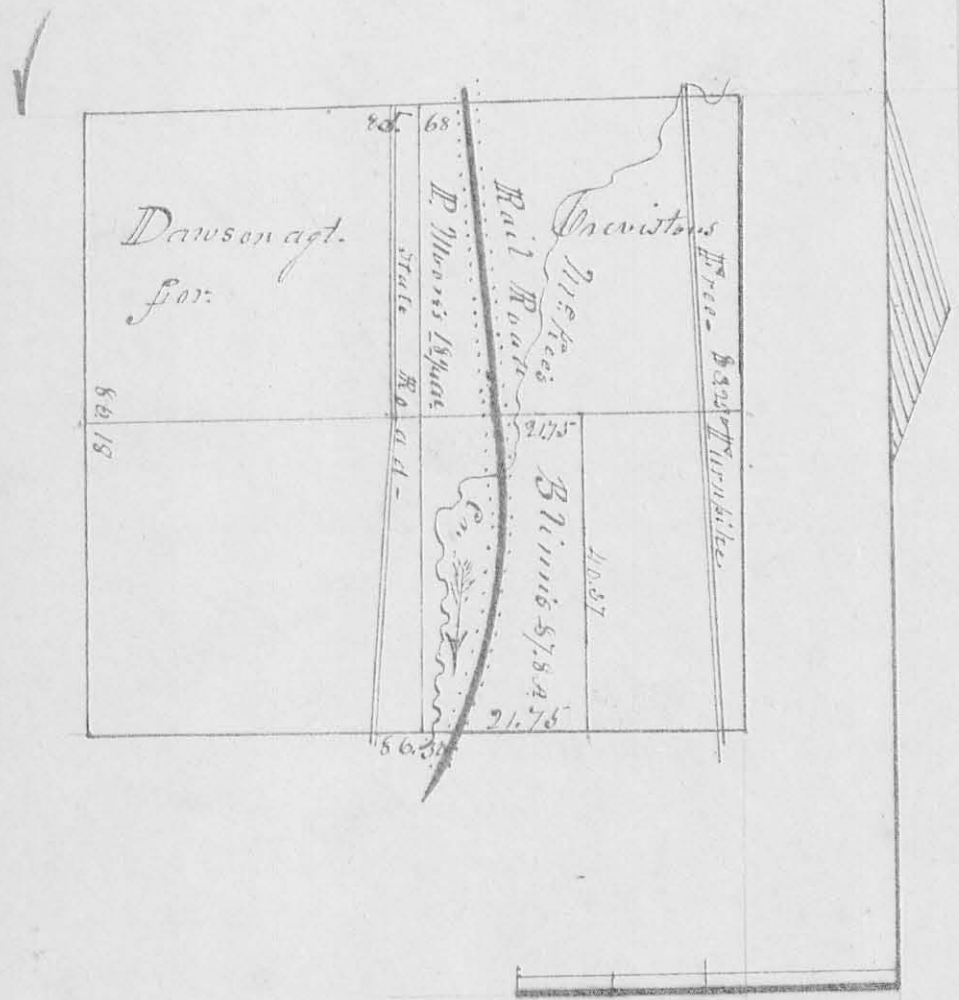

N.B. The above erasures were made on the
 27th May 1848 to correct an error made
 in taking the bearings and distances of
 those trees from the corners -
 O. Hayes S. C. Ohio

Survey No. 608 Surveyed March 17 and 18 1848 for Hezekiah B. Hubbell and Jacob K. Rosier the N.W. qr. of Sec. 34 T3. Range 13 East Miami River as follows

8543

109

for Hubble the North half of said qr. beginning at the S.E. corner of said qr. at a Lynn 24 S. 1/2 S. 1/2 W 28 and White Oak 24 S. 1/2 W 106 Links thence N 87 W 45.75 chains crossing Indian creek at 1 chain to a stake Hickory (down) B. Ash 14 S. 1/2 S. 1/2 W 36 and B. Ash 18 S. 1/2 S 73 E 5 Links distant (all down) thence S 1 W 20.91 chains to a stone Beech 10 S. 1/2 S 46 1/2 E 56. Beech 8 S 42 E 48 Links thence S 89 E 45.75 chains crossing a spring branch to a stone in the middle line of the Sec. thence N 1 E 20.91 chains crossing Indian Creek at 17.27 chains to the Beginning containing 75.66 Acs. for Rosier the South half of said qr. as follows Beginning at the centre of said Sect. at a stone and Beech 10 S. 1/2 S 46 1/2 W 11. and Lynn 5 S. 1/2 S 47 1/2 E 4 links distant thence N 89 W 45.75 chains to Bur Oak 18 S. 1/2 S 70 3/4 W 14, S. 1/2 S 24 S. 1/2 S 46 1/2 E 32 links. thence N 1 E 20.91 chains to a Beech 10 S. 1/2 S 46 1/2 E 56 and Beech 8 S. 1/2 S 42 E 48 links distant thence S 89 E 45.75 crossing a spring branch to a stone in the middle line of the Sect. thence S 1 W 20.91 chains to the Beginning containing 75.66 Acs.

H. B. Hubbell
Jac. K. Rosier

O. Hayes Sur. Sec. Ohio

Survey No 609

Surveyed March 17th 1848
for Volume A. Souders Survey

of Souders Sect a part of the N.W.
qt. of Sect. 35 T. 3. Range 13 East Miami river
as follows to wit Beginning at a stake in
the North line of said Sec. by chain and 48 1/2
links east of the N.W. corner of the same
at a stake thence S 89 1/2 E 11. chains 58 2/3 links
to a stake Blue Ash 11. S. S. 16 E 8. and W.
Ash 18 S. S. N 52 W 13 links ditto thence
S 1/2 W 9 chs 48 1/2 links crossing Indian creek
down a high bank at 5 chains to a stake
in a field thence N 89 1/2 W 11. chs. 58 2/3 links
along a very rugged bank of Ind. creek to
a stone in a field. thence N 1/2 E 9 chs
48 1/2 links crossing Soc. Horner's mill pond
to the beginning containing 11 S. S.

Mortimer Souders
Allen S. Forsythe } Chers.

O. Hayes Sur. L. C.

Survey No. 610 [✓] Surveyed March 14th 1848. for ^{Albany}
~~Shos. P. Miller~~ an addition

(8523) To "Miller's addition" to the town of West Liberty and made an alteration in the plat and Survey made by S. A. Harbison Esq. former Surveyor of Logan County for which see plat ante page 51. and note page 52.

E. Foushey.
Ewd. Blaylock } Ch. Ers.
O. Hayes Sur. Sec. C.

Survey No. 611 [✓] Surveyed April 11th 1848.

(8545) for Aaron Welch part of Military Survey No 9904 in M. Arthur Trapp, Logan County as follows Beginning at a stone in the East line of George Hoover's land, thence and N. E. corner to Hugh Bickham thence $N 71 \frac{1}{6}^{\circ} E$ 92.6 poles to a stone at said Hoover's N. E. corner from which a Hickory 12 I. S. bears $N 30 \frac{1}{2}^{\circ} W$ 22 links and an Ironwood 10 I. S. $S 34 \frac{1}{3}^{\circ} W$ 40 links dist. thence $S 11^{\circ} E$ 90.5 poles to a stone in the west side of Washington Alley in the town of Cherokee Logan County Ohio. thence $S 79^{\circ} W$ 92.6 poles to a stake from which a white 20 I. S. bears $N 11 \frac{1}{2}^{\circ} W$ 72 links distant thence $N 11^{\circ} W$ 80 poles to the beginning corner containing 49 A. 37.1 Perches.

R. A. Westfall
Jos. Knight } Ch. Ers.
O. Hayes Sur. Sec. C.

Survey No 612

Surveyed April 11/48
 for R. A. Westfall a lot out of the E.
 side of the lot described on the fore-
 going page being a part of Military Survey
 No 9904 as follows to wit. Beginning by
 poles S 79° W from the N.E. corner of the
 lot owned by Aaron Welch thence S 79° W
 22 poles to stone on the bank of a branch
 thence N 11° W 21.82 poles to a stone in a mead-
 ow from which a plum tree 4 S. Dr. bears S 50° E
 56 links distant thence N 79° E 22 poles to
 a stone in a field thence S 11° E 21.82 poles
 to a stone at the Beginning corner, contain-
 ing 3 acres

Also for J. W. Brooks out of the same
 tract being pt. Mil Survey No 9904 a lot as
 follows to wit Beginning at a stone
 N 11° W 4 poles from the N.E. corner of said
 tract thence N 11° W 17.82 poles to a stone in
 the E. line of said tract and on the W. side
 of Washington alley in the town of Cherokee
 thence S 79° W 7 poles to a stone at Westfall's
 N.W. corner thence S 11° E 17.82 poles to a stone
 in Westfall's E. line thence N 79° E 7 poles
 to the beginning corner, containing 124.74
 Perches.

R. A. Westfall & Ch. ers.
 Joseph Knight

O. Hayes Sur. & C. C.

Survey N^o 613

2545

113

Surveyed April 12/48 for
James Langhead and J. M. Brooks
Jt. of Mil. Survey N^o 9904 as follows—
for Langhead Beginning at a stone
in the centre of the present location of
a free Turnpike thence N 80 E 70.25 perches
to a stone in the Richmond road, thence
S 18 W 57 poles to a stone in said road
from which a mulberry C. S. S., bears
N 60 W 56 links distant thence S 89 W
36 poles to a stone in the aforesaid Free
Turnpike thence N 19 W 44.75 poles to
the place of beginning containing
16 Acres and $\frac{10}{100}$ parts of an acre—

Also in same Survey for J. M. Brooks
a lot as follows to wit Beginning at
Langhead's N. W. corner at a stone in
the aforesaid Free Turnpike thence
S 80 W 7.25 poles to a stake from which
a white Oak 10 S. S., bears N 11 W 20 links
distant. thence N 11 W 43.16 poles to
a stone in the edge of Carter's Branch
thence S 26 E 4.4 poles to a stone in the
angle of the Free Turnpike thence S 17 W
39 1/2 poles to the place of Beginning—Contain-
ing 156.52 Perches—

Thos. Norton
J. M. Brooks } Ch. eis.
O. Hayes Sur. L. & C.

114

Survey No. 614

Surveyed Apr. 12/48

3546

for the heirs of James Mahan in
 Military Survey No. 9881 on the waters
 of Cherokee creek two lines as follows
 to wit. Beginning at a stone in the line
 Road at the N.W. corner of said survey
 thence S 11 E 25 chains to a stone in the
 aforesaid road planted by me thence S 79 1/2 W
 100 chains to a stake in a ditch from which
 a Bur Oak 30 S. S. S 78 W 14 links distant
 crossing Cherokee creek at 23.50 chains

John Coulter
 Noah Devault ch. eris

O. Hayes Sur. S. C. C.

Survey No. 615

Surveyed for J. M. Brooks

3546

a lot of land in Military Survey No. 9704
 as follows Beginning at a stone in the
 East line of a tract of land now owned
 by Aaron Welch thence N 77 E. 72 chains
 to a stake on the West side of Washington
 alley in the town of Cherokee Logan Co,
 Ohio and S.W. corner to a lot now owned
 by Samuel Harrod thence S 30.45 E 4.50
 chains to the N. side of Mountain street
 in the aforesaid town thence N 11 W 4.55
 chains to the place of beginning contain-
 ing 37.5 Perches or $\frac{234}{1000}$ of an acre

Wm J. King
 Joseph Stalbruck ch. eris

O. Hayes Sur. S. C. Ohio

Survey No 616

185

8389

Surveyed April 17th 1848

for Josiah Carr Esq., a lot of land adjoining the town of Loganville in section 15 Q. 2 Range 14 East Miami river as follows to wit Beginning at a ~~stone~~ stone in the East line of the S. addition to the S. addition to said town from which a white C. stump 36 S. 5. bears E. 20. E 28 links and a MC. stump 8 S. 5. N 20 W 65 links distant thence N 63 1/2 E 15 chains to a stake in West line of Mrs. Douglass' land, thence North 11 chains to a stake at said Douglass. N. W. corner thence West 15 chains to a stake, thence North 3 chains to a stake near a Blk. Oak thence S 37 W 9.50 chains to a stake between a R. Oak and Ash, thence S 30 W 15 chains to the stone at the beginning corner containing 23. $\frac{40}{100}$ Acre

Also laid off for same out of same tract a lot for Daniel Beck. as follows. Beginning N 30 W 64 links (from the stone mentioned as the beginning of Carr's tract) at a stone thence N 58 E 10 perches to a stone, thence N 30 W 16 perches to a stone thence S 58 W 10 perches to a stone thence S 30 E 16 perches to the beginning. Containing One acre.

Also laid off for same out of same tract a lot for Thompson Dixon Esq., as follows. Beginning at a stone at Beck's S. E. corner thence N 38 E 3.50 chains to a stone at King's S. W. corner thence N 22 W 7 chains to a stone at said King's N. W. corner thence S 54 W 5.55 chains to a stone in the East line of Loganville thence S 30 E 2.43 chains to a stone at Beck's N. W. corner.

corner

Thence N 58 E. 2.50 chs. to Becks N.E. Corner thence S 30 E 4 chs. to the stone at the Beginning containing 3 Acres ~~and~~

Also laid off a lot for same out of same tract for Abraham Cooper as follows to-wit, Beginning N 30 W 30 feet from a stone in the East line of Loganville at the N.W. Corner of S. Dixons Plot. thence N 54 E. 21 perches to a stake thence N 30 W 38 ²⁰/₂₃ perches to a stake thence S 37 W 22 poles to a stake Between a R. Oak and Ash thence S 30 E 30 poles to a stake at the beginning containing ~~3 Acres~~ 4 Acres - 82 Perches -

Also laid off a lot out of same tract for Josiah Carr as follows. to wit Beginning at a stake near a red oak thence N 37 E 16 ¹⁰/₂₅ poles to a stake ^{near a white oak} thence South 12 poles to a stake a small Cherry and Dogwood thence East 61 poles to a stake near a N. O. 16 ¹⁰/₂₅ thence South 7 ¹/₂ poles to a stone at Kings N.E. Corner thence S 67 ³/₄ W 28 poles to a stone thence S 58 ¹/₂ W 29 ¹/₂₅ poles to a stone 30 feet S. of Coopers S.E. Corner thence N 30 W 40 ¹⁵/₂₅ poles to the beginning containing - 8 Acres -

Madison Vial }
John M. Rice } chs.

O. Hayes Sur. S.C.

Note. See plot on next page
O. Hayes

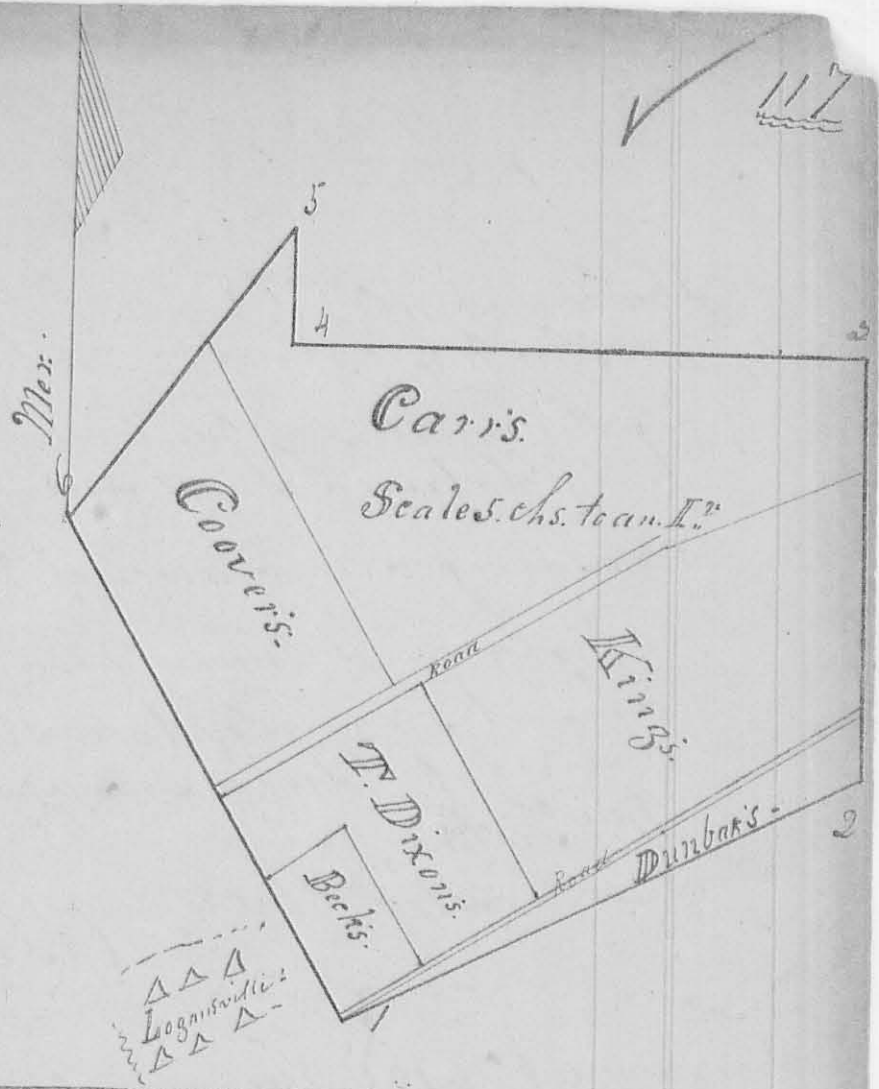

Survey No. 617. Surveyed April 18th 1828 for
 Allen D. and Samuel Crofford
 the S.W. q. or part of fractional Sect 17
 Down 2. Range 15 E. N.R. as follows. Beginning
 at the S.W. corner of the sect. at a post in a prairie
 thence N 77° E. 40.90 chs. to a stone thence
 S 1° W 25.50 chains to a stone thence S 89° W
 40.11 chains to a stone thence N 91° E 17.25
 chains to the Beginning containing 85 Aers
 117.62 perches

A.D. Crofford?
 S. Crofford Sch. cr's.

O. Hayes Sur. L. & C.

Survey No. 618

April 22nd 1848 On the application of Peter Vandoorhis, Wm. Robinson, Wm. Fisher et al.

Surveyed a line as follows Beginning at the N.E. corner of Military Survey No. 5089 on the waters of Mill creek thence S 10 W 152 poles between said Survey and No. 4010 crossing one branch of Mill creek at about 80 poles and main branch said creek at about 300 poles to a stone at the S.E. corner of said Survey. No. 5089.

Wm. Fisher }
Dav. Endley } ch. evs. O. Hayes Sur, L.C.C.

Survey No. 619

Surveyed April 22nd 1848

On application of Scrub Baldwin, Wm. Fisher, Peter Vandoorhis et al. Trustees of the Methodist C. Church known as the "Mill Creek Meeting house" a meeting house lot as follows Beginning at a stone in the center of the present location of the Smith, and Yansfield and Newton Road thence S 70 W 8 1/2 poles to a stone in the center of the last mentioned road thence N 10 E 16 poles to a stone near a large Spring. thence S 89 E 8 1/4 poles to a stone in center of the first mentioned road thence S 1 W 15 1/2 poles to the beginning containing 12393

Perchys }
Wm. Fisher } ch. evs. O. Hayes Sur, L.C.C.
Wm. Robinson }

Survey No. 620

Surveyed April 21st

1848 for Mr. Ballinger a part of Military Survey No. 4010 on the waters of Mill Creek Logan County O. as follows.

Beginning at a Stone in E. line of Mr. Donald's Survey No. 5089 thence East 80 poles to a stone in the West line of Mr. Weatherby's land thence North $15\frac{2}{3}$ poles to a stone in the Yarnsfield and Newton road, thence $489^{\circ} 11\frac{4}{25}$ poles to a red Oak in said road thence $S 67^{\circ} W 21\frac{15}{25}$ poles to a stone in the centre of said road, thence West 19 poles in the East line of the town plot of the town of Greenfield in Logan Co. O.

thence $S 1^{\circ} W 15$ poles to a stone at the S. E. corner of said town plot, thence $N 89\frac{1}{2}^{\circ} W 18\frac{2}{25}$ poles to a stone in S. line of said town plot, thence $S \frac{1}{2} E 6\frac{15}{25}$ poles to a stone thence $S 86 W 16$ poles to a stone in West line Survey No. 5089 thence $S 1^{\circ} W 13\frac{20}{25}$ poles to the place of beginning containing $14.87\frac{1}{100}$ Acres

Also laid off a lot out of the West end of the above described lot for Mr. Wm. Fadin corner lot No. 20 in the Town of Greenfield thence $S 86 W 14.82$ poles to a stone 20 feet E. of West line Survey No. 5089 thence $S 1^{\circ} W 13.80$ poles to a stone 20 feet E. of the West line No. 4010, thence East 13.80 poles to a stone thence North 13.08 poles to the beginning containing $205.65\frac{65}{100}$ Acres

Peter Vanvorshick }
Asa Swinn }
O. Hayes Sur L. C.

Survey No. 621

Surveyed April 21st, 1848

a lot of land for J. E. Southward to Henry Canvovich in Military Survey No. 5010 on the waters of Mill Creek as follows Beginning at a stake near a sugar and Ironwood (down) thence S 19° W 78 1/2 poles to a stake near a hickory thence East 16 2/3 poles to a stake, thence N 3 1/2 E 98 1/2 poles to a stake near a Dogwood thence N 87 1/2 W 16 2/3 poles to the place of Beginning containing 10 Acres -

Peter Canvovich
Asa Swinn

Chas.

O. Hayes Sur. G. Co.

Survey No. 622

Surveyed April 21st 1848

for Isaac Johnson to Asa Swinn a lot out of Military Survey No 5089 on the waters Mill Creek Logan Co. as follows Beginning at a stone in the Mansfield and Newton Road and in the West line of the Bushong tract of land and N. E. corner to Saml. Supleys land thence N 58 1/2 E 24 poles to a stone in the aforesaid road thence S 1/2 W 23 1/3 poles to a stone, thence N 58 1/2 W 24 poles to a stone in the aforesaid W line. thence N 1/2 E along said line 23 1/3 poles to the beginning containing 3 Acres

Henry Canvovich
Dar. Jones

Chas.

O. Hayes Sur. G. Co.

Survey No. 623

121

8547
Surveyed April 25th 1848 for John Wolff
a lot of land as follows Beginning at
the centre stake of Section 5, T. 3, R. 13
East of the Great Miami thence $N 72^{\circ} E$ 19.25
to a Stake from which a white Oak 36.5 ft.
bears $S 50^{\circ} W$ 13 links and Bot. Oak 10.5 ft. $N 52^{\circ} W$
20 links distant, thence $N 88^{\circ} E$ 2.01 chains to
a stake in the present location of the Man-
paukonnetta Road and in line between
John J. Reynolds and John Wolff's land thence
 $N 27^{\circ} W$ 4.82 chains to a stake in the afore-
said road and White Oak 20.5 ft. $S 73^{\circ} W$
91 links distant, thence $N 23^{\circ} W$ 5.08 chs.
to a stake in said road Bot Oak 18.5 ft.
 $S 75^{\circ} W$ 56 links distant thence $N 46^{\circ} W$
7.06 chs. to a stake in said road W. Oak
18.5 ft. $N 76^{\circ} W$ 95. distant thence $N 89^{\circ} W$
2.21 chs. to a stone White Oak 18.5 ft. $S 59^{\circ} W$
12 links distant thence $S 1/2^{\circ} W$ 33. chs.
crossing "Stoney Creek" to a stake in a
prairie thence $S 89^{\circ} E$ 9.68 chs. crossing
"Stoney Creek" to the place of beginning
containing 28. $\frac{37}{100}$ Acres.

Also laid off out of the North end of
the above described tract Beginning at
~~the a stake in~~ for John J. Reynolds's
follows to wit Beginning at a stake
in the Manpaukonnetta road in the
line between John Wolff and J. Reynolds
thence $N 27^{\circ} W$ 4.82 chains to a stake
in the aforesaid Road W. Oak 20.5 ft.
 $S 73^{\circ} W$ 91 Links distant thence $N 23^{\circ} W$ 5.08
chains to a stake in said road. Bot. Oak
18.5 ft. $S 75^{\circ} W$ 56 Links distant

129
min

thence $N 46 \frac{1}{2} W$ 7.06 chains to a stake
in the aforesaid road White Oak 18
S. 51 $N 76^{\circ} W$ 95 links distant thence
 $N 89 \frac{1}{2} W$ 2.21 chs. to a stone N. O. 18 S. 51
 $S 59 \frac{1}{2} W$ 12 links distant thence $S \frac{1}{2} W$
15 chains to a stake at N. O. 12 S. 51 $N 66^{\circ} E$
74 links distant thence $N 88^{\circ} E$ 11.79
chains to the place of beginning
containing 9 and $\frac{62}{100}$ Acres

J. Doan } ch. ers.
John Shaw }

O. Hayes Sur. L. C.

Survey No. 624 } Surveyed April 25th 1848
for John J. Reynolds to John Wolf for
a lot of land as follows Being a part
of the S. W. q. sec. 5, T. 3, R. 13 beginning
at a stone in the Warsaw, Konotta
road at the N. E. corner of lot now owned
by said Wolf thence $N 28 \frac{1}{2} W$ 12.10 chs
to a stake in the road N. O. 36 S. 51 $S 72 \frac{1}{2} W$
21 links dist. thence $S 88^{\circ} W$ 2.01 ch to a stone
White Ash 36 S. 51 $S 50 W$ 13 links Bot Oak
10 S. 51 $N 59 W$ 20 links distant, thence
 $S \frac{1}{2} W$ 10.59 chains to a stone in a field.
thence $S 88^{\circ} E$ 8 chains to the place of Begin-
ning containing 5 and $\frac{27}{100}$ Acres

John Doan } ch. ers.
John Shaw }

O. Hayes Sur. L. C.

Survey No. 625

123

Surveyed April 25th 1848

B383

for Mrs Saylor to John Wolfe Jr. a part
of the N.W. qr Sec 35 T4. R13 East G. Miami
as follows Beginning at the N.W. corner
of said Sect. N. 0 16 S. 1/2 E. S 41 E 16 links dist,
S 12 S. 1/2 E. 48 1/2 W. 32 links dist, thence S 87 1/2
100 poles to a stake White Elm 12 S. 1/2 E.
S 72 1/2 E 21 links. made a corner for J. Wolfe Jr
on this line at 57 poles. Bot. C 15 S. 1/2 E. S 53 1/2 E 110
links dist, thence S 72 W 80 poles to a stake
and Honey Locust 4 S. 1/2 E. 48 1/2 W 56 links.
thence S 87 1/2 W 100 poles to a stone in a
prairie on the W. side Stoney Creek - made
a corner for John Wolfe Jr. on this line at 43
poles viz. N. 0 18 S. 1/2 E. S 59 1/2 W 39 links
White Oak. 18 S. 1/2 E. 48 1/2 E. 38 links dist. thence
N. 72 E 80 poles to the Beginning contain-
ing 30 Acres in all and 28.50 Acres
to John Wolfe Jr.

John Shaw & others

O. Hayes Sec. S. C. C.

Survey No. 626

April 26th 1848 Surveyed

B578

a line for John Votestine and John
Wolfe Jr. as follows Beginning at a stone
in the Warpankometta road on the
West side of "Stoney Creek" in the S.E. qr
Sect 5, T3, R13. Thence S 30 W 54 2/5 poles
to an Elm 18 S. 1/2 E. corner tree thence S 22 W
20 poles to a crossing said creek to a stone on
the East Bank thence S 38 W. 30 poles to
a Red Elm 20 S. 1/2 E. 42 1/2 W 7 links dist.

12th
thence S 40 W 22 poles to a stone in
a field thence S 71 W 39 poles to a
stone in the N. line said 9th
John Shaw }
Joan } chers

O. Hayes Sur. G. C.

Survey No 627 Surveyed April 29th 1848

8549

for David Yoder and others a corner
to their lands as follows i.e. established
the corner between Secs. 4, 5, 10 & 11 T. 4, R. 13
East Great Miami as follows planted
a stone at said corner which bears
N 44 E 10 links from a white Oak 20th Feb^y
and N 43 W from a red Oak 24th Feb^y
Red Oak down but stump still re-
mained at the time of making said
Survey -

present at time }
David Yoder }
Chas Brown }
Rich^d P. Swall }
Hugh Newell }

O. Hayes Sur. G. C.

Survey No. 628

9550

125

Surveyed May 26th
1848 on the application of Solomon
Proppis after his having given the nec-
essary notice to all the parties interes-
ted in said survey the East half of the
N.W. qr. of Section 23. T4. Range 13 E. Great
Miami R. to ascertain whether said
half qr contained a surplus above
Eighty seven acres and I find on survey-
ing said half qr. as follows viz. Begin-
ning at the centre stake of said Sect.
W. Oak 18 S. E. S 42 1/2 E 12 links distant thence
N 7 1/2 E 42.81 chains to a stone in a prairie
thence N 89 1/2 W 20.19.91 chains to a stake
in a field near a hickory stump
thence S 1/2 W 43.50 chains to a stake
and Blk. Oak 20 S. E. S 26 W 33 and
Blk. Oak 24 S. E. S 25 1/2 E. 35 links dist-
thence S 88 W 20 ch. to the beginning con-
taining 86.30 ¹⁰⁰ Acres. at 14 Poles from
the N.W. corner of said 1/2 qr. on
the west line put a stake in a field
and on the East line at 14 1/2 poles
from the N.E. corner placed an-
other stake as the S.E. corner to Solo-
mon Proppis lot.

R. R. Moore Esq

Geo. Cumins } ch. ers.

O. Hayes Sur. Gen.