

N. 29° W 20

Section Bitter Elm S.E. 1/4, T. 65 N. R. 29 W. <sup>links</sup> 29 Hickory  
4 S. S. ~~4 22 28~~ <sup>43 78 47</sup> 34 links, thence S 1/2 N 40. 87  
chains to the beginning containing 87.80 acres -  
This last piece was surveyed for H. D. Blinn  
further see plat hereto attached.

O. Hayes Sur. S. C. Ohio

Geo. W. Grindle  
Thos. S. Linker & others

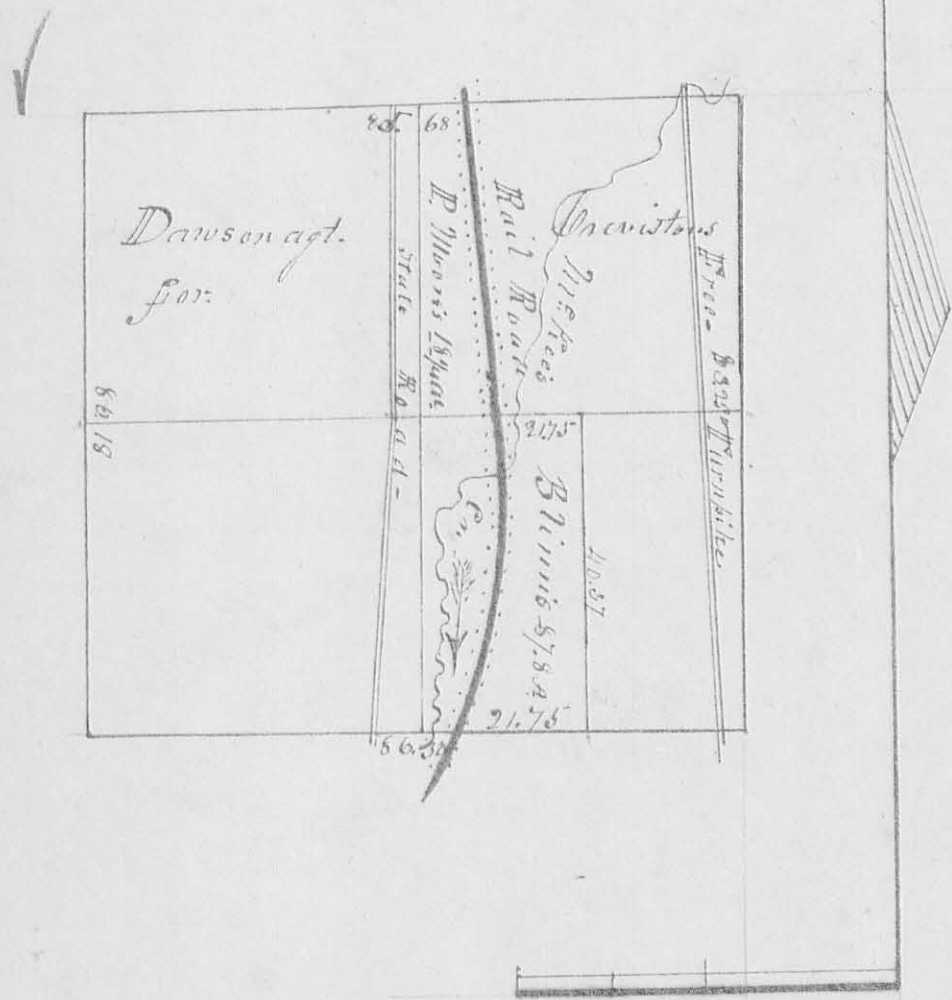

N.B. The above erasures were made on the  
27th May 1848 to correct an error made  
in taking the bearings and distances of  
those trees from the corners -  
O. Hayes S. C. Ohio