

84 6<sup>th</sup> mo. June 28<sup>th</sup> 1825. (2225) Survey No 108 84

Surveyed 137 1/4 acres of land for Daniel Stratton  
 Beginning at a buckeye divided into 3 trunks and  
 a black ash on the east bank of Beaver run a branch  
 of Darty's Creek, easterly corner of Philip Slaughter's  
 survey no 354, thence east with ~~the~~ the southerly  
 line of Slaughter's survey N 6 1/2° W 196 poles crossing  
 beaver run at 2 poles, a branch at 5 1/2 poles (either at  
 27 poles a drain at 170 poles) to a stone 2 dog woods and  
 beech stump on the easterly side of a drain - thence  
 S 38° E 115 poles passed a hickory and beech corner to  
 Joshua Sharp at 20 poles crossed Sharp's spring branch  
 at 27 poles, a drain at 30 poles, a branch at 40 poles  
 and a drain at 105 poles to 2 sugar trees and beech -  
 thence N 16 1/2° E 190 poles crossed beaver <sup>stone dog wood</sup>  
 run at 74 poles, and found a bur  
 oak white oak and black ash corner  
 5 poles northerly, hence the true bearing  
 of this line is N 45° E - thence N 38° W <sup>SB</sup>  
 passing an ash elm and buckeye  
 westerly corner to Warner's land, at  
 110 poles to the beginning contain-  
 ing 137 1/4 acs in the N. E. corner of  
 George McCredie's survey no 355. James Warner S. L. C.  
 Daniel Warner } 66  
 David Warner }

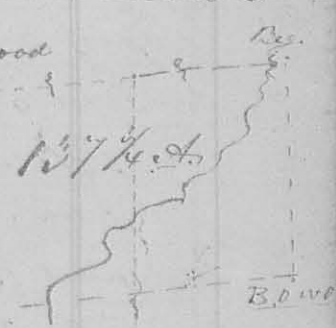

7<sup>th</sup> mo. July 7<sup>th</sup> 1825 Survey No 109

Surveyed 48 acres for James H. Blair and John Powell  
 Beginning at a stone in the road west of Bellefontaine in  
 the north of Sec. 34 Town. 4 Range 14 N. W. which stone  
 is the 90<sup>th</sup> Sec. corner and 160 poles from either of the north-  
 -erly corner of the Sec. thence west with said line and  
 road 50.6 poles - set a stake on each side of the road,  
 thence south 1° W. crossing a small branch at 57 poles  
 set a stake at 66 poles, crossing a branch at 84 poles,  
 94 poles to a stake - thence S 87 1/2° W 14 poles crossing