

DESCRIPTION

LYING IN SECTION 28, TOWN 5, RANGE 13, LIBERTY TOWNSHIP, LOGAN COUNTY, OHIO.

BEING ALL OF THE REMAINDER OF THE FOLLOWING EIGHT TRACTS WITH ALL DEED REFERENCED TO THE LOGAN COUNTY RECORDS OF DEEDS: WEST LIBERTY HOMES, INC. 4.30 ACRE TRACT, DEED VOLUME 384, PAGE 920, TRACT I; WEST LIBERTY HOMES, INC. 4.06 ACRE TRACT, DEED VOLUME 356, PAGE 30; WEST LIBERTY HOMES, INC. 2.36 ACRE TRACT, DEED VOLUME 384, PAGE 920, TRACT II; WEST LIBERTY HOMES, INC. 0.08 ACRE TRACT, DEED VOLUME 391, PAGE 864, TRACT I; WEST LIBERTY GARDEN APARTMENTS, INC. 6.20 ACRE TRACT, OFFICIAL RECORD 26, PAGE 106; WEST LIBERTY GARDENS APTS., INC. 4.08 ACRE TRACT, VOLUME 391, PAGE 867; WEST LIBERTY CARE CENTER, INC. ORIGINAL 19.70 ACRE TRACT, DEED VOLUME 352, PAGE 613; AND WEST LIBERTY CARE CENTER, INC. ORIGINAL 12.32 ACRE TRACT, DEED VOLUME 352, PAGE 474. THE COMBINED AREA OF THE ABOVE BEING MORE PARTICULARLY DESCRIBED FOR ANNEXATION PURPOSES AS FOLLOWS:

BEGINNING AT A POINT AT THE SOUTHWEST CORNER OF THE ROBERT RICHARD KING 6.40 ACRE TRACT (VOL. 356, PG. 19), THE CENTER-LINE OF U.S. ROUTE 68, AND ON AN EXISTING EAST CORPORATION LINE OF THE VILLAGE OF WEST LIBERTY, OHIO.

THENCE, WITH THE LINES OF THE SAID 6.40 ACRE TRACT THE FOLLOWING TWO COURSES:
 S 82°-37' E. A DISTANCE OF 796.72 FEET TO A POINT AT THE SOUTHEAST CORNER OF THE SAID 6.40 ACRE TRACT.
 N 3°-58' E. A DISTANCE OF 325.0 FEET TO A POINT.

THENCE, WITH THE SOUTH LINE OF THE ROBERTA MAE GRABER 32.291 ACRE TRACT (O.R. 56, PG. 181, TR. 3, 4, AND 5) THE FOLLOWING TWO COURSES:
 S 81°-43' E. A DISTANCE OF 450.12 FEET TO A POINT
 S 82°-58' E. A DISTANCE OF 929.28 FEET TO A POINT ON THE CENTER-LINE OF COUNTY HIGHWAY 5.

THENCE, WITH THE CENTER-LINE OF COUNTY HIGHWAY 5, S 13°-24' W. A DISTANCE OF 60.3 FEET TO A POINT.

THENCE, WITH THE LINES OF THE VERNON C. YODER 6.02 ACRE TRACT (VOL. 394, PG. 749) THE FOLLOWING TWO COURSES:
 N 82°-58' W. A DISTANCE OF 430.0 FEET TO A POINT.
 S 4°-25' W. A DISTANCE OF 1073.0 FEET TO A POINT.

THENCE, WITH THE LINES OF THE VIVIAN C. DODGE 13.66 ACRE TRACT (VOL. 395, PG. 751) THE FOLLOWING TWO COURSES:
 N 89°-54' W. A DISTANCE OF 927.50 FEET TO A POINT.
 S 3°-58' W. A DISTANCE OF 255.13 FEET TO A POINT.

THENCE, WITH THE CENTER-LINE OF U.S. ROUTE 68, N 44°-58'-30" W. A DISTANCE OF 65.69 FEET TO A POINT AT T.S. STATION 88+91.69.

THENCE, WITH THE CENTER-LINE OF U.S. ROUTE 68 ON A SPIRAL HAVING A DEGREE OF CURVATURE OF 3°-00'-00" TO THE RIGHT, A LENGTH OF 300.00 FEET, AND HAVING A CHORD BEARING N 43°-28'-31" W. A DISTANCE OF 299.92 FEET TO A POINT AT S.C. STATION 91+91.69.

THENCE, WITH THE CENTER-LINE OF U.S. ROUTE 68 ON A CURVE TO THE RIGHT HAVING A CENTRAL ANGLE OF 22°-58'-35", A RADIUS OF 1910.08 FEET AND A CHORD BEARING N 28°-59'-15" W. A DISTANCE OF 760.83 FEET TO A POINT AT C.S. STATION 99+57.52.

THENCE, WITH THE CENTER-LINE OF U.S. ROUTE 68 ON A SPIRAL HAVING A DEGREE OF CURVATURE OF 3°-00'-00" TO THE RIGHT, A LENGTH OF 300.00 FEET, AND HAVING A CHORD BEARING N 14°-29'-59" W. A DISTANCE OF 299.92 FEET TO A POINT AT S.T. STATION 102+57.52.

THENCE, WITH THE CENTER-LINE OF U.S. ROUTE 68 AND AN EXISTING CORPORATION LINE OF THE VILLAGE OF WEST LIBERTY, N 13°-00' W. A DISTANCE OF 66.6 FEET TO THE POINT OF BEGINNING.

CONTAINING 39.82 DEED ACRES.

LOGAN COUNTY COMMISSIONERS	<u>John A. Jeffery</u> <u>Donald E. Leavin</u>	<u>12-29-94</u> DATE <u>12-29-94</u> DATE
LOGAN COUNTY ENGINEER	<u>George W. Clayton</u>	<u>12-29-94</u> DATE <u>1-9-95</u> DATE
CHAIRMAN, TOWNSHIP TRUSTEES	<u>James K. Cox</u>	<u>12-21-95</u> DATE
L.U.C. PLANNING DIRECTOR	<u>Carman J. Jett</u>	<u>12-21-95</u> DATE
MAYOR OF WEST LIBERTY	<u>Richard L. Zerk</u>	<u>12-21-95</u> DATE
PRESIDENT, VILLAGE COUNCIL	<u>Steve M. Pullough</u>	<u>12-20-95</u> DATE
PLAT PRE-APPROVED	<u>Jon C. Hines</u>	<u>7-6-94</u> DATE
PLAT CHECKED	<u>Jon C. Hines</u>	<u>12-22-95</u> DATE
VILLAGE ORDINANCE NUMBER	<u>423</u>	
TRANSFERRED THIS	<u>26th</u> DAY OF <u>December</u> , 19 <u>95</u>	
LOGAN COUNTY AUDITOR	<u>Michael E. Godwin</u>	
RECEIVED FOR RECORD AT	<u>9:57:01</u> O'CLOCK <u>A.</u> M. <u>9508951</u>	
THIS	<u>26th</u> DAY OF <u>December</u> , 19 <u>95</u>	
LOGAN COUNTY RECORDER	<u>Carolyn Collins</u>	
RECORDED IN PLAT CABINET	<u>B</u> , SLIDE <u>4A</u>	

ANNEXATION MAP OF
 39.82 DEED ACRES TO THE
 VILLAGE OF WEST LIBERTY
 SECTION 28, TOWN 5, RANGE 13
 LIBERTY TOWNSHIP
 LOGAN COUNTY, OHIO

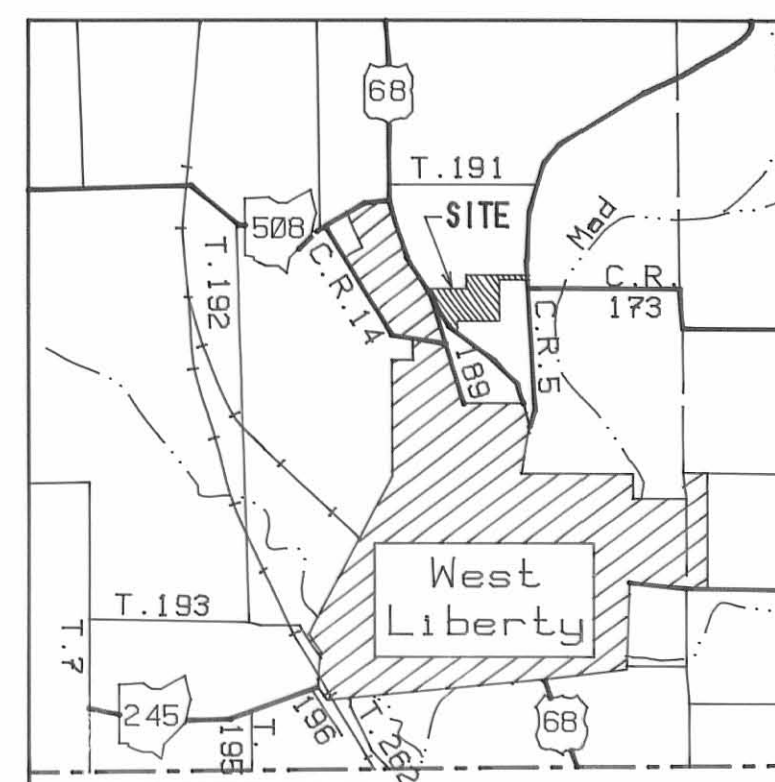

LEE SURVEYING & MAPPING CO.
 143 East Columbus Avenue
 BELLEFONTAINE, OHIO 43311
 (513) 593-7335

D 240 GHANNEX L-1456-1

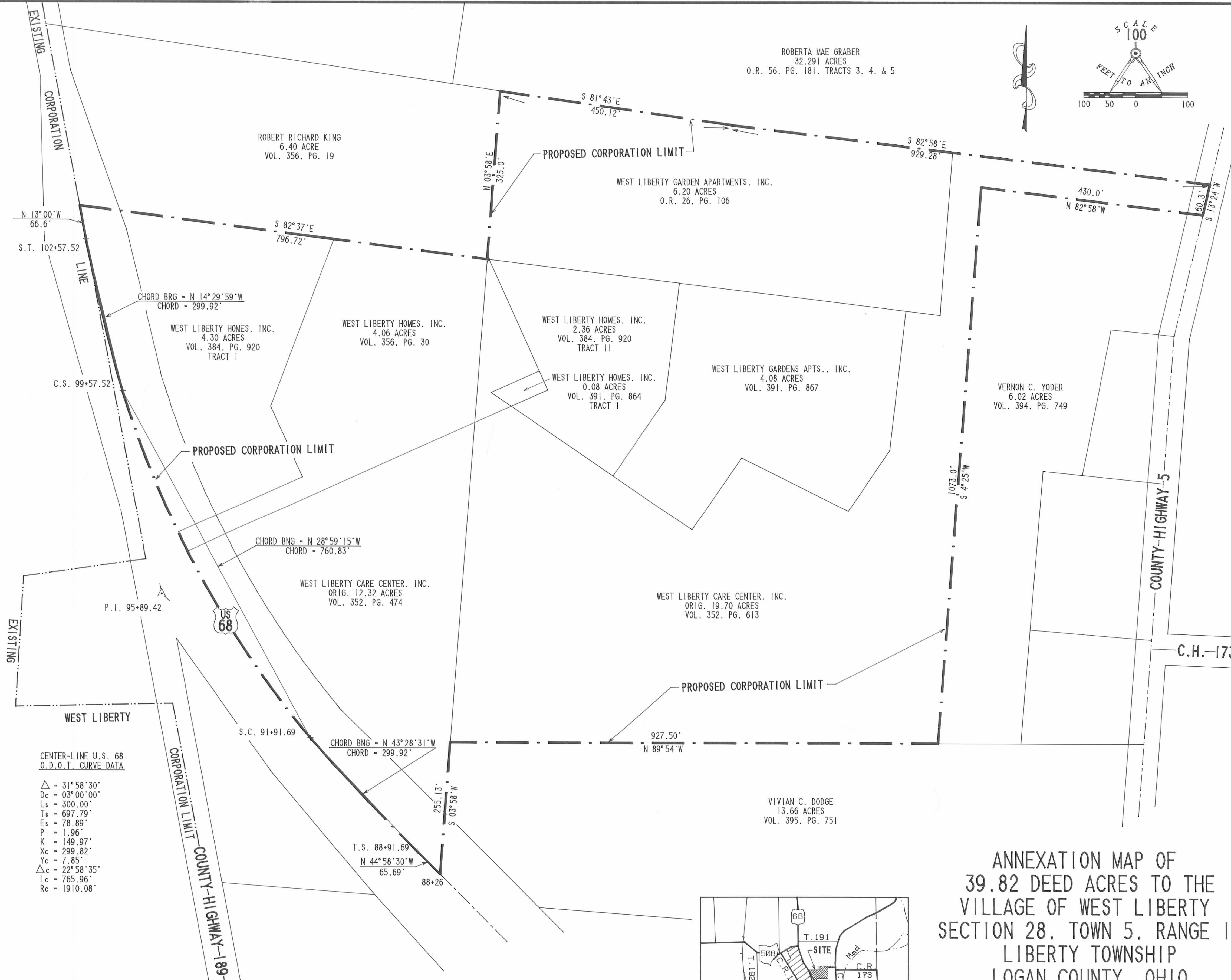

CENTER-LINE U.S. 68
 O.D.O.T. CURVE DATA
 Δ = 31° 58' 30"
 Dc = 03° 00' 00"
 Ls = 300.00'
 Ts = 697.79'
 Es = 78.89'
 P = 1.96'
 K = 149.97'
 Xc = 299.82'
 Yc = 7.85'
 Δc = 22° 58' 35"
 Lc = 765.96'
 Rc = 1910.08'

SURVEYOR'S AFFIDAVIT

THE ABOVE ANNEXATION MAP HAS BEEN PREPARED FROM RECORDS BY LEE SURVEYING AND MAPPING COMPANY.

BEARINGS ARE BASED UPON THE CENTER-LINE OF U.S. ROUTE 68, BEING N 13° 00' 00" W. AND ALL OTHER BEARINGS ARE FROM DEED RECORDS.

Jeffrey I. Lee
 JEFFREY I. LEE
 PROFESSIONAL SURVEYOR 6359





REC'D 3-12-99 SMY OK ✓

EDWARDS SURVEYING
110 SOUTH MAIN STREET
URBANA, OHIO 43078
(937) 653-6508

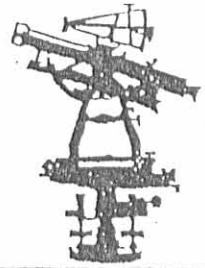

Page 1 of 2

LEGAL DESCRIPTION FOR WEST LIBERTY CARE CENTER, INC.'S
2.761 ACRES TRACT

Being situate in the State of Ohio, County of Logan, Village of West Liberty, Liberty Township and being a part of Section 28, Town 5, Range 13, and being more particularly described as follows;

Beginning at a railroad spike found on the centerline of County Road 5 (60' right-of-way) at the Northeast corner of a 6.02 acres tract conveyed to Vernon Yoder by Deed recorded in Deed Volume 394, Page 749 of the Logan County Deed Records;

- thence with the bounds of said Yoder's 6.02 acres tract, the following two (2) courses;
1. N-82°57'26"-W, 430.32'(feet) to a 5/8" diameter iron bar found 0.1'(feet) below grade, passing for reference an iron bar set on the right-of-way line of County Road 5 at 30.19'(feet);
 2. S-4°26'41"-W, 722.52'(feet) to an iron bar set;

thence N-85°33'19"-W, 255.78'(feet) to an iron bar set;

thence N-34°25'55"-E, 235.74'(feet) to an iron bar set at a corner of a 4.08 acres tract conveyed to West Liberty Garden Apartments, Inc., by Deed recorded in Deed Volume 391, Page 867 of the Logan County Deed Records, passing for reference the Southeast corner of said West Liberty Garden Apartments, Inc.'s, 4.08 acres tract at 93.74'(feet);

thence with the East line of said West Liberty Garden Apartments, Inc.'s, 4.08 acres tract, N-7°03'58"-E, 270.00'(feet) to an iron bar set on the South line of a 6.20 acres tract conveyed to West Liberty Garden Apartments, Inc.'s, by Deed recorded in Official Record Volume 26, Page 106 of the Logan County Records;

thence with the bounds of said West Liberty Garden Apartments, Inc.'s, 6.20 acres tract, the following two (2) courses;

1. S-82°56'02"-E, 65.71'(feet) to a 5/8" diameter iron bar found 0.1'(feet) below grade;
2. N-4°27'52"-E, 314.32'(feet) to a 1/2" diameter iron bar found projecting 0.4'(feet) above grade on the South line of an original 62.604 acres tract owned by Roberta Graber as recorded in Official Record Volume 56, Page 81 of the Logan County Records;

thence with the South line of said Graber's tract, S-82°57'31"-E, 499.64'(feet) to a Mag Nail set on the aforementioned centerline of County Road 5, passing for reference an iron bar set on the right-of-way line of County Road 5 at 469.45'(feet);

thence with the centerline of County Road 5, S-13°24'34"-W, 60.30'(feet) to the place of beginning.

Containing a total of 2.761 acres, 0.042 acre of which is within the road right-of-way, but being subject to the rights of all legal highways and all easements of record, including but not limited to an Ingress-Egress Easement herein reserved and described as follows;

Beginning at a railroad spike found on the centerline of County Road 5 (60' right-of-way) at the Northeast corner of a 6.02 acres tract conveyed to Vernon Yoder by Deed recorded in Deed Volume 394, Page 749 of the Logan County Deed Records;

- thence with the bounds of said Yoder's tract, the following two (2) courses;
1. N-82°57'26"-W, 430.32'(feet) to a 5/8" diameter iron bar found 0.1'(feet) below grade, passing for reference an iron bar set on the right-of-way line of County Road 5 at 30.19'(feet);
 2. S-4°26'41"-W, 289.37'(feet) to a point;

thence N-82°56'02"-W, 101.61'(feet) to a point;

8926 ID-1



EDWARDS SURVEYING
110 SOUTH MAIN STREET
URBANA, OHIO 43078
(937) 653-6508

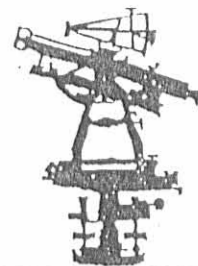

Page 2 of 2

thence S-4°26'41"-W, 300.54'(feet) to a point;

thence with a curve to the right, having a radius of 162.50'(feet), and a delta of 57°38'05", an arc distance of 163.46'(feet) to a point on the South line of the previously described 2.761 acres tract, the chord of which bears, S-33°15'39"-W, 156.66'(feet);

thence with the South line of the previously described 2.761 acres tract, N-85°33'19"-W, 78.77'(feet) an iron bar set;

thence with a curve to the left, having a radius of 137.50'(feet), and a delta of 86°34'26", an arc distance of 207.76'(feet) to a point, the chord of which bears, N-47°43'49"-E, 188.55'(feet);

thence N-4°26'41"-E, 317.13'(feet) to a point on the West line of the previously described 2.761 acres tract;

thence with the East line of said 2.761 acres tract, N-7°03'58"-E, 19.54'(feet) to an iron bar set on the South line of a 6.20 acres tract conveyed to West Liberty Garden Apartments, Inc.'s, by Deed recorded in Official Record Volume 26, Page 106 of the Logan County Records;

thence S-82°56'02"-E, 65.71'(feet) to a 5/8" diameter iron bar found 0.1'(feet) below grade at the Southeast corner of said West Liberty Garden Apartments, Inc.'s, 6.20 acres tract;

thence with the East line of said West Liberty Garden Apartments, Inc.'s, 6.20 acres tract, N-4°27'52"-E, 314.32'(feet) to a 1/2" diameter iron bar found projecting 0.4'(feet) above grade on the South line of an original 62.604 acres tract owned by Roberta Graber as recorded in Official Record Volume 56, Page 81 of the Logan County Records;

thence with the South line of said Graber's tract, S-82°57'31"-E, 499.64'(feet) to a Mag Nail set on the aforementioned centerline of County Road 5, passing for reference an iron bar set on the right-of-way line of County Road 5 at 469.45'(feet);

thence with the centerline of County Road 5, S-13°24'34"-W, 60.30'(feet) to the place of beginning.

Containing 1.406 acres.

Being a part of an original 19.70 acres tract conveyed to West Liberty Care Center, Inc. by Deed recorded in Deed Volume 352, Page 613 of the Logan County Deed Records.

The herein described 2.761 acres tract is to be attached to the mentioned existing and adjoining 4.08 acres tract owned by West Liberty Garden Apartments, Inc. as recorded in Deed Volume 391, Page 867 of the Logan County Deed Records, and is not to be used as a separate and independent parcel.

The foregoing description prepared by and in accordance with a field survey by William D. Edwards, Professional Surveyor No. 7574, March 5, 1999. All iron bars set are 5/8"x30" iron rebar with a yellow plastic cap stamped "EDWARDS PS 4792 PS 7574". The basis of bearings for the herein described tract is the centerline of County Road 5 per an assumed bearing of S-13°24'34"-W.





WILLIAM D. EDWARDS
PROFESSIONAL SURVEYOR No. 7574

8926 ID-2

PLAT OF SURVEY
VILLAGE OF WEST LIBERTY
LOGAN COUNTY, OHIO
SECTION 28, TOWN 5, RANGE 13

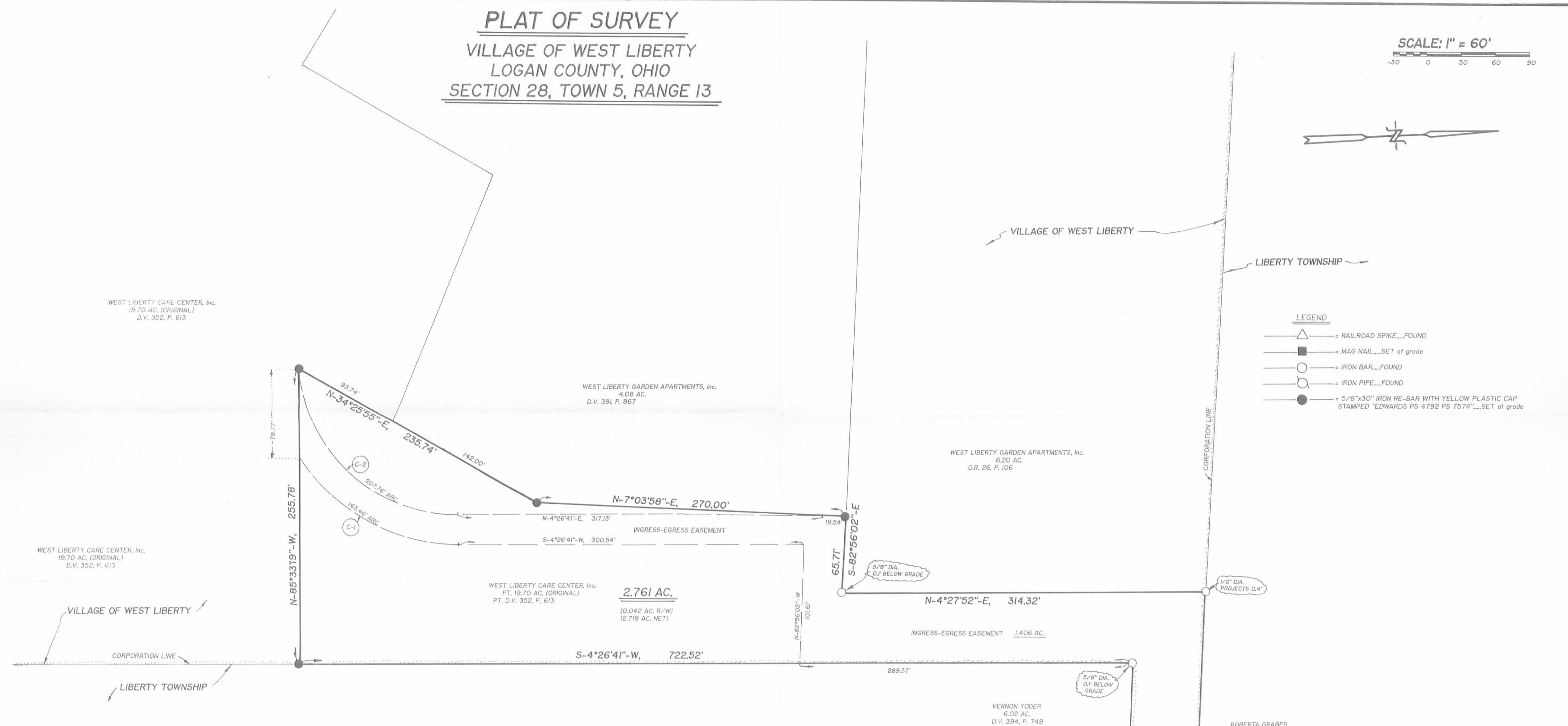
SCALE: 1" = 60'



- LEGEND**
- = RAILROAD SPIKE...FOUND
 - = MAG NAIL...SET at grade
 - = IRON BAR...FOUND
 - = IRON PIPE...FOUND
 - = 5/8" x 30" IRON RE-BAR WITH YELLOW PLASTIC CAP STAMPED "EDWARDS PS 4792 PS 7574"...SET at grade

CURVE DATA				
CURVE	RADIUS	DELTA	ARC	CHORD
C-1	162.50'	57°38'05"	163.46'	S-33°15'39"-W, 156.66'
C-2	137.50'	86°34'26"	207.76'	N-47°43'49"-E, 188.55'

- NOTE:**
- BEARINGS ARE BASED ON THE CENTERLINE OF COUNTY ROAD 5 PER AN ASSUMED BEARING OF S-13°24'34"-W.
 - THE 2.761 AC. TRACT, SHOWN HEREON, IS TO BE ATTACHED TO THE ADJOINING 4.08 AC. TRACT OWNED BY WEST LIBERTY GARDEN APARTMENT, Inc..
 - AN EASEMENT FOR INGRESS AND EGRESS IS HEREON RESERVED AS DEPICTED ON THIS PLAT.
 - REFERENCES USED: DEED OF SUBJECT PREMISES, DEEDS OF ADJOINING PARCELS, COUNTY TAX MAPS, PLATS OF SURVEYS IN THE VICINITY.



SURVEYED BY: *W.D. Edwards*
 WILLIAM D. EDWARDS
 PROFESSIONAL SURVEYOR No. 7574
 110 SOUTH MAIN STREET
 URBANA, OHIO 43078
 (937)653-6508

DATE: MARCH 5, 1999

INDEXED BY: 8926 IP





**KUSMER &
ASSOCIATES, INC.**

Architects

Engineers

Surveyors

**LEGAL DESCRIPTION FOR A 11.0297 ACRE PARCEL
FOR GREEN HILLS RETIREMENT COMMUNITY
PARCEL ONE (1)**

Being a parcel of land situated in Section Twenty-Eight (28), Town-Five (5), Range-Thirteen (13) in the Village of West Liberty, Liberty Township, Logan County, Ohio described as follows:

- 1.) Commencing at a found 1" square iron rod on the centerline intersection of Township Road One Hundred Ninety-One (191) (40' R/W) and County Road Five (5) (60' R/W);
- 2.) thence S 11° 52' 34" W one thousand eighty-five and seven hundredths (1085.07) feet along the centerline of County Road Five (5) (60' R/W) to a found PK nail;
- 3.) thence S 12° 02' 49" W sixty and thirty hundredths (60.30) feet along the centerline of County Road Five (5) (60' R/W) to a found railroad spike, said line also being along the West Liberty Corporation line;
- 4.) thence N 84° 32' 01" W four hundred thirty and thirty-two hundredths (430.32) feet along the north line of a 6.02 acre parcel now or formerly owned by Vernon R. Yoder, etal (Vol. 394, Pg. 749) to a found 5/8" iron rod, passing at thirty and four hundredths (30.04) feet a found 1/2" iron rod on line, said line also being along the West Liberty Corporation line;

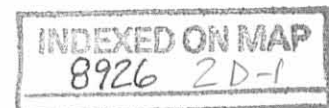

- 5.) thence S 02° 53' 37" W one thousand seventy-one and seventy-three hundredths (1071.73) feet along the west line of a 6.02 acre parcel of land now or formerly owned by Vernon R. Yoder, etal (Vol. 394, Pg. 749) to a found 6" wood post, passing at seven hundred twenty-two and fifty-two hundredths (722.52) feet a found 1/2" iron rod on line, said line also being along the West Liberty Corporation line;
- 6.) thence S 88° 39' 03" W three hundred sixty-eight and thirty-seven hundredths (368.37) feet along the north line of a 13.66 acre parcel of land now or formerly owned by West Liberty Care Center, Inc. (OR Vol. 895, Pg. 336) to a set 5/8" iron rod marking the POINT OF BEGINNING, said line also being along the West Liberty Corporation line;
- 7.) thence S 88° 39' 03" W five hundred sixty-one and thirty hundredths (561.30) feet along the north line of a 13.66 acre parcel of land now or formerly owned by West Liberty Care Center, Inc. (OR Vol. 895, Pg. 336) to a found 6" wood post, said line also being along the West Liberty Corporation line;
- 8.) thence S 01° 34' 47" W two hundred fifty-eight and eighty-six hundredths (258.86) feet along the west line of a 13.66 acre parcel of land now or formerly owned by West Liberty Care Center, Inc. (OR Vol. 895, Pg. 336) to a point on the centerline of U.S. Route Sixty-Eight (68) (R/W Varies), passing at one hundred thirty-seven and fifty-seven hundredths (137.57) feet a found 6" wood fence post on the easterly right-of-way of U.S. Route Sixty-Eight (68) (R/W varies), said line also being along the West Liberty Corporation line;
- 9.) thence N 46° 19' 35" W sixty-nine and thirty-seven hundredths (69.37) feet along the centerline of U.S. Route Sixty-Eight (68) (R/W Varies) to a point, said point being on the beginning of a spiral concaving to the northeast, said line also being along the West Liberty Corporation line;

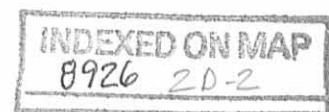

- 10.) thence northwesterly along the spiral curve through a spiral angle of $04^{\circ} 30' 00''$ having a spiral length of three hundred (300.00) feet and a chord bearing of $N 44^{\circ} 49' 38'' W$, a chord length of two hundred ninety-nine and ninety-two hundredths (299.92) feet to a point on the beginning of a curve concaving to the northeast having a radius of one thousand nine hundred nine and eighty-six hundredths (1909.86) feet, said line also being the centerline of U.S. Route Sixty-Eight (68) (R/W Varies), said line also being along the West Liberty Corporation line;
- 11.) thence northwesterly along the curve through a central angle of $12^{\circ} 57' 06''$ having an arc length of four hundred thirty-one and seventy-two hundredths (431.72) feet and a chord bearing of $N 35^{\circ} 21' 02'' W$ and a chord length of four hundred thirty and eighty hundredths (430.80) feet to a point, said line also being the centerline of U.S. Route Sixty-Eight (68) (R/W Varies), said line also being along the West Liberty Corporation line;
- 12.) thence $N 64^{\circ} 12' 26'' E$ five hundred forty-four and twenty-one hundredths (544.21) feet along the south line of a 4.06 acre parcel of land now or formerly owned by West Liberty Homes, Inc. (Vol. 356, Pg. 30) to a found $1/2''$ iron rod, passing at eighty and twelve hundredths (80.12) feet a found $1/2''$ iron rod on the easterly right-of-way of U.S. Route Sixty-Eight (68) (R/W Varies);
- 13.) thence $S 88^{\circ} 28' 34'' E$ one hundred seventy-six and seventy hundredths (176.70) feet along the south line of a 2.36 acre parcel of land now or formerly owned by West Liberty Homes, Inc. (Vol. 384, Pg. 920, Tract II) to a found $1/2''$ iron rod;

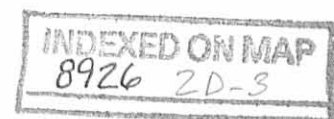

- 14.) thence S 57° 07' 34" E two hundred forty-three (243.00) feet along the south lines of a 2.36 acre parcel of land now or formerly owned by West Liberty Homes, Inc. (Vol. 384, Pg. 920, Tract II) and a 4.08 Acre parcel of land now or formerly owned by West Liberty Garden Apts. (Vol. 391, Pg. 867) to a set 5/8" iron rod;
- 15.) thence S 25° 20' 08" E four hundred eighty-seven and six hundredths (487.06) feet to the POINT OF BEGINNING.

Containing in all 11.0297 acres of land more or less, subject to all legal highways and easements.

1.4237 Acres in the Right-of-Way

The size of all set iron rods is 5/8" X 30".

The above described 11.0297 acre tract being all of the remainder of the 12.32 acre tract owned by West Liberty Care Center, Inc. (Vol. 352, Pg. 474) and part of the 19.70 acre tract (Vol. 352, Pg. 613).

The bearings are based on the centerline of County Road 5 (S 11° 52' 34" W) and for angular measurements only.

This legal description is based upon a survey performed for Green Hills Retirement Community by W. Robert Kusmer, P.S. # 6754 of Kusmer & Associates, Inc. in November, 2009.

December 3, 2009
Job No. 09071-S
WRK/blk

File: 09071a.leg



W Robert Kusmer
12/3/2009

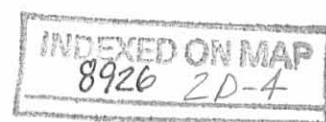



**KUSMER &
ASSOCIATES, INC.**

Architects

Engineers

Surveyors

**LEGAL DESCRIPTION FOR A 4.7189 ACRE PARCEL
FOR GREEN HILLS RETIREMENT COMMUNITY
PARCEL TWO (2)**

Being a parcel of land situated in Section Twenty-Eight (28), Town-Five (5), Range-Thirteen (13) in the Village of West Liberty, Liberty Township, Logan County, Ohio described as follows:

- 1.) Commencing at a found 1" square iron rod on the centerline intersection of Township Road One Hundred Ninety-One (191) (40' R/W) and County Road Five (5) (60' R/W);
- 2.) thence S 11° 52' 34" W one thousand eighty-five and seven hundredths (1085.07) feet along the centerline of County Road Five (5) to a found PK nail;
- 3.) thence S 12° 02' 49" W sixty and thirty hundredths (60.30) feet along the centerline of County Road Five (5) to a found railroad spike, said line also being along the West Liberty Corporation line;
- 4.) thence N 84° 32' 01" W four hundred thirty and thirty-two hundredths (430.32) feet along the north line of a 6.02 acre parcel now or formerly owned by Vernon Yoder, etal (Vol. 394, Pg. 749) to a found 5/8" iron rod, passing at thirty and four hundredths (30.04) feet a found 1/2" iron rod on line, said line also being along the West Liberty Corporation line;
- 5.) thence S 02° 53' 37" W seven hundred twenty-two and fifty-two hundredths (722.52) feet along the west line of a 6.02 acre parcel of land now or formerly owned by Vernon R. Yoder, etal (Vol. 394, Pg. 749) to a found 1/2" iron rod marking the POINT OF BEGINNING, said line also being along the West Liberty Corporation line;

622 West State Street • Fremont, Ohio 43420 • Phone 419-332-1027 • Fax 419-332-7056
kusmer.associates@sbcglobal.net www.kusmerassociates.com

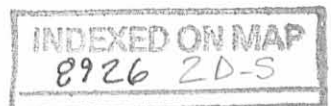

- 6.) thence S 02° 53' 37" W three hundred forty-nine and twenty-one hundredths (349.21) feet along the west line of a 6.02 acre parcel of land now or formerly owned by Vernon R. Yoder, etal (Vol. 394, Pg. 749) to a found 6" wood post, said line also being along the West Liberty Corporation line;
- 7.) thence S 88° 39' 03" W three hundred sixty-eight and thirty-seven hundredths (368.37) feet along the north line of a 13.66 acre parcel of land now or formerly owned by West Liberty Care Center, Inc. (OR Vol. 895, Pg. 336) to a set 5/8" iron rod, said line also being along the West Liberty Corporation line;
- 8.) thence N 25° 20' 08" W four hundred eighty-seven and six hundredths (487.06) feet to a set 5/8" iron rod;
- 9.) thence S 57° 07' 34" E ninety-seven (97.00) feet along the south line of a 4.08 acre parcel of land now or formerly owned by West Liberty Garden Apts., Inc. (Vol. 391, Pg. 867) to a found 1/2" iron rod;
- 10.) thence N 32° 52' 26" E one hundred ninety (190.00) feet along the southerly line of a 4.08 acre parcel of land now or formerly owned by West Liberty Garden Apts., Inc. (Vol. 391, Pg. 867) to a found 1/2" iron rod;
- 11.) thence S 64° 31' 32" E two hundred twenty-seven and fifty-nine hundredths (227.59) feet along the southerly line of a 4.08 acre parcel of land now or formerly owned by West Liberty Garden Apts., Inc. (Vol. 391, Pg. 867) to a found 1/2" iron rod;
- 12.) thence S 32° 58' 50" W ninety-four and five hundredths (94.05) feet along the westerly line of a 2.761 acre parcel of land now or formerly owned by West Liberty Garden Apts., Inc. (OR 413, Pg. 735) to a found 1/2" iron rod;

13.) thence S 87° 06' 23" E two hundred fifty-five and seventy-eight hundredths (255.78) feet along the south line of a 2.761 acre parcel of land now or formerly owned by West Liberty Garden Apts., Inc. (OR 413, Pg. 735) to the POINT OF BEGINNING.

Containing in all 4.7189 acres of land more or less, subject to all legal highways and easements.

The size of all set iron rods is 5/8" X 30".

The above described 4.7189 acre tract being part of the 19.70 acre parcel of land owned by West Liberty Care Center, Inc. (Vol. 352, Pg. 613).

The bearings are based on the centerline of County Road 5 (S 11° 52' 34" W) and for angular measurements only.

This legal description is based upon a survey performed for Green Hills Retirement Community by W. Robert Kusmer, P.S. # 6754 of Kusmer & Associates, Inc. in November, 2009.

December 3, 2009
Job No. 09071-S
WRK/blk

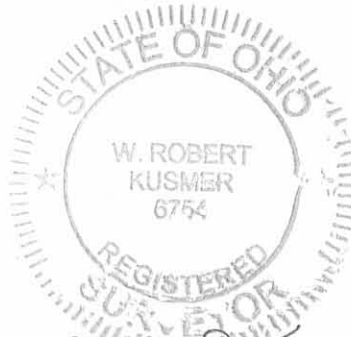

File: 09071B.leg

W Robert Kusmer
12/3/2009

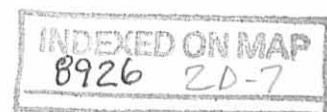



**KUSMER &
ASSOCIATES, INC.**

Architects

Engineers

Surveyors

**LEGAL DESCRIPTION FOR A 15.7486 ACRE PARCEL
FOR GREEN HILLS RETIREMENT COMMUNITY**

Being a parcel of land situated in Section Twenty-Eight (28), Town-Five (5), Range-Thirteen (13) in the Village of West Liberty, Liberty Township, Logan County, Ohio described as follows:

- 1.) Commencing at a found 1" square iron rod on the centerline intersection of Township Road One Hundred Ninety-One (191) (40' R/W) and County Road Five (5) (60' R/W);
- 2.) thence S 11° 52' 34" W one thousand eighty-five and seven hundredths (1085.07) feet along the centerline of County Road Five (5) to a found PK nail;
- 3.) thence S 12° 02' 49" W sixty and thirty hundredths (60.30) feet along the centerline of County Road Five (5) to a found railroad spike, said line also being the West Liberty Corporation line;
- 4.) thence N 84° 32' 01" W four hundred thirty and thirty-two hundredths (430.32) feet along the north line of a 6.02 acre parcel of land owned by Vernon R. Yoder, etal (Vol. 394, Pg. 749) to a found 5/8" iron rod, passing at thirty and four hundredths (30.04) feet a found 1/2" iron rod on said line, said line being along the West Liberty Corporation line;
- 5.) thence S 02° 53' 37" W seven hundred twenty-two and fifty-two hundredths (722.52) feet along the west line of a 6.02 acre parcel now or formerly owned by Vernon R. Yoder, etal (Vol. 394, Pg. 749) to a found 1/2" iron rod marking the POINT OF BEGINNING, said line also being the West Liberty Corporation line;

622 West State Street • Fremont, Ohio 43420 • Phone 419-332-1027 • Fax 419-332-7056
kusmer.associates@sbcglobal.net www.kusmerassociates.com

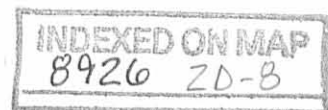

- 6.) thence S 02° 53' 37" W three hundred forty-nine and twenty-one hundredths (349.21) feet along the west line of a 6.02 acre parcel now or formerly owned by Vernon R. Yoder, etal (Vol. 394, Pg. 749) to a found 6" wood fence post, said line also being along the West Liberty Corporation line;
- 7.) thence S 88° 39' 03" W nine hundred twenty-nine and sixty-seven hundredths (929.67) feet along the north line of a 13.66 acre parcel of land owned by West Liberty Care Center, Inc. (OR Vol. 895, Pg. 336) to a found 6" wood fence post, said line also being along the West Liberty Corporation line;
- 8.) thence S 01° 34' 47" W two hundred fifty-eight and eighty-six hundredths (258.86) feet along the west line of a 13.66 acre parcel of land now or formerly owned by West Liberty Care Center, Inc. (OR Vol. 895, Pg. 336) to a point on the centerline of U.S. Route Sixty-Eight (68) (R/W Varies), passing at one hundred thirty-seven and fifty-seven hundredths (137.57) feet a found 6" wood fence post on the easterly right-of-way of U.S. Route Sixty-Eight (68) (R/W Varies), said line also being along the West Liberty Corporation line;
- 9.) thence N 46° 19' 35" W sixty-nine and thirty-seven hundredths (69.37) feet along the centerline of U.S. Route Sixty-Eight (68) (R/W Varies) to a point, said point being on the beginning of a spiral curve concaving to the northeast, said line being along the West Liberty Corporation line;
- 10.) thence northwesterly along the spiral curve through a spiral angle of 04° 30' 00" having a spiral length of three hundred (300.00) feet and a chord bearing of N 44° 49' 38" W, a chord length of two hundred ninety-nine and ninety-two hundredths (299.92) feet to a point on the beginning of a curve concaving to the northeast having a radius of one thousand nine hundred nine and eighty-six hundredths (1909.86) feet, said line also being the centerline of U.S. Route Sixty-Eight (68) (R/W Varies), said line also being along the West Liberty Corporation line;

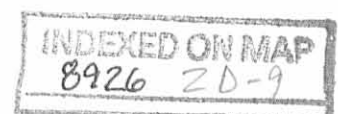

- 11.) thence northwesterly along the curve through a central angle of $12^{\circ} 57' 06''$ having an arc length of four hundred thirty-one and seventy-two hundredths (431.72) feet and a chord bearing of $N 35^{\circ} 21' 02'' W$ and a chord length of four hundred thirty and eighty hundredths (430.80) feet to a point, said line also being the centerline of U.S. Route Sixty-Eight (68) (R/W Varies), said line also being along the West Liberty Corporation line;
- 12.) thence $N 64^{\circ} 12' 26'' E$ five hundred forty-four and twenty-one hundredths (544.21) feet along the south line of a 4.06 acre parcel of land owned by West Liberty Homes, Inc. (Vol. 356, Pg. 30) to a found $1/2''$ iron rod, passing at eighty and twelve hundredths (80.12) feet a found $1/2''$ iron rod on the easterly right-of-way of U.S. Route Sixty-Eight (68) (R/W Varies);
- 13.) thence $S 88^{\circ} 28' 34'' E$ one hundred seventy-six and seventy hundredths (176.70) feet along the south line of a 2.36 acre parcel of land now or formerly owned by West Liberty Homes, Inc. (Vol. 384, Pg. 920, Tract II) to a found $1/2''$ iron rod;
- 14.) thence $S 57^{\circ} 07' 34'' E$ two hundred forty-three (243.00) feet along the south lines of a 2.36 acre parcel of land now or formerly owned by West Liberty Homes, Inc. (Vol. 384, Pg. 920, Tract II) and a 4.08 acre parcel of land now or formerly owned by West Liberty Garden Apts., Inc. (Vol. 391, Pg. 867) to a found $1/2''$ iron rod, passing at one hundred forty-six (146.00) feet a set iron rod on line;
- 15.) thence $N 32^{\circ} 52' 26'' E$ one hundred ninety (190.00) feet along the south line of a 4.08 acre parcel of land now or formerly owned by West Liberty Garden Apts., Inc. (Vol. 391, Pg. 867) to a found $1/2''$ iron rod;

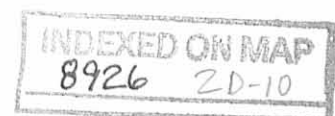

- 16.) thence S 64° 31' 32" E two hundred twenty-seven and fifty-nine hundredths (227.59) feet along the south line of a 4.08 acre parcel of land now or formerly owned by West Liberty Garden Apts., Inc. (Vol. 391, Pg. 867) to a found 1/2" iron rod;
- 17.) thence S 32° 58' 50" W ninety-four and five hundredths (94.05) feet along the westerly line of a 2.761 acre parcel of land owned by West Liberty Garden Apts., Inc. (OR 413, Pg. 735) to a found 1/2" iron rod;
- 18.) thence S 87° 06' 23" E two hundred fifty-five and seventy-eight hundredths (255.78) feet along the southerly line of a 2.761 acre parcel of land now or formerly owned by West Liberty Garden Apts., Inc. (OR 413, Pg. 735) to the POINT OF BEGINNING.

Containing in all 15.7486 acres of land more or less, subject to all legal highways and easements.

1.4237 Acres in the Right-of-Way

The size of all set iron rods is 5/8" X 30".

The above described 15.7486 acres being all of the remainder of the West Liberty Care Center, Inc., 12.32 acre tract described in Vol. 352, Pg. 474 and 19.70 acre tract described in Vol. 352, Pg. 613.

The bearings are based on the centerline of County Road 5 (S 11° 52' 34" W) and for angular measurements only.

This legal description is based upon a survey performed for Green Hills Retirement Community by W. Robert Kusmer P.S. # 6754 of Kusmer & Associates, Inc. in April, 2002.

December 3, 2009
 Job No. 02048-S
 WRK/blk

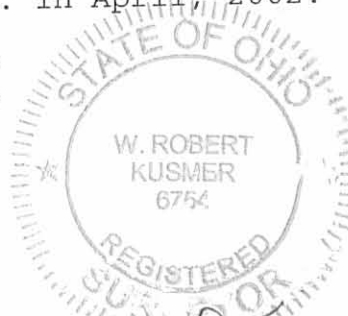

*W Robert Kusmer
 12/3/2009*

File: 02048S.leg

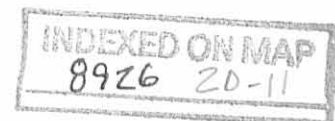

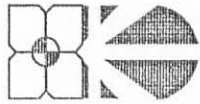

**KUSMER &
ASSOCIATES, INC.**

Architects

Engineers

Surveyors

**LEGAL DESCRIPTION FOR A 0.5324 ACRE PARCEL
FOR GREEN HILLS RETIREMENT COMMUNITY
DRAINAGE AREA EASEMENT**

Being a drainage area easement situated in Section Twenty-Eight (28), Town-Five (5), Range-Thirteen (13) in the Village of West Liberty, Liberty Township, Logan County, Ohio described as follows:

- 1.) Commencing at a found 1" square iron rod on the centerline intersection of Township Road One Hundred Ninety-One (191) (40' R/W) and County Road Five (5) (60' R/W);
- 2.) thence S 11° 52' 34" W one thousand eighty-five and seven hundredths (1085.07) feet along the centerline of County Road Five (5) to a found PK nail;
- 3.) thence S 12° 02' 49" W sixty and thirty hundredths (60.30) feet along the centerline of County Road Five (5) to a found railroad spike, said line also being along the West Liberty Corporation line;
- 4.) thence N 84° 32' 01" W four hundred thirty and thirty-two hundredths (430.32) feet along the north line of a 6.02 acre parcel now or formerly owned by Vernon Yoder, etal (Vol. 394, Pg. 749) to a found 5/8" iron rod, passing at thirty and four hundredths (30.04) feet a found 1/2" iron rod on line, said line also being along the West Liberty Corporation line;

- 5.) thence S 02° 53' 37" W one thousand seventy-one and seventy-three hundredths (1071.73) feet along the west line of a 6.02 acre parcel of land now or formerly owned by Vernon R. Yoder, etal (Vol. 394, Pg. 749) to a found 6" wood post, said line also being along the West Liberty Corporation line, passing at seven hundred twenty-two and fifty-two hundredths (722.52) feet a found 1/2" iron rod;
- 6.) thence S 88° 39' 03" W three hundred sixty-eight and thirty-seven hundredths (368.37) feet along the north line of a 13.66 acre parcel of land now or formerly owned by West Liberty Care Center, Inc. (OR Vol. 895, Pg. 336) to a set 5/8" iron rod, said line also being along the West Liberty Corporation line;
- 7.) thence N 25° 20' 08" W twenty-eight (28.00) feet to the POINT OF BEGINNING;
- 8.) thence N 25° 20' 08" W two hundred fifty and ninety-two hundredths (250.92) feet to a point;
- 9.) thence S 45° 55' 03" E one hundred ten (110.00) feet to a point;
- 10.) thence N 44° 04' 57" E twenty (20.00) feet to a point;
- 11.) thence S 62° 41' 12" E one hundred ten (110.00) feet to a point;
- 12.) thence S 37° 01' 54" E one hundred ten (110.00) feet to a point;
- 13.) thence S 44° 44' 40" W forty-five (45.00) feet to a point;
- 14.) thence N 87° 16' 01" W one hundred eighteen (118.00) feet to the POINT OF BEGINNING.

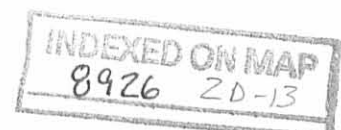

Containing in all 0.5324 acres of land more or less,
subject to all legal highways and easements.

The size of all set iron rods is 5/8" X 30".

The above described 0.5324 acre easement being part of
the 19.70 acre parcel of land owned by West Liberty Care
Center, Inc. (Vol. 352, Pg. 613).

The bearings are based on the centerline of County Road
5 (S 11° 52' 34" W) and for angular measurements only.

This legal description is based upon a survey performed
for Green Hills Retirement Community by W. Robert Kusmer,
P.S. # 6754 of Kusmer & Associates, Inc. in November,
2009.

December 3, 2009
Job No. 09071-S
WRK/blk



W Robert Kusmer
12/3/2009

File: 09071c.leg

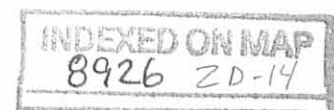

REV'D 12-7-09 SWM &c

X:\DWG\Green Hills Center-SR66-01043E\090715\good.dwg <Plot Device>: D:\cadd\ <Plot Device>: D:\cadd\ <Page Size>: ANSI Expanded D (34.00 X 22.00 Inches)

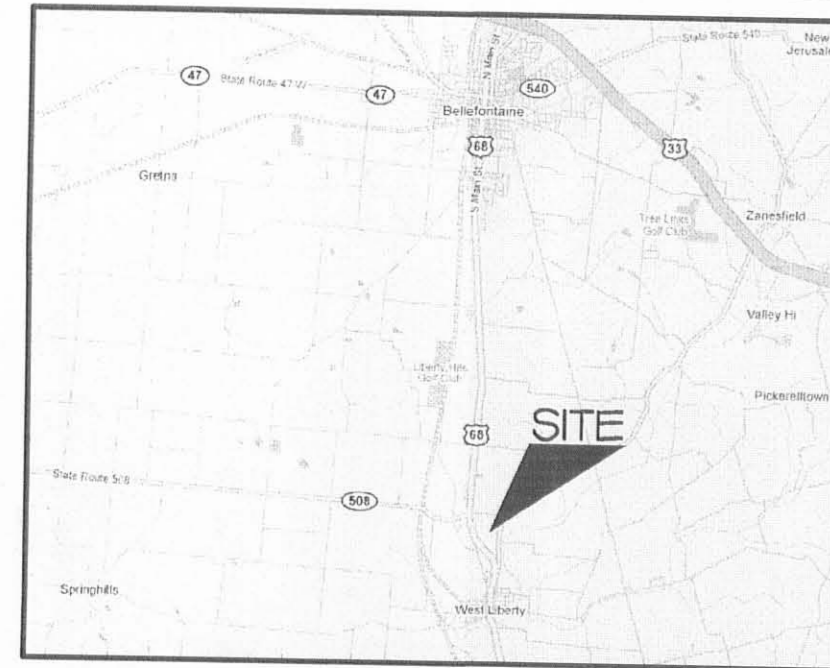

VICINITY MAP

T.R. 191 (40' R/W) (LIBERTY TWP. - PUBLIC)

REFERENCES

DEEDS AS SHOWN.
SURVEY FOR GREEN HILLS RETIREMENT COMMUNITY BY KUSMER & ASSOC., INC., APRIL 2002.
LAWYERS TITLE INSURANCE CORPORATION COMMITMENT FOR TITLE INSURANCE ORDER NUMBER: 2888207, REFERENCE NUMBER: 09-38318, EFFECTIVE DATE: JULY 14, 2009 AT 6:59 A.M.

EASEMENTS

8. EASEMENT FOR HIGHWAY PURPOSES TO THE STATE OF OHIO, FILED FOR RECORD OCTOBER 20, 1954, IN VOLUME 224, PAGE 524. (NORTH OF PROPERTY.)
9. EASEMENT FOR HIGHWAY PURPOSES TO THE STATE OF OHIO, FILED FOR RECORD OCTOBER 20, 1954, IN VOLUME 224, PAGE 530. (ORIGINAL HIGHWAY.)
10. EASEMENT FOR HIGHWAY PURPOSES TO THE STATE OF OHIO, FILED FOR RECORD OCTOBER 20, 1954, IN VOLUME 224, PAGE 533. (SOUTH OF PROPERTY.)
11. EASEMENT TO THE OHIO BELL TELEPHONE COMPANY, FILED FOR RECORD FEBRUARY 28, 1955, IN VOLUME 226, PAGE 545. (2' EAST OF R/W.)
12. EASEMENT TO THE DAYTON POWER AND LIGHT COMPANY, FILED FOR RECORD AUGUST 24, 1961, IN VOLUME 276, PAGE 13. APPROXIMATE LOCATION. COMMENCING POINT UNCLEAR.
13. EASEMENT TO THE OHIO BELL TELEPHONE COMPANY, FILED FOR RECORD NOVEMBER 3, 1971, IN VOLUME 337, PAGE 654. NORTH OF PROPERTY.
14. EASEMENT TO THE DAYTON POWER AND LIGHT COMPANY, FILED FOR RECORD NOVEMBER 15, 1974, IN VOLUME 356, PAGE 132. (SAME AS 16.)
15. EASEMENT TO THE DAYTON POWER AND LIGHT COMPANY, FILED FOR RECORD OCTOBER 19, 1976, IN VOLUME 367, PAGE 90. (SAME AS 22.)
16. EASEMENT TO THE DAYTON POWER AND LIGHT COMPANY, FILED FOR RECORD NOVEMBER 15, 1974, IN VOLUME 388, PAGE 350.
17. RESERVATIONS, RESTRICTIONS, COVENANTS, LIMITATIONS, EASEMENTS AND/OR CONDITIONS, AS ESTABLISHED IN INSTRUMENT, FILED FOR RECORD FEBRUARY 17, 1976, IN VOLUME 362, PAGE 227.
18. RESERVATIONS, RESTRICTIONS, COVENANTS, LIMITATIONS, EASEMENTS AND/OR CONDITIONS, AS ESTABLISHED IN INSTRUMENT, FILED FOR RECORD APRIL 22, 1981, IN VOLUME 391, PAGE 862.
19. RESERVATIONS, RESTRICTIONS, COVENANTS, LIMITATIONS, EASEMENTS AND/OR CONDITIONS, AS ESTABLISHED IN INSTRUMENT, FILED FOR RECORD APRIL 22, 1981, IN VOLUME 391, PAGE 864.
20. RESERVATIONS, RESTRICTIONS, COVENANTS, LIMITATIONS, EASEMENTS AND/OR CONDITIONS, AS ESTABLISHED IN INSTRUMENT, FILED FOR RECORD APRIL 23, 1981, IN VOLUME 391, PAGE 867.
21. EASEMENT TO UNITED TELEPHONE COMPANY OF OHIO, FILED FOR RECORD OCTOBER 1, 1982, IN O.R. VOLUME 170, PAGE 399. (10' BY 100')
22. EASEMENT TO THE DAYTON POWER AND LIGHT COMPANY, FILED FOR RECORD MARCH 10, 1988, IN O.R. VOLUME 58, PAGE 90. APPROXIMATE LOCATION. DIFFICULT TO READ. (SAME AS 15.)
23. RESERVATIONS, RESTRICTIONS, COVENANTS, LIMITATIONS, EASEMENTS AND/OR CONDITIONS, AS ESTABLISHED IN INSTRUMENT, FILED FOR RECORD JUNE 8, 1999, IN O.R. VOLUME 413, PAGE 735.
24. AGREEMENT OF LEASE BY AND BETWEEN WEST LIBERTY CARE CENTER, INC. (LESSOR) AND THE COUNTY OF LOGAN, OHIO (LESSEE), FILED FOR RECORD MAY 2, 2002 IN VOLUME 565, PAGE 826.
25. SUBLEASE BY AND BETWEEN COUNTY OF LOGAN, OHIO AND WEST LIBERTY CARE CENTER, INC., FILED FOR RECORD MAY 2, 2002 IN VOLUME 565, PAGE 379.
26. EASEMENT AND RIGHT-OF-WAY TO THE DAYTON POWER AND LIGHT COMPANY, FILED FOR RECORD JANUARY 7, 2003, IN O.R. VOLUME 613, PAGE 379. (10' EASEMENT.)

U.S. 68 (R/W VARIES)
(LOGAN CO. - PUBLIC)

C.R. 5 (60' R/W)
(LOGAN CO. - PUBLIC)

C.H. 189 (60' R/W)
(LOGAN CO. - PUBLIC)

WEST LIBERTY HOMES, INC.

WEST LIBERTY HOMES, INC.
VOL.356-PG.30
4.06 ACRES

WEST LIBERTY HOMES, INC.
VOL.384-PG.920 TRACT II
2.36 ACRES

WEST LIBERTY GARDEN
APTS., INC.
VOL.391-PG.867
4.08 ACRES

VERNON R. YODER, ETAL
VOL.394-PG.749
6.02 ACRES

WEST LIBERTY CARE CENTER, INC.
VOL.352-PG.474
12.32 ACRES

PARCEL 1
11.0297 ACRES
(1.4237 ACRES IN R/W)

15.7486 ACRES
(686,009.37 SQ. FT.)
(1.4237 ACRES IN R/W)

WEST LIBERTY CARE CENTER, INC.
VOL.352-PG.613
19.70 ACRES

PARCEL 2
4.7189 ACRES

WEST LIBERTY GARDEN
APTS., INC.
OR 413-PG.735
2.761 ACRES

FLOOD PLAIN:
FIRM MAP 390772 0185 C
185 OF 225
MAY 15, 1985
ZONE C

R/W CURVE DATA

Δ	12.4900'
R	1829.86'
L	409.33'
T	408.48'
Ch	N35°25'05"W

CL CURVE DATA

Δ	12.5706'
R	1909.86'
L	431.72'
T	430.80'
Ch	N35°21'02"W

SPIRAL

Δ	22°58'31"
R	1909.86'
L	765.84'
T	388.14'
Ch	760.72'
E	39.04'
Mo	38.26'
Dc	3'00'00"
Os	4'30'00"
Ls	300.00'
Xs	299.815'
Ys	7.85'
ST	100.10'
LT	200.02'
k	149.97'
p	197'
Ch	299.92'
Length	Ch = N44°49'38"W
Bearing	

LEGEND

DESCRIPTION	SET	EXISTING
MONUMENT BOX	□	◻
CONCRETE MONUMENT	△	◕
STONE	▲	▲
IRON ROD	○	●
IRON PIPE	○	○
RAILROAD SPIKE	⊕	⊕
PK NAIL	○	○
DRILL HOLE	○	○
FENCE POST	○	○
PLAT	P	P
SURVEY RECORD	SR	SR
MEASURED	M	M
DEED	D	D
CALCULATION	C	C

SURVEYOR'S STATEMENT

I HEREBY DECLARE THAT THE ABOVE PARCEL WAS SURVEYED DURING NOVEMBER 2009. PROPERTY LINES SHOWN ARE LOCATED FROM DEEDS ON RECORD AND ARE DIED LINES. THIS SURVEY CONFORMS TO THE MINIMUM STANDARDS FOR BOUNDARY SURVEYS AS ESTABLISHED UNDER THE ADMINISTRATIVE CODE CHAPTER 4733-37.

BEARINGS ARE ASSUMED AND ARE FOR ANGULAR MEASUREMENTS ONLY. CLOSURE IS GREATER THAN 110,000 MINIMUM. ALL INFORMATION SHOWN IS TRUE AND CORRECT TO THE BEST OF MY KNOWLEDGE AND BELIEF.

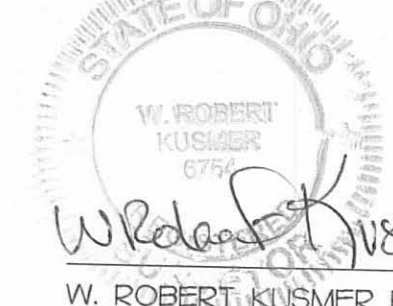

W. ROBERT KUSMER 12/3/2009
W. ROBERT KUSMER P.S. #6754 DATE

KUSMER & ASSOCIATES, INC.
Engineers & Architects
622 WEST STATE STREET
FREMONT, OHIO 43162
PHONE 419-332-1020
FAX 419-332-7056
E-MAIL kumar.associates@bmcglobal.net

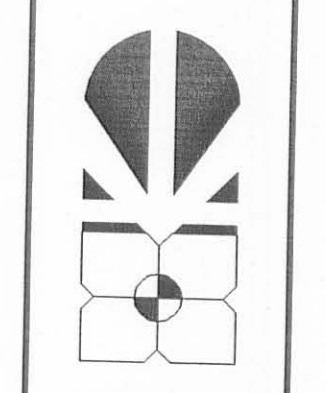

GREEN HILLS
RETIREMENT COMMUNITY
LOCATED IN PART OF SECTION 28, TOWNSHIP 5, RANGE 13, IN THE VILLAGE
OF WEST LIBERTY, LIBERTY TOWNSHIP, LOGAN COUNTY, OHIO.

Created 9:12 AM
Tuesday, Nov. 03, 2009
Last Saved WS2
Dec. 3, 2009 9:35 AM
Printed WS2
Dec. 3, 2009 10:57 AM
Revision

COCOPC No 5-13-02936

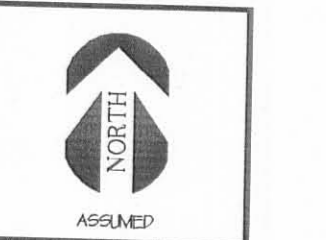

SCALE: 1" = 100'

1/1

090715

INDEXED ON MAP
8926 2P

ANY INFORMATION OR DATA ON THIS DRAWING IS NOT INTENDED TO BE SUITABLE FOR RELIANCE BY ANY PERSON, FIRM, OR CORPORATION OR ANY OTHERS ON EXTENSIONS OF THIS PROJECT OR FOR ANY USE ON ANY OTHER PROJECT. ANY RELIANCE WITHOUT WRITTEN VERIFICATION AND ADAPTATION BY THE ENGINEER, ARCHITECT, OR SURVEYOR FOR THE SPECIFIC PURPOSE INTENDED WILL BE AT THE USER'S SOLE RISK AND WITHOUT LIABILITY OR LEGAL EXPOSURE TO THE ENGINEER, ARCHITECT, OR SURVEYOR. RELIANCE ON ANY INFORMATION OR DATA ON THIS DRAWING BY ANY PERSON, FIRM, OR CORPORATION IS A VIOLATION OF THE AGREEMENT AND IS SUBJECT TO LITIGATION BY ENGINEER, ARCHITECT, OR SURVEYOR. NOT PUBLIC. ALL RIGHTS RESERVED.

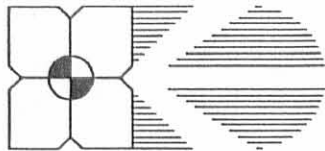

KUSMER & ASSOCIATES, INC.

ARCHITECTS • ENGINEERS • SURVEYORS

LEGAL DESCRIPTION FOR A 13.2277 ACRE PARCEL FOR GREEN HILLS RETIREMENT COMMUNITY PARCEL ONE (1)

Being a parcel of land situated in Section Twenty-Eight (28), Town-Five (5), Range-Thirteen (13), Village of West Liberty, Liberty Township, Logan County, Ohio described as follows:

- 1.) Commencing at a found 1" square iron rod on the centerline intersection of Township Road One Hundred Ninety-One (191)(40' R/W) and County Road Five (5)(60' R/W);
- 2.) thence S 11° 52' 34" W one thousand eighty-five and seven hundredths (1085.07) feet along the centerline of County Road Five (5) to a set PK nail marking the POINT OF BEGINNING;
- 3.) thence S 12° 02' 49" W sixty and thirty hundredths (60.30) feet along the centerline of County Road Five (5) to a found railroad spike;
- 4.) thence N 84° 32' 01" W four hundred thirty and thirty-two hundredths (430.32) feet along the north line of a 6.02 acre parcel of land owned by Vernon & Sandy Yoder (Vol. 394, Pg. 749) to a found 5/8" iron rod, passing at thirty and four hundredths (30.04) feet a found 1/2" iron rod on said line;
- 5.) thence S 02° 53' 37" W seven hundred twenty-two and fifty-two hundredths (722.52) feet along the west line of said 6.02 acre parcel to a set iron rod;
- 6.) thence N 87° 06' 23" W two hundred fifty-five and seventy-eight hundredths (255.78) feet along the north line of the remainder of a 19.70 acre parcel of land owned by West Liberty Care Center, Inc. (Vol. 352, Pg. 613) to a set iron rod;
- 7.) thence N 32° 58' 50" E ninety-four and five hundredths (94.05) feet along the northerly line of said 19.70 acre parcel to a found 1/2" iron rod;
- 8.) thence N 64° 31' 32" W two hundred twenty-seven and fifty-nine hundredths (227.59) feet along the northerly line of said 19.70 acre parcel to a set iron rod;

INDEXED ON MAP
8926 3D-1

- 9.) thence S 32° 52' 26" W one hundred ninety (190.00) feet along the northerly line of said 19.70 acre parcel to a set iron rod;
- 10.) thence N 57° 07' 34" W one hundred eighty-five (185.00) feet along the northerly line of said 19.70 acre parcel to a set iron rod;
- 11.) thence N 32° 52' 26" E one hundred ninety-seven and sixty hundredths (197.60) feet along the easterly line of a 2.36 acre parcel of land owned by West Liberty Homes, Inc. (Vol. 384, Pg. 920 Tract II) to a set iron rod;
- 12.) thence N 05° 29' 52" E two hundred twenty-six and twenty-five hundredths (226.25) feet along the easterly line of said 2.36 acre parcel to a set iron rod;
- 13.) thence N 84° 31' 17" W three hundred seventy and thirty-one hundredths (370.31) feet along the north line of said 2.36 acre parcel to a found 1/2" iron rod;
- 14.) thence N 01° 38' 14" E three hundred twenty-four and twenty-one hundredths (324.21) feet along the east line of an 8.00 acre parcel of land owned by Robert & Avonda King (Vol. 356, Pg. 19) to a found 1/2" iron rod;
- 15.) thence S 83° 19' 19" E four hundred fifty-one and forty-seven hundredths (451.47) feet along the south line of a 37.3735 acre parcel of land owned by Roberta Mae Graber, Trustee (OR Vol. 428, Pg. 334 Tracts 3, 4 & 5) to a set iron rod;
- 16.) thence S 84° 31' 00" E nine hundred thirty-one and ninety-three hundredths (931.93) feet along the south line of said 32.3735 acre parcel to the POINT OF BEGINNING, passing at nine hundred one and seventy-three hundredths (901.73) feet a set iron rod on the west right-of-way of County Road Five (5).

Containing in all 13.2277 acres of land more or less, subject to all legal highways and easements.

0.0415 acres in the Right-of-Way

The size of all set iron rods is 1/2" X 30".

The above described 13.2277 acres being all of the West Liberty Garden Apartments, Inc. 6.20 acre tract described in O.R. Vol. 26, Pg. 106 and all of the West Liberty Garden Apts., Inc. 4.08 acre tract described in Vol. 391, Pg. 867 and 2.761 acre tract described in O.R. Vol. 413, Pg. 735).

INDEXED ON MAP

8924 3D-2

The bearings are assumed based on the centerline of County Road 5 (S 11° 52' 34" W) and for angular measurements only.

This legal description is based upon a survey performed for Green Hills Retirement Community by Gary Elliott, P.S. # 7438 of Kusmer & Associates, Inc. in April, 2002.

Revised May 16, 2002
Job No. 02048-S
WRK/blk



Gary W. Elliott

Gary W. Elliott, P.S. # 7438

file: 02048B.leg

INDEXED ON MAP
02048 3D-3

K:\DWG\Green Hills Ret. Center\020488.dwg, Model, 05/16/02 01:16:38 PM, W32

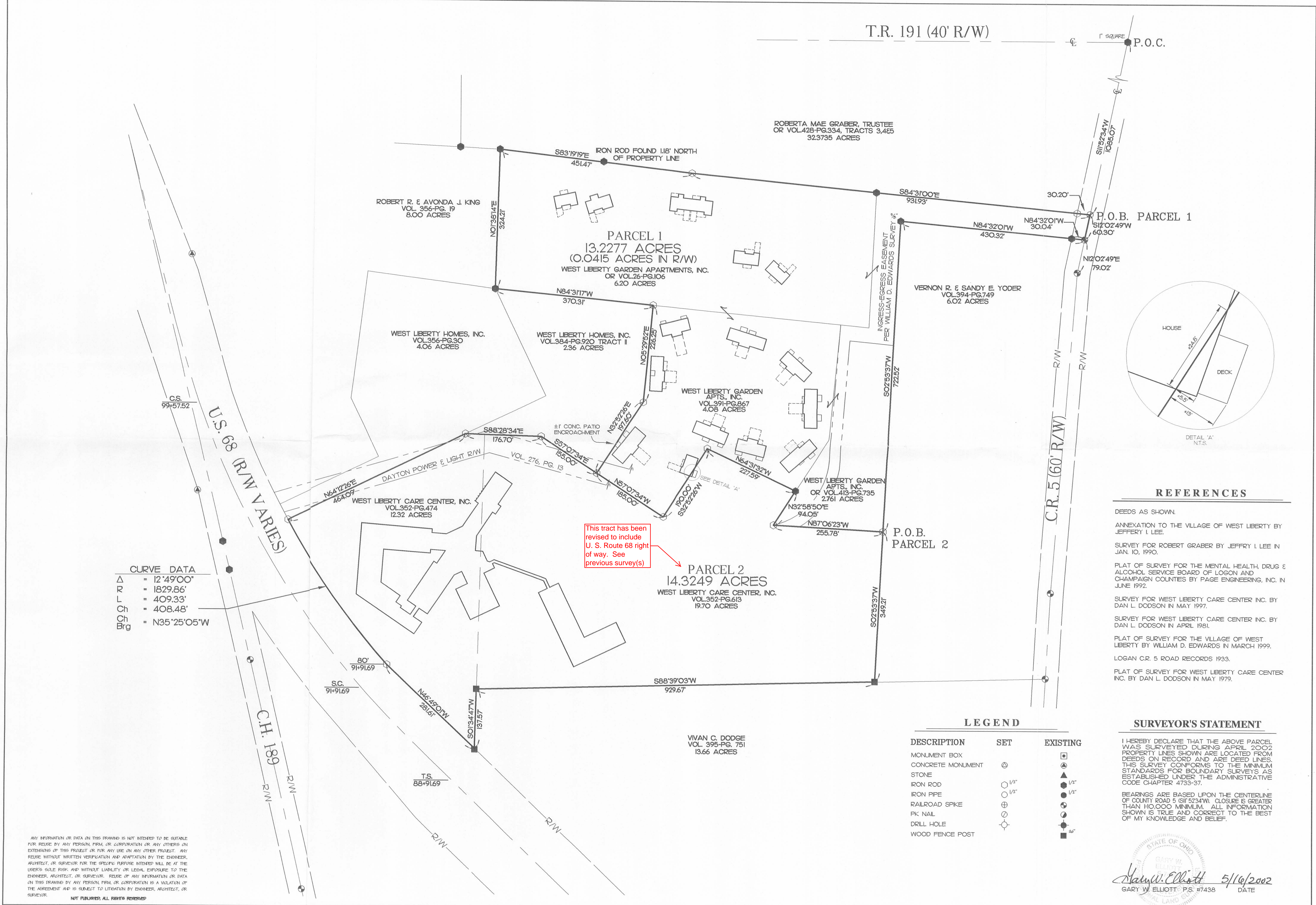

CURVE DATA

Δ	= 12°49'00"
R	= 1829.86'
L	= 409.33'
Ch	= 408.48'
Brg	= N35°25'05"W

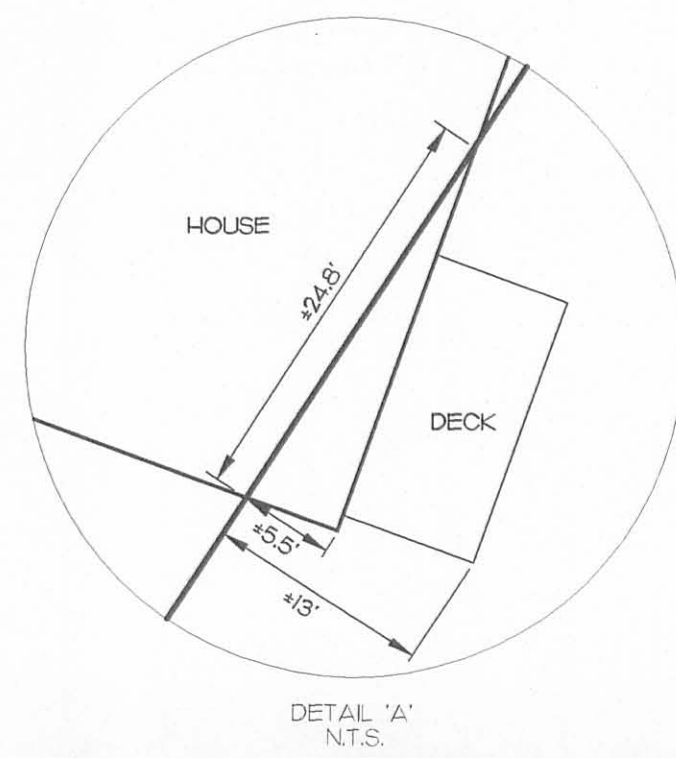

REFERENCES

- DEEDS AS SHOWN.
- ANNEXATION TO THE VILLAGE OF WEST LIBERTY BY JEFFERY I. LEE.
- SURVEY FOR ROBERT GRABER BY JEFFERY I. LEE IN JAN. 10, 1990.
- PLAT OF SURVEY FOR THE MENTAL HEALTH, DRUG & ALCOHOL SERVICE BOARD OF LOGAN AND CHAMPAIGN COUNTIES BY PAGE ENGINEERING, INC. IN JUNE 1992.
- SURVEY FOR WEST LIBERTY CARE CENTER INC. BY DAN L. DODSON IN MAY 1997.
- SURVEY FOR WEST LIBERTY CARE CENTER INC. BY DAN L. DODSON IN APRIL 1981.
- PLAT OF SURVEY FOR THE VILLAGE OF WEST LIBERTY BY WILLIAM D. EDWARDS IN MARCH 1999.
- LOGAN CR. 5 ROAD RECORDS 1933.
- PLAT OF SURVEY FOR WEST LIBERTY CARE CENTER INC. BY DAN L. DODSON IN MAY 1979.

LEGEND

DESCRIPTION	SET	EXISTING
MONUMENT BOX	⊙	⊠
CONCRETE MONUMENT	⊙	⊠
STONE	⊙	⊠
IRON ROD	⊙ 1/2"	⊠ 1/2"
IRON PIPE	⊙ 1/2"	⊠ 1/2"
RAILROAD SPIKE	⊙	⊠
PK NAIL	⊙	⊠
DRILL HOLE	⊙	⊠
WOOD FENCE POST	⊙	⊠

SURVEYOR'S STATEMENT

I HEREBY DECLARE THAT THE ABOVE PARCEL WAS SURVEYED DURING APRIL 2002. PROPERTY LINES SHOWN ARE LOCATED FROM DEEDS ON RECORD AND ARE DEED LINES. THIS SURVEY CONFORMS TO THE MINIMUM STANDARDS FOR BOUNDARY SURVEYS AS ESTABLISHED UNDER THE ADMINISTRATIVE CODE CHAPTER 4733-37.

BEARINGS ARE BASED UPON THE CENTERLINE OF COUNTY ROAD 5 (S11°52'34"W). CLOSURE IS GREATER THAN 1/10,000 MINIMUM. ALL INFORMATION SHOWN IS TRUE AND CORRECT TO THE BEST OF MY KNOWLEDGE AND BELIEF.

GARY W. ELLIOTT
 GARY W. ELLIOTT P.S. #7438
 5/16/2002
 DATE

ANY INFORMATION OR DATA ON THIS DRAWING IS NOT INTENDED TO BE SUITABLE FOR REUSE BY ANY PERSON, FIRM, OR CORPORATION OR ANY OTHERS ON EXTENSIONS OF THIS PROJECT OR FOR ANY USE ON ANY OTHER PROJECT. ANY REUSE WITHOUT WRITTEN VERIFICATION AND ADAPTATION BY THE ENGINEER, ARCHITECT, OR SURVEYOR FOR THE SPECIFIC PURPOSE INTENDED WILL BE AT THE USER'S SOLE RISK, AND WITHOUT LIABILITY OR LEGAL EXPOSURE TO THE ENGINEER, ARCHITECT, OR SURVEYOR. REUSE OF ANY INFORMATION OR DATA ON THIS DRAWING BY ANY PERSON, FIRM, OR CORPORATION IS A VIOLATION OF THE AGREEMENT AND IS SUBJECT TO LITIGATION BY ENGINEER, ARCHITECT, OR SURVEYOR.

NOT PLUMBED. ALL RIGHTS RESERVED

KUSMER & ASSOCIATES, INC.

Engineers
Architects
Surveyors

622 WEST STATE STREET
 FREMONT, OHIO 43420
 PHONE 419-332-1027
 FAX 419-332-1027
 E-MAIL kusmer@earthlink.net

**GREEN HILLS
RETIREMENT COMMUNITY**

LOCATED IN PART OF SECTION 28, TOWN-5, RANGE-13, IN THE
VILLAGE OF WEST LIBERTY, LIBERTY TOWNSHIP, LOGAN COUNTY, OHIO.

DRAWN	J. POLTER	CHECK
NO DATE	BY	REVISION

NORTH
AS SHOWN

SCALE: 1" = 100'

1/1

Rev - 0

020488

INDEXED ON MAP 020488 3P



**KUSMER &
ASSOCIATES, INC.**

Architects

Engineers

Surveyors

**LEGAL DESCRIPTION FOR A 0.1785 ACRE PARCEL
FOR GREEN HILLS RETIREMENT COMMUNITY
DRAINAGE EASEMENT**

Being a drainage easement situated in part of Section Twenty-Eight (28), Town-Five (5), Range-Thirteen (13), Liberty Township, Logan County, Ohio described as follows:

- 1.) Commencing at a found 1" square iron rod on the centerline intersection of Township Road One Hundred Ninety-One (191) (40' R/W) and County Road Five (5) (60' R/W);
- 2.) thence S 11° 52' 34" W one thousand eighty-five and seven hundredths (1085.07) feet along the centerline of County Road Five (5) (60' R/W) to a found PK nail;
- 3.) thence S 12° 02' 49" W one hundred thirty-nine and thirty-two hundredths (139.32) feet along the centerline of County Road Five (5) (60' R/W) to a found railroad spike, passing at sixty and thirty hundredths (60.30) feet a found railroad spike on line;
- 4.) thence S 05° 20' 11" W four hundred forty-four and ninety-four hundredths (444.94) feet along the centerline of County Road Five (5) (60' R/W) to a point;
- 5.) thence S 03° 10' 40" W eight hundred forty-three and fifty hundredths (843.50) feet along the centerline of County Road Five (5) (60' R/W) to a point, passing at three hundred and nineteen hundredths (300.19) feet a found railroad spike on line and also passing at five hundred and fifty hundredths (500.50) feet a found railroad spike on line;
- 6.) thence S 04° 43' 20" E seventy and fifty-six hundredths (70.56) feet along the centerline of County Road Five (5) (60' R/W) to a point at the POINT OF BEGINNING;
- 7.) thence S 73° 54' 43" E one hundred seventeen and ninety-two hundredths (117.92) feet to a point;

622 West State Street • Fremont, Ohio 43420 • Phone 419-332-1027 • Fax 419-332-7056
kusmer.associates@sbcglobal.net www.kusmerassociates.com



- 8.) thence S 82° 47' 20" E one hundred thirty-one and eleven hundredths (131.11) feet to a point;
- 9.) thence S 74° 54' 25" E two hundred seventy-one and ninety-five hundredths (271.95) feet to a point in the center of the Mad River;
- 10.) thence S 15° 05' 35" W fifteen (15.00) feet along the center of the Mad River to a point;
- 11.) thence N 74° 54' 25" W two hundred seventy and ninety-one hundredths (270.91) feet to a point;
- 12.) thence N 82° 47' 20" W one hundred thirty-one and twenty-four hundredths (131.24) feet to a point;
- 13.) thence N 73° 54' 43" W one hundred thirteen and thirty-eight hundredths (113.38) feet to a point;
- 14.) thence N 04° 43' 20" W sixteen and five hundredths (16.05) feet along the centerline of County Road 5 (60' R/W) to the POINT OF BEGINNING.

Containing in all 0.1785 acres of land more or less, subject to all legal highways and easements.

0.0111 Acres in the Right-of-Way

The size of all set iron rods is 5/8" X 30".

The above described 0.1785 acre easement being part of the 97 acre parcel of land owned by Cronkleton Land LLC (OR Vol. 810, Pg. 48, Parcel B, Tract 1)

The bearings are based on the centerline of County Road 5 (S 11° 52' 34" W) and for angular measurements only.

This legal description is based upon a prior survey performed for Green Hills Retirement Community by W. Robert Kusmer, P.S. # 6754 of Kusmer & Associates, Inc. in April, 2002.

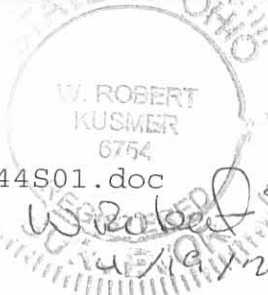

April 19, 2010
 Job No. 10444-S
 WRK/blk

File: 10444S01.doc

W. Robert Kusmer
 4/19/2010

8926 4D-2



**KUSMER &
ASSOCIATES, INC.**

Architects

Engineers

Surveyors

**LEGAL DESCRIPTION FOR A 0.3150 ACRE PARCEL
FOR GREEN HILLS RETIREMENT COMMUNITY
DRAINAGE EASEMENT**

Being a drainage easement situated in part of Section Twenty-Eight (28), Town-Five (5), Range-Thirteen (13), Liberty Township, Logan County, Ohio described as follows:

- 1.) Commencing at a found 1" square iron rod on the centerline intersection of Township Road One Hundred Ninety-One (191) (40' R/W) and County Road Five (5) (60' R/W);
- 2.) thence S 11° 52' 34" W one thousand eighty-five and seven hundredths (1085.07) feet along the centerline of County Road Five (5) (60' R/W) to a found PK nail;
- 3.) thence S 12° 02' 49" W one hundred thirty-nine and thirty-two hundredths (139.32) feet along the centerline of County Road Five (5) (60' R/W) to a found railroad spike, passing at sixty and thirty hundredths (60.30) feet a found railroad spike on line;
- 4.) thence S 05° 20' 11" W four hundred forty-four and ninety-four hundredths (444.94) feet along the centerline of County Road Five (5) (60' R/W) to a point;
- 5.) thence S 03° 10' 40" W eight hundred forty-three and fifty hundredths (843.50) feet along the centerline of County Road Five (5) (60' R/W) to a point, passing at three hundred and nineteen hundredths (300.19) feet a found railroad spike on line and also passing at five hundred and fifty hundredths (500.50) feet a found railroad spike on line;
- 6.) thence S 04° 43' 20" E seventy and fifty-six hundredths (70.56) feet along the centerline of County Road Five (5) (60' R/W) to a point at the POINT OF BEGINNING;
- 7.) thence S 04° 43' 20" E sixteen and five hundredths (16.05) feet along the centerline of County Road Five (5) (60' R/W) to a point;

622 West State Street • Fremont, Ohio 43420 • Phone 419-332-1027 • Fax 419-332-7056
kusmer.associates@sbcglobal.net www.kusmerassociates.com

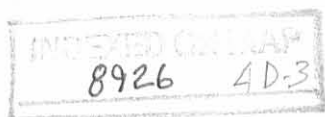

- 8.) thence N 73° 54' 43" W thirteen and two hundredths (13.02) feet to a point;
- 9.) thence N 54° 16' 55" W three hundred eighty-eight and seventy-eight hundredths (388.78) feet to a point;
- 10.) thence S 88° 43' 19" W seventy-seven and thirty-six hundredths (77.36) feet to a point;
- 11.) thence N 73° 14' 15" W three hundred twenty-eight and thirty-six hundredths (328.36) feet to a point;
- 12.) thence N 44° 44' 20" W one hundred twenty-one and six hundredths (121.06) feet to a point;
- 13.) thence N 88° 39' 03" E twenty and sixty-four hundredths (20.64) feet along the south line of an 11.0297 acre parcel of land now or formerly owned by West Liberty Care Center, Inc, (OR Vol. 987, Pg. 838, Parcel II) to a point, said line also being the West Liberty Corporation line;
- 14.) thence S 44° 44' 20" E one hundred three and seven hundredths (103.07) feet to a point;
- 15.) thence S 73° 14' 15" E three hundred twenty-two and seventeen hundredths (322.17) feet to a point;
- 16.) thence N 88° 43' 19" E eighty (80.00) feet to a point;
- 17.) thence S 54° 16' 55" E three hundred ninety-one and twenty-one hundredths (391.21) feet to a point;
- 18.) thence S 73° 54' 43" E four and seventy-three hundredths (4.73) feet to the POINT OF BEGINNING.

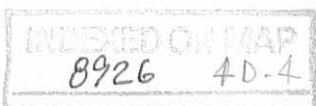

Containing in all 0.3150 acres of land more or less, subject to all legal highways and easements.

0.0129 Acres in the Right-of-Way

The size of all set iron rods is 5/8" X 30".

The above described 0.3150 acre easement being part of the 13.66 acre parcel of land owned by West Liberty Care Center, Inc. (OR Vol. 895, Pg. 336).

The bearings are based on the centerline of County Road 5 (S 11° 52' 34" W) and for angular measurements only.

This legal description is based upon a prior survey performed for Green Hills Retirement Community by W. Robert Kusmer, P.S. # 6754 of Kusmer & Associates, Inc. in April, 2002.

April 19, 2010
Job No. 10444-S
WRK/blk

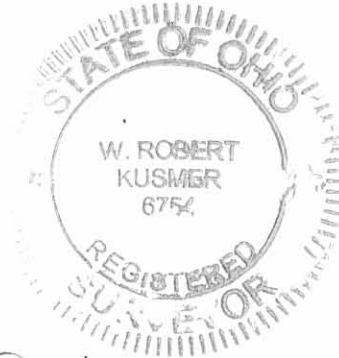

File: 10444S02.doc

W Robert Kusmer
4/19/2010

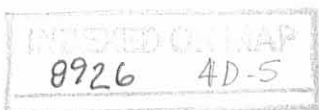

T.R. 191 (40' R/W)
(LIBERTY TWP. - PUBLIC)

P.O.C.

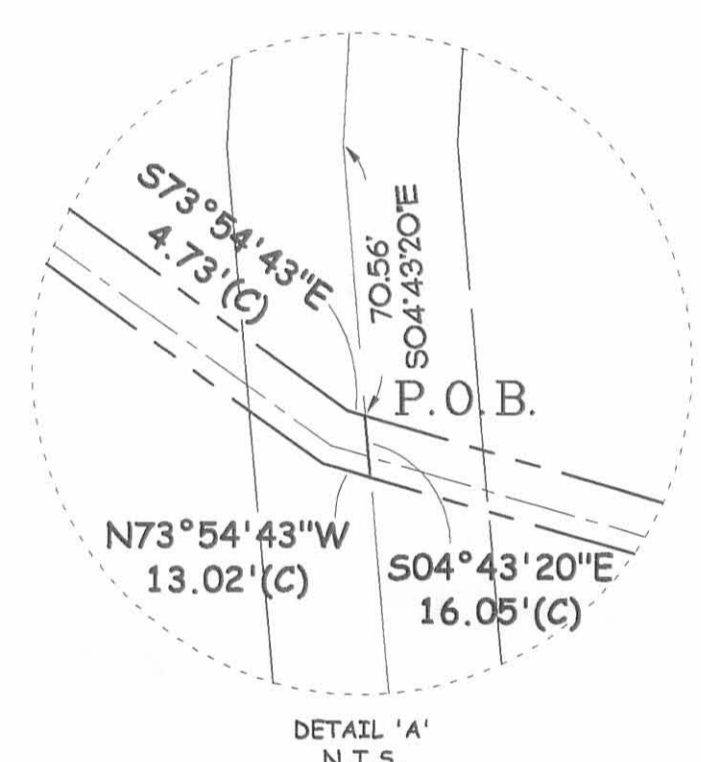

DRAINAGE EASEMENT
0.1785 ACRES
(0.0111 ACRES IN R/W)

DRAINAGE EASEMENT
0.3150 ACRES
(0.0129 ACRES IN R/W)

REFERENCES

DEEDS AS SHOWN
SURVEY FOR WEST LIBERTY CARE CENTER INC. BY
DAL L. DODSON, MARCH 1981

LEGEND

Table with columns for Description, Existing, Proposed, and symbols for various features like fences, easements, and utilities.

SURVEYOR'S STATEMENT

I HEREBY DECLARE THAT THE ABOVE PARCEL WAS SURVEYED DURING APRIL 2002... BEARINGS ARE BASED UPON THE CENTERLINE OF COUNTY ROAD 5 (S17°32'30\"/>

W. Robert Kusmer P.S. 19754 DATE 4/20/02

ANY INFORMATION OR DATA ON THIS DRAWING IS NOT INTENDED TO BE SUITABLE FOR REUSE BY ANY PERSON, FIRM, OR CORPORATION OR ANY OTHERS ON EXTENDING THIS PROJECT OR FOR ANY USE ON ANY OTHER PROJECT...

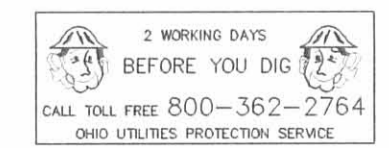

INDEXED ON MAP 8926 AP

KUSMER & ASSOCIATES, INC. Surveyors & Architects. 622 WEST STATE STREET, FREMONT, OHIO 43420. Phone: 419-337-7056, Fax: 419-337-7056, E-Mail: kusa@aol.com

GREEN HILLS RETIREMENT COMMUNITY. LOCATED IN PART OF SECTION 28, TOWN-5, RANGE-13, LIBERTY TOWNSHIP, LOGAN COUNTY, OHIO.

Revision table with columns for Date, Description, and initials.

Scale 1" = 100', 1/1, Rev - 0, IO444SI