

PLAT OF A SURVEY
 OF LOTS 108 AND
 THE W. 1/2 OF 109
 ORCHARD ISLAND,
 SECTION 36, T6S-R8E,
 WASHINGTON TOWNSHIP,
 LOGAN COUNTY, OHIO

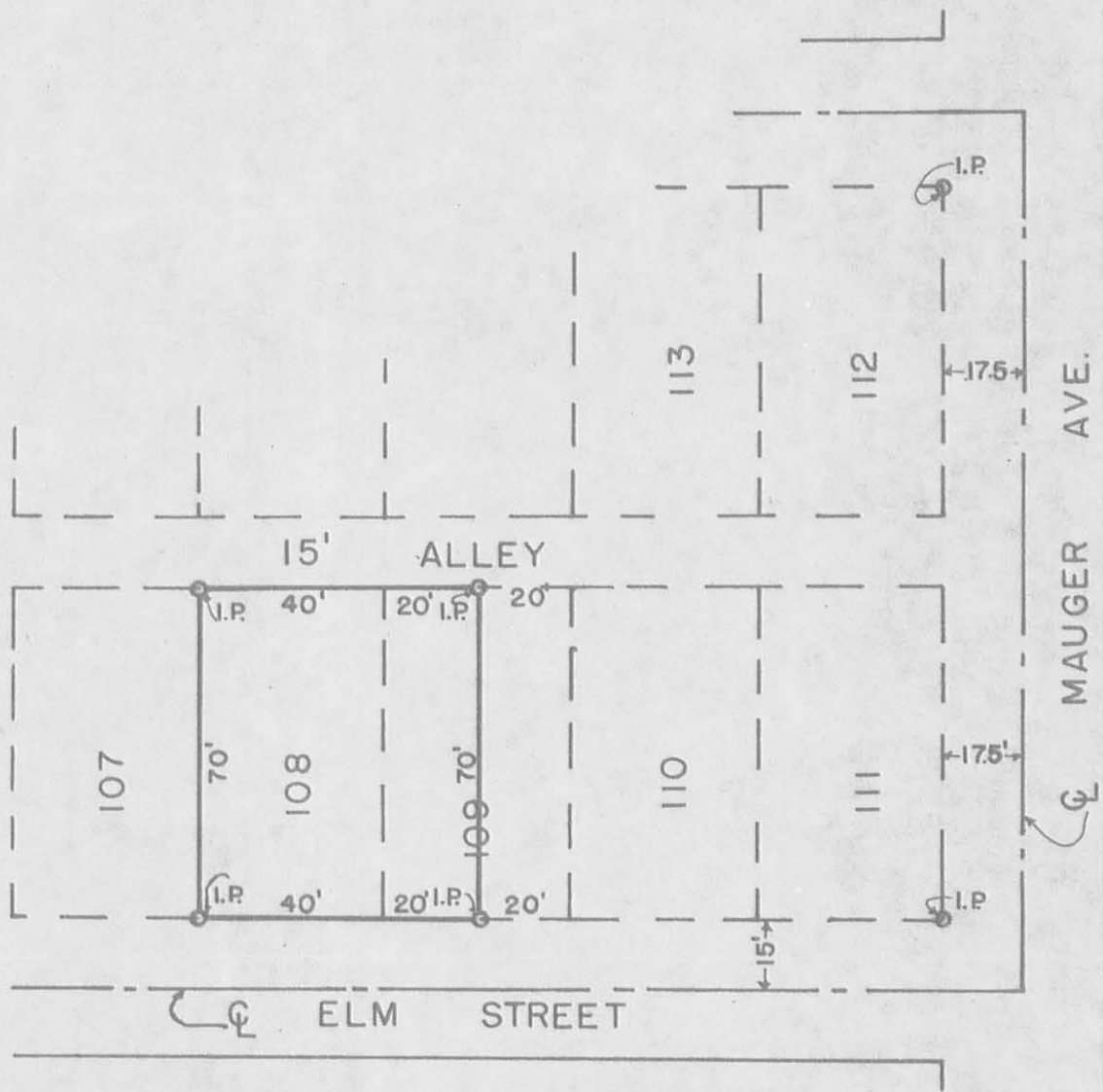

Thomas G. Hubbell
 Reg. Surveyor #50144

SHELDON ENGINEERING



LIMA, OHIO

4258 IP

INDEXED ON MAP

18 JUNE 1968	DATE	JOB NO. 06409
DRAWN	DF	
CHECKED		SCALE 1" = 40'
APPROVED		