

2<sup>nd</sup> mo (Feb.) 10<sup>th</sup> 1827 ✓ Surveyor No 68

(899)

Surveyed the N.E. quarter of section 12 in Town 4 Range 13 E. M. R. for William H. Davis - beginning at the N.E. corner of said sec. a stake in a prairie a white oak 30 inches in diam. bears S 14° E 11.9 poles dist. thence West 152 poles to the quarter sec. corner, a white oak 15 inches in diam. S 79° E 104 links, a white oak 17 inches in diam. N 79° E 104 links dist. thence S 1/2 W 162 poles to a stake in a prairie - thence east 156 poles to the South corner of said quarter a white oak 8 inches in diam. south 14 links dist. a white 10 inches in diam. S 5° W 3 links dist. thence north 162 poles to the beginning containing 155 3/4 acres

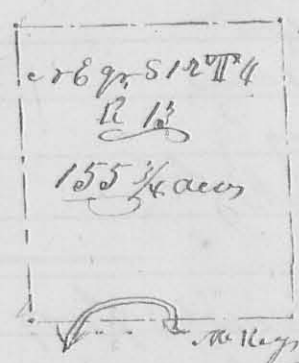

James Craig }  
 James MacKinnon }  
 Sec. W. H. Morrison & Surveyor

2<sup>nd</sup> mo (Feb.) 10<sup>th</sup> 1827 ✓ Surveyor No 69

(8700)

Surveyed the north half of the north east quarter of section 18 Town 4 Range 13 E. M. R. for George Meekick: beginning at the north east corner of said sec. the original bearing tree, a white oak 18 inches in diam. S 18° W 56 links dist a white oak 22 inches in diam. N 69° E 51 links distant thence west with the north line of the sec. 161 poles to the original quarter sec. corner, a white oak 12 inches diam. S 50° W 20 links - a white oak S 65° E 12 links thence S 80 poles, a white oak 20 inches in diam. south 20 links - 2 black oak's growing from one root west 12 links thence east 161 poles to a stake in the east line of the sec. - thence north 80 poles to the beginning containing 80 1/2 acres

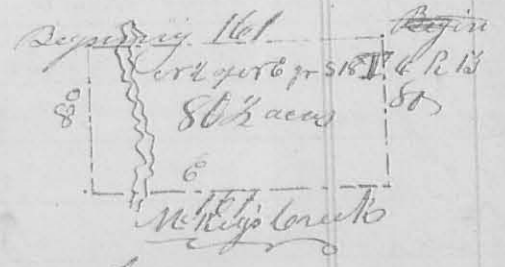

James Craig }  
 Andrew Thompson }  
 James W. Morrison & Surveyor

54 2<sup>nd</sup> mo. (Feb) 10<sup>th</sup> 1827. Survey No 70. (820)

Surveyed the south half of the N.E. q<sup>r</sup> of sec. 13 Town 4 Range 13 E. N. R. for Jonathan Sigas: beginning at the south east corner of said quarter section, 2 white oaks growing from one root in the east line of the sec. thence north with said line 80 poles to a stake corner to George Elliptic's land thence west 166 poles to a white oak 15 inches in diam. S 20 links dist. 2 black oaks growing from one root west 12 links - thence south 80 pole to a white oak 10 inches in diam. S 20 links dist. a white oak 14 inches diam.

N 47° E 24 links dist. thence east 166 poles to the beginning containing 80 1/2 acy.

James Craig }  
Andrew Thompson }

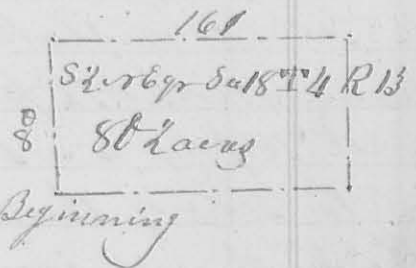

La. M. Harmon, Surveyor

3<sup>rd</sup> mo. (March) 8<sup>th</sup> 1827. Survey No 71. (821)

Surveyed for Samuel Blair, Abram Cofpy, John Wall and others Section 5 Town 4 Range 13 E. N. R. in the following manner beginning at the south west corner of said sec. original corner a black oak 24 inches in diam. S 46° E 17 links dist. (which is now cut down), a white oak 20 inches in diam. S 44° W 10 links dist - thence with the west line of the sec. 160 poles to the original q<sup>r</sup> sec. corner a hickory 12 inches in diam.

S 49° E 16 links dist. (it is now dead), a white oak S 32° W 20 links dist. thence east 156 poles to a stone at the centre. Then I went to the q<sup>r</sup> sec. corner on the north line a white oak 16 inches in diameter S 66° E 26 links distant, a white oak

Beginning		
A. Cofpy 156 a.		John Wall 116 a.
		John Taylor 32 a.
Sam. Blair 56 a.	Sam. Blair 110 a.	Sam. Blair 50 a.
		Gen. Huston 50 a.
		Sam. Blair 68 a.