

CLAIR A. INSKEEP
CIVIL ENGINEER
INSKEEP BLOCK
BELLEFONTAINE, OHIO

- "A" County Line Survey "M" 20' S and 20' W of SW cor 3.16 (found)
 "B" " " " " "M" 20' N of S 1/4 cor 3.16 (Not found)
 "C" Post on S 1/4 cor 3.16 (Set) 6" round 7' long-pipe
 "D" County Line Survey "M" 20' S at SE cor 3.16 (found)
 "E" Stone S.E. cor E 1/2 SE 1/4 3.16 (found)
 "F" " " N 1/4 cor 3.16 (Road 14) (found)
 "G" Center 3.16 - searched - found nothing.
 "H" Iron bar set
 "I" " " set
 "J" " " set on S. berm.
 Chained W. of S. line 3.16
 0+00 S.E. cor 3.16 T 4 R 13, T road north. Co line "M" 20' S.
 20+74 chains Found stone in E road and on fence lines
 N and S - S.E. cor W 1/2 SE 1/4 3.16
 41+57 chains \angle Angle L 0°-45' (No angle shown on Co line Survey Record)
 Set 6" round post 7' long at S. 1/4 cor. 3.16. This is
 approx 17' S. of old fence line and on apparent E
 road to S. Said by Mr. Thompson about 70 yrs.
 and son Paul Thompson 42 yrs. old to be very
 near location of old 1/4 corner. Mr. T has owned and
 lived on 1/4 sec to SE many years. Paul, the son, born
 there and lived there most of life. O.M. Newell, who
 was present had no recollection of location
 58.32 chains Set iron bar on S. berm for S.W. cor. 13⁴⁰ A. tract.
 Pass just S. of truss at br.
 83.16 chains S.W. cor 3.16 and 20' E and 20' N of Co. line Survey "M"

Sheet 2
of 25 sheets
over

CLAIR A. INSKEEP
CIVIL ENGINEER
FLOOR
DELEPORTAINE, OHIO

$1/4$ and $3/4$ line is straight between stone at
 $1/4$ $1/4$ cor in $\frac{1}{2}$ Road 14 and post set at $3/4$
cor. Fences are as much as 10' both E and W
of $1/4$ line.

Post set at $3/4$ line is 35.8' N of st. line
between SE cor 16 and SW cor 16

caj

INDEXED ON MAP
1775 1D-2

survey for oak Newell

CLAIR A. INSKEEP
 CIVIL ENGINEER
 INSKEEP BLOCK
 BELLEFONTAINE, OHIO

INDEXED ON MAP
 1775 1P

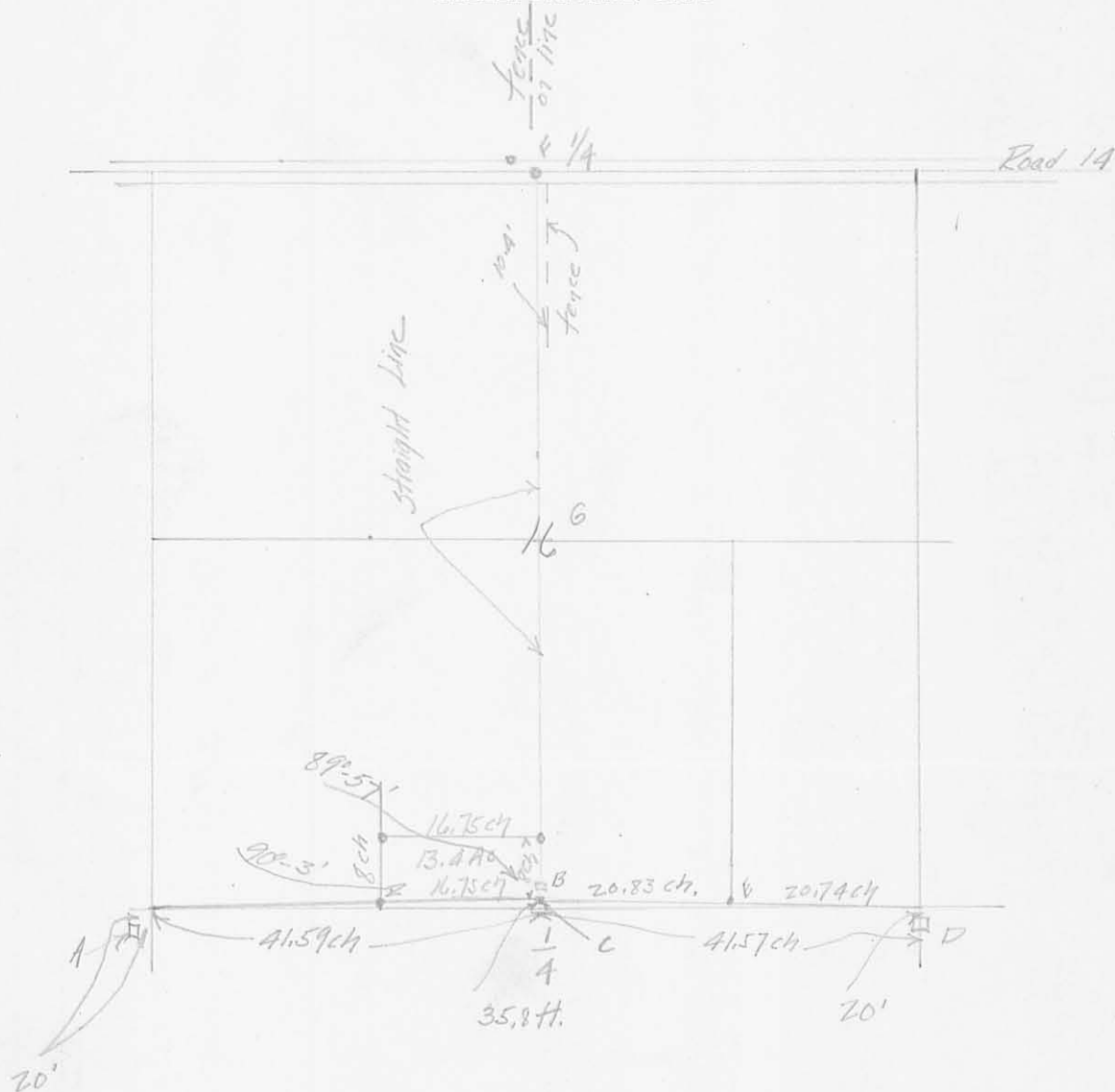

Survey of 13.40 Acres in S.W. 1/4

S. 16 T 4 R 13

Union Twp.

Logan Co. Ohio.

March 31, 1937

Clair A. Inskeep.