

Being a parcel of land situate in the Southeast quarter of Section 16, Stokes Township, T-6-S, R-8-E, Logan County, Ohio and more particularly described as follows:

Commencing at an iron pin found at the southeast corner of said Southeast quarter of said Section 6;  
 Thence S 88°45'00" W (bearing obtained from previous survey) with the south line of said Southeast quarter (also the centerline of Stringtown Pike - C.R. 88), 2300.43 feet to a PK nail set and the PLACE OF BEGINNING;  
 Thence continuing S 88°45'00" W with said south line and centerline, 350.00 feet to a PK nail set;  
 Thence N 01°23'25" W (passing through a 5/8 inch rebar set at 20.00 feet), 374.00 feet to a 5/8 inch rebar set;  
 Thence N 88°45'00" E, 350.00 feet to a 5/8 inch rebar set;  
 Thence S 01°23'25" E (passing through a 5/8 inch rebar set at 354.00 feet), 374.00 feet to the PLACE OF BEGINNING.  
 Containing 3.005 acres more or less and subject to all highways and other legal easements of record. Previous deed reference: Volume 2, Page 322 of the Logan County Recorder's Office.

I hereby certify the above description was prepared from a true and accurate survey made under my direct supervision on June 24, 1987.

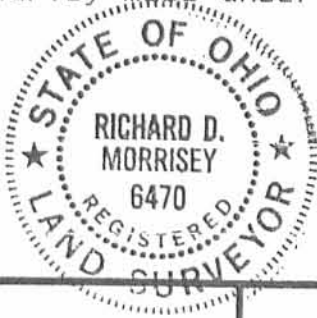

*Richard D. Morrissey*  
 Registered Surveyor No. 6470  
 KUCK AND MORRISEY, INC.

INDEXED ON MAP  
 7697 IP

Signature by a representative of the County Health Dept. denotes compliance with Health Regulations.  
 Signed: \_\_\_\_\_ Date \_\_\_\_\_

Signature by a representative of the Logan County Regional Planning Commission denotes approval of this plat.  
 Signed: \_\_\_\_\_ Date \_\_\_\_\_

Signature by a representative of City with 3 mile limit jurisdiction or Twp. Trustees or Village with zoning jurisdiction denotes approval of this plat. Signed: \_\_\_\_\_  
 for political S. D. of: \_\_\_\_\_ Date \_\_\_\_\_

Signature by a representative of the County Engineer's Dept. denotes that this plat meets tax map plat requirements.  
 Signed: \_\_\_\_\_ Date \_\_\_\_\_

**KUCK and MORRISEY, INC.**  
 CONSULTING ENGINEERS & SURVEYORS  
 LIMA, OHIO 45805  
 TELEPHONE 228-1735 - AREA CODE 419  
 2807 CHAPEL HILL DRIVE

Client Oakridge Realty Co.  
 County Logan Twp. Stokes Sec. 16  
 Drawn by RDM Scale 1"=100' Drwg. No. \_\_\_\_\_  
 Checked by rdm Date 6/24/87  
 Sheet 1 of 1  
 (T-6-S; R-8-E)