

PLAT OF
 PUMP STATION LOT
 LAKE RIDGE ISLAND
 I. L. S. S. Dist. No. 4 - Ext. No. 1
 STOKES TWP.
 LOGAN COUNTY, OHIO
 1957

INDEXED ON MAP
 4449

SCALE 1" = 60'
 17

DEDICATION OF EASEMENT

Extension of Sanitary Sewer at Wolf Trailer Court
 Located in the Township of Stokes, County of Logan, Lakeridge, Ohio

The undersigned Trustees for the Uma C Wolf Trust, hereby certify that the attached Plat correctly represents their DEDICATION OF EASEMENT to the Indian Lake Sanitary Sewer District of Logan County, Ohio for the purpose of allowing ingress and egress to the County for properly maintaining and inspecting the sanitary sewer line. Said easement to be twelve (12) feet wide as shown and shall remain free of buildings, concrete slabs, plantings or any other obstructions that might hinder the proper maintenance of said sewer.
 Said Easement is located on parcel of land transferred to Trustee Third National Bank Dayton, Ohio, under agreement with Uma C Wolf dated October 27, 1966 as recorded in Deed Book Volume 311, page 200, Recorder's Office, Beletfontaine, Ohio.

VICE PRESIDENT Trust Officer
 Trustee, Third National Bank, Dayton Ohio

STATE OF OHIO } ss
 COUNTY OF } Before me a Notary Public in and for said County personally came the above named Officers of the Third National Bank of Dayton Ohio who acknowledge the signing of the foregoing instrument to be their voluntary act and deed for the uses and purposes therein expressed. In witness thereof, I have here unto set my hand and affixed my notarial seal this ___ day of ___, 1967.

NOTARY PUBLIC
 My Commission Expires
 Logan County Sanitary Engineer

Plan and Easement approved this 14th day of February, 1967.

Plan and Easement approved and accepted this 14th day of February, 1967
 Board of County Commissioners, Logan County, Ohio

Recorded this 15th day of Feb., 1967 in Plat Book 27, Page 5.

Logan County Recorder

FED. RD. DIVISION	STATE	PROJECT
2	OHIO	

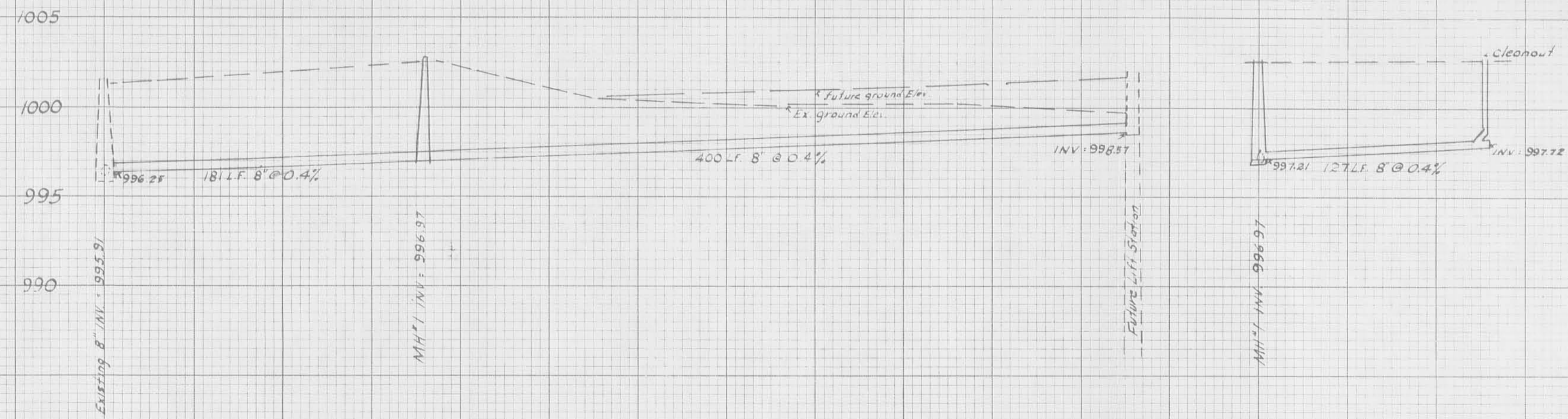
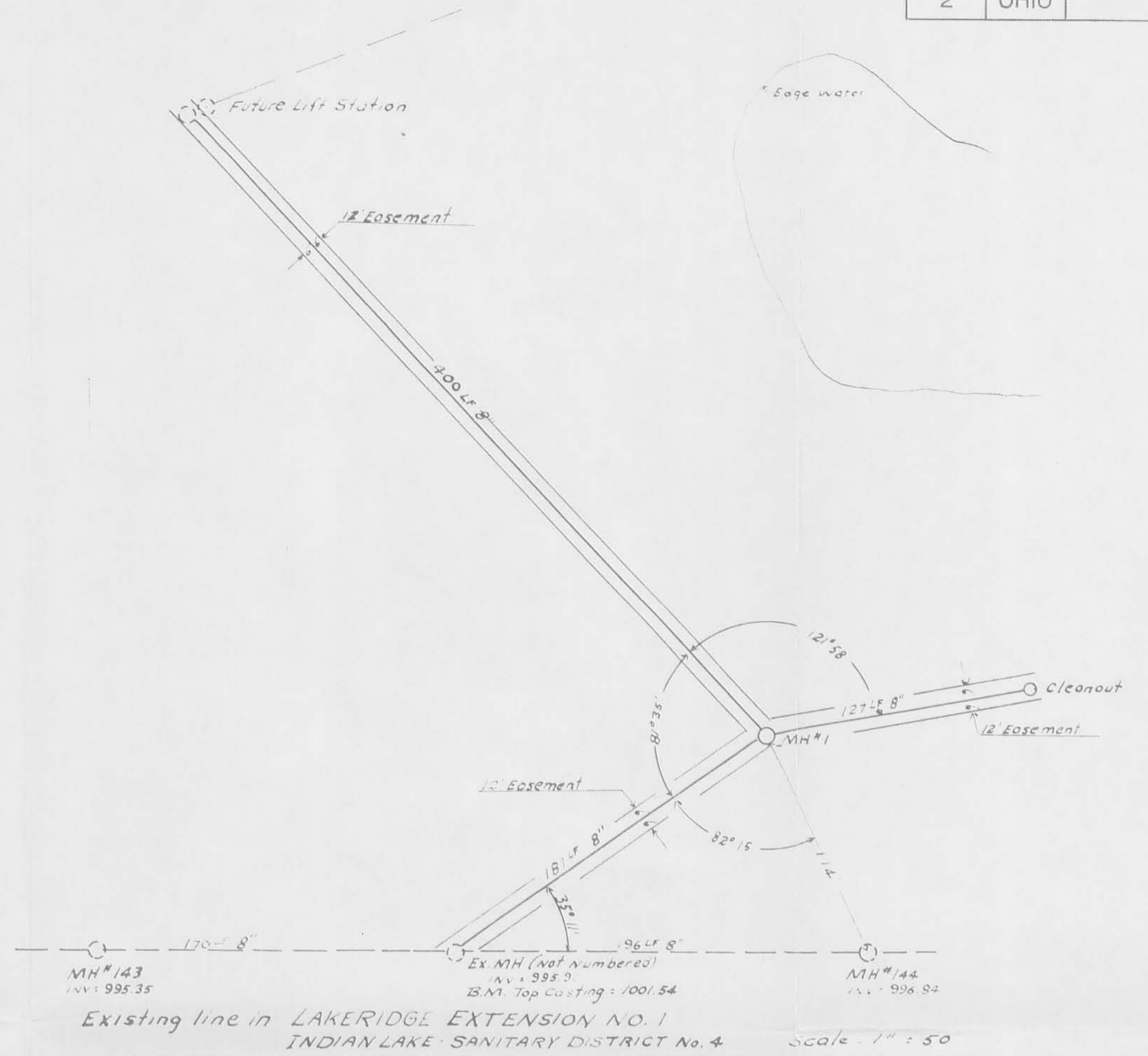

General Specifications

All sanitary sewer pipe and fittings to be extra strength vitrified (C-200) with wedge lock joints or equal. Pipe to be laid true to line and grade on firm bedding and shall have a minimum of 2 1/2 feet of cover. Manholes may be constructed using precast reinforced concrete sections. Manhole bases shall be 8" concrete. Castings shall be Neenah R 1771 or equal. Steps to be Neenah R 980-C or 16" centers upon completion. The owner shall submit a revised plan showing the exact location and depth of all sewers, branches, connections, manholes and other accessories.

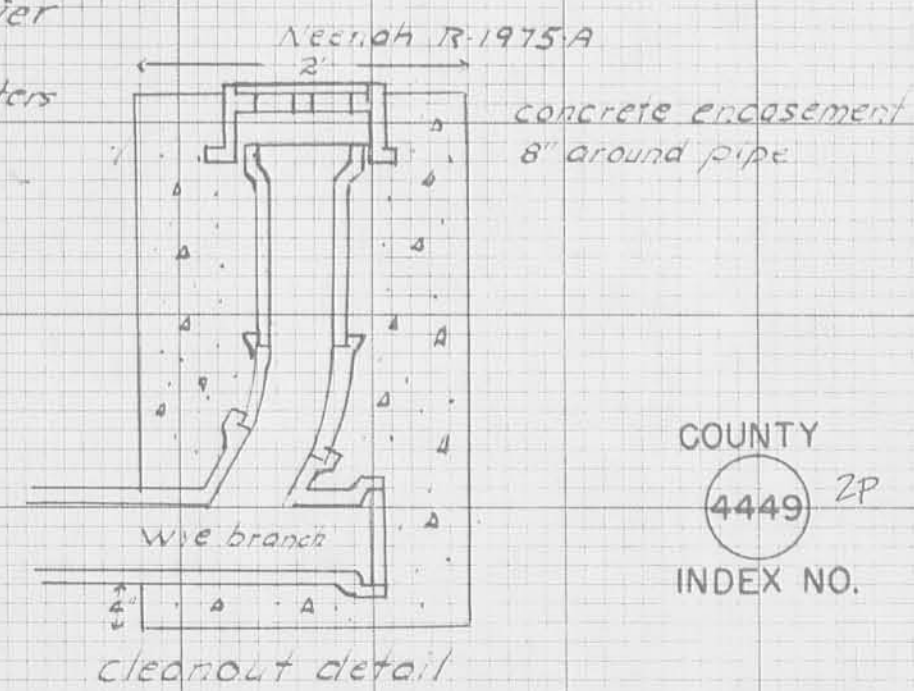

Plan prepared by Bernard Hurst
 Registered Engineer No 26568

COUNTY
 4449 2P
 INDEX NO.