

Snapp to Van Gundy Survey

Aug., 1972

Being situated in Stokes Township, Logan County, Ohio;
being a part of Section 33, Town 6 South, Range 8 East.

Beginning at an iron in the center of State Route 720
that bears S $84^{\circ}-12'$ W 1152.0 feet from the intersection of
the centerlines of said State Route 720 and Township Road 83.

Thence with the center of State Route 720 S $84^{\circ}-12'$ W 45.0
feet to an iron. Said iron is the southeast corner of a
0.58 acre tract.

Thence N $5^{\circ}-58'$ W 180.0 feet to an iron at the northeast
corner of said 0.58 acre tract.

Thence N $84^{\circ}-12'$ E 45.0 feet to an iron.

Thence S $5^{\circ}-58'$ E 180.0 feet to the place of beginning,
passing thru an iron at 150.0 feet.

Containing 0.19 of an acre more or less. Being surveyed
from a 24.32 acre tract.

Owen K. Shirk
Surveyor 4271

SNAPP TO VAN GUNDY SURVEY
 STOKES TOWNSHIP, LOGAN COUNTY, OHIO
 SECTION 33, TOWN 6 SOUTH, RANGE 8 EAST
 1" = 100' - • DENOTES IRONS



Owen K. Stirk
 Surveyor 4271
 8-2-72

INDEXED ON MAP
 3630 -1P

Van Gundy - Snapp Survey Stokes Township Feb. 1964 0.58 Acre

The following described land in Stokes Township, Logan County, Ohio,
and bein in Section 33 Town 6 S. Range 8 E.

Beginning at an iron in the center of State Route Number 720 and
being Station 41 plus 51 as shown in Logan County Engineer's
Book 589 page 31 and also being the S.E. corner of George A.
Smith's 40.00 acre tract and the S.W. corner of Carey E. Snapp's
25.00 acre tract.

Thence with the said line of Smith abd Snapp N. 5° - 58' W. 180.00
feet to an iron. The last described line passing an iron at the north
side of the State Highway at 30.00 feet.

Thence N. 84° - 12' E. 140.00 feet to an iron.

Thence S. 5° - 58' E. 180.00 feet to an iron in the center
of State Route Number 720. The last described line passing an iron
at the north side of the State Highway at 150.00 feet.

Thence with the center of the State Highway S. 84° - 12' W.
140.00 feet to the place of beginning.

The above described tract contains 0.58 of one acre and being out
of the S.W. corner of a 25.00 acre tract now in the name of Carey E.
Snapp.

cc

Logan County Engineer.



3630 -2P
INDEXED ON MAP

On Plat Book
2-13-64
D.E.G.

(B)

REC'D 5-20-10 SMY ak

Lee Surveying and Mapping Co., Inc.

Land Surveys • Topography • Subdivisions • Construction Layout

117 N. Madriver St.
Bellefontaine OH 43311



Phone: (937) 593-7335
Fax: (937) 593-7444
surveys@lsminc.us

SNAPP 2.475 ACRES

Lying in Section 33, Town 6, Range 8, Stokes Township, Logan County, Ohio.

Being out of the Betty J. Snapp, Transfer on Death to Valerie K. Van Gundy, Errol D. Snapp and Kerry L. Snapp, 14.46 acre tract as deeded and described in Official Record 799, Page 683 of the Logan County Records of Deeds and being more particularly described as follows:

Commencing on a 5/8 inch iron rod found with O.D.O.T. cap in a monument box at the center of Section 33 on the center-line of Ohio Route 720 at Station 41+51 (Logan County Engineer's Field Book 589, Page 31).

THENCE, with the south line of the northeast quarter of Section 33 and the center-line of Ohio Route 720 (60 feet wide), N 89°-40'-31"E, a distance of 185.00 feet to a MAG nail set at the TRUE POINT OF BEGINNING.

THENCE, with the east line of the Jon Wickersham 0.19 acre tract (O.R. 77, Pg. 837, Tract II) and said line extended, N 00°-36'-00"W, a distance of 203.00 feet to a 5/8 inch iron rod set, passing a 5/8 inch iron rod set at 30.00 feet and a 1/2 inch iron rod found at 180.00 feet.

THENCE, S 88°-39'-26"E, a distance of 553.98 feet to a 5/8 inch iron rod set.

THENCE, with the west line of the John A. Horne 2.21 acre tract (O.R. 236, Pg. 736), S 00°-16'-33"E, a distance of 186.88 feet to a MAG nail set on the south line of the northeast quarter of Section 33 and the center-line of Ohio Route 720, passing a 5/8 inch iron rod set at 156.88 feet.

THENCE, with the south line of the northeast quarter of Section 33 and the center-line of Ohio Route 720, S 89°-40'-31"W, a distance of 552.61 feet to the point of beginning.

Containing 2.475 acres, of which 0.381 acre is within the highway right-of-way.

Property is subject to any and all previous easements and rights-of-way of record.

The basis for bearings is south line of the northeast quarter of Section 33, being N 89°-40'-31"E, and all other bearings are from angles and distances measured in a field survey by Lee Surveying and Mapping Co., Inc. on May 17, 2010.

Description prepared by:



ORIGINAL STAMP IN GREEN

William K. Bruce
Professional Surveyor 7437
May 18, 2010

4958510

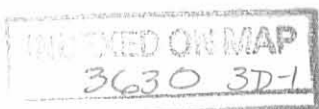

REC'D 5-21-10 SWY OK

Lee Surveying and Mapping Co., Inc.

Land Surveys • Topography • Subdivisions • Construction Layout

117 N. Madriver St.
Bellefontaine OH 43311



Phone: (937) 593-7335
Fax: (937) 593-7444
surveys@lsminc.us

SNAPP 11.985 ACRES

Lying in Section 33, Town 6, Range 8, Stokes Township, Logan County, Ohio.

Being out of the Betty J. Snapp, Transfer on Death to Valerie K. Van Gundy, Errol D. Snapp and Kerry L. Snapp, 14.46 acre tract as deeded and described in Official Record 799, Page 683 of the Logan County Records of Deeds and being more particularly described as follows:

Commencing on a 5/8 inch iron rod found with O.D.O.T. cap in a monument box at the center of Section 33 on the center-line of Ohio Route 720 at Station 41+51 (Logan County Engineer's Field Book 589, Page 31).

THENCE, with the west line of the northeast quarter of Section 33, N 00°-36'-01"W, a distance of 180.00 feet to a 5/8 inch iron rod set at the TRUE POINT OF BEGINNING.

THENCE, with west line of the northeast quarter of Section 33 and the east line of the Daniel L. Burch Jr. and Timothy W. Burch 40 acre tract (O.R. 893, Pg. 907), N 00°-36'-01"W, a distance of 477.60 feet to a 5/8 inch iron rod set.

THENCE, with the south line of the Samuel C. Everhart 9.77 acre tract (O.R. 89, Pg. 96), N 89°-40'-44"E, a distance of 1341.71 feet to a railroad spike found on the center-line of County Highway 83, passing a 5/8 inch iron rod set at 1311.71 feet.

THENCE, with the center-line of County Highway 83 (60 feet wide), S 00°-16'-33"E, a distance of 294.71 feet to a MAG nail set.

THENCE, with the north lines of the Charles M. Barton 2.79 acre tract (O.R. 973, Pg. 458) and the John A. Horne 2.21 acre tract (O.R. 236, Pg. 736), S 89°-40'-27"W, a distance of 600.37 feet to a 5/8 inch iron rod set, passing a 5/8 inch iron rod set at 30.00 feet and a 5/8 inch iron rod found at 335.38 feet.

THENCE, with the west line of the said 2.21 acre tract, S 00°-16'-33"E, a distance of 175.91 feet to a 5/8 inch iron rod set.

THENCE, N 88°-39'-26"W, a distance of 553.98 feet to a 5/8 inch iron rod set.

THENCE, S 00°-36'-00"E, a distance of 23.00 feet to a 1/2 inch iron rod found.

THENCE, with the north lines of the Jon Wickersham 0.19 acre tract and 0.58 acre tract (O.R. 77, Pg. 837, Tract II and Tract I), S 89°-40'-30"W, a distance of 185.00 feet to the point of beginning.

Containing 11.985 acres, of which 0.203 acre is within the highway right-of-way.

Property is subject to any and all previous easements and rights-of-way of record.

The basis for bearings is south line of the northeast quarter of Section 33, being N 89°-40'-31"E, and all other bearings are from angles and distances measured in a field survey by Lee Surveying and Mapping Co., Inc. on May 17, 2010.

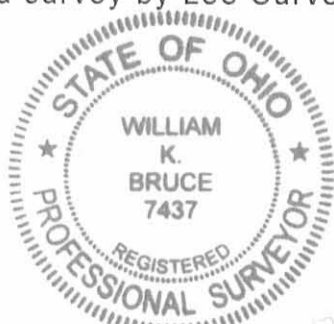

ORIGINAL STAMP IN GREEN

Description prepared by:

A handwritten signature in cursive script that reads 'William K. Bruce'.

William K. Bruce
Professional Surveyor 7437
May 18, 2010

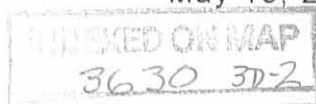

4958510A

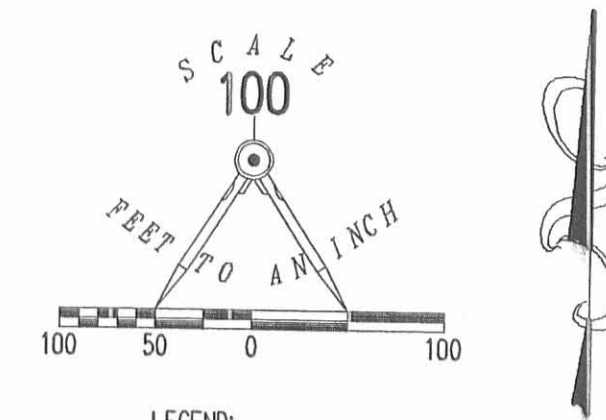

- LEGEND:
- 5/8 INCH IRON ROD FOUND WITH O.D.O.T. CAP IN MONUMENT BOX
 - MAG NAIL SET
 - ⊕ RAILROAD SPIKE FOUND
 - ⊙ 1/2 INCH IRON ROD FOUND
 - ⊙ 1/2 INCH IRON PIPE FOUND
 - 5/8 INCH IRON ROD FOUND
 - 5/8 INCH IRON ROD SET WITH PLASTIC I.D. CAP STAMPED "LSM 7437"

DANIEL L. BURCH JR.
AND TIMOTHY W. BURCH
40 ACRES
O.R. 893, PG. 907

SAMUEL C. EVERHART
9.77 ACRES
O.R. 89, PG. 96

11.985 ACRES
OF WHICH 0.203 ACRE IS WITHIN
THE HIGHWAY RIGHT-OF-WAY

BETTY J. SNAPP, TRANSFER ON DEATH TO
VALERIE K. VAN GUNDY,
ERROL D. SNAPP AND KERRY L. SNAPP
14.46 ACRES
O.R. 799, PG. 683

2.475 ACRES
OF WHICH 0.381 ACRE IS WITHIN
THE HIGHWAY RIGHT-OF-WAY

JOHN A. HORNE
2.21 ACRES
O.R. 236, PG. 736

CHARLES M. BARTON
2.79 ACRES
O.R. 973, PG. 458

QUARTER SECTION LINE

N 00°36'01" W
317.00'

N 00°36'01" W
477.60'

N 00°36'01" W
180.00'

N 00°36'01" W
180.00'

N 89°40'44" E
1341.71'

317.05'
S 00°16'33" E

294.71'
S 00°16'33" E

362.80'

COUNTY HIGHWAY 83 (60')

185.00' 23.00'
S 89°40'30" W

JON WICKERSHAM
O.R. 77, PG. 837

0.58 ACRE
TRACT I

185.00' 30.00'
N 89°40'31" E

0.19 ACRE
TRACT II

180.00'
N 00°36'00" W 203.00'

S 88°39'26" E
553.98'

175.91'
S 00°16'33" E

186.88'
S 00°16'33" E

S 89°40'27" W 600.37'

264.99'

335.38'

30.00'

30.00'

30.00'

552.61'
S 89°40'31" W

720 (60')

600.37'
N 89°40'31" E
(BASIS FOR BEARINGS)

QUARTER SECTION LINE

STATION 41+51
(LOGAN COUNTY ENGINEER'S
FIELD BOOK 589, PG. 31)

CENTER OF SECTION

SURVEY OF TWO TRACTS OUT OF THE
BETTY J. SNAPP, TRANSFER ON DEATH TO
VALERIE K. VAN GUNDY,
ERROL D. SNAPP AND KERRY L. SNAPP
14.46 ACRE TRACT
OFFICIAL RECORD 799, PAGE 683
SECTION 33, TOWN 6, RANGE 8
STOKES TOWNSHIP
LOGAN COUNTY, OHIO

SURVEYED BY:

William K. Bruce
WILLIAM K. BRUCE
PROFESSIONAL SURVEYOR 7437
MAY 17, 2010



COPYRIGHT 2010 BY:
LEE SURVEYING & MAPPING CO., INC.
117 North Madriver Street
BELLEFONTAINE, OHIO 43311
(937) 593-7335
surveys@lsminc.us

KSS D0510 4958510 L-4958-2

2 WORKING DAYS
BEFORE YOU DIG
CALL TOLL FREE 800-362-2764
OHIO UTILITIES PROTECTION SERVICE

INDEXED ON MAP
3630 3P