

Auglaize Co.

Sec 25 T6, R7.

- J = stone in cent pike pce - patented by Daniel Craig March 16th 1885. Limestone 12" x 4" x 16"
- N 1° 5' 67" O. stone q., S & corner Sec 25, T6 R7
- " 40.22 fence on grass line
- " 40.05 cent pike run S 86 1/2° W
- " 63.87 North line to unstoned Reservation, and to S.P. Lidle on North West corner south
- " 80.325 cor Sec 24 & 25
- " 87.065 point in road east
- " 45.28 point on side of Mississippi pike
- " 11.47 center of bridge over much. creek

Sec 25, T6, R7.

March 16th 85 transit line gas 15' W

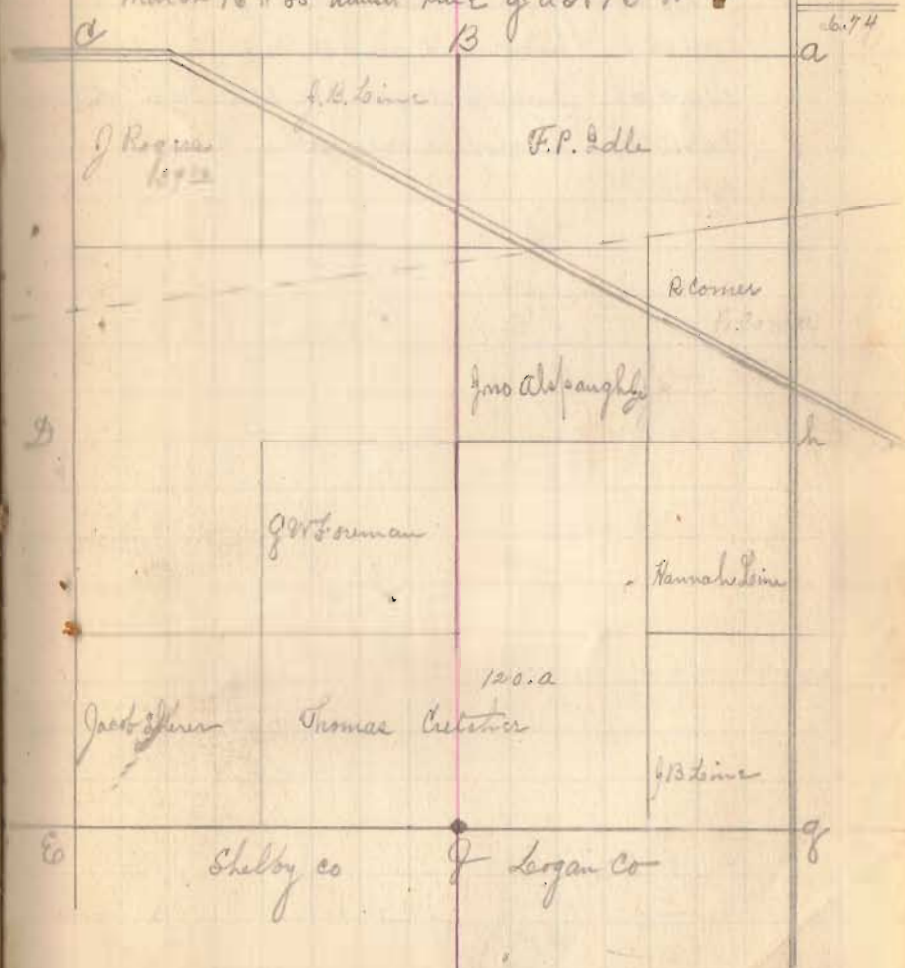

533
INDEXED ON MAP