

Road Near Andrews Farm Stokes

Road # 09

Note that stone B is not in line
between A and C. This is over

about 3' from A.C. Sec. 7

B is 15' from present fence.

No measurements were made
between stones.

See Road Survey Book 559 Page 6

137

INDEXED ON MAP

Sec. 18

June-17-1923

Made

Wright
Ed. Cox

44

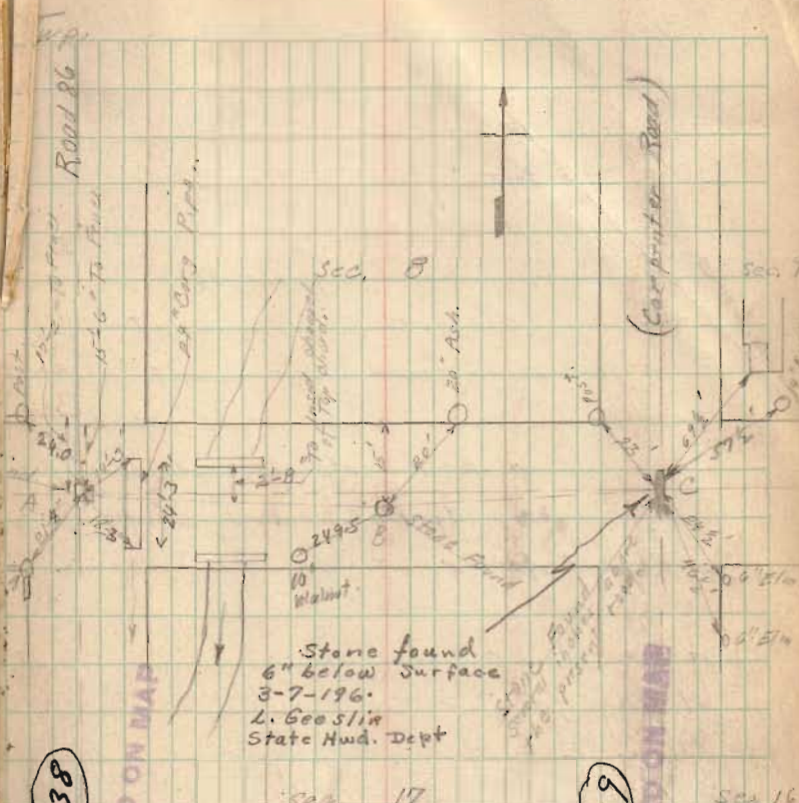

138

INDEXED ON MAP

Sec. 17

139

INDEXED ON MAP

Sec. 16