

Survey  
559

8519

43

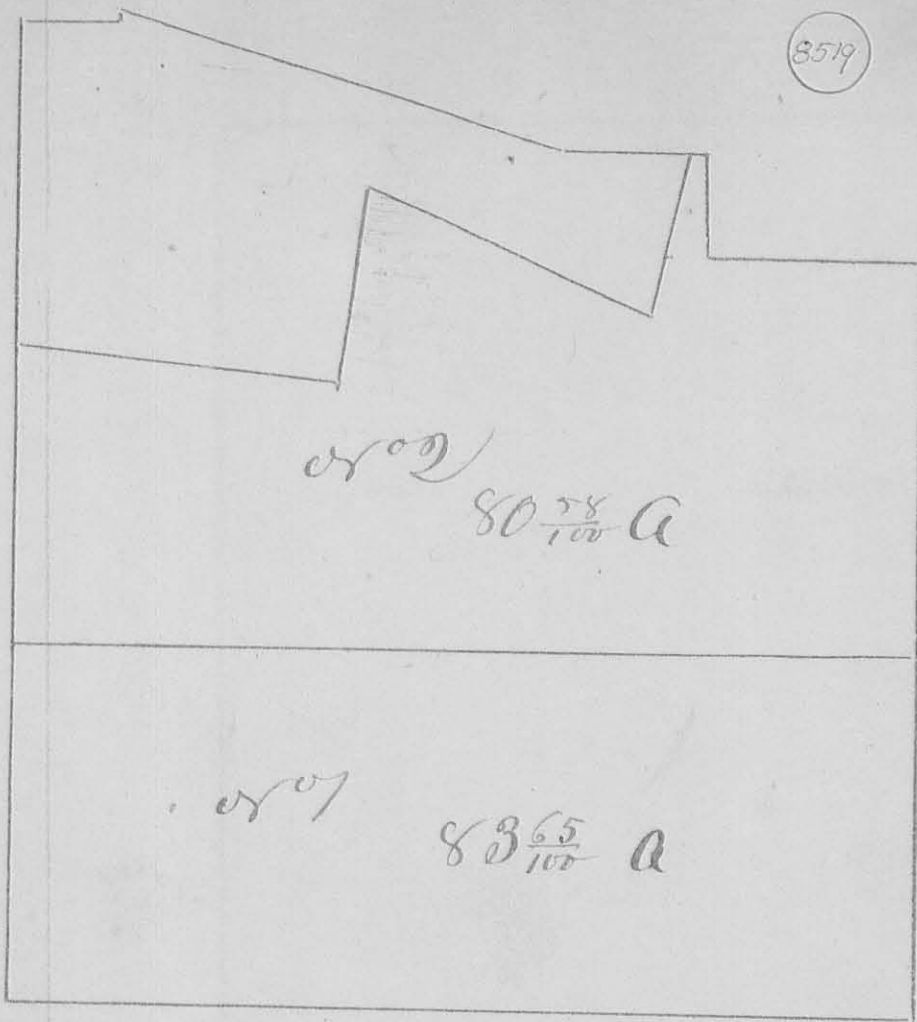

Surveyed Oct 23, 1846 the following lands for  
 Wm Johnson being part of Survey No 9951

Lot No 1, Beginning at 3 Dog-woods & a Red Elm in a Co road  
 & run N 78° E 178 poles 18 links to a Buck & Dog  
 wood, then N 12° W 74 1/2 poles to a stake in Sand  
 Mitchell's West line then S 78° W 178 poles 18 links  
 to a stake in road then with said road S 12° E  
 172 1/2 poles to the Beginning containing 83 65 / 100 acres

Lot No 2, Beginning at a stake in a Co road N W corner  
 to Lot No 1 & run N 12° W 59 poles 18 links to a stake  
 in Co road then N 85° E 68 poles to a stake then N  
 21° W 40 1/2 poles to a stake in Richland & North  
 wood road then with said road S 78 1/2° E 65 poles to a stake  
 in said road then N 1/2° W 39 poles to a stake in Wm Johnson's  
 South line, then N 78° E 3 1/2 poles to a stake then S 12° E 22 p  
 to a stake then N 78° E 4 1/2 p to a stake then S 12° E 79 1/2 poles to a  
 stake in S Mitchell's West line, then S 78° W 178 p to the Beginning  
 containing 80 78 / 100 acres

A. Harrison  
 C & Co. Surv