

Road # 98
Richland TWP.
Time

Nov. 13 30

J. S. Crane

1

J. A. McKirahan

1

Ivan Wickersham

1

Gerald Antrim

1

Lunches

2.00

(1291)
INDEXED ON MAP

side stakes 25' from $\frac{1}{2}$

8+75
old curve

9+00

231.7

88.9

8+79

209.2

Bar II

191.6

7+51.2

63.7

7+09

43'

ACS

280.5

N 37 1/2 E

23° 47'

RR SPIKE
OK - 10.5
10' E

P.C. 0+88.9

P.T. 2+80.5

P.T. 4+65.0

D 23° 47'

E 20'

T 191.6'

D 60'

27.805

148'

62° 45'

N 6 1/2 W

157'

Road # 38

11' 3/4
158.9
40.8 E

RR SPIKE
57.0

covered bridge

Road. 98

Iron Bar 4 Buck 1' deep.

35' from Sacand fence Post East

Wit to stone at Corners line

N.E. of Concrete Pier W. 45.5
forked (linked) S.E. 60'

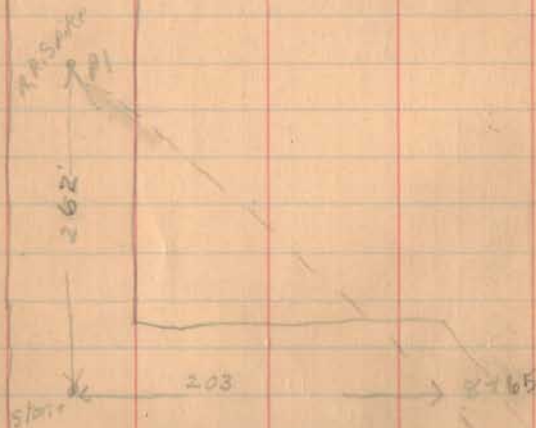

(1291)
INDEXED ON MAP

N. 42 W.

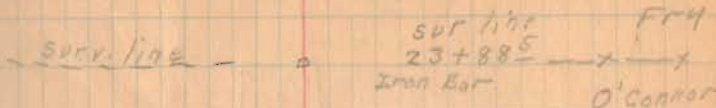

12.7 12.3
21+81 = 2 1/2 x 3
Stone Bot

CONCRETE

Sta. 14 +19'

P.T. 10+132
P.I. 12+367
P.C. 10+998

A 33° 20'
E 20'
T 142.5
O 12°

P.I. 12+367

R.R. SPIKE

262 from stone
at corners & line
to P.I.

Road 98

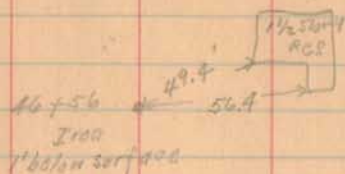

Wit to stone sta 39+78 (1' below surface)

S.W. \angle 1 1/2 story frame Res N.E. 94.3

S.W. \angle Barn N.E. 150.2

(1291)
INDEXED ON MAP

10

80' Tile far Res,

$\leftarrow 40.0$ \times Res $\begin{matrix} 47+15 \\ 46+86 \end{matrix}$

$\&$ 2.0' W of Iron

Iron $46+86$

O'Connor

Woods

130' Tile

O'Connor

$40+60$

O'Connor

$\leftarrow 32.5$

Res

$40+82$

$40+55$

$\&$ 1.9' W of Stone

car post
stone $39+78$

Woods

Fry

$32+15$ $\&$

Road # 96

$26+89$ Drive

Road 98

11

254.

617467 & Road # 98
Iron Bar

O'Connor

O'Connor

2 1/2 m. of stone

O. 55+41 1/2
stone

53489 O-11.5 →
Tree

(129)
INDEXED ON MAP