

Sand. Pruthy 9th mo. (p.) 29th 1830 Survey No. 152

Surveyed 98 1/2 acres for Samuel Pruthy

(3252)

Beginning at a beech stump and fallen sugar tree in fallen timber it being the south west corner of Survey No 9889 and south east corner to Survey No 9888 in Porterfield's name thence with the east line of Survey No 9888 N 72° W. crossing a branch at 3 1/4 poles, 96 poles to 3 Sugar trees; thence N 78° E crossing Mill creek at 128 poles the road from Garwood's Mill to Sandusky at 154 poles, 164 poles to a stake in fallen timber in the east line of Taylor's land; thence with said line S 12° E, crossing the road and Mill creek 96 poles to a beech and sugar tree in the Green willow Swaty line; with said line S 78° W 154 poles to the beginning then run a division line beginning at 3 small sugar trees in the south line 66 1/2 poles, from the south east corner thence N 12° W crossing a small branch several times to 2 beeches and 1 raw horn bush in the north line - thus striking off 40 acres of the east end

3 Sugar. N 78° E 26 1/2 Stake

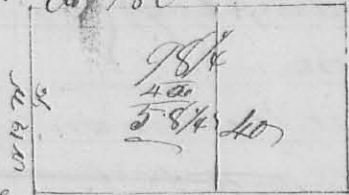

John Parkinson
John King

J. W. Marrison
C. S. L. Co.

Ans. Scholes 10th mo. Oct. 7th 1830

Survey No 153

(3253)

Surveyed 140 acres for John Scholes

Beginning at in the west line of Sec 32 Town 3 R. 14 M. P. 24 poles north of the south west of said sec. thence east 162 poles crossing the road from Bellefontaine to Sidney to a stake in a prairie 24 poles north of the gr. sec corner on the line between Sect 31 & 32; thence north 138 poles to a stake in the center of the sec. where a bur oak bears N 48° W 1/4 line - thence west 162 poles (crossing the roads) to a white oak 2 1/2 inches Diam corner tree in the west line of the sec; thence with said line south 138 poles to the beginning;



Robert Hurlbut & Wm Moore

J. W. Marrison
C. S. L. Co.

124
John
Mathewson
no 154

10th mo Oct. 7th 1830

Survey no 154

154

(E253)

Surveyed 164 acres for John Mathewson
Beginning at a stone, the corner of sect 31, 32, 25, & 26, T. 3, R. 14

M.R. set in a prairie 10 links north of a spring branch; thence north with the original line 162 poles to a stake in a prairie q^r sec corner between sect 26 & 32; thence west 162 poles to a stake, a bur oak 20 in diam. N 28 W 44 links dist. Thence south 162 poles to a stone, the q^r sec corner on the line between sect 31 & 32 thence east 162 poles to the beginning it being the S.E. q^r of the sec 32 T. 3 R. 14. M.R.

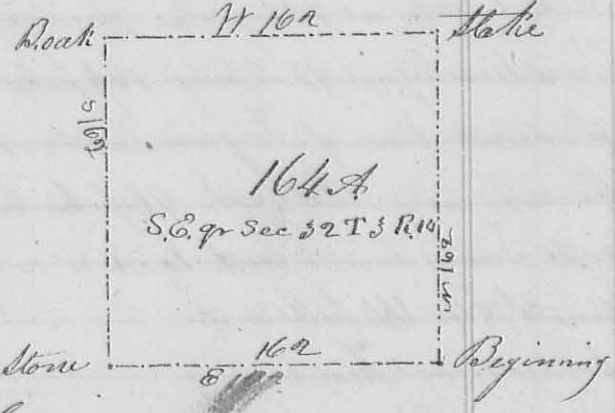

Robert Humphreys
Wm Moore
James Mathewson

Thos Butler
no 155

10th mo Oct. 2nd 1830

Survey no 155

155

Surveyed 231 acres for Thomas Butler

(E254) Beginning at a beech sugar and cherry tree, the cherry tree is down in the west line of Alex. S. Dandridge's survey no 3220 and south east corner to his survey no 4478, thence north with the west line of the former survey, crossing the road from Bellefontaine to Jarvisfield at 80 poles, 320 poles to a sugar tree to a sugar tree hickory and beech N.W. corner to survey no 3220, thence with the north line of the original survey east crossing a branch at 120 poles, 163 poles to three beeches, sugar tree hickory & beech N.W. corner to Joseph Dickinson's land thence with his west line south crossing a branch at 88 poles, 163 poles to a stake in a marsh N.W. corner to Dickinson; thence with his south line east 16 1/2 poles to the west side of the water in McKey's blue ash and white walnut creek; thence down the creek with its meanders crossing said road to 2 sugar trees on the west bank of the creek 23 1/2 poles east of the beginning; thence west 23 1/2 poles to the

