

104 a white oak 26 in. diam. S30E 9 L. a hickory ¹⁰⁴
 4 in diam. r 2 1/2 N 27 L. - 2nd Division Beginning
 at an elm 18 in diam. west 22 L. in the south line
 102 1/2 poles from either corner thence north marked
 a white oak 26 in. diam. S12 N 6 links. a white oak
 30 inches diam. r 70 E 6 links. at 80 1/2 poles, passing the
 center corner at 169 1/2 poles, 322 poles to a stake in a
 prairie in the north line of the Section -

3rd Division Begin at 3 elms growing from one root S18E
 12 links dist in the south line of the sec. 84 1/2 poles
 west of the elm thence north 161 poles to the 3 willows
 on the bank of the creek

(8137) 11th mo. (Nov) 18th 1829 Survey N^o 125
 Surveyed 70 1/4 acres for Thomas Macamson

Beginning 70 poles north of the S.E. corner of Sec. 31
 Town 3 Range 14 Mtd. a white oak 18 in. diam. S23L dist
 a birch oak r 45 E 34 L. - thence east 22 1/2 poles to a
 white oak 12 inches diam. N7E 39 L. - thence north 51
 poles to a stake in a cornfield
 thence r 70 N 25 poles to a stake
 in a prairie and in the east line
 of Robert Humphrey's land
 thence with said line south
 58 poles to the beginning con-
 taining a part of the S.E. q^r
 of said section

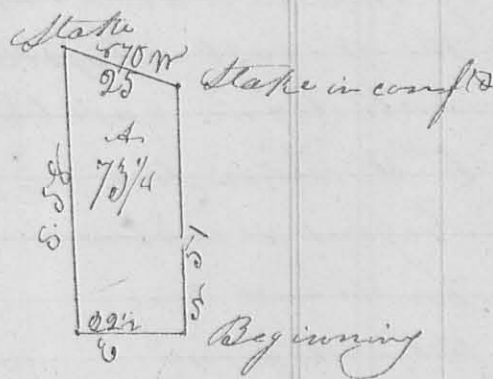

William Blair } 66
 Hugh Schooner }
 Lizzy & page }
 J. C. Marmen
 C. L. L. C.

(8138) 11th mo. 12th 1830 Survey N^o 124
 Surveyed 158 1/2 acres of land for Robert R. Dantape
 Beginning at a sugar tree and buck in the east line
 of Benjamin Boffard's Survey N^o 46588, 4678 and
 north west corner to a lot of Gary's land thence r 37 N
 (leaving a branch) at 16 poles 84 1/2 pole passed 2 trees marked

as a corner, 196 poles to 2 elms and hickory, corner to Boyl
 - saw's said survey, found them 6 poles to the left hand
 Hence the true bearing of this line is $N 38 \frac{1}{2} W$ - Thence
 $N 5 \frac{3}{4} E$ (crossing a branch at 57 poles) 140 poles to 2 sugar
 - trees, westerly corner to James Danney's survey no 1502
 Thence $N 38 E$ (crossing a
 branch at 34 poles) 180 poles
 to 2 beeches - Thence $N 50 W$
 (crossing a branch at 118
 poles) 238 poles to the
 beginning containing
 158 1/2 acres, the north
 end of Thomas Camp
 bell's survey no 4750 -



1st mo. 14th 1830

Survey no. 125

Surveyed 5 acres of land for Ebenezer Jones
 Beginning at a stone on the south side of the road
 from Jamesfield to Garwood's mill where east line of
 Ebenezer Jones' land as shown by A. L. Hunt crosses said
 road, - thence $N 79 W$ with said road 16 poles to a stake
 thence $N 6 W$ 50 poles, crossing a branch, to a forked bush
 in the north line of Benjamin Smith's land
 thence with said line $S 75 E$ 16 poles stake - Beginning
 to two ironwoods and hickory at the
 N.E. corner Smith's land thence
 $N 15 E$ 50 poles crossing a spring forked
 branches to the beginning
 being part of James Calderwood's survey no
 3137

Robert Dickinson
 J. W. Pullarmon

James Pullarmon C. S. & Co.

3rd mo. (March) 3rd 1830

Survey no 126

8238

Surveyed fifty acres of land for
 William Danson, beginning at 2 small hickories, south
 east corner to Robert Smith's land and north east corner to,