

# Lee Surveying and Mapping Co.



CLAYTON M. LEE, P.S.  
JEFFREY I. LEE, P.S.

855 East Sandusky Avenue  
Bellefontaine, Ohio 43311  
Phone 593-5780



Farm Surveys • Lot Surveys • Topography • Subdivisions • Construction Layout

## BIONDI TO LOCKWOOD

PAGE 1.

Lying in V.M.S. 3221, Monroe Township, Logan County, Ohio.

### TRACT 1:

Being that 84.52 acre tract lying in the name of Biondi as deeded and described in Volume 402, Page 622 (Tract 2) of the Logan County Records of Deeds.

EXCEPT the following tract deeded and described in Volume \_\_\_\_\_, Page \_\_\_\_\_ of the Logan County Records of Deeds, described as follows:

### BIONDI TO KINNEY

Lying in V.M.S. 3221, Monroe Township, Logan County, Ohio.

Being out of that land lying in the name of Robert Biondi, as deeded and described in Volume 402, Page 622 of the Logan County Records of Deeds and being more particularly described as follows:

Beginning at a railroad spike set on the center-line of County Road 29, a distance of 631.2 feet easterly along said center-line from the center-line of County Road 29 and also being easterly along said center-line a distance of 125.00 feet from the northeast corner of the A.M.E. Church property. (Volume 32, Page 333).

THENCE, with the center-line of County Road 29, N 76°-00' E, a distance of 379.06 feet to an angle in said center-line (Found 2" iron).

THENCE, continuing with said center-line, a distance of 258.69 feet to a railroad spike.

THENCE, S 21°-28'-40" E, a distance of 527.92 feet to an iron rod.

THENCE, S 76°-30'-50" W, a distance of 638.80 feet to an iron rod.

THENCE, N 21°-28'-40" W, a distance of 520.02 feet to the point of beginning.

Containing 7.600 acres. Leaving for transfer 76.92 acres of said Tract 2.

ALSO the following:

### TRACT II:

### BIONDI TO LOCKWOOD (30 ACRES)

Also lying in V.M.S. 3221, Monroe Township, Logan County, Ohio.

Being out of the northeast part of that 87.036 acre tract lying in the name of Biondi as deeded and described in Volume 402, Page 622, Tract 1, of the Logan County Records of Deeds and being more particularly described as follows:

Beginning at a 5/8" iron rod found on the east line of V.M.S. 3221, marking the northeast corner of said 87.036 acre tract and also being the southeast corner of Earl Peter's 11.54 acre tract (Volume 361, Page 769).

THENCE, with said V.M.S. line and property line, S 14°-27'-20" E, a distance of 660.00 feet to a 5/8" iron rod.

THENCE, parallel to the north line of said 87.036 acres, S 74°-51'-40" W, a distance of 1980.14 feet to a 5/8" iron rod.

THENCE, parallel to the east line, N 14°-27'-20" W, a distance of 660.00 feet to a 5/8" iron rod set on the north line of said 87.036 acres.

THENCE, with said north line, N 74°-51'-40" E, a distance of 1980.14 feet to the point of beginning.

Containing 30.00 acres.

Making a total for transfer of 106.92 acres.

ALSO: A 30 foot wide easement for access to the above 30 acre tract running from County Road 28 to said 30 acres, being over that present drive running through grantor's land and being adjacent to and north of the north line of Wenger's 7.344 acre tract (Volume 400, Page 383) and extending to the west line of said 30 acres.

7284 ID

INDEXED ON DAY

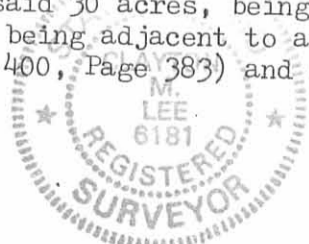

Prepared by:

*Clayton M. Lee*  
Clayton M. Lee  
Registered Surveyor No. 6181

ORIGINAL STAMP IN GREEN

CO. RD. 28

D.G. KINNEY  
4.93 AC.

E.D. RICHARDS  
15.00 AC.  
VOL. 399, PG. 226

BIONDI TO LOCKWOOD  
76.92 ACRES  
(PT. OF ORIG. 84.52 AC.  
VOL. 402, PG. 622  
TRACT 2)

EARL PETERS  
11.54 ACRES  
VOL. 361, PG. 769

467.1'  
823.18'

859.34'

FOUND 5/8" IRON ROD N 74°-51'-40" E

FOUND 5/8" IRON ROD

FOUND 5/8" IRON ROD

1980.14'

SET 5/8" IRON ROD

30' WIDE ACCESS EASEMENT

179.6' 208.3' 280.1'

WENGER  
7.344 AC  
VOL. 400, PG. 383

N 14°-27'-20" W  
660.00'

BIONDI TO LOCKWOOD  
30,000 ACRES

S 14°-27'-20" E  
660.00'

H.H. WILLETS  
55.38 AC.  
VOL. 222, PG. 494

SCALE ~  
1" = 300'

S 74°-51'-40" W  
1980.14'

SET 5/8" IRON ROD

BIONDI  
PT. OF 87.036 AC.  
VOL. 402, PG. 622  
TRACT 1

89°-19'

V.M.S. 3221

V.M.S. 4676

SET 5/8" IRON ROD

SURVEY OF 30,000 ACRES OUT OF THE  
ROBERT BIONDI 87.036 ACRE TRACT (VOL. 402, PG. 622, TRACT 1)  
V.M.S. 3221, MONROE TOWNSHIP, LOGAN COUNTY, OHIO

7284 IP

INDEXED ON MAP



ORIGINAL STAMP IN GREEN

By: Jeffrey I. Lee  
JEFFREY I. LEE  
REG. SURVEYOR 6359  
DEC. 7, 1984

L-1179-4