

at same time Surveyed 80 acres off the North end of
the foregoing quarter Section as follows. beginning at a stone
then $S 89^{\circ} 20' W$ 39 ch. 50 L. to a stake in a prairie, then $S 74^{\circ} W$
20 ch. 25 Links, curving a pond to an Elm 8 inches diameter
Corner tree - then $N 89^{\circ} 20' E$ 39 ch. 50 Links to an Elm 8 in. d.
 $N 80^{\circ} W$ 4 Links, a White oak 3 in. d. 54568 Links - then $N 74^{\circ} W$
20 ch. 25 Links -

D. Hopkins Co. Surveyor G. B.

N^o 323

8378

Surveyed April 29th 1836 for John Pattato, brother a Division
line between them, dividing a lot of land containing $199 \frac{166}{1000}$ acres
into two equal parts (See Survey N^o 248 page 204) as follows -
beginning on the East line of said lot 22 chain from either corner
at a Buck 12 in. d. $S 40^{\circ} E$ 21 Links, Ash 2 in. d. $N 62^{\circ} W$ 11 Links, then
 $N 89^{\circ} 20' W$ 45 ch. 30 Links, crossing Indian Creek at 19 chain to a black
Ash 18 in. d. $N 64^{\circ} W$ 20 Links, Cypress 20 in. d. $S 63^{\circ} E$ 32 Links, in the West
Line of said Lot, and of the distant from either corner, dividing the
lot into two equal parts, containing each $99 \frac{72}{1000}$ acres -

D. Hopkins Co. Surveyor G. B.

N^o 324

8378

Surveyed July 29th 1836 for Griffin Johnson a lot of land including
a Saw mill and appurtenances as follows. Beginning at the NW
Corner of $S 35^{\circ} 59' R$ 12 in. d. S, then $S 74^{\circ} W$ 9 ch. 48 $\frac{1}{2}$ Links to a Buck
15 in. d. $S 35^{\circ} W$ 12 Links, 10. 15 in. d. $N 35^{\circ} E$ 55 Links, then $S 89^{\circ} 20' E$ 9 ch. 48 $\frac{1}{2}$
Links to a Cherry 18 in. d. $S 63^{\circ} E$ 50 Links, Logwood 4 in. d. $N 20^{\circ} W$ 49
Links, then $N 74^{\circ} E$ 9 ch. 48 $\frac{1}{2}$ Links to a Buck 15 in. d. Catt 18 Links,
and Buck 6 in. d. $S 48^{\circ} W$ 31 L. - then $N 89^{\circ} 20' W$ 9 ch. 48 $\frac{1}{2}$ Links, crossing
Indian Creek to the beginning. Containing 9 acres.

D. Hopkins Co. Surveyor G. B.

N^o 325

8379

Surveyed for John Leach Mrs Dryden the NW quarter of $S 16^{\circ} 42'$
 $R 12$ in. d. S. Beginning at the N. E. corner of said quarter Section
at a White oak 24 in. d. $N 80^{\circ} W$ 10 L. a Buck 12 in. d. $S 62^{\circ} E$ 16 Links - then
 $S 74^{\circ} W$ 41 ch. 20 Links, Co. Road at 11.50 to a Buck 12 in. d. $S 25^{\circ} E$ 20 L. and
White Buck 2 in. d. $N 77^{\circ} W$ 11 Links, then West 40 ch. 25 Links to the o.
iginal q. corner on the West line of the Section, then $N 74^{\circ} E$ 41 ch. 20
Links to the NW corner of the Section, then with the North line thence
 $S 89^{\circ} 20'$ East 40 ch. 25 Links to the beginning. Containing $166 \frac{42}{1000}$ acres.

63 $\frac{72}{1000}$

then dividing the same into ten parts as follows. Beginning on the south line of said quarter section, 20 ch. 12 links from either corner, at a White Oak 26 inches diameter 880 E 26 Links, Reach 16 in. dr. N 80 W 11 Links - then on N 2 E 41 chain 35 Links to a Bush 10 in. dr. N 41 1/2 E 6 1/2 links to a gum 5 in. dr. N 56 W 29 Links, in the north line of said Q 20.12 from either corner -

D. Hopkins Co. Surveyor G. C.

N^o 326

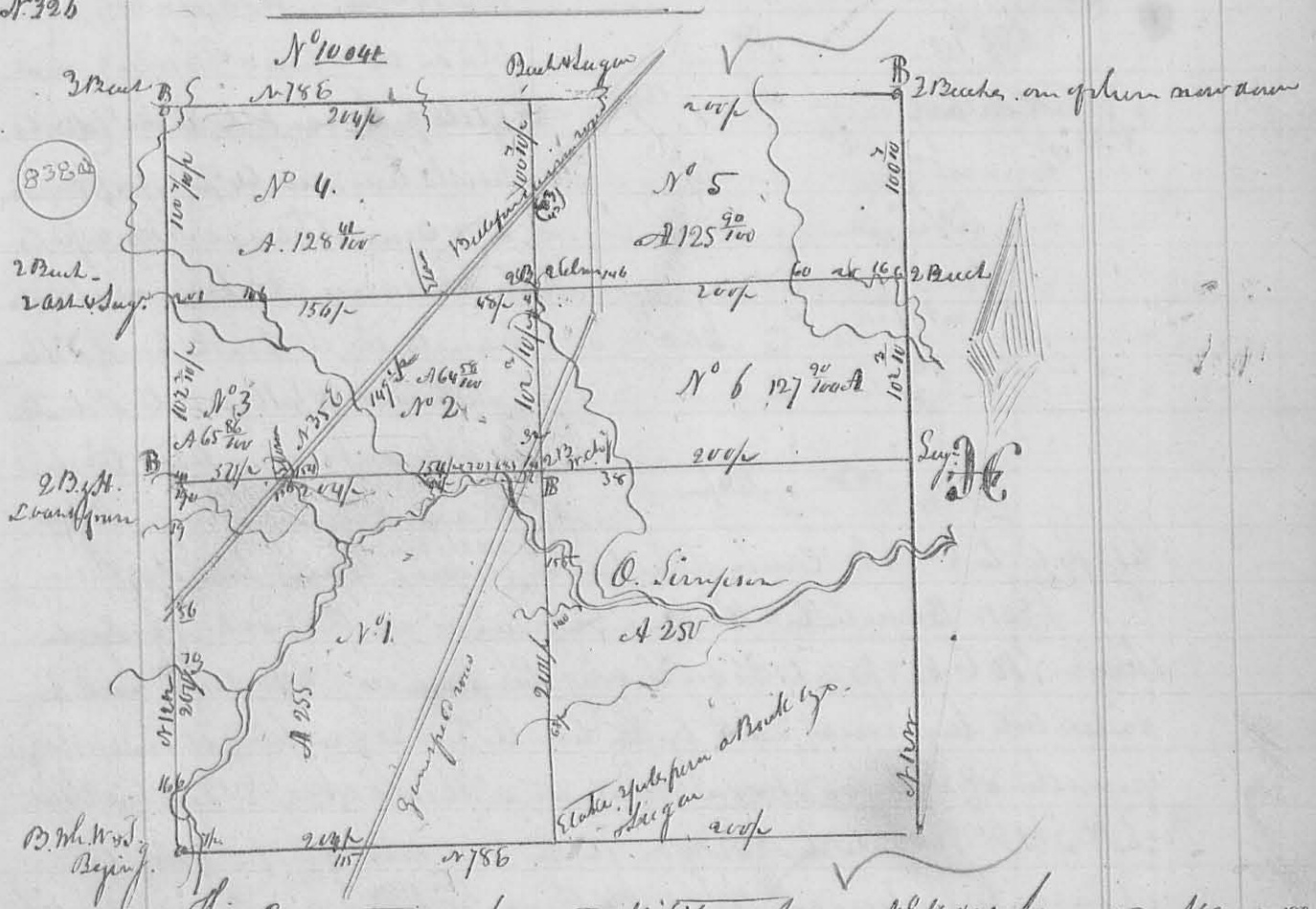

This connection represents Military Survey N^o 10041 surveyed May 9, 1836 for Signs starting ESE lying on the waters of Rush Creek - The course of the lines N 10 W & at right angles therewith, except the line between Lots N^o 2 & 3, which runs with the Big road from a stone in the road, when the north line of lot N^o 1 crosses N 35 E to a stone, when the north line of N^o 4 crosses the Survey road, the figures with the letter p before them on the lines represent their respective lengths from corner to corner, the others (smaller) show the pole at which the branches were capped in going round the survey. B this letter denotes the beginning of each lot - except N^o 1 which begins in the south West corner of the origin of survey, the course, as noted on the map, and also the contents in acres.

Thos. Jones
John Fay } ch. men
Jacob Geary H. K. S.

D. Hopkins Co. Surveyor G. C.