

July A.D. 1835

N^o 282

Registery

8351

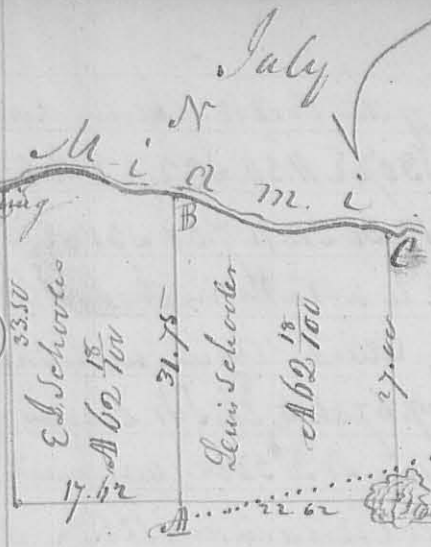

Surveyed July 18. 1835 for Lewis & Evan J. Scholer the west half of fractional Sect. 18 S. 3. R. 12 W. as follows beginning at the NW corner of said section at a stake near the river then South 33. ch 50 links to the W corner of the section. thence with the South line thence of East 40 ch. 25 links crossing a road at 22 ch. to a stake in a pond. thence North 27 chains crossing road at 4.30 to a red oak 7 1/2 S. 53 1/2 E 17 Links, a B. Oak 8 1/2 S. 55 W 14 links on the bank of the river, thence with the Meander as follows N 77 1/2 E 6.25 S 88 1/2 W 2.00 S 79 1/4 W 2.50 N 77 1/4 W 4.35 N 66 W 3.55 N 72 W 4.35 N 75 E 5.20 N 65 W 3.90 N 81 1/2 W 3.30 S 81 W 3.37 S 71 W 2.30 to the beginning containing 124 3/4 acres. Divided into two equal parts by the line A. B. Beginning at A. on the South line of the section 17 ch 62 links from the NW corner thence at an Ash 8 1/2 S. East 39 Links, & Dogwood 8 1/2 S. 50 W 26 Links, running thence North 31 ch 75 Links to a Buckeye 8 1/2 S. 28 1/2 W 17 & Hickory 18 1/2 S. 78 E 12 Links at the end of the line. A. & distance from Lewis Scholer's N. E. corner, on the river (See sketch)

L. A. Hopkins, L. C. Sawyer.

N^o 283

8352

Surveyed July 31st 1835 for Abram Gardner the S. E. q. of the South East of S. 4. T. 5. R. 8 E. Beginning at the NW corner a Beech 18 1/2 S. 87 W 30 Links, Sugar tree 17 1/2 E 8 Links in the South line of the Sect. & center of South line of said q. thence N. 3. 50 W 20 chains to a Beech 6 1/2 S. 20 W 4 Links, White Oak 17 1/2 S. 45 W 43 Links, thence N 86. 10 E 20 ch. 30 links to a Beech 8 1/2 S. 10 E 4 Links and a pine 18 1/2 S. 60 E 11 Links, thence S 3. 50 E 20 chains to the South East corner of the section, thence S 86 10 W 20 chains 50 Links to the beginning containing 61 acres

L. A. Hopkins, L. C. Sawyer.

N^o 284

8353

Surveyed August 1. 1835 for Saml^d Hall a part of the S. W. q. of S. 4. T. 5. R. 8 E. and part of the West half of the S. E. q. of the same Sect. as follows Beginning at q. corner on the West line of the Sect. 100 North 1/2 ch. thence N 86. 10 E 29 ch. 25 Links to a pinked hollow 10 1/2 S. 55 W 35 Links, Gray ash 18 1/2 S. 76 W 55 Links on the creek, the