

Co. Road No 37

H-15-31

fine day  
Bridge - 9  
McNairham  
Antrim  
Wickham

17+85 Lane

9+25

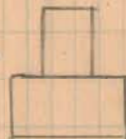

Need/c  
N 83° 45' E

Stone found  
1" pipe set

210'

215'

Old Corner Stone  
Angle 26' Left  
Sta 0+00

0+00 - N 6° 30' W  
Road No 49

25.5'  
Cur. pipe

290'

41.7'

1296  
INDEXED ON MAP

Road No 37

4-15-31

60

125  
INDEXED ON MAP

12" Walnut

Thatcher

M. Zirkle

⊙

52'-3"

X X X X X

12" Ash  
Sta 22+10

Angle 45' Right  
old Cornerstone

⊙ 41'-10"

~~185 E~~  
N-84-50 E

Sta 24+12

X X X X X



Road No 37

Tuttle

4-15-31

61

48+80

42+00 res.

Hurley

40+85

N 84-20 E  
N 83 E

8" Hickory

6" Elm

63.6'

22'-10"

8" Hickory

Angle 07' Left

Iron bolt Placed

32+00

1296  
INDEXED ON MAP

Co. Road No. 37

4-16-31  
fine day 62  
Bridge  
Mekarahan  
Antrim  
Wickersham

needle  
N 82 E

301-51  
1V 83-40 E

Sta. 55+96  
Angle 93' Left  
 $\frac{3}{4}$ " iron bolt placed  
86" 14" sugar

ICH. 276

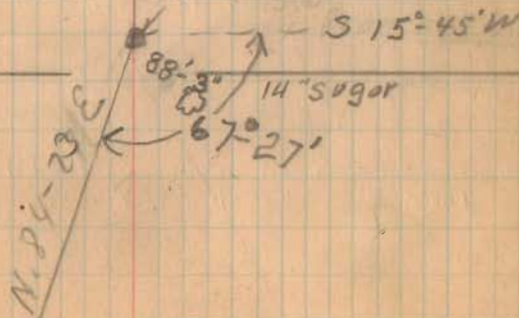

1296  
INDEXED ON MAP



Co. Road No 37

Measurements for Pipe Feb-29-1932

37 @	7.00	Road 49
	7.20	18" x 28' cong Add 4' N
	7.35	12" x 24' cong add 6' N 4' S.
	7.55	Field Tile 10" x 16' New 34'
	7.60	Wood Box 12' x 8' x 14' New 36'
	7.70	12" x 16' 8' on N 10' on S.
	7.95	Field Tile 12" x 18' New 34'
	8.10	36" x 31' cong 12' on N. 3
	8.15	S. H. 226

July - 24-1935

F. W. 417

E. 206

J. Montgomery

± Road south on shoots West Line Measured 3015'  
 shoots Deed Vol. 129-559  $\frac{3529.25}{+26.25}$

± Road south on Kemper East Line Measured 2458'  
 Kemper Deed Vol 142-291  $\frac{2440}{+18}$

± Road south on Shoots East Line Measured 3576'  
 Shoots Deed Vol. 129-559  $\frac{3529.25}{+1276}$

1296

INDEXED ON MAP

± Road south on Miller (S. Hall) West Line Measured 2496'  
 Miller Deed Vol. 110-457  $\frac{2491.5}{+4.5}$

4-16-31

63

(See Page 79)

Rushcreek Twp.  
 Township  
 McArthur  
 Line  
 Twp.

Rose

3-11-37  
 New Fence

22.3

27.6

53.75

shoots  
 Angle 37' Right  
 $579.66 + 93.70$   
 3/4" pipe placed  
 6" Hickory  
 106' walrus

Kemper

3-11-37  
 New Fence

