

Received 2-5-98

RICHARD A. BRUCE, P.E., P.S.
Registered Land Surveyor No. 6993

513/465 - 7412

Bruce Land Surveying
4293 Road 171, West Liberty, Ohio 43357



HALL SURVEY
S.25,T.4,R.14
S.30,T.5,R.13
LIBERTY TOWNSHIP
LOGAN COUNTY, OHIO

The following described real estate situated in the State of Ohio, County of Logan, Township of Liberty, being part of Section 25, Town 4, Range 14, and part of Section 30, Town 5, Range 13, and more particularly described as follows:

Commencing at a railroad spike found in the center of T.R. 190 and in the east line of Section 30.

THENCE, with the center of T.R. 190, N.85°30'W. 199.43 feet to a railroad spike set, said spike being the True Point of Beginning of this description.

THENCE, continuing with the center of T.R. 190, N.85°30'W. 60.00 feet to a railroad spike set marking the southeast corner of Dale M. and Patricia A. McClure's 26.76 acre tract, D.B.367, Pg.801.

THENCE, with the east line of said McClure, N.4°44'52"E. 802.95 feet to a stone found in the north line of Section 30 marking the northeast corner of said McClure's 26.76 acre tract, and the southeast corner of said McClure's 172.96 acre tract, passing a 5/8 inch iron bar set at 20.00 feet.

THENCE, with the east line of said McClure's 172.96 acre tract, N.3°57'30"E. 1903.84 feet to a 5/8 inch iron bar set.

THENCE, S.85°56'49"E. 260.03 feet to a 5/8 inch iron bar set in the east line of Section 25.

THENCE, with the east line of Section 25, S.3°57'30"W. 1907.41 feet to a Re-survey monument found marking the southeast corner of Section 25.

THENCE, with the south line of Section 25, N.85°09'35"W. 200.07 feet to a 5/8 inch iron bar set.

THENCE, S.4°44'52"W. 802.59 feet to the point of beginning, passing a 5/8 inch iron bar set at 782.59 feet.

INDEXED ON MAP

799/10-1

RICHARD A. BRUCE, P.E., P.S.
Registered Land Surveyor No. 6993

513/465 - 7412

Bruce Land Surveying
4293 Road 171, West Liberty, Ohio 43357



Containing 12.482 acres, more or less, of which 11.376 acres are in Section 25, Town 5, Range 14, and 1.106 acres are in Section 30, Town 5, Range 13.

Basis for Bearing: Centerline of T.R. 190= N.85°30'W.

The above described 12.482 acre tract being all of the 11.37 acres of Tract I and part of the 4.76 acre of Tract II in the name of Burley E. and Patricia M. Hall as described in O.R.99, Pg.441.

This description prepared from an actual field survey.

Prepared by: Richard A. Bruce
Richard A. Bruce
Reg. Surveyor No. 6993
January 30, 1990



INDEXED ON MAP
799/1D.2

HALL SURVEY
 S.25, T.4, R.14
 S.30, T.5, R.13
 LIBERTY TWP.
 LOGAN CO., OHIO

BY: Richard A. Bruce
 RICHARD A. BRUCE
 REG. SURVEYOR 6993
 JANUARY 30, 1990



Dale M. †
 Patricia A. McClure
 D.B. 367 Pg. 801
 172.96 Ac.

Doral C. †
 Janet Mae Neal
 D.B. 243 Pg. 390
 38 Ac.

Burley E. †
 Patricia M. Hall
 O.R. 99 Pg. 441
 54.81 Ac.



SCALE: 1" = 300'

- 5/8" φ IRON SET
- RR SPIKE SET
- RR SPIKE FND.
- ⊕ STONE FND.
- ⊕⊕ RESURVEY MON. FND.

SEC. 25, T.4, R.14

SECTION LINE

SEC. 30, T.5, R.13

1.106 Ac.
 26.76 Ac.

11.376 Ac.

4.76 Ac.
 Total

SEC. 19, T.4, R.14

SEC. 24, T.5, R.13

21 Ac.

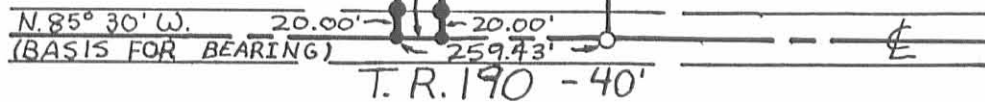

T. R. 190 - 40'

INDEXED ON MAP
 799 / 1P