

358

N^o 353

8394

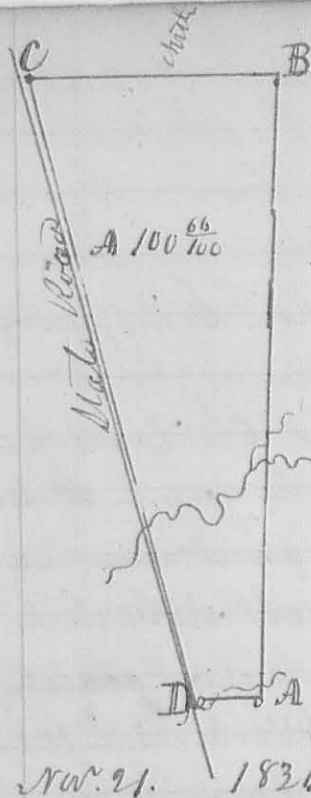

Surveyed for James Gordon on application of Robert Patterson Esq. part of Survey N^o 5045 as follows. Beginning at the South East Corner of said Survey (See letter A) at a white oak & Black Oak, thence N 15° 25' 58" pole, crossing the Mack River at 86 poles, ~~crossing~~ branch at 101 poles to two Black Oaks, thence West 102 1/2 poles to two Black Oaks (both down), in the Big road thence with said road 120 to 270 poles, crossing a run at 190 poles to a stem, the original corner is gone, thence East 22 poles crossing a branch at 18 poles to the beginning containing 100 66/100 acres. Dan Hopkins Co. Sur. G. C.

Nov. 21. 1836.

Robert Patterson Esq. James Gordon

N^o 354

8395

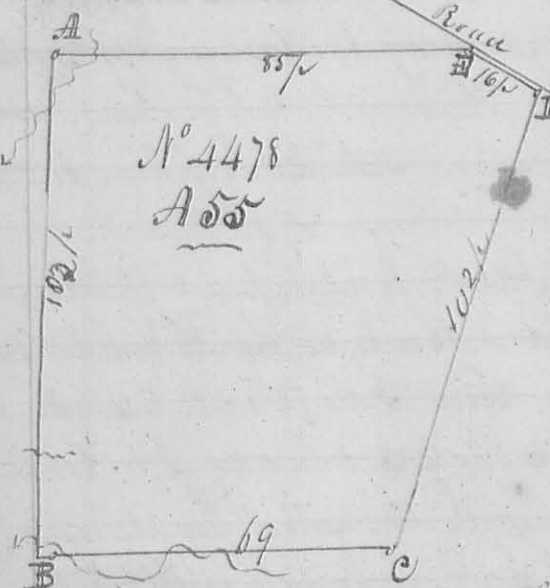

Surveyed Nov. 26. 1836 for Isaac Savage part of Military Survey N^o 4478 as follows. Beginning at a Sugar and Elm N. E. corner near to Joseph Marquis and come to Lupo Millner (See letter C) thence C. D. N 19° 6' 102 poles to Mark in the parcelled road and in the Southly line of George Knutke's, thence with his line N 71° 10' 16 poles to a hickory, comes between said Knutke's & Lupo's, thence with 88 poles, crossing a stem, comes between said Knutke's & Lupo's, at 39 poles, crossing Lupo's branch at 74 poles to a stem near a small Hickory, thence South 103 poles, crossing a branch at 16 poles, then at 102 poles to a stem in Joseph Marquis' North line, thence 88 1/2 poles, crossing a small branch seen at times to the beginning containing 55 acres. Isaac Savage, David Barrett Esq. } Dan Hopkins Co. Sur. G. C.

Isaac Savage, David Barrett Esq. }

Dan Hopkins Co. Sur. G. C.

