



3/18/43

3/4" \square iron found in road. No other mark of identification. Monument set at point 18" North of iron above mentioned, being the section corner mentioned Field Book 492 P15-21

Monument is set about 8" below surface of roadway

Wano Kerns

Fay Hurst

R.H. Reed

Monument stamped as directed above

3/18/43

R.H.R.

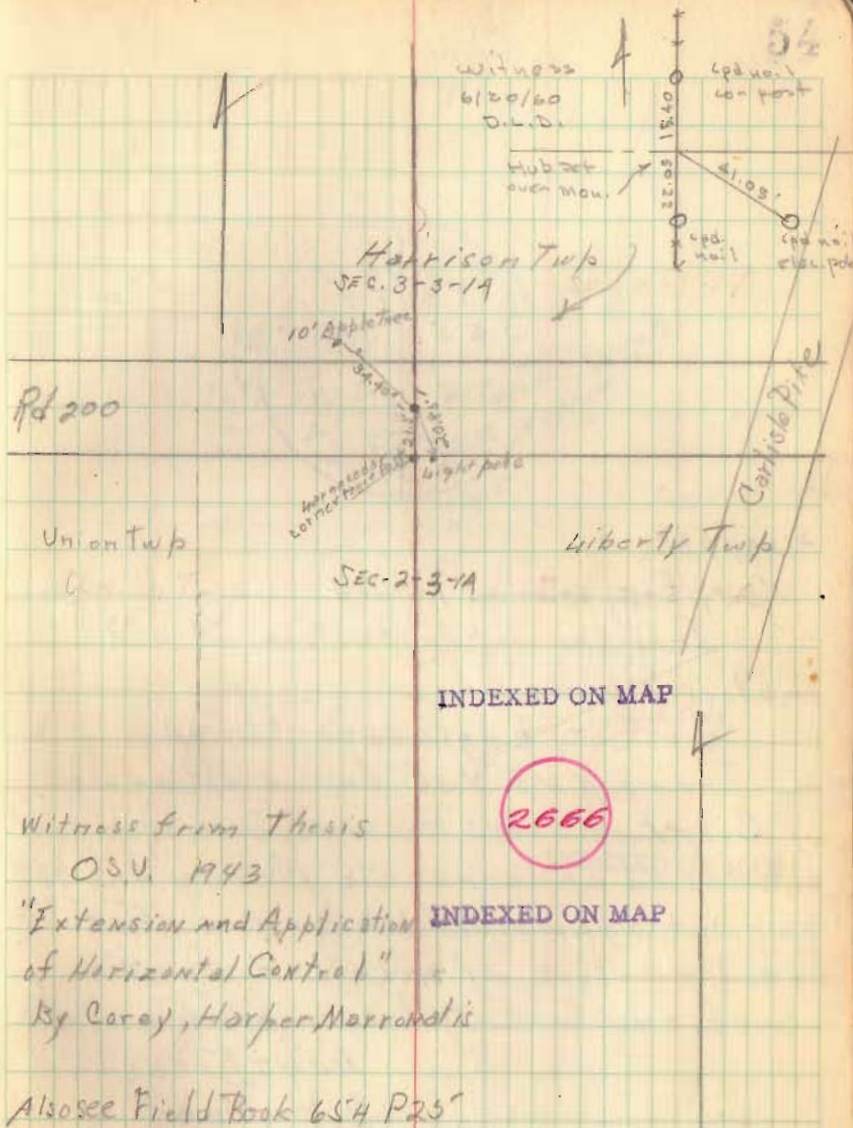

Witness from Thesis

OSU, 1943

"Extension and Application of Horizontal Control"

By Carey, Harper, Marrantis

Also see Field Book 654 P25