

REC'D 3-14-02 8M OK

Lee Surveying and Mapping Co., Inc.

Land Surveys • Topography • Subdivisions • Construction Layout

117 N. Madriver St.
Bellefontaine OH 43311



Phone: (937) 593-7335
Fax: (937) 593-7444

MAYS 1.696 ACRES

Lying in Virginia Military Survey 2674, Jefferson Township, Logan County, Ohio.

Being out of the W. Page Mays, Jr. and Grace M. Mays 33 acre and 120 rod tract and 6.37 acre tract as both are deeded and described in Official Record 517, Page 654, Parcel 3, Tract II and III of the Logan County Records of Deeds and being more particularly described as follows:

Beginning at a 3/8 inch iron rod found at Station 148+80 (Logan County Engineer's files: Field Book 579, Page 58) on the center-line of County Highway 2.

THENCE, with the center-line of County Highway 2 (60 feet wide), S 67°-04'-50" W, a distance of 31.44 feet to a MAG nail set at the TRUE POINT OF BEGINNING.

THENCE, with the center-line of County Highway 2, S 67°-04'-50" W, a distance of 215.00 feet to a MAG nail set.

THENCE, N 5°-31'-00" W, a distance of 360.00 feet to a 5/8 inch iron rod set, passing a 5/8 inch iron rod set at 31.44 feet.

THENCE, N 67°-04'-50" E, a distance of 215.00 feet to a 5/8 inch iron rod set.

THENCE, S 5°-31'-00" E, a distance of 360.00 feet to the point of beginning, passing a 5/8 inch iron rod set at 328.56 feet.

Containing 1.696 acres of which 0.148 acre is in the highway right-of-way.

The basis for bearings is the center-line of County Highway 2 being S 67°-04'-50" W, and all other bearings are from angles and distances measured in a field survey by Lee Surveying and Mapping Co., Inc. on October 14, 1999 and March 8, 2002.



ORIGINAL STAMP IN GREEN

Description prepared by:

Jeffrey I. Lee
Professional Surveyor 6359
March 8, 2002

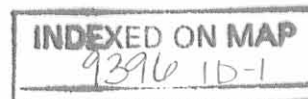

L-2823

REC'D 3-14-02 SML OK

Lee Surveying and Mapping Co., Inc.

Land Surveys • Topography • Subdivisions • Construction Layout

117 N. Madriver St.
Bellefontaine OH 43311



Phone: (937) 593-7335
Fax: (937) 593-7444

MAYS CURTAIN DRAIN EASEMENT

Lying in Virginia Military Survey 2674, Jefferson Township, Logan County, Ohio.

Being a 15 feet by 30 feet curtain drain easement over the W. Page Mays, Jr. and Grace M. Mays 33 acre, 120 rod tract as deeded and described in Official Record 517, Page 654, Parcel 3, Tract II of the Logan County Records of Deeds and being more particularly described as follows:

Beginning at a 3/8 inch iron rod found at Station 148+80 (Logan County Engineer's files: Field Book 579, Page 58) on the center-line of County Highway 2.

THENCE, with the center-line of County Highway 2 (60 feet wide), S 67°-04'-50" W, a distance of 31.44 feet to a MAG nail set.

THENCE, N 5°-31'-00" W, a distance of 330.00 feet to a point at the TRUE POINT OF BEGINNING, passing a 5/8 inch iron rod set at 31.44 feet.

THENCE, N 5°-31'-00" W, a distance of 30.00 feet to a 5/8 inch iron rod set.

THENCE, N 67°-04'-50" E, a distance of 15.00 feet to a point.

THENCE, with the west line of the W. Page Mays, Jr. tract as described and deeded in O.R. Volume 517, Page 654 (Parcel 1, Second tract), S 5°-31'-00" E, a distance of 30.00 feet to a point.

THENCE, S 67°-04'-50" W, a distance of 15.00 feet to the point of beginning.

The basis for bearings is the center-line of County Highway 2 being S 67°-04'-50" W, and all other bearings are from angles and distances measured in a field survey by Lee Surveying and Mapping Co., Inc. on October 14, 1999 and March 8, 2002.



ORIGINAL STAMP IN GREEN

Description prepared by:

A handwritten signature in black ink, appearing to read 'Jeffrey I. Lee'.
Jeffrey I. Lee
Professional Surveyor 6359
March 8, 2002

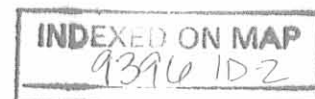

L-2823

REC'D 3-14-02 8M/OK
Lee Surveying and Mapping Co., Inc.

Land Surveys • Topography • Subdivisions • Construction Layout

117 N. Madriver St.
Bellefontaine OH 43311



Phone: (937) 593-7335
Fax: (937) 593-7444

**MAYS
30 FEET WIDE INGRESS/EGRESS EASEMENT**

Lying in Virginia Military Survey 2674, Jefferson Township, Logan County, Ohio.

Being a 30 feet wide ingress/egress easement for future road purposes over the W. Page Mays, Jr. and Grace M. Mays 33 acre, 120 rod tract and 6.37 acre tract as deeded and described in Official Record 517, Page 654, Parcel 3, Tracts II and III of the Logan County Records of Deeds and being more particularly described as follows:

Beginning at a 3/8 inch iron rod found at Station 148+80 (Logan County Engineer's files: Field Book 579, Page 58) on the center-line of County Highway 2.

THENCE, with the center-line of County Highway 2 (60 feet wide), S 67°-04'-50" W, a distance of 46.44 feet to a point at the TRUE POINT OF BEGINNING.

THENCE, with the center-line of this easement, N 5°-31'-00" W, a distance of 360.00 feet to a point in the north line of a previously surveyed 1.696 acre tract at the Terminus of this easement.

The basis for bearings is the center-line of County Highway 2 being S 67°-04'-50" W, and all other bearings are from angles and distances measured in a field survey by Lee Surveying and Mapping Co., Inc. on October 14, 1999 and March 8, 2002.

Description prepared by:



ORIGINAL STAMP IN GREEN

A handwritten signature in black ink, appearing to read 'Jeffrey I. Lee'.

Jeffrey I. Lee
Professional Surveyor 6359
March 8, 2002

L-2823

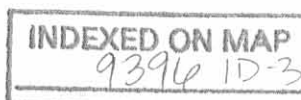

REV'D 3-19-02 SM OK

Lee Surveying and Mapping Co., Inc.

Land Surveys • Topography • Subdivisions • Construction Layout

117 N. Madriver St.
Bellefontaine OH 43311



Phone: (937) 593-7335
Fax: (937) 593-7444

MAYS 30 FEET WIDE INGRESS/EGRESS EASEMENT

Lying in Virginia Military Survey 2674, Jefferson Township, Logan County, Ohio.

Being a 30 feet wide ingress/egress easement for future road purposes over the W. Page Mays, Jr. and Grace M. Mays 33 acre, 120 rod tract and 6.37 acre tract as deeded and described in Official Record 517, Page 654, Parcel 3, Tract II and III and the 16.5 feet wide tract in Official Record 517, Page 654, Parcel 1, Second Tract, of the Logan County Records of Deeds and being more particularly described as follows:

Beginning at a 3/8 inch iron rod found at Station 148+80 (Logan County Engineer's files: Field Book 579, Page 58) on the center-line of County Highway 2.

THENCE, with the center-line of County Highway 2 (60 feet wide), S 67°-04'-50" W, a distance of 31.44 feet to a MAG nail set.

THENCE, N 5°-31'-00" W, a distance of 360.00 feet to a 5/8 inch iron rod set.

THENCE, N 67°-04'-50" E, a distance of 31.44 feet to a point.

THENCE, with the east line of the said 16.5 feet wide tract and the west line of the Brian L. Elliott 5.78 acre tract (O.R. 184, Pg. 977), S 5°-31'-00" E, a distance of 360.00 feet to the point of beginning.

The basis for bearings is the center-line of County Highway 2 being S 67°-04'-50" W, and all other bearings are from angles and distances measured in a field survey by Lee Surveying and Mapping Co., Inc. on October 14, 1999 and March 8, 2002.

Description prepared by:

Jeffrey I. Lee
Professional Surveyor 6359
March 8, 2002

L-2823



ORIGINAL STAMP IN GREEN

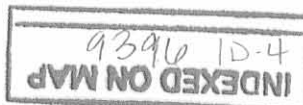

REC'D 3-14-02 SMM/CL

REFERENCES:

LOGAN COUNTY ENGINEER'S FILES:
FIELD BOOK 579, PAGE 58

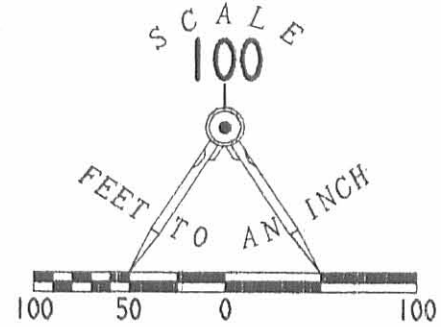

LEGEND

- 5/8" IRON ROD FOUND
- 5/8" IRON ROD SET
- ⊗ RAILROAD SPIKE FOUND
- ⊙ MAG NAIL SET
- 3/8" IRON ROD FOUND

W. PAGE MAYS, JR. &
GRACE M. MAYS
O.R. 517, PG. 654
PARCEL 1
SECOND TRACT

W. PAGE MAYS, JR. &
GRACE M. MAYS
33 ACRE, 120 ROD
O.R. 517, PG. 654
PARCEL 3, TRACT II

W. PAGE MAYS, JR. &
GRACE M. MAYS
6.37 ACRE
O.R. 517, PG. 654
PARCEL 3, TRACT III

15' x 30' CURTAIN
DRAIN EASEMENT

30' WIDE INGRESS/EGRESS
EASEMENTS

BRIAN L. ELLIOTT &
CATHY S. ELLIOTT
5.78 ACRES
O.R. 184, PG. 977

1.696 ACRES
OF WHICH 0.148 ACRE IS
WITHIN THE HIGHWAY
RIGHT-OF-WAY

STATION 148+80
FIELD BOOK 579, PAGE 58
31.44'
S 67°04'50"W

(160' WIDE)
COUNTY HIGHWAY 2

SURVEY OF 1.696 ACRES OUT OF THE
W. PAGE MAYS, JR. AND GRACE M. MAYS
33 ACRE, 120 ROD AND 6.37 ACRE TRACT
OFFICIAL RECORD 517, PAGE 654
PARCEL 3, TRACT II AND TRACT III
VIRGINIA MILITARY SURVEY 2674
JEFFERSON TOWNSHIP
LOGAN COUNTY, OHIO



ORIGINAL STAMP IN GREEN

SURVEYED BY:

JEFFREY I. LEE
PROFESSIONAL SURVEYOR 6359
OCTOBER 14, 1999
AND MARCH 8, 2002

COPYRIGHT 2002 BY:

LEE SURVEYING & MAPPING CO., INC.
117 North Madriver Street
BELLEFONTAINE, OHIO 43311

(937) 593-7335

D-359 MAYS2 L-2823



CALL TOLL FREE 800-362-2764
OHIO UTILITIES PROTECTION SERVICE.

INDEXED ON MAP

9396 1P

4-29-15

Lee Surveying and Mapping Co., Inc.



Land Surveys • Topography • Subdivisions • Construction Layout

117 N. Madriver St.
Bellefontaine OH 43311



Phone: (937) 593-7335
Fax: (937) 593-7444
surveys@lsmcinc.us

MAYS 43.765 ACRES

Lying in Virginia Military Survey 2674, Jefferson Township, Logan County, Ohio.

Being all of the remainder of the W. Page Mays Jr., and Grace M. Mays 16.44 acre tract, 33 acre and 120 rods tract and 6.37 acre tract as deeded and described in Official Record 517, Page 654, Parcel 3, Tracts I, II and III of the Logan County Records of Deeds and being more particularly described as follows:

Commencing at a 3/8 inch iron rod found at Station 148+80 per Logan County Engineer's Field Book 579, Page 58, on the center-line of County Highway 2 (60 feet wide).

THENCE, with the center-line of County Highway 2, S 66°-50'-47"W, a distance of 17.29 feet to a MAG nail set at the TRUE POINT OF BEGINNING.

THENCE, with the center-line of County Highway 2, S 66°-50'-47"W, a distance of 14.16 feet to a MAG nail set.

THENCE, with the lines of the Norman J. Marshall 1.696 acre tract (O.R. 1150, Pg. 804), the following three courses:

N 05°-43'-59"W, a distance of 359.96 feet to a 5/8 inch iron rod found, passing a 5/8 inch iron rod found at 31.31 feet.

S 66°-45'-57"W, a distance of 215.04 feet to a 5/8 inch iron rod found.

S 05°-45'-33"E, a distance of 359.60 feet to a MAG nail set passing a 5/8 inch iron rod set at 328.28 feet.

THENCE, with the center-line of County Highway 2, S 66°-50'-47"W, a distance of 864.19 feet to a MAG nail set.

THENCE, with the east line of the Clarence J. Rees Jr., and Melanie Rees 4.18 acre tract (Vol. 320, Pg. 472), N 12°-16'-53"W, a distance of 647.80 feet to a 3/4 inch iron pipe found, passing a 5/8 inch iron rod set at 30.51 feet.

THENCE, with the north line of said 4.18 acre tract, and the north line of the Ruth A. Tetrick 8.00 acre tract (O.R. 1067, Pg. 56), S 84°-57'-52"W, a distance of 660.34 feet to a 5/8 inch iron rod set, passing a 3/4 inch iron pipe found at 224.22 feet.

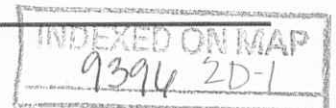

Lee Surveying and Mapping Co., Inc.

Land Surveys • Topography • Subdivisions • Construction Layout

117 N. Madriver St.
Bellefontaine OH 43311



Phone: (937) 593-7335
Fax: (937) 593-7444
surveys@lsminc.us

THENCE, with the east line of the Dennis Lynn Kasper 50 acre tract (O.R. 585, Pg. 706), N 05°-11'-14"W, a distance of 815.38 feet to a 5/8 inch iron rod set.

THENCE, with the north line of Virginia Military Survey 2674, N 84°-19'-33"E, a distance of 1769.38 feet to a 5/8 inch iron rod set.

THENCE, with the west line of the W. Page Mays Jr., and Grace M. Mays 0.25 acre tract (O.R. 517, Pg. 654, Parcel 1, Second Tract), S 05°-43'-59"E, a distance of 1137.87 feet to the point of beginning, passing a 5/8 inch iron rod set at 1106.56 feet.

Containing 43.765 acres of which 0.605 acre is within the highway right-of-way.

Property is subject to any and all previous easements and rights-of-way of record.

The basis for bearings is the north line of Virginia Military Survey 2674, being N 84°-19'-33"E, and all other bearings are from angles and distances measured in a field survey by Lee Surveying and Mapping Co., Inc. on April 16, 2015.

Description prepared by:

A handwritten signature in black ink that reads "William K. Bruce".

William K. Bruce
Professional Surveyor 7437
April 16, 2015



L-58920415

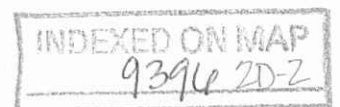

4-29-15

Lee Surveying and Mapping Co., Inc.



APPROVED

Land Surveys • Topography • Subdivisions • Construction Layout

117 N. Madriver St.
Bellefontaine OH 43311



Phone: (937) 593-7335
Fax: (937) 593-7444
surveys@lsminc.us

MAYS 69.833 ACRES

Lying in Virginia Military Surveys 3436 and 2674, Jefferson Township, Logan County, Ohio.

Being all of the remainder of the W. Page Mays Jr., and Grace M. Mays 65 acre tract and all of the 0.25 acre tract as deeded and described in Official Record 517, Page 654, Parcel 1, First and Second Tract of the Logan County Records of Deeds and being more particularly described as follows:

Beginning at a 3/8 inch iron rod found at Station 148+80 per Logan County Engineer's Field Book 579, Page 58, on the center-line of County Highway 2 (60 feet wide).

THENCE, with the center-line of County Highway 2, S 66°-50'-47"W, a distance of 17.29 feet to a MAG nail set.

THENCE, N 05°-43'-59"W, a distance of 1137.87 feet to a 5/8 inch iron rod set, passing a 5/8 inch iron rod set at 31.31 feet.

THENCE, with the north line of Virginia Military Survey 2674, S 84°-19'-33"W, a distance of 1769.38 feet to a 5/8 inch iron rod set.

THENCE, with the east line of the Dennis Lynn Kasper 50 acre tract (O.R. 585, Pg. 706), N 05°-11'-14"W, a distance of 1045.50 feet to a 5/8 inch iron rod set.

THENCE, with the lines of the Shawnee Nation United Remnant Band Land Fund, Inc. 84.045 acre tract (O.R. 922, Pg. 287), the following three courses:

N 85°-44'-40"E, a distance of 167.60 feet to a 5/8 inch iron rod found.

N 06°-07'-30"W, a distance of 329.57 feet to a 5/8 inch iron rod set.

N 81°-54'27"E, a distance of 557.02 feet to a 5/8 inch iron rod found.

THENCE, with the south line of the Kent Green 118.12 acre tract (O.R. 248, Pg. 4, Tract One), N 82°-54'-59"E, a distance of 1467.38 feet to a point in a ravine.

INDEXED ON MAP
9396 2D-3

Lee Surveying and Mapping Co., Inc.

Land Surveys • Topography • Subdivisions • Construction Layout

117 N. Madriver St.
Bellefontaine OH 43311



Phone: (937) 593-7335
Fax: (937) 593-7444
surveys@lsminc.us

THENCE, with the west line of the Kent Green 280 acre tract (O.R. 248, Pg. 4, First Tract) and the west line of the Walter G. Farringer and Judy Farringer 20.61 acre tract (O.R. 1109, Pg. 143), S 05°-58'-49"E, a distance of 1430.49 feet to a 5/8 inch iron rod set, passing a 5/8 inch iron rod set at 20.00 feet.

THENCE, with a north line of said 20.61 acre tract and the north line of Virginia Military Survey 2674, S 84°-19'-33"W, a distance of 419.06 feet to a 5/8 inch iron rod set.

THENCE, with a west line of said 20.61 acre tract and the west line of the Brian L. Elliot and Cathy S. Elliott 5.78 acre tract (O.R. 184, Pg. 977), S 05°-43'-59"E, a distance of 1132.68 feet to the point of beginning.

Containing 69.833 acres of which 0.012 acre is within the highway right-of-way.

69.403 acres is within Virginia Military Survey 3436 and 0.430 acre is within Virginia Military Survey 2674.

Property is subject to any and all previous easements and rights-of-way of record.

The basis for bearings is the north line of Virginia Military Survey 2674, being N 84°-19'-33"E, and all other bearings are from angles and distances measured in a field survey by Lee Surveying and Mapping Co., Inc. on April 16, 2015.

Description prepared by:

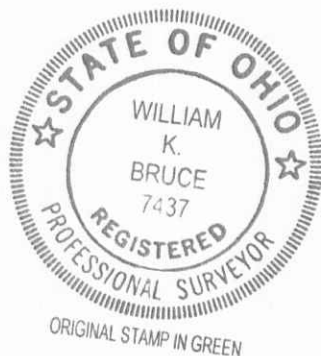

William K. Bruce
William K. Bruce
Professional Surveyor 7437
April 16, 2015

L-58920415

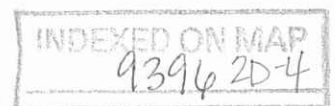

LEGEND

- 5/8 INCH IRON ROD SET WITH PLASTIC I.D. CAP STAMPED "LSM7437"
- 5/8 INCH IRON ROD FOUND
- ⊙ 3/4 INCH IRON PIPE FOUND
- MAG NAIL SET
- ⊗ 3/8 INCH IRON ROD FOUND

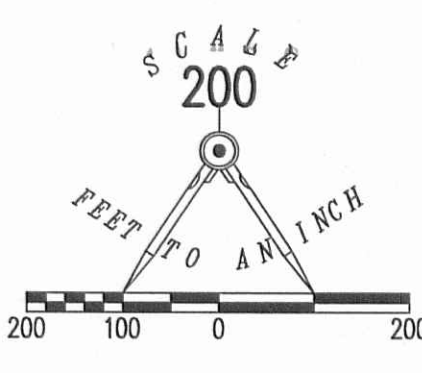

SHAWNEE NATION
 UNITED REMNANT BAND
 LAND FUND, INC.
 84.045 ACRE TRACT
 O.R. 922, PG. 287

KENT GREEN
 118.12 ACRE TRACT
 O.R. 428, PG. 4
 TRACT ONE

SEE DETAIL "A"

DETAIL "A"
 NOT TO SCALE

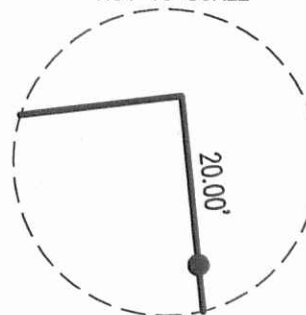

KENT GREEN
 280 ACRE TRACT
 O.R. 428, PG. 4
 FIRST TRACT

W. PAGE MAYS JR., AND GRACE M. MAYS
 65 ACRE TRACT
 O.R. 517, PG. 654
 PARCEL 1, FIRST TRACT

WALTER G. FARRINGER
 AND JUDY FARRINGER
 20.61 ACRE TRACT
 O.R. 1109, PG. 143

69.833 ACRES

OF WHICH 0.012 ACRE IS WITHIN THE HIGHWAY
 RIGHT-OF-WAY.

0.430 ACRE IN V.M.S. 2674
 69.403 ACRE IN V.M.S. 3436

DENNIS LYNN KASPER
 50 ACRE TRACT
 O.R. 585, PG. 706

WIRE FENCE
 IN TREES
 (TYP.)

V.M.S. 3436
 V.M.S. 2674

1769.38'
 N 84°19'33" E
 BASIS FOR BEARINGS

WALTER G. FARRINGER
 AND JUDY FARRINGER
 20.61 ACRE TRACT
 O.R. 1109, PG. 143

W. PAGE MAYS JR., AND GRACE M. MAYS
 0.25 ACRE TRACT
 O.R. 517, PG. 654
 PARCEL 1, SECOND TRACT

W. PAGE MAYS JR., AND GRACE M. MAYS
 33 ACRE, 120 RODS
 O.R. 517, PG. 654
 PARCEL 3, TRACT II

43.765 ACRES

OF WHICH 0.605 ACRE IS WITHIN THE HIGHWAY
 RIGHT-OF-WAY.

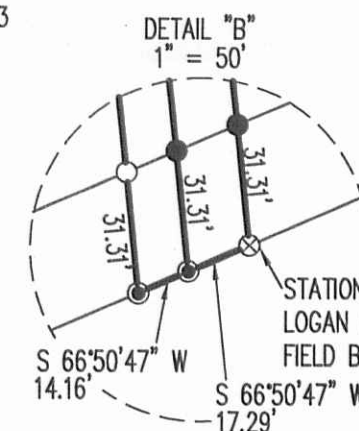

DETAIL "B"
 1" = 50'

STATION 148+80
 LOGAN COUNTY ENGINEER'S
 FIELD BOOK 579, PG. 58

BRIAN L. ELLIOTT AND
 CATHY S. ELLIOTT
 5.78 ACRE TRACT
 O.R. 184, PG. 977

30' WIDE INGRESS/EGRESS EASEMENT

DENNIS LYNN KASPER
 50 ACRE TRACT
 O.R. 585, PG. 706

15' X 30' CURTAIN DRAIN EASEMENT
 (0.079 AC.)

(34.662 AC.)
 (4.400 AC.)
 (4.624 AC.)

W. PAGE MAYS JR., AND GRACE M. MAYS
 6.37 ACRE
 O.R. 517, PG. 654
 PARCEL 3, TRACT III

W. PAGE MAYS JR., AND
 GRACE M. MAYS
 16.44 ACRE
 O.R. 517, PG. 654
 PARCEL 3, TRACT I

RUTH A. TETRICK
 8.00 ACRE TRACT
 O.R. 1067, PG. 56

CLARENCE J. REES JR.,
 AND MELANIE REES
 4.18 ACRE TRACT
 VOL. 320, PG. 472

COUNTY HIGHWAY 2 (60')

A SURVEY OF TWO TRACTS OUT OF THE
 W. PAGE MAYS, JR. AND GRACE M. MAYS
 65 ACRE AND 0.25 ACRE TRACTS
 AND REMAINDER OF THE
 16.44 ACRE, 33 ACRE, 120 RODS AND 6.37 ACRE TRACTS
 OFFICIAL RECORD 517, PAGE 654
 PARCEL 1, FIRST AND SECOND TRACTS
 PARCEL 3, TRACTS I, II AND III
 VIRGINIA MILITARY SURVEYS 2674 AND 3436
 JEFFERSON TOWNSHIP
 LOGAN COUNTY, OHIO

SURVEYED BY:

William K. Bruce
 WILLIAM K. BRUCE
 PROFESSIONAL SURVEYOR 7437
 APRIL 16, 2015



COPYRIGHT 2015 BY:
 LEE SURVEYING & MAPPING CO., INC.
 117 North Madriver Street
 BELLEFONTAINE, OHIO 43311
 (937) 593-7335
 WWW.LSMINC.US
 surveys@lsminc.us
 ADW D0415 58920415 L-5892-2

10-15-19



APPROVED

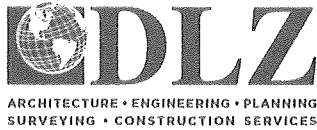

INNOVATIVE IDEAS
EXCEPTIONAL DESIGN
UNMATCHED CLIENT SERVICE

MAYS 0.354 ACRE

Lying in Virginia Military Survey 2674, Jefferson Township, Logan County, Ohio (all records referenced herein refer to the Logan County Records of Deeds).

Being out of the W. Page Mays, Jr. and Grace M. Mays 43.765 acre tract as deeded and described in Official Record 1180, Page 307, Tract I and being more particularly described as follows:

COMMENCING at a 3/8 inch iron rod found on the center-line of County Highway 2 (60 feet wide) at Station 148+80 (Logan County Engineer's Field Book 579, Page 58);

THENCE, with said center-line, S 67°-13'-17" W, a distance of 17.29 feet to a MAG nail found at the **TRUE POINT OF BEGINNING**, being a southeasterly corner of said 43.765 acre tract and a southwesterly corner of the W. Page Mays, Jr. and Grace M. Mays 69.833 acre tract as deeded and described in Official Record 1180, Page 307, Tract II;

THENCE, with said center-line and the southerly line of said 43.765 acre tract, S 67°-13'-17" W, a distance of **14.21 feet** to a MAG nail found at a southwesterly corner of said 43.765 acre tract and the southeasterly corner of the Rick A. Dodge, Jr., 1.696 acre tract as deeded and described in Official Record 1319, Page 175;

THENCE, with a common line to said 43.765 acre and 1.696 acre tracts, N 04°-59'-43" W, passing a 5/8 inch iron rod found at a distance of 31.36 feet, a total distance of **360.31 feet** to a 5/8 inch iron rod found;

THENCE, with a new division line through said 43.765 acre tract, N 04°-59'-43" W, a distance of **781.84 feet** to an iron rod set on the north line of Virginia Military Survey 2674 and said 43.765 acre tract and the south line of Virginia Military Survey 3436 and said 69.833 acre tract;

THENCE, with said north line of Virginia Military Survey 2674 and the 43.765 acre tract and said south line of Virginia Military

INDEXED ON MAP
9396

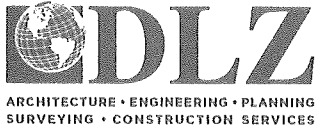

INNOVATIVE IDEAS
EXCEPTIONAL DESIGN
UNMATCHED CLIENT SERVICE

Survey 3436 and the 69.833 acre tract, **N 85°-04'-07" E**, a distance of **13.53 feet** to a 5/8 inch iron rod found (I.D. cap stamped "LSM 7437"), being a corner common to said 43.765 acre and 69.833 acre tracts;

THENCE, with the easterly line of said 43.765 acre tract and westerly line of said 69.833 acre tract, **S 04°-59'-43" E**, a distance of **1137.79 feet** to the **POINT OF BEGINNING**.

Containing **0.354 acre**, more or less, of which 0.010 acre is within the highway right-of-way.

Iron rods set, where indicated, are 30 inches in length, 5/8 inch in diameter with a plastic I.D. cap stamped "DLZ OHIO, INC".

This parcel is to be attached to an adjoining tract of land and is not to be used as a separate and independent parcel.

Property is subject to any and all previous easements and rights-of-way of record.

Bearings and distances, described herein, are derived from GPS observations based on Grid North, Ohio State Plane Coordinate System, North Zone, NAD83 (2011, Epoch 2010), with the center-line of County Highway 2 having a bearing of **S 67°-13'-17" W**. Distances are expressed in U.S. Survey Feet. All other measurements are from angles and distances measured in a field survey by DLZ on September 30, 2019.

Description prepared by:

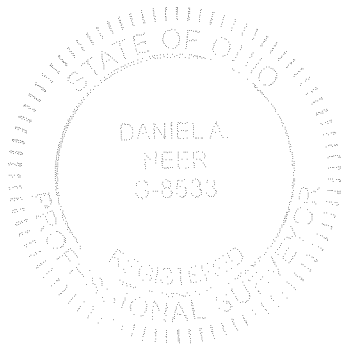

D. A. Neer
Daniel A. Neer
Professional Surveyor No. 8533
October 9, 2019

1921-2074



10-15-19

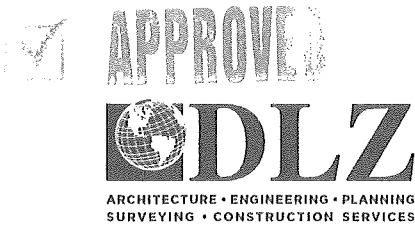

INNOVATIVE IDEAS
EXCEPTIONAL DESIGN
UNMATCHED CLIENT SERVICE

**MAYS
2.537 ACRES**

Lying in Virginia Military Survey 3436, Jefferson Township, Logan County, Ohio (all records referenced herein refer to the Logan County Records of Deeds).

Being out of the W. Page Mays, Jr. and Grace M. Mays 69.833 acre tract as deeded and described in Official Record 1180, Page 307, Tract II and being more particularly described as follows:

COMMENCING at a 3/8 inch iron rod found on the center-line of County Highway 2 (60 feet wide) at Station 148+80 (Logan County Engineer's Field Book 579, Page 58);

THENCE, with said center-line, S 67°-13'-17" W, passing a MAG nail found at a distance of 17.29 feet, a total distance of 31.50 feet to a MAG nail found at a southwesterly corner of the W. Page Mays, Jr. and Grace M. Mays 43.765 acre tract as deeded and described in Official Record 1180, Page 307, Tract I and the southeasterly corner of the Rick A. Dodge, Jr., 1.696 acre tract as deeded and described in Official Record 1319, Page 175;

THENCE, with a common line to said 43.765 acre and 1.696 acre tracts, N 04°-59'-43" W, passing a 5/8 inch iron rod found at a distance of 31.36 feet, a total distance of 360.31 feet to a 5/8 inch iron rod found;

THENCE, with a line through said 43.765 acre tract, N 04°-59'-43" W, a distance of 781.84 feet to an iron rod set on the north line of Virginia Military Survey 2674 and said 43.765 acre tract and the south line of Virginia Military Survey 3436 and said 69.833 acre tract at the **TRUE POINT OF BEGINNING**;

THENCE, with said south line of Virginia Military Survey 3436 and the 69.833 acre tract and said north line of Virginia Military Survey 2674 and the 43.765 acre tract, **S 85°-04'-07" W**, a distance of **803.24 feet** to an iron rod set:

THENCE, with new division lines through said 69.833 acre tract, the following nine (9) courses:

INDEXED ON MAP
9396



INNOVATIVE IDEAS
EXCEPTIONAL DESIGN
UNMATCHED CLIENT SERVICE

- 1) **N 42°-30'-11" E**, a distance of **202.10 feet** to an iron rod set;
- 2) **N 60°-07'-09" E**, a distance of **94.57 feet** to an iron rod set;
- 3) **N 71°-07'-28" E**, a distance of **328.48 feet** to an iron rod set;
- 4) **S 59°-53'-09" E**, a distance of **100.27 feet** to an iron rod set;
- 5) **S 07°-32'-51" W**, a distance of **93.72 feet** to an iron rod set;
- 6) **N 87°-11'-53" W**, a distance of **37.85 feet** to an iron rod set;
- 7) **S 08°-52'-57" E**, a distance of **69.99 feet** to an iron rod set;
- 8) **N 89°-12'-36" E**, a distance of **117.23 feet** to an iron rod set; and
- 9) **S 77°-03'-03" E**, a distance of **109.02 feet** to the **POINT OF BEGINNING**.

Containing **2.537 acres**, more or less.

Iron rods set, where indicated, are 30 inches in length, 5/8 inch in diameter with a plastic I.D. cap stamped "DLZ OHIO, INC".

This parcel is to be attached to an adjoining tract of land and is not to be used as a separate and independent parcel.

Property is subject to any and all previous easements and rights-of-way of record.

Bearings and distances, described herein, are derived from GPS observations based on Grid North, Ohio State Plane Coordinate System, North Zone, NAD83 (2011, Epoch 2010), with the center-line of County Highway 2 having a bearing of S 67°-13'-17" W. Distances are expressed in U.S. Survey Feet. All other measurements are from angles and distances measured in a field survey by DLZ on September 30, 2019.

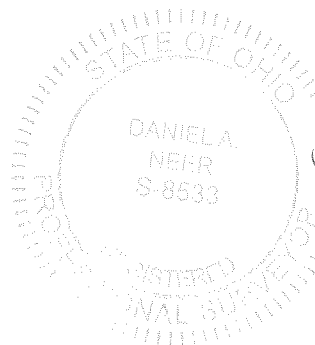

Description prepared by:

Daniel A. Neer
Daniel A. Neer

Professional Surveyor No. 8533

October 9, 2019

1921-2074



10-31-19



APPROVED



INNOVATIVE IDEAS
EXCEPTIONAL DESIGN
UNMATCHED CLIENT SERVICE

30' INGRESS/EGRESS EASEMENT 0.542 ACRE

Lying in Virginia Military Survey 2674, Jefferson Township, Logan County, Ohio (all records referenced herein refer to the Logan County Records of Deeds).

Being a 30 feet wide easement for ingress/egress purposes out of the W. Page Mays, Jr. and Grace M. Mays 43.765 acre tract as deeded and described in Official Record 1180, Page 307, Tract I and being more particularly described as follows:

COMMENCING at a 3/8 inch iron rod found on the center-line of County Highway 2 (60 feet wide) at Station 148+80 (Logan County Engineer's Field Book 579, Page 58);

THENCE, with said center-line, S 67°-13'-17" W, passing a MAG nail found at a distance of 17.29 feet, a total distance of 31.50 feet to a MAG nail found at a common corner to a southwesterly corner of said 43.765 acre tract and the Rick A. Dodge, Jr., 1.696 acre tract as deeded and described in Official Record 1319, Page 175;

THENCE, with a common line to said 43.765 acre and 1.696 acre tracts, N 04°-59'-43" W, passing a 5/8 inch iron rod found at a distance of 31.36 feet, a total distance of **360.31 feet** to a 5/8 inch iron rod found at the **TRUE POINT OF BEGINNING**, being the northeasterly corner of said 1.696 acre tract and a southerly corner of said 43.765 acre tract;

THENCE, with a common line to a southerly line of said 43.765 acre tract and the northerly line of said 1.696 acre tract, S 67°-27'-06" W, a distance of **31.47 feet** to a point;

THENCE, with the west line of said easement and through said 43.765 acre tract, N 04°-59'-43" W, a distance of **791.36 feet** to a point on a common line to northerly lines of said 43.765 acre tract and said Virginia Military Survey 2674 and southerly lines of the W. Page Mays, Jr. and Grace M. Mays 69.833 acre tract as deeded and described in Official Record 1180, Page 307, Tract II and Virginia Military Survey 3436;

INDEXED ON MAP
9396

117 N Madriver St, Bellefontaine, OH 43311 | OFFICE 937.593.7335 | ONLINE WWW.DLZ.COM

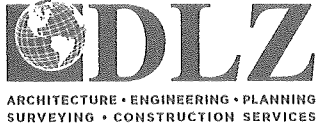

INNOVATIVE IDEAS
EXCEPTIONAL DESIGN
UNMATCHED CLIENT SERVICE

THENCE, with said common line, **N 85°-04'-07" E**, a distance of **30.00 feet** to a 5/8 inch iron rod set;

THENCE, with the easterly line of said easement and through said 43.765 acre tract, **S 04°-59'-43" E**, a distance of **781.84 feet** to the **POINT OF BEGINNING**.

Containing **0.542 acre**, more or less.

Iron rods set, where indicated, are 30 inches in length, 5/8 inch in diameter with a plastic I.D. cap stamped "DLZ OHIO, INC".

Property is subject to any and all previous easements and rights-of-way of record.

Bearings and distances, described herein, are derived from GPS observations based on Grid North, Ohio State Plane Coordinate System, North Zone, NAD83 (2011, Epoch 2010), with the center-line of County Highway 2 having a bearing of S 67°-13'-17" W. Distances are expressed in U.S. Survey Feet. All other measurements are from angles and distances measured in a field survey by DLZ on September 30, 2019.

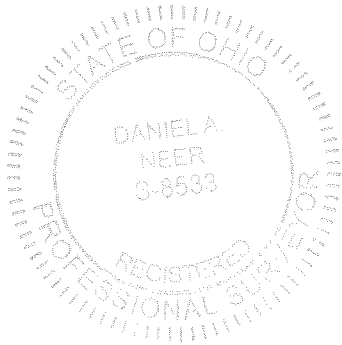

Description prepared by:

Daniel A. Neer
Professional Surveyor No. 8533
October 30, 2019

1921-2074

INDEXED ON MAP
9396

LEGEND:

- ⊕ 3/8 INCH IRON ROD FOUND
- ⊙ MAG NAIL FOUND
- 5/8 INCH IRON ROD FOUND
- 5/8 INCH BY 30 INCH IRON ROD SET WITH PLASTIC I.D. CAP STAMPED "DLZ OHIO, INC"
- P.O.C. = POINT OF COMMENCEMENT
- P.O.B. = POINT OF BEGINNING
- R/W = RIGHT-OF-WAY
- C/L = CENTER-LINE
- V.M.S. = VIRGINIA MILITARY SURVEY

ACCESS MANAGEMENT NOTE:

COUNTY HIGHWAY 2 IS CLASSIFIED AS A LOCAL ROAD.
 MINIMUM DRIVE SPACING IS 250'
 MINIMUM STOPPING SIGHT DISTANCE IS >495 (55 MPH)
 (NO NEW DRIVE IS BEING REQUESTED)

NOTE:

THESE PARCELS ARE TO BE ATTACHED TO ADJOINING TRACTS OF LAND AND ARE NOT TO BE USED AS SEPARATE AND INDEPENDENT PARCELS.

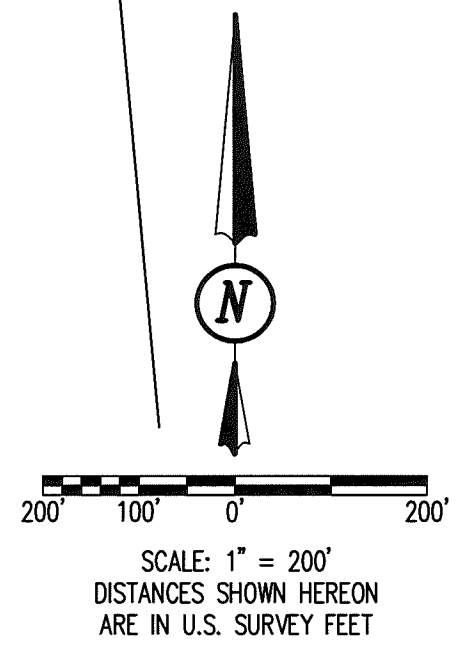

W. PAGE MAYS, JR. AND
 GRACE M. MAYS
 69.833 ACRES
 O.R. 1180, PG. 307
 TRACT II

W. PAGE MAYS, JR. AND
 GRACE M. MAYS
 43.765 ACRES
 O.R. 1180, PG. 307
 TRACT I

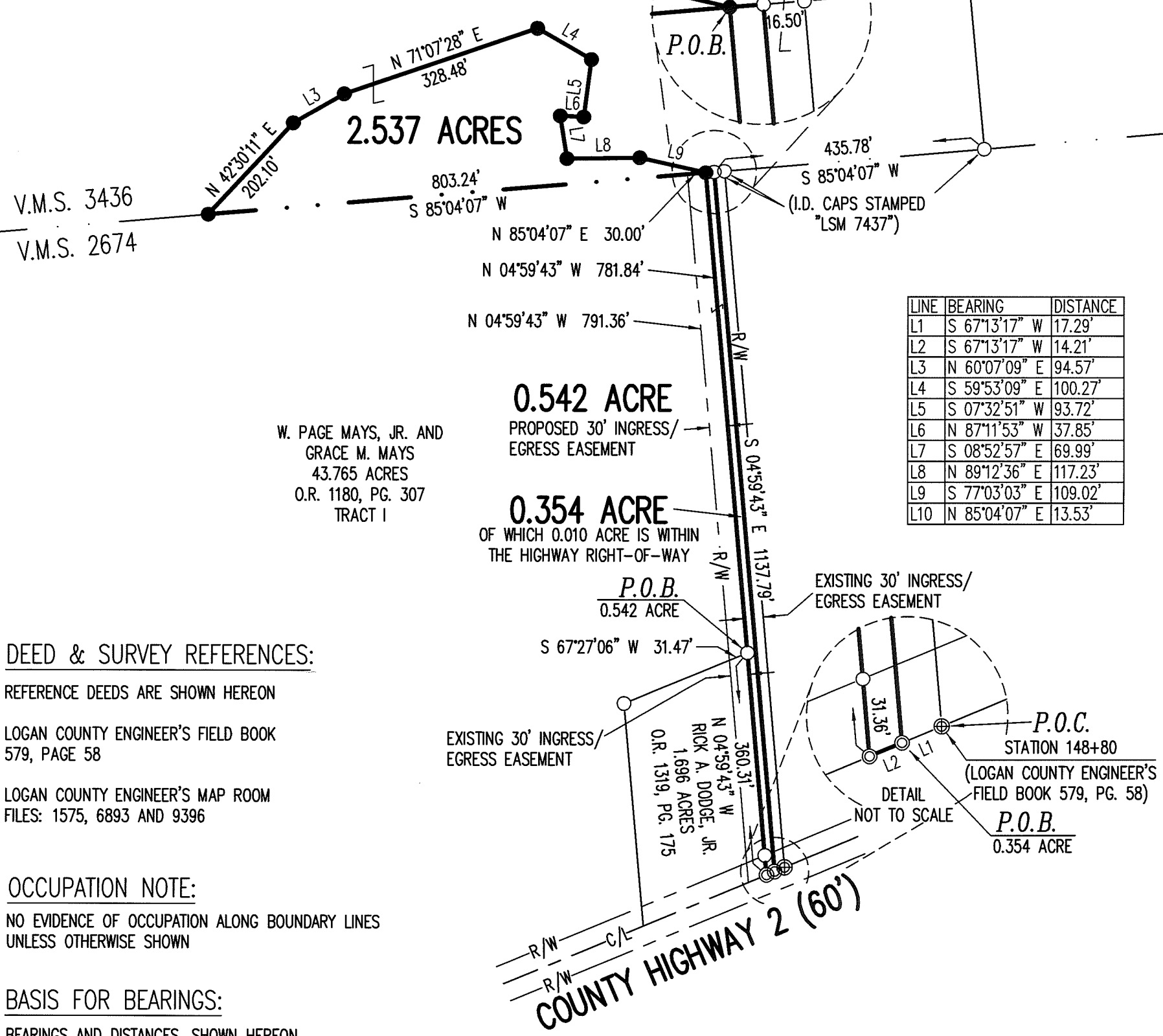

LINE	BEARING	DISTANCE
L1	S 67°13'17" W	17.29'
L2	S 67°13'17" W	14.21'
L3	N 60°07'09" E	94.57'
L4	S 59°53'09" E	100.27'
L5	S 07°32'51" W	93.72'
L6	N 87°11'53" W	37.85'
L7	S 08°52'57" E	69.99'
L8	N 89°12'36" E	117.23'
L9	S 77°03'03" E	109.02'
L10	N 85°04'07" E	13.53'

DEED & SURVEY REFERENCES:

- REFERENCE DEEDS ARE SHOWN HEREON
- LOGAN COUNTY ENGINEER'S FIELD BOOK 579, PAGE 58
- LOGAN COUNTY ENGINEER'S MAP ROOM FILES: 1575, 6893 AND 9396

OCCUPATION NOTE:

NO EVIDENCE OF OCCUPATION ALONG BOUNDARY LINES UNLESS OTHERWISE SHOWN

BASIS FOR BEARINGS:

BEARINGS AND DISTANCES, SHOWN HEREON, ARE DERIVED FROM GPS OBSERVATIONS BASED ON GRID NORTH, OHIO STATE PLANE COORDINATE SYSTEM, NORTH ZONE, NAD83 (2011, EPOCH 2010), WITH THE CENTER-LINE OF COUNTY HIGHWAY 2, HAVING A BEARING OF S 67°13'17" W.

THIS SURVEY WAS PREPARED IN THE ABSENCE OF A COMPLETE AND ACCURATE TITLE SEARCH AND DOES NOT GUARANTEE TITLE.

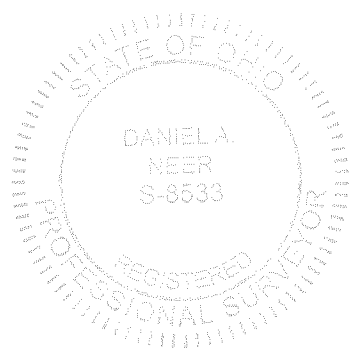

Daniel A. Neer
 DANIEL A. NEER
 PROFESSIONAL SURVEYOR NO. 8533
 SEPTEMBER 30, 2019

COPYRIGHT 2019 BY:
DLZ
 117 N. Madriver Street • Bellefontaine, OH 43311
 (937) 593-7335 • www.dlz.com
 Project #1921-2074.00

SURVEY OF TWO TRACTS
 VIRGINIA MILITARY SURVEYS 2674 AND 3436
 JEFFERSON TOWNSHIP
 LOGAN COUNTY, OHIO

INDEXED ON MAP
 9396

DRAWN BY:	DESCRIPTION	REV. NO.	DATE
KSS			10/8/2019
DAN	REVISED FOR EASEMENT	1	10/30/2019