

8271

Survey N^o 527

A

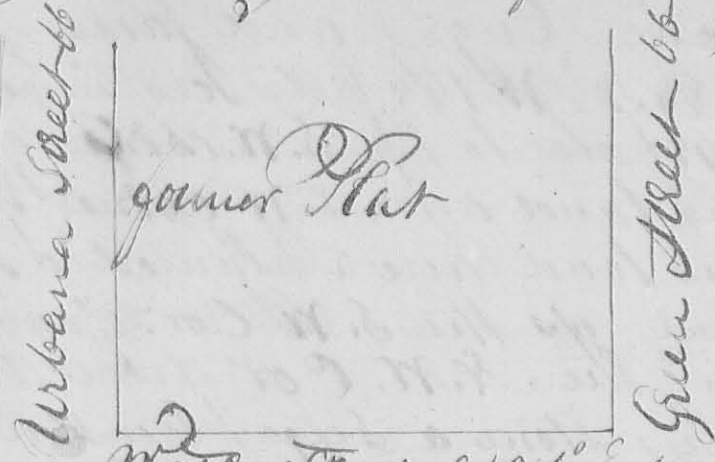

Surveyed June 5th 1844 for W^m Grubb, an location to the town of Middleburgh as represented by the annexed plat Lot N^o 103

Water Street S 42 1/2° E 66 feet fronts on Water Street 132 feet

165 feet	132 feet
104	103

Grubb's line S 37 E

Street 165 feet extending back to Grubb's line planted a stone as represented on the plat by Christopher J. & Wm. Mechem S. L. Co
Benj. Grubb, 3 Chainmen

Survey N^o 528

Surveyed June 24th 1844 for Vincent Hough as follows: Beginning at Hough's North West Corner Run S 83° E 144 poles

8499

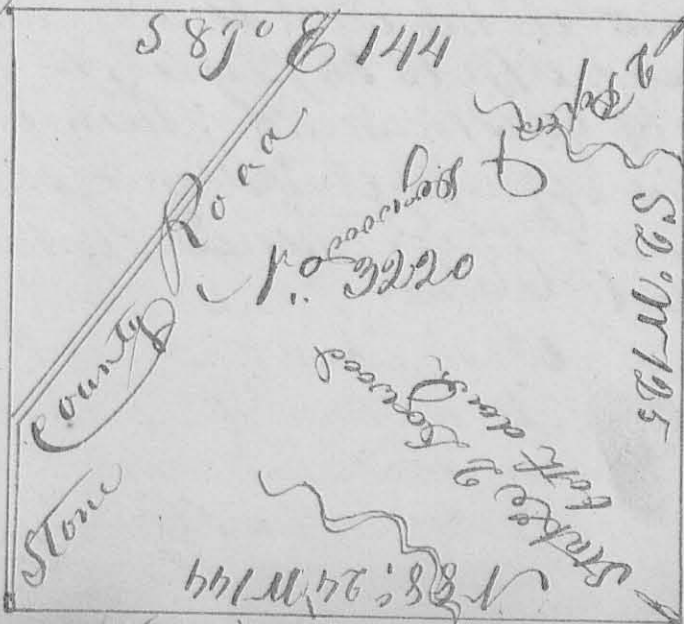

to 2 Poplar and Dogwood the Dogwood is gone; thence S 2° W 125 poles crossing a branch at 28 poles to 2 Dogwood, (down N. W. corner Joseph Hill) thence run the line between

5.

between said Hughz and James J. Costin $N 88^{\circ} 24' W$ 144 poles crossing a branch at 48 poles to the S.W. corner of said Hughz land and N.W. corner of said Costin's land here I planted a stone by agreement as the S.W. Cor. of said Hughz and the N.W. Cor of said Costin land from this stone a Sugar tree 18 in diameter bears $N 50' W$ 39 links present at planting said Stone Joseph Dickinson Archibald Walker of Garwood V. Hughz Samuel R. Costin, James S. Costin, James Walker, and Andrew Sperry.

Jo. Dickinson & Co
Arch. Walker & Co
John Michern S. L. C.

8768

SURVEY No. 529

Surveyed August 19th 1844 for Richard Cadee as follows; Beginning at the S.E. corner of the S.E. Quarter of Sec. No. 5. T.3. R. 14 thence $N 1 1/2^{\circ} E$ 66 2/3 poles, to a Stake on the South side of a small drain near a small Hickory stump; thence $N 88 1/4^{\circ} W$ 166 poles to a white Oak 18 inches in diameter 35 1/2 E 23 links distant in the west line of said section; thence $S 1 1/2^{\circ} W$ 66 2/3 poles, to the S.W. corner of said Quarter Section; thence $S 88 1/4^{\circ} E$ 166 poles, to the beginning. Containing 66 2/3 acres.

John Good & Co
Sam. Miller & Co
John Michern & Co