

358

N<sup>o</sup> 353

8394

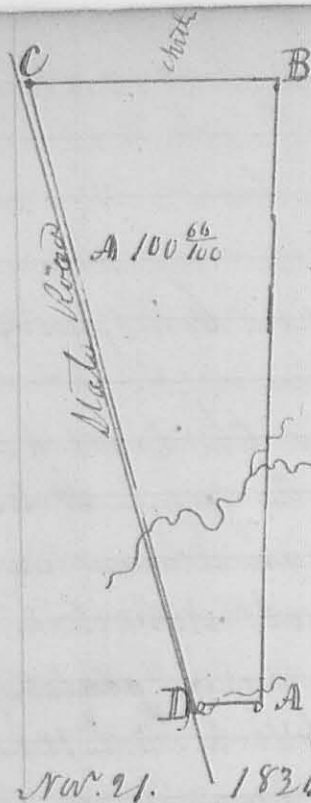

Surveyed for James Gordon on application of Robert Patterson Esq. part of Survey N<sup>o</sup> 5045 as follows. Beginning at the South East Corner of said Survey (See letter A) at a white oak & Black Oak, thence N 15° 25' pole, crossing the Mack River at 86 pole, ~~more~~ branch at 101 pole to two Black Oaks, thence West 102 1/2 pole to two Black Oaks (both down), in the Big road thence with said road 120 to 270 pole, crossing a run at 190 pole to a stem, the original corner is gone, thence East 22 pole, crossing a branch at 18 pole to the beginning, containing 100 66/100 acres. Dan Hopkins Co. Sur. G. C.

Nov. 21. 1836.

Robert Patterson Esq. James Gordon

N<sup>o</sup> 354

8395

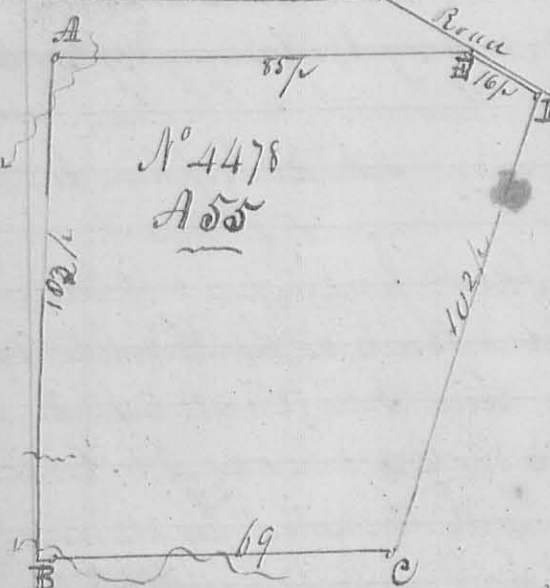

Surveyed Nov. 26. 1836 for Isaac Savage part of Military Survey N<sup>o</sup> 4478 as follows. Beginning at a Sugar and Elm N. E. corner near to Joseph Marquis and come to Sape Millner (See letter C) thence C D N 19° 6' 102 pole to Mark in the parcelled road, and in the South line of George Knutke's, thence with his line N 71° 18' 16 pole to a hickory, comes between said Knutke's & Isaac Savage, thence with 88 pole, crossing a stem, comes between said Knutke's & Isaac Savage, at 39 pole, crossing Isaac's branch at 74 pole to a stem near a small Hickory, thence South 103 pole, crossing a branch at 16 pole, and at 102 pole to a stem in Joseph Marquis' North line, thence 88 1/2 pole, crossing a small branch seen at times to the beginning, containing 55 acres. Dan Hopkins Co. Sur. G. C.

Nov. 26. 1836.

Isaac Savage, David Barrett Esq.

Dan Hopkins Co. Sur. G. C.

N<sup>o</sup> 482

8471

Surveyed Sept. 25. 1841 on Application of Joseph Mar-  
 qui part of Military Survey N<sup>o</sup> 9572 & 4478. as follows.  
 Beginning at a Black Walnut & Dogwood. S. E. corner  
 to Humphreys & S.W. corner to N 4478. thence N 1 E 34 poles  
 to a Stone & N. corner to George Humphreys: thence with  
 his South line S 89 E 58 1/2 poles crossing a run at 30 1/2 poles  
 to a Stone Cherry & Sassafras in John Marquis West line and  
 S. E. corner to said Humphreys. thence S 2 E 53 poles to a Cutting  
 corner to Marquis: thence S 88 E 12 poles to a Stone & 2 Bl.  
 Oaks. corner to Mortimer Survey N<sup>o</sup> 4498. thence with his  
 West line S 2 W 92 7/10 poles to a Stone & 2 Black Oaks, one  
 down thence West 10 3/4 poles to a Stone in Ludlow's line  
 thence N 19 W 103 7/10 poles to a Stone S.W. corner to Humphreys  
 thence S 88 E 65 7/10 poles to the beginning. Containing  
 89 2/10 acres.

D. Hopkins, C. S. L. C. O.

N<sup>o</sup> 482

8395

Surveyed Oct 2. 1841 for Wm. McComb part of Worthington  
 Survey N<sup>o</sup> 4399 & Brown Survey 3683 as follows. Beginning  
 at a Stone N E corner to Worthington Survey: thence  
 thence S 10 E 118 poles crossing a run at 78 & Road at  
 9 1/2 poles to a Stone Elm & Hickory corner to W. S. Brown:  
 thence N 80 E 40 poles to a Stone S E corner to Brown:  
 in the line of Lips Gwynns. thence S 12 E 20 poles to a  
 Stone & 2 White Walnuts. thence S 80 W 41 7/10 poles to a  
 Stone forked Hickory, White Walnut & Sassafras  
 in the line of the Worthington Survey thence S 10 E 9  
 poles to a Stone two hickories & Dead Sugar. corner  
 to Jacob Humphreys: thence S 85 W 104 poles to a Stone  
 Sassafras & Hickory. thence North 17 1/2 poles to a Stone & two  
 White Walnuts & Hickory N W corner to Worthington's said  
 Survey: thence East 70 poles to the beginning. Contain-  
 ing 10 7/10 acres.

Dan Hopkins  
C. S. L. C. O.