



N<sup>o</sup> 404

8423

Surveyed March 7. 1838 for John Mitchell part 281  
of Military Survey N<sup>o</sup> 9993 as follows. Beginning at the NW  
Corner of said Survey at a Red Oak & Beech. thence S 12 E  
100 poles ending a branch at 90 poles to 2 Ironwood from one root  
and small Beech top. thence N 77 E 80 poles. ending at oak of 16 ft.  
Big wood at 28 ft & same branch at 47.53. 62 ft & 69 ft to a Stone  
thence N 11 W 100 poles ending Big wood at 68 ft to Dogwood & 3 ft.  
in the N Line of said Survey thence S 79 W 80 poles to the beginning  
Containing 37 acres.

David Hopkins, C.S.

N<sup>o</sup> 405

8424

Surveyed March 8. 1838 for William Clark part of Military  
Survey N<sup>o</sup> 9932 as follows - Beginning at the center corner of  
the South line of said Survey at 2 Beech & 2 Sugar. thence  
N 11 W 105 poles. ending big wood & small branch to a Beech and  
Ironwood corner to David Kirkland. thence N 79 E 52 poles to Beech  
Hickory and Elm another of said Kirklands corner. thence N 78 E  
70 poles. ending a Big Round to 2 Beech. thence S 11 E 106 poles.  
passing a corner at 6 poles to 2 Beech & Sugar in the South line  
of the Survey. thence with said line S 79 W 122 poles to the beginning  
Containing 81 <sup>1/2</sup> Acres. Also at Samston

Survey Beginning at Center of the East Line of said  
Survey at 2 Blue Ash. 2 Beech & 2 Beech top. thence with the  
division line of said Survey S 79 W 125 poles to 2 beech in a corner  
corner to J. Kirkland. thence South with said Kirkland E  
line 96 poles to a Beech Hickory & Elm. thence N 78 E 70 poles  
to 2 beech. corner to W. Clark. thence S 11 E 6 poles to an Iron  
wood thence N 79 E 80 poles to a Stake in the East Line of the  
Survey. thence with said line N 11 W 100 poles to the beginning  
Containing 81 <sup>1/2</sup> Acres.

David Hopkins, C.S.

N<sup>o</sup> 405

8384

Surveyed March 10. 1838 for Saml. Hancock part of  
Military Survey N<sup>o</sup> 4678 as follows. Beginning at a  
Stone in the East Line of Midway Run, land corner to G. Hancock  
thence East 58 poles ending run at 26 poles to 3 small Ash  
Hickory & low. Walnut. thence South 55 poles to 2 poles  
branches at 23 poles to small Ash. Cherry & Hickory - thence



282

thence West 58/100, crossing a branch at 25 poles to a Stake in Knopf's said Lin. thence with said Lin North 55.2/100 poles, crossing branch at 25 1/2 and on at 36 p. to the beginning. Containing 20 acs. Peter Knopf, J. F. Knemkopf ch. men.

Dan Hopkins Co. S. T. C. O.

N<sup>o</sup> 406

8490

Surveyed March 14. 1838 a Lin between William McV<sup>o</sup>lts and David Shields, Heir. as follows.

Beginning on the line dividing S. 34. T. 5. R. 13 N. W. 1/4 from north to south, and N. 69 ch. 37 Links from a stem in the center of the South line of said section at a White Oak 24 1/2 ch. 12 Links thence S 87 1/2 E 62 ch. 65 Link to a stem in the East Lin of said section and N. 69 ch. 37 Links from J. P. Miller N. W. corner - Dan Hopkins Co. S. T. C. O.

N<sup>o</sup> 407

8426

Survey and Subdivision of S. 74. R. 13 N. W. 1/4 for Saml McFrank on Dan. Joseph, Alfred Hays and Horner made March 23<sup>rd</sup> 1838. Boundaries James Carter ch. men.

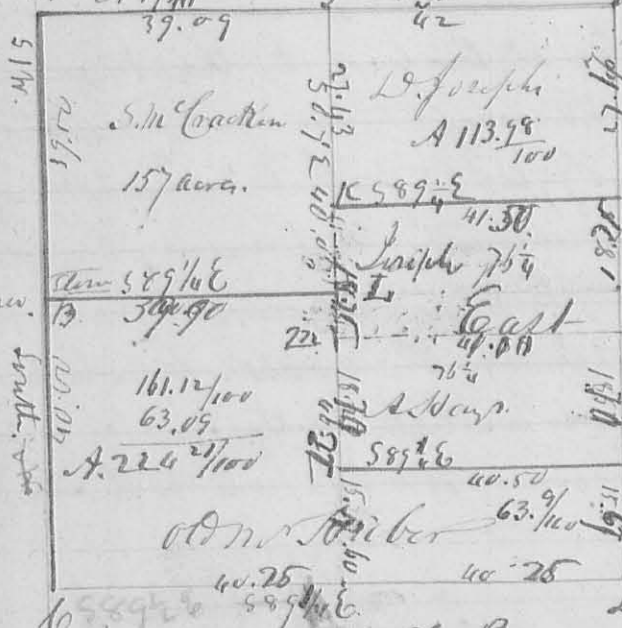

Description of Corners.

G. A. NW Corner of the section the original bearing true down planted stem and marked W. Oak 15 1/2 D. 55 7/8 61 Links - B. Oak 12 D. N. 32 1/2 18 links planted stem. C. SW Sect corner. planted stem in a Stake and D. Bur. 0 12 N 52 E 17 Links. E - Jack Oak 8 1/2 D. 589 1/4 65 Links. F. Bur. Oak 6 1/2 D. N 37 1/4 8 Links ditto G. 56 1/2 W 64 Links. G. Stem. H. Jack Oak 10 1/2 D. N 10 E 11 Links. ditto I. 6 1/2 D. 523 E 9 Links. J. Stem. orig. tree standing a white oak 20 1/2 D. 542 E 29 Links. K. Stem. I. Mickay 6 1/2 D. N 50 W 15 Links Jack oak 3 1/2 D. 564 E 18 Links. M - Bl. Oak 15 1/2 D. N 30 E 29 Links. an oak 500 W 15 Links - Dan Hopkins Co. S. T. C. O.