

132  
 668 acrs. - The division line east and west begins in <sup>132</sup>  
 the east line 150 poles from the S. E. corner of the sec.  
 a w. oak  $\text{S } 70^{\circ} \text{ W } 23^{\circ}$  links; thence west, crossing the creek  
 at 158 poles  $\text{S } 20^{\circ}$  poles to a stake in the west line of the sec.  
 The line north and south begins at a w. oak  $\text{S } 83^{\circ} \text{ W } 16$   
 links dist in the north line 164 poles from the N. W.  
 corner of the sec.; thence south crossing the creek 9 times  
 passing the center stake at 153 poles  $\text{S } 04^{\circ}$  poles to a stake  
 in the south line of the sec. a w. oak  $\text{S } 34^{\circ} \text{ E } 19$  links.  
 dist. 164 poles from the N. W. corner  
 Cyrus Ferris } C. C.  
 Henry Kelley } C. C. James Harmon

B. Long et al. } 10<sup>th</sup> Mo., Oct. 16 1831  
 N. 168 } 3

Survey No 168

(8258)  
 Surveyed 206 acrs for Benjamin Long and step  
 sons, heirs of Zabud Randall; beginning at a white  
 oak, where formerly stood 2 white oaks hickory and elm  
 (the hickory elm and one white oak is down), at the N. E.  
 corner of Thomas Worthington's survey N 4497; thence  
 with his east line  $\text{S } 20^{\circ} \text{ E}$ , crossing Machachae at 129  
 poles, 248 poles to 2 black oaks and red oak, the S. E. cor  
 -ner of said survey; thence  $\text{S } 70^{\circ} \text{ W}$  with the south line of  
 the original survey, 137 poles to 2 black oaks and hickory  
 corner to Gauge No. 1 found  
 thence  $\text{S } 20^{\circ} \text{ W}$  (crossing  
 Machachae at 268 poles)  
 (a mill race at 234 poles)  
 248 poles, to a white oak  
 in the north line of said  
 survey - thence with said  
 line  $\text{S } 70^{\circ} \text{ E}$  137 poles to the  
 beginning containing  
 206 acrs, off the east end  
 of Worthington's said survey  
 Jeffrey Williams } C. C.  
 Thomas Wittett }

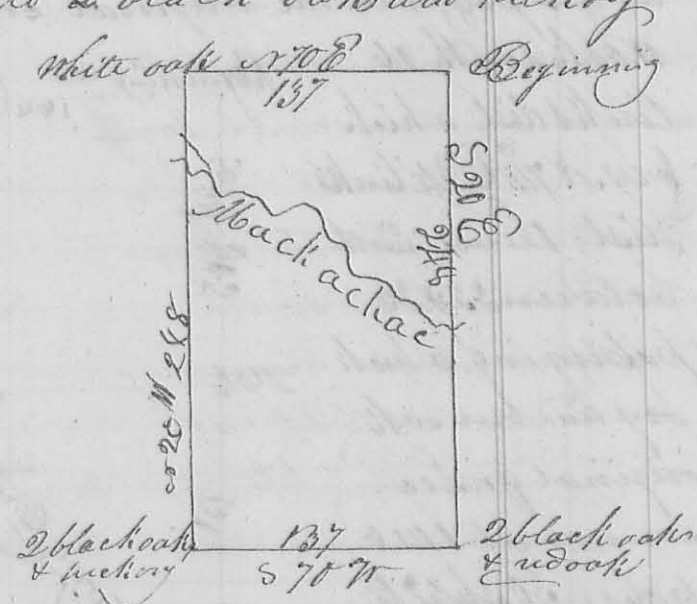

James Harmon  
 C. C.