

76 12<sup>th</sup> mo. (Dec) 2<sup>th</sup> 1827 (8217) ✓ Survey No 95 76

Surveyed for Charles Drinnay. Beginning at the South west corner of Philip Daughter's survey no 3154 a large ash, sugar tree, and cypress stumps, thence ~~58~~ 98 poles N 88° W (cypress a small branch at 12 poles) 49 poles to a stone near a large oak; thence N 51° E 98 poles to a stone in John Woodman's west line - thence with Woodman's line N 38° E 49 poles to a stone corner to Woodman's land thence with the north line of Philip Daughter's said survey N 58° 41' W 98 poles to the beginning containing 29 1/4 acres part of Philip Clayton's survey no 3164

Stacy Smith  
John Woodman } Co

J. W. Mearns & Co

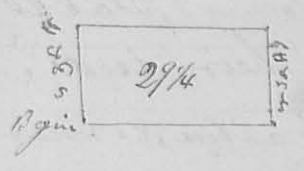

1<sup>st</sup> mo. (Jan) 7<sup>th</sup> 1828 ✓ Survey No 96 (8219)

Surveyed for Edward Marow. Beginning at a dog wood and iron wood C. C. corner to Joseph Dickinson's land on the head of McKays Creek, and in the east line of Alexander Sandridges' survey no 3220; thence, west with the south line of Dickinson's land 85 poles to a hickory and 2 white walnuts on the west bank of said creek; thence down the creek with its meanders, to 2 swamp beeches, hickory and elm on the west bank thereof 7 poles south of the road from Bellefontaine to Jonesfield; thence east 212 poles, to 2 sugar trees and black ash in the original line thence with said line north 97 poles to the beginning containing 100 acres -- part of Sandridges' said survey --

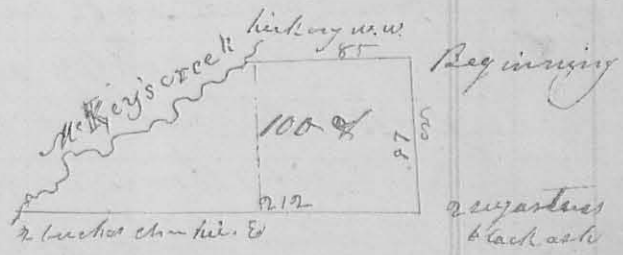

I also ran a line through said 100 acres beginning at a sugar tree and ash in the north line 82 poles from the beginning corner; thence south 97 poles to a cypress in the south line dividing the 100 acres into 2 equal parts

Wm. Smith  
Arch. Walker } Co

J. W. Mearns & Co