

8533

Survey  
596

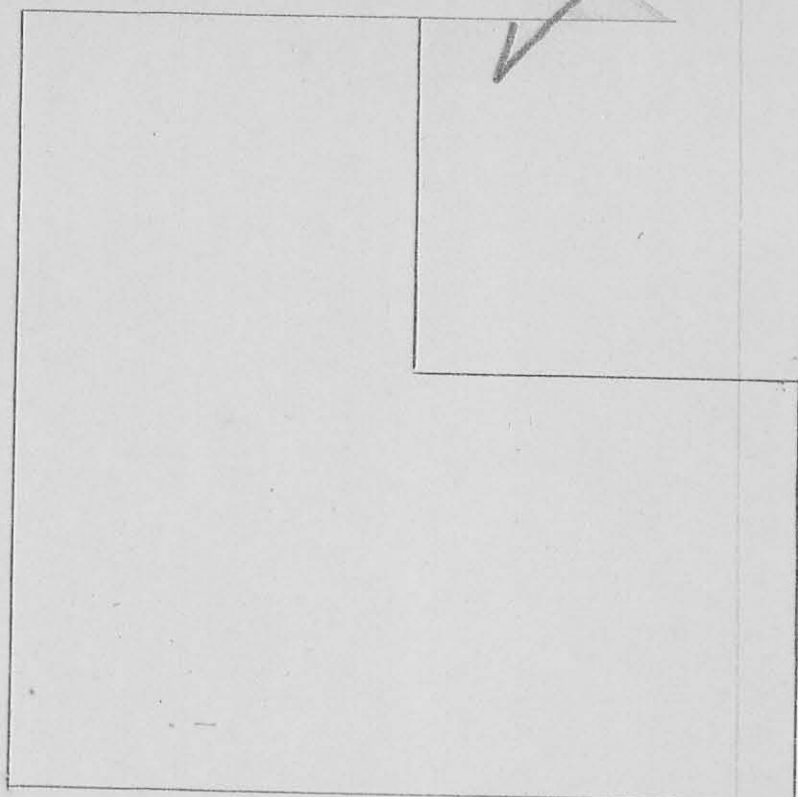

Surveyed Sept 1st 1847 for Robt Patterson  
 Administrator of A & S Spencers Estate a part  
 of the N E q of Sect 15, 23, R 14, as follows  
 Beginning at a stone in Sect line 80 poles or 88 1/2  
 W from N E Corner of said Section, and run  
 N 88 1/2 W 163 1/2 poles to a Stake (Hickory 14 1/2  
 S 35 W 10 links, W Oak 12 1/2, S 75 E, 35 links)  
 then S 1 1/2 W 138 poles to a Stake, (W Oak 20 1/2,  
 S 1 1/2 W 50 links) then S 88 1/2 E 95 poles to  
 West edge of prairie, 163 1/2 poles to a Stake  
 in prairie then N 1/2 E 86 poles to Stake  
 in prairie then N 88 1/2 W 62 1/2 poles to West  
 edge of prairie 80 poles to a Stake in field  
 then N 1/2 E 72 poles to the Beginning con-  
 taining 125 45/100 Acres

J D Kinn  
 A Bossart

A Harrison  
 C S Yool