

Survey
596

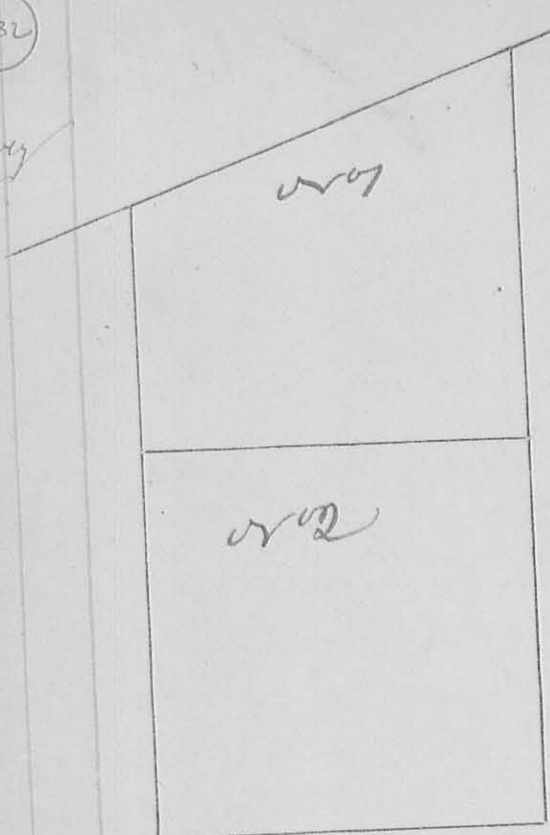

Surveyed and subdivided
Sept 12 1847 for James
Miller and Fleming
the East half of Section
19, 22, R 15. As follows
Set v07 Beginning at the
N W corner of said Section
and run S 1/2 W 136 poles
to a stake in center of
Candy-roun (W Oak 88 3/4
E 3 poles 14 links) then
88 1/2 W 162 1/2 poles to a
stake (Jack Oak 4 1/2 D, N
2 E, 31 links, and Jack Oak
6 1/2 D, 566 E 36 links) then

N 1/2 E 10 1/2 poles to stake in Greenilly
treaty line (W Oak 12 1/2 D 528 1/2 E 28 links)
then N 80 E 164 poles to the Beginning
Containing 120 00/100 Acres
Set v02, Beginning at the South East
Corner of said Section (W Oak 12 1/2 D, S 1/2 W
42 links, and W Oak, 16 1/2 D N 6 1/2 E 31 links
this last tree down but stump found) and run
N 88 1/2 W 162 1/2 poles to stake (W Oak, 18 1/2 D
N 67 1/2 E 37 links) then N 1/2 E 160 poles to
a stake (Jack Oak 4 1/2 D, N 2 E 31 links
and Jack Oak 6 1/2 D, 566 E 36 links) then S
88 1/2 E 162 1/2 poles to stake in Candy-
roun (W Oak 18 1/2 D N 88 3/4 E 3 poles 14 links
then with said road S 1/2 E 160 poles to the
Beginning Containing 162 1/2 Acres
Elias Thompson
Saml Hurst
W Harrison
C S Geo D