

Oct 1835

223

N^o 287 Surveyed Oct. 16 1835 for Philip Le dricks part of the S. E. q^r of S 22 T 3. R 14 M. R. D. as follows. Beginning at the NW corner of said quarter Section a Hickory 15th N 95 E 36 Links, Bur. Oak 18th N 35 W 57 Links, then W East 1.52 to R. Oak 12th W 21 Links, and E W 10th S 60 E 65th Links, then Sth W 39.25 crossing the creek to Hickory 12th S 8 E 11 Links, & Hickory 8th N 23th W 30 Links, then West 1.52 to the SW corner of said corner. orig. witness trees, then Nth W 39.25 crossing creek at about 8 p.m. to the beginning containing six Acres.

8355

Oct 16 1835

Jan Hopkins Sur. L. C.

N^o 289

Part of S 20 T 3. R 8 E

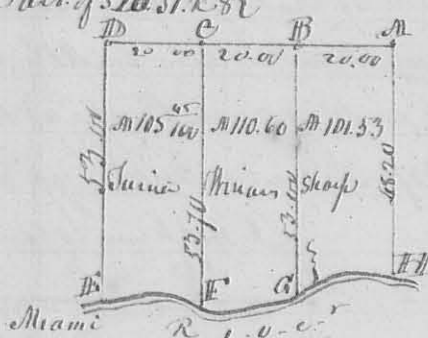

8356

Divided Tract S 20 T 3. R 8 E between James Minam & Shoop as shown by the plat. Beginning at B. corner between Martin & Groves on the South line of S 16. at an old 3rd N 40 W 32th Ch 2nd S 76 W 11th Links, then S 5 E 53 ch to the River see letter a, a dy camas 1st S 5 E 15 Links, Hackberry 24th N 15 W 68th Links.

then began at C. orig. p. Post then S 5 E 53 ch. 70 Links, to a stone at H. then began at D corner on South line of S 16. between Groves & James a pole 15th N 11 W 14 Links, & Hickory, then S 5 E 33 ch. to River at G a Log 15th West 10 Links Buck Eye 8th N 37 W 10 Links.

Oct. 1835

Jan Hopkins L. C. Surveyor

N^o 290 Tract S 27 T 3. R 8 E

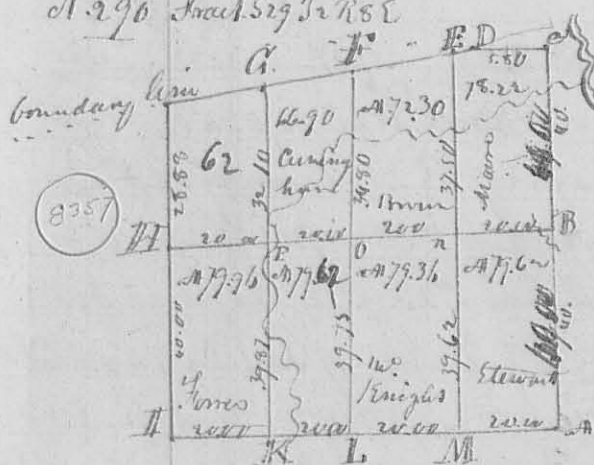

8357

This Plat represents the survey sub. division of S 27 T 3. R 8 E. between the individuals whose names are written on the map - Corner of the line N 37 W. boundary line runs from the East by 8 W. the description of corners as follows. at A Section Corner B. Beech 22th N 35 W 6th Links, Beech 18th S 60 E 37 Links. C Sect. corner D. orig. corner a boundary (C. low cut down was the corner tree) E. Sugar 12th S 55 E 5 Links, Ironwood 8th S 80 E 8th Links, F. Sugar 18th S 5 E 33 Buck Eye 8th N 35 W 33 Links, G. Beech 12th N 78 W 13th Links, Beech 5th S 80 E 6th H. orig. p. corner I. Sect. corner. K. Alder & Hickory from one root 12th N 75 W 8th Beech 16th N 34 E 25th B. at the

then began at C. orig. p. Post then S 5 E 53 ch. 70 Links, to a stone at H. then began at D corner on South line of S 16. between Groves & James a pole 15th N 11 W 14 Links, & Hickory, then S 5 E 33 ch. to River at G a Log 15th West 10 Links Buck Eye 8th N 37 W 10 Links.