

and white oak 14⁰ 3/4 links dist. in the north line of the section
 thence with said line East 13¹/₂ poles (spring a branch at 64
 poles) to a stake in Ludlow's line at the N.E. corner of said
 sec. (the original bearing trees have been destroyed) thence with
 said line S 19⁰ 47' des. to a buckeye or 65¹/₂ 45 links dist. a
 white ash 14⁰ 1/2 33 links.

thence an original corner of
 the sec. on Ludlow's line
 thence South (spring a
 branch 38 poles, one at 112
 poles) 240 poles to the begin-
 -ning containing 324¹/₂ acres

Run a division line beginning
 at a stem and black oak 100⁰
 9 links in the west line of the
 sec 160 poles from the N.W. corner
 thence thence East (spring a

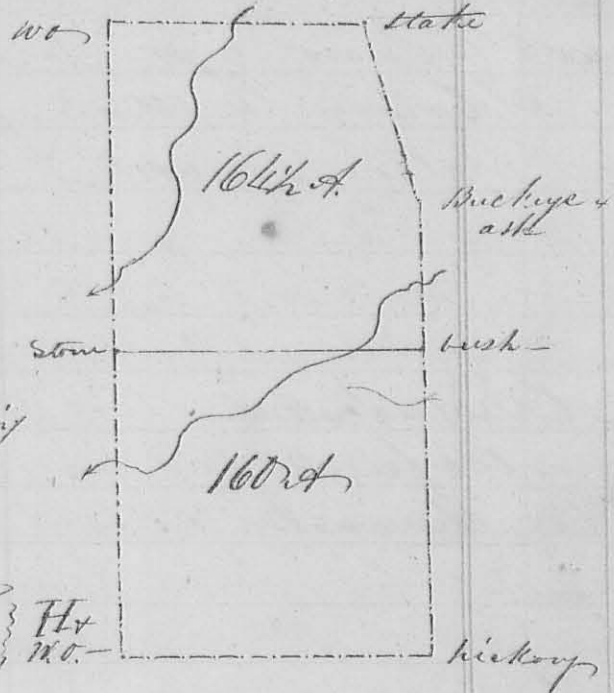

small hickory bush in the east line of the section

Wm. Marquis }
 Wm. Marquis }
 Wm. Marquis }

J. W. Marrison }
 J. W. Marrison }
 J. W. Marrison }

W.B. Clemens }
 W.B. Clemens }
 W.B. Clemens }

Survey # 181
 8269

Surveyed the C. n of the S.E. q. of sec 23 T 3
 R 14 N.W. for John B. Clemens, Beginning at the N.E.
 corner of said sec a white oak original corner tree thence
 with the south line of the section West 1/2⁰ variation eastward,
 81 poles to a stake in the road from Bellefontaine to Sydney,
 thence N 10⁰ 161 poles to a stake in
 a prairie thence East (with easterly variation)
 81 poles to a stake in the east line of
 the section thence with said line N 10⁰
 161 poles to the beginning containing
 83 acres -

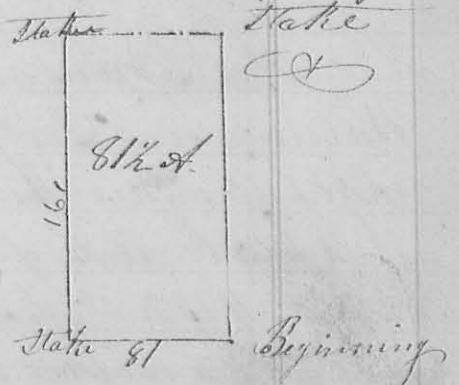

Thomas Powell }
 William Carpenter }
 Thomas Powell }
 William Carpenter }

J. W. Marrison }
 J. W. Marrison }
 J. W. Marrison }