

(142)

last named corner, a stone and black oak, thence
 S 2 1/2 N 16 3/4 poles to a stone and hickory in the south line
 N 3 being at a stone and elm in the south
 line 1/2 poles from the latter corner thence N 2 E 16 3/4
 poles to a stone & white oak in the north line - then
 dividing the west side into two equal lots of 79 acres
 each & the east side into two of 77 acres each -
 Solomon Thrasher }
 Peter Provost } J. M. Marmou
 C. S. L. C. S.

John Benders

13th March, 28th 1832

Survey No 179

(8267)

Surveyed 103 acres for John Benders; beginning
 at a red oak and two buck stumps in a line N.E. of Ropp's
 house - thence with said line N 78 E 104 poles to a small sugar
 tree - thence N 2 1/2 W 160 poles to an ash and white oak - thence
 S 78 W, crossing the road from Bellefontaine to Detroit
 at 22 poles) 102 poles to a sugar tree ash & buck corner to John
 Piatt's 50 acres - thence
 with the east line
 S 12 E 160 poles (crossing the
 aforesaid road at 108 poles)
 to the beginning part of
 Survey 9984 on Cherokee
 - Mar's run

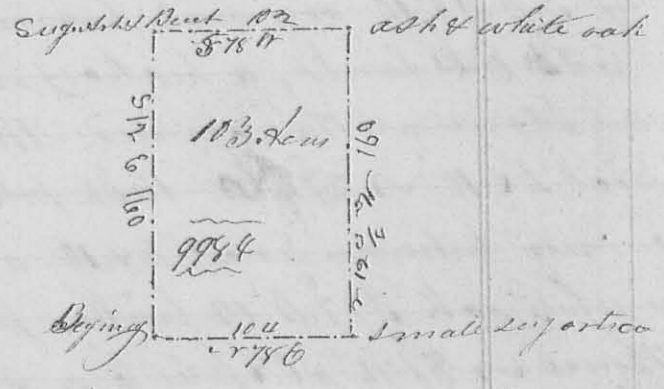

Ch. Lorenus Patrick }
 Peter Beards } J. M. Marmou
 C. S. L. C. S.

Survey No 180

Thomas Morquis } 4th Mo, April, 16th 1832

(8268)

Survey the E 1/2 of sec. 1 Town. 2 Range 15. 1832
 for Thomas Morquis; Beginning at the south corner of said
 sec. an original corner tree a hickory standing & 57 1/2 links
 distant, the other tree is down there yet being some remains
 thereof - thence with the south line of the sec. west 160 poles to
 a stone marked a black oak N 80 E 9 links dist hickory N 8 W
 43 links, a white oak S 25 E 48 links distant - thence north up
 ing a branch at 116 poles or at 186 poles) 332 poles to a stone

and white oak 14⁰ 3/4 links dist. in the north line of the section
 thence with said line East 13 1/2 poles (upping a branch at 64
 poles) to a stake in Ludlow's line at the N.E. corner of said
 sec. (the original bearing trees have been destroyed) thence with
 said line S 19⁰ E 97 poles to a buckeye or 65 1/2 45 links dist. a
 white ash 14 1/2 33 links.

thence an original corner of
 the sec. on Ludlow's line
 thence South (upping a
 branch 38 poles, one at 112
 poles) 240 poles to the begin-
 -ning containing 32 1/2 acres

Run a division line beginning
 at a stem and black oak or 80
 9 links in the west line of the

sec 160 poles from the N.W. corner
 thence East (upping a
 branch at 10 poles) 160 poles to a

small hickory bush in the east line of the section

Wm. Marquis }
 Wm. Marquis }
 Wm. Marquis }

J. A. Marrison }
 J. A. Marrison }
 J. A. Marrison }

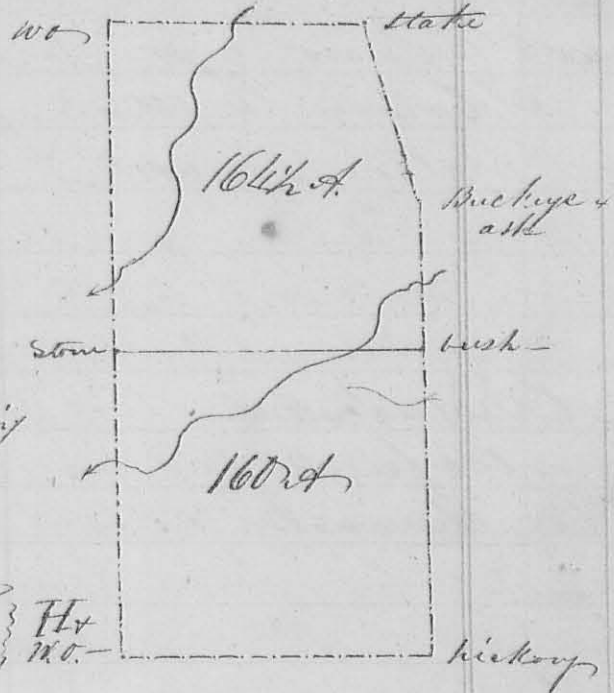

W.B. Clemens }
 W.B. Clemens }
 W.B. Clemens }

Survey # 181
 8269

Surveyed the C. n of the S.E. q. of sec 23 T 3
 R 14 N.W. for John B. Clemens, Beginning at the N.E.
 corner of said sec a white oak original corner tree thence
 with the south line of the section West 1/2⁰ variation eastward,
 81 poles to a stake in the road from Bellefontaine to Sydney,
 thence N 10⁰ E 161 poles to a stake in
 a prairie thence East (with easterly variation)
 81 poles to a stake in the east line of
 the section thence with said line N 10⁰
 161 poles to the beginning containing
 8 1/2 acres -

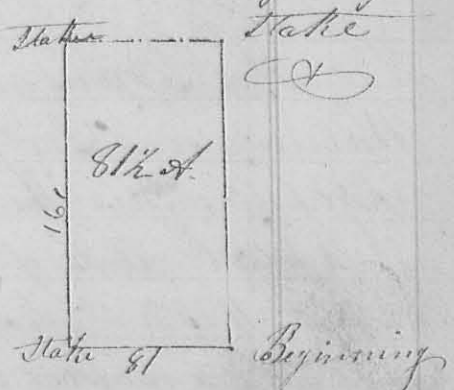

Thomas Powell }
 William Carpenter }
 Thomas Powell }
 William Carpenter }

J. A. Marrison }
 J. A. Marrison }
 J. A. Marrison }