

Survey
N^o 253

S. 13 R. 13 m. 1/2

8337

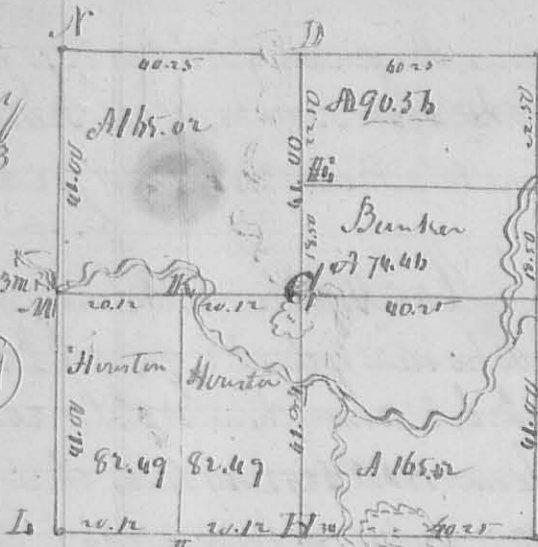

This plat represents the Survey & Sub. div
 ion of S. 13. R. 13. M. 1/2. bearing of the line
 & due course with variation 30' N. for the
 length of the lines, and contents of the lots
 as per the plat. Description of corners -
 A. S. E. corner of the S. 13. R. 13. M. 1/2 N 68 W 30
 White Oak 16 1/2 N 33 E 20 links
 B. B. Oak 20 1/2 Ball 24 1/2 links and
 A White Oak 18 1/2 S 63 W 30 L.

C. W. Oak 16 1/2 S 41 E 16. and White oak 12 1/2 N 81 W 32 links
 D. Hickory 4 1/2 N 35 E 37 1/2 links, R. Oak 26 1/2 N 31 W 73 ditto
 E. B. Oak 8 1/2 N 34 W 21 links, Hickory 8 1/2 S 89 E 19 links
 F. Stake near a branch.
 G. Bur. Oak 15 1/2 N 30 E 109 links, same 15 1/2 N 28 E 93 links
 H. B. Oak 12 1/2 N 48 E 50 links, Hickory 15 1/2 N 71 W 33 links
 I. W. K. Stake. M. Stake in a prairie. L. N. S. M. N. W. corner of the
 Oct. 1834

Geo. Hopkins, L. C. Surveyor

N^o 254

8338

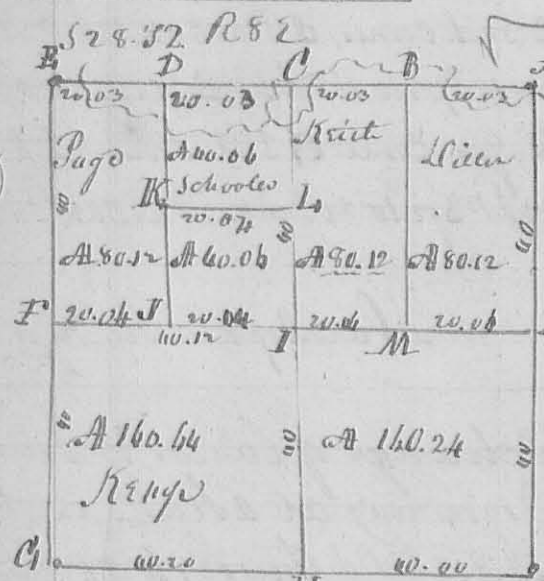

In this survey the line A. bears N 85 W
 for distance to the plat. O. C. bears the same
 O. A & C. E. bear N 3 W & N 5 1/2 W.

Description of corners as follows -
 N. A. E. C. O. Section corner, N. H. Origin
 of gr. Posts.
 B. Lyrum 18 1/2 N 87 1/2 W 39 Buck eye 3
 W 18 1/2 E 30 1/2 L. M. Buck 10 1/2 S 89 W
 36 links, Elm 6 1/2 N 50 E 19 links
 I. Beech 18 1/2 N 22 E 10 L. Beech 18 1/2 S 12 W 30 Links C. Elm N 85 E 14
 Links, Gray Ash 8 1/2 N 44 W 18 links, K. Hickory 18 1/2 S 55 E 14
 Beech 3 1/2 N 12 W 20 links, L. Buck 18 1/2 N 63 W 3 Links and
 Buck 12 1/2 S 4 E 25 links, D. Buck 12 1/2 N 33 W 12 Beech 10 S 89 E
 26 links, F. Buck 22 N 33 W 47 Links, Beech 18 1/2 S 61 E 37 Links, J. Stake
 in the line W. F. with 6 Links 185 W from I.

Oct. 21. 1834

Geo. Hopkins Surveyor L. C.