

HENRY SURVEY
216 E. WASHINGTON ST.
BELLEFONTAINE, OHIO
MARCH 30, 1967

The following described real estate situated in the City of Bellefontaine, Lake Township, Logan County, Ohio and being part of Section 34, Town 4, Range 14 of the Between the Miami Rivers Survey and more particularly described as follows:

Beginning at an iron bar at the intersection of the south line' of Washington Street and the west line of Hamilton Street; thence with the west line of said Hamilton Street S.4° 36'W. 260.0 feet to an iron bar at the northeast corner of the Bellefontaine Development Company's 2.92 acre tract; thence with the north line of said tract N.85° 17'W. 59.4 feet to an iron bar at the southeast corner of Donald E. Baker's 0.33 acre tract; thence with said Baker's east line N.4°43'E. 260.0 feet to an iron bar in the south line of said Washington Street; thence with said south line S.85° 17'E. 58.7 feet to the place of beginning.

Containing 0.35 of an acre more or less.

INDEXED ON MAP

4264 1D

HAMILTON ST. 50'
S. 4° 36' W. 285.0'

WASHINGTON AVE. 50'
S. 85° 17' E. 83.7'

4' Conc. Walk

25'

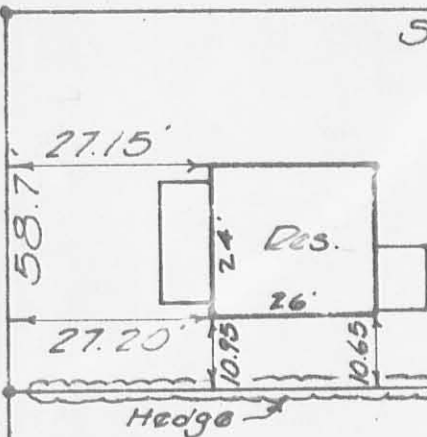

S. 4° 36' W. 260.0'

216 E. Washington Ave.

0.35 Ac.

N. 4° 43' E. 260.0'

Donald F. Baker et ux
0.33 Ac.

25.0'

59.4'

N. 85° 17' W.



HENRY SURVEY
 SEC. 34, T-4, R-14
 LAKE TOWNSHIP
 LOGAN COUNTY, OHIO
 CITY OF BELLEFONTAINE
 MARCH 30, 1967
 SCALE 1"=30'

I hereby certify that this plat is a correct representation of a survey made by me and that the same shows the improvements as located on the premises.

The improvements are entirely within the property lines and there are no encroachments on the premises by improvements on adjoining premises.

● = Iron Bar

Dan L. Dodson
 Reg. Surveyor 4270
 Bellefontaine, Ohio

4264 110

INDEXED ON MAP

HENRY SURVEY
DELLAFONTAINE, Ohio

SEE F.B. 492, pg. 49
SEE Inskip Survey Plan 3-1

- A = 1" ϕ Bar Found
- B = 1" Pipe "
- C = 1" ϕ Bar Found @ Madriver. St.
- D = 5/8" ϕ Bar Set
- E = " " "
- F = 3/4" ϕ Bar Found
- G = 5/8" ϕ Bar Set
- H = 3/4" ϕ Bar Found

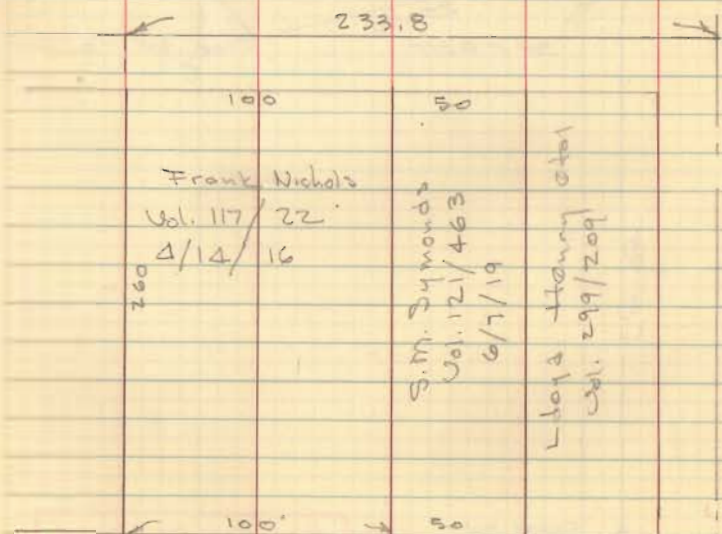

March 20, 1967
75° 49'

