

Received 12/17/89 in 954

MAP ROOM

**DOW To JOHNSON SURVEY**

The following described real estate situated in the City of Bellefontaine, Township of Lake, County of Logan, State of Ohio and being a part of Lot No. 969 and a part of a 0.131 Acre tract in Section No. 35, T.4, R.14, BMRS in the name of Stanley E. Dow et ux as recorded in Deed Volume No. 304 Page 335 (8-20-1965) and Deed Volume No. 353 Page 472 (6-12-1974) and being more particularly described as follows:

Beginning at a 5/8" x 30" Rebar found at the northeast corner of Lot No. 970 in the name of Dixie Lee Johnson and the northwest corner to Stanley E. Dow's present 0.131 Acre tract;

Thence with the north line of said 0.131 Acre tract, N. 83°28' E. 2.00 feet to a 5/8" x 30" Rebar set;

Thence parallel with the east line of said Lot No. 970, S. 6° 00' W. 52.00 feet to a 5/8" x 30" Rebar set;

Thence N. 83°28' W. 22.00 feet to a 5/8" x 30" Rebar set, passing through the east line of Lot No. 969 at 2.00 feet;

Thence N. 6°00' E. 2.00 feet to a 5/8" x 30" Rebar set in the line between Lot No. 969 and Lot No.970;

Thence with the line between said lots, S. 83°28' E. 20.00 feet to a point at the southeast corner to Lot No. 970 and the northeast corner to Lot No. 969 and in the west line of said 0.131 Acre tract;

Thence with the line between Lot No. 970 and said 0.131 Acre tract, N. 6°00' E. 50.00 feet to the place of beginning, containing a total of 144.00 square feet or 0.003 Acres, more or less.

Of the above described tract, there is 40.00 square feet or 0.001 Acre in Lot No. 969 and 104.00 square feet or 0.002 Acres out of said 0.131 Acre tract in Section No. 35, T.4, R.14 BMRS.

I hereby certify that this description is based on a field survey made by me on December 1, 1989.

*Daniel E. Gilbert*

DANIEL E. GILBERT, P.S.  
Reg. Sur. No 5402  
400 N. Park St.  
Bellefontaine, Ohio  
43311



INDEXED ON MAP  
3988 112

LAWRENCE ST. - 45' R/W

N. 6°-00' E. Basis of Bearing 50.00'

John E. Brown  
O.R. 38 P. 422 (3-4-1986)  
Per. Par. No. 17-091-07-18-003.000  
Lot No. 983 pt.

Per. Par. No. 17-091-07-18-004.000  
0.170 Acres

S. 83°-28' E. 103.50'

S. 83°-28' E. 2.00'

Dixie Lee Johnson et al  
Vol. 387 P. 438 (4-3-1980)  
Per. Par. No. 17-091-07-18-006.000  
Lot No. 970

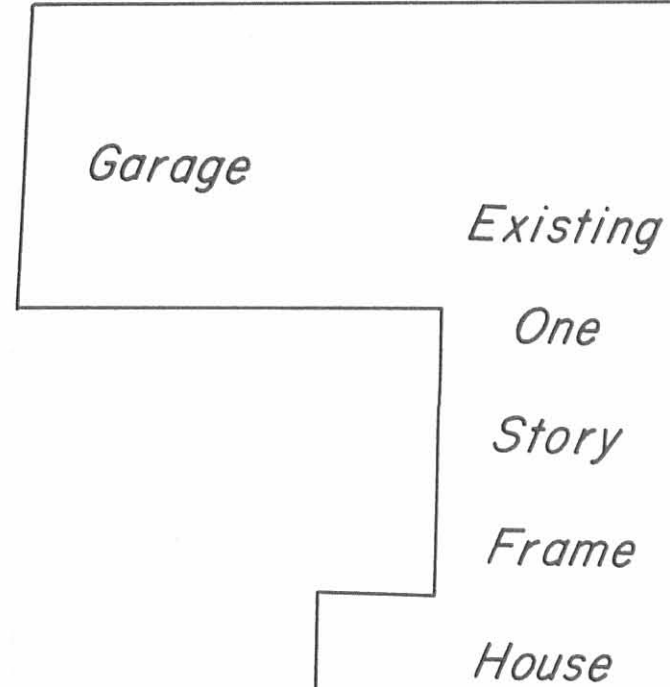

N. 6°-00' E. 50.00'  
S. 6°-00' W. 52.00'  
N. 6°-00' E. 2.00'  
S. 6°-00' W. 22.00'

N. 83°-28' W. 83.50'

N. 6°-00' E. 2.00'  
S. 83°-28' E. 20.00'  
N. 83°-28' W. 22.00'

Stanley E. Dow  
Vol. 353 P. 472 (6-12-1974)  
Per. Par. No. 17-091-07-18-005.000  
0.131 Acres

Stanley E. Dow et ux  
Vol. 304 P. 335 (8-20-1965)  
Per. Par. No. 17-091-07-18-007.000  
Lot No. 969

● - 5/8" x 30" Rebars Fd. or Set.

INDEXED ON MAP  
3988 IP

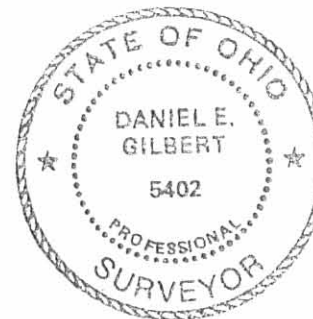

Dow To Johnson Survey, Part of Lot No. 969 + Acreage,  
Section No. 35, T.4, R.14 BMRS, City of Bellefontaine,  
Lake Township, Logan County, Ohio.

SCALE: 1" = 10'	APPROVED BY:	DRAWN BY DEG
DATE: 12-1-1989		REVISED

*Daniel E. Gilbert*  
Daniel E. Gilbert, P.S.  
Reg. Sur. No. 5402

DRAWING NUMBER  
089-072

Ives - Hughes Survey Bellefontaine September 1966 0.07 Acre

The following described land in Bellefontaine, Lake Township, Logan County, Ohio and being in Section 35 Town 4 Range 14.

Beginning at the N.E. corner of Lot Number 970. ( Lot Number 970 being on Lawrence Street ) Thence East with the south line of a 0.21 acre tract in the name of A.E. Knowlton 59.00 feet to an iron in the west side of a fifteen foot alley. The last described line being an extension of the north side of Lot Number 970.

Thence with the west side of said fifteen foot alley South 50.00 feet to an iron.

Thence west 59.00 feet to an iron at the S.E. corner of Lot Number 970. The last described line being an extension of the south line of Lot Number 970.

Thence with the east side of Lot Number 970 North 50.00 feet to the place of beginning.

The above described tract contains 0.07 of one acre and is off of the north end of a 0.24 acre tract now in the name of John L. Hughes.

cc  
Logan County Engineer



INDEXED ON MAP

3988

2D

00 Plan Book K  
12/3/66  
DEC.