

Surveyed for Churchill Jones and James Taylor ^{ap^{re}} and John Steel 999 ²/₃ acres of land on two Military Warrants, Jones and Taylor 611 acres on No 5731 and Steel 388 ²/₃ acres on No 5443 on the big Miami: - Beginning at an ironwood and two beeches Northwest corner to George Clarke's survey No. 9947 thence S 78. E 400 poles crossing the big Miami at 144 poles and several times leaving at 210 poles to two sugar trees and two buck-

eyes northeast corner to Clarke's said survey; thence N. 12. W. 400 poles to two beeches, thence S. 78. W. 400 poles to a stake 25 poles west of the North branch of Miami; thence S. 12. E 400 poles to the beginning.

Levi D. Thorpe
 Keniah Rosebrau
 Wilson S. Thompson M.k.s.

Sam^l Forster D. S.
 February 29. 1820
 July 22nd 1820

Surveyed for James Taylor ^{ap^{re}} 611 acres of land on part of a military warrant No 5431 on the Big Miami: Beginning at an Ironwood and two beeches Northwest corner of George Clarke's survey No 9947; thence N 78 E 250 poles (at) the big Miami at 114 poles and several times and leaving it at 210 poles to a stake in Clarke's line; thence N. 12, W. 400 poles to a stake, thence S. 78. W. 250 poles to a stake 25 poles west of the North Branch of Miami, thence S. 12. E. 400 poles to the beginning.

And S Dawson
 Jesse Coffee
 G. Henderson M.k.s.

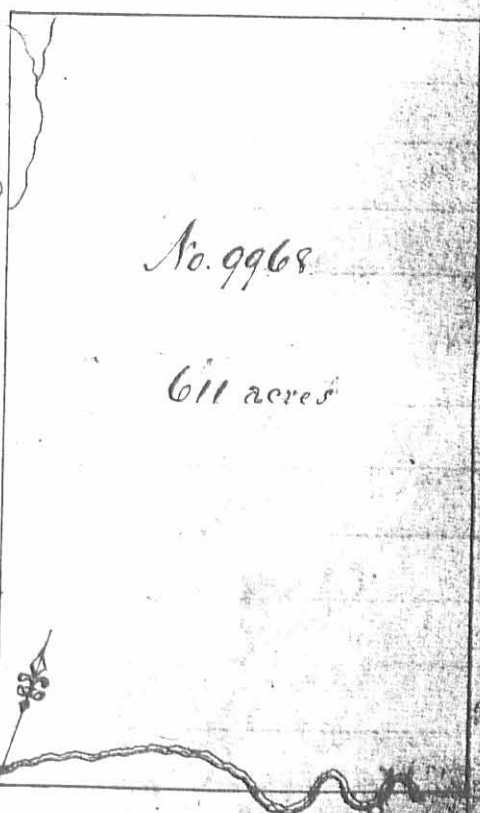

James Taylor D. S.
 July 4th 1839
 July 12th 1839

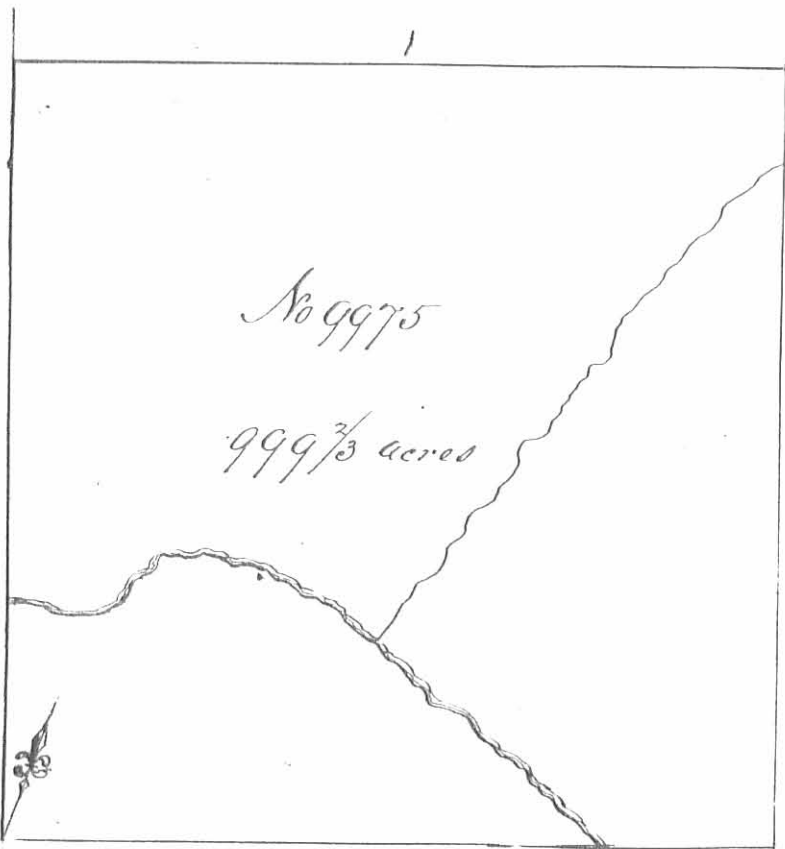

Surveyed for the Representatives of William Miller dec^d the representatives of John Green dec^d Thomas Martin and James Taylor ap^{te} 999 ²/₃ acres of land on the following Military Warrants; - Miller 388 ²/₃ acres on No 5439 Green 111 acres on No 5089 Martin and Taylor 353 acres on part of No. 5247 and James Taylor 145 acres on No 5363 and 50 acres on No. 5408 on the waters of Big Miami beginning at a Sugar tree and

three beeches southeast corner of Duncan McArthur's survey No. 9974 thence N. 78. E 400 poles crossing a drain at 14 and the main branch of Miami at 308 poles to three beeches northeast corner to James and William Taylor's survey No 9954, thence N 12 W. 400 poles crossing a branch at 34 poles to three beeches, thence N 78 W 400 poles to an elm, maple and ash northeast corner of McArthur's said survey; thence S 12 E 400 poles crossing the main branch at 266 poles to the beginning.

Levi D Thorp
 Belkiah Rosebrog 3/66
 Wilson S Thompson M.k.v

Sam^l Forrer D.S.
 March 2nd 1820
 July 22nd 1820

Surveyed for Elizabeth Monon dec^d and James Taylor ap^{te} 999 ²/₃ acres of land on two Military Warrants Monon 555 acres on No 5460 and Taylor 444 ²/₃ acres on No. 5456 on the waters of Scioto; beginning at three beeches southeast corner to James Benwick's survey No. 9936, thence with a line of Nicholas Taliaferro's survey No 9912 N 78 E 400 poles crossing a branch of Boker's creek at 269 poles to a buckeye, bur oak and hickory northeast corner to Taliaferro's said survey, thence N 12 W. 400 poles to a buckeye and two iron woods, thence S 78 W. 400 poles to two ashes and an elm northeast corner to said Benwick's survey, thence with said line S 12 E 400 poles to the beginning.

Levi D Thorp
 Belkiah Rosebrog 3/66
 Wilson S Thompson M.k.v

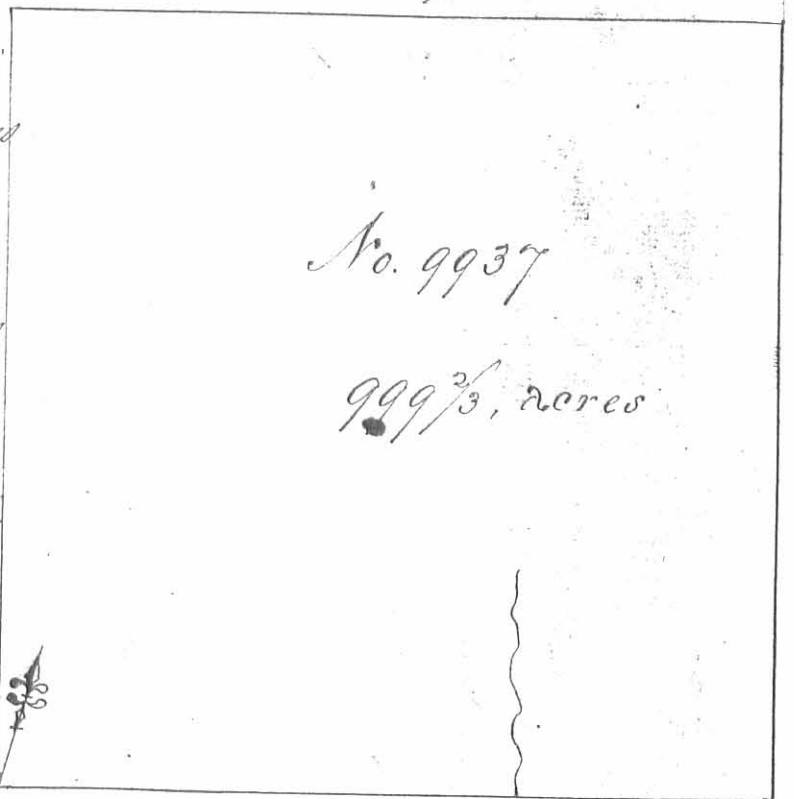

Sam^l Forrer D.S.
 January 21st 1820
 July 22nd 1820

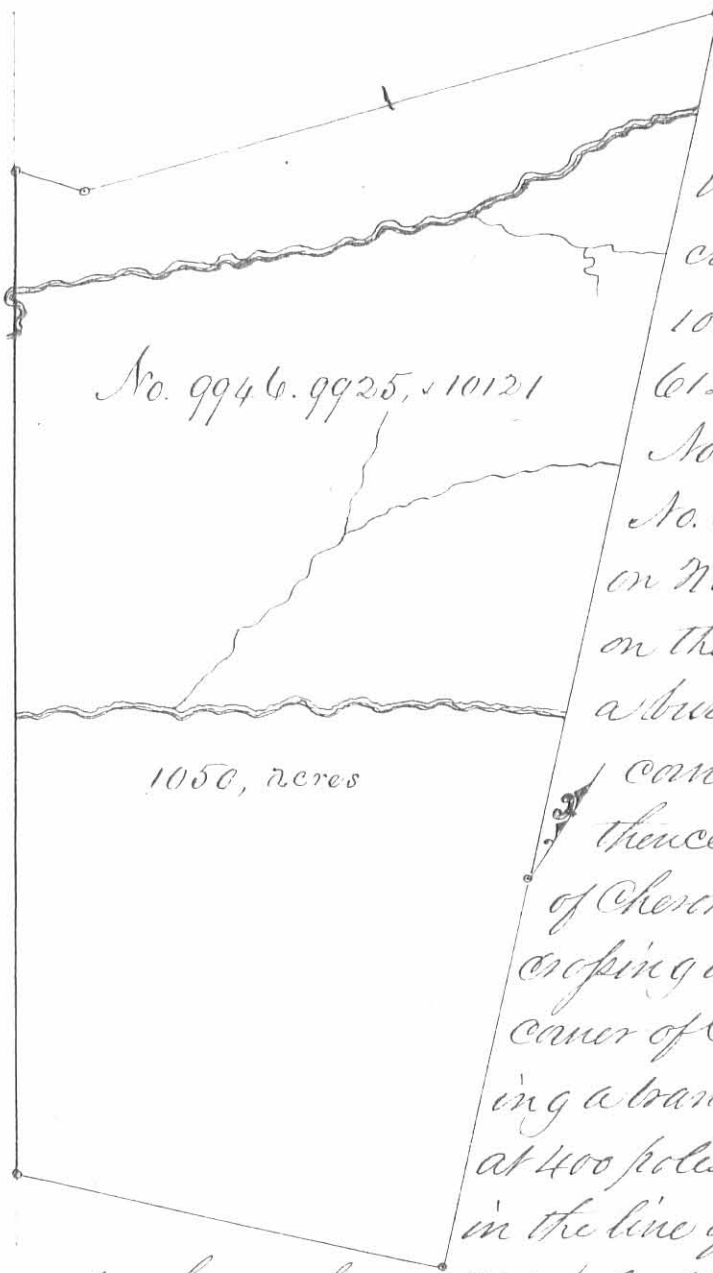

Surveyed for Walter Dun of ¹⁰⁵⁰ acres of land in part of ~~various~~ Military warrants, 210 acres on No 6202, 100 acres on No. 5877, 46 ²/₃ acres on No 6217, 100 acres on No 5718, 100 acres on No 6120, 15 acres on No. 6124, 27 acres on No. 5825, 200 acres on No 6216, 210 acres No. 5828, 73 ²/₃ acres on No 5849, 37 acres on No 6222 and 21 acres on No. 6218 on the Big Miami river; beginning at a bur oak red oak and beech southwest corner to George Clark's entry No. 9947 thence N. 12 W. 400 poles touching a bend of Cherokee mans run at 68 and at 76 poles crossing it at 84 poles passing the north west corner of Clark's said entry at 400 poles, crossing a branch at 220 at 334 and the big Miami at 400 poles to a beech, two ashes & a hickory in the line of Churchill Jones and others entry No.

9968, thence S. 50 W. 344 poles to two ashes, thence S. 78 W. 37 poles to an ash maple and Elm in Robert's line also the line of the Shawnee and Seneca reserve at Swistain, thence with the said line S 24 30' E 520 poles crossing the big Miami at 60 and down it from 60 to 80 poles crossing Cherokee mans run 280 poles passing the division between the Senecas and Shawnees at 420 poles to two hickories and a large white oak in the said line, thence N. 78 E. 227 poles to a hickory red oak and Cherry tree; thence N. 12 W. 208 poles to the beginning

George Henry 3
James Henry 3 AC
Benjamin McCullough M.R.

Walter Dun D.S.
November 20th 1819
March 29th 1820

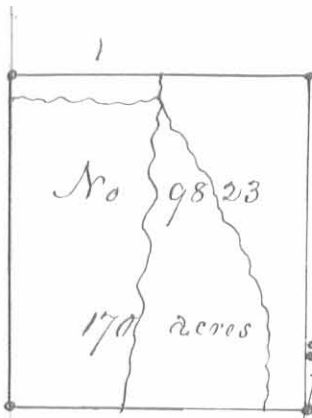

Surveyed for Thomas Pemberton 170 acres of land on part of a military warrant No 2742 on the lake of Rush creek; beginning at two sugar trees and an Ironwood Southwesterly corner to James Mcabins survey No. 3323 in the line of William Millers survey No 3327, thence with Mcabins line N. 10 W. 173 poles to a stake in said line; thence S. 80. W 158 poles crossing rush creek at 83 poles to a cypress, sugar tree and Ironwood in the line of Sayton Yanceys survey No. 3320; thence with said line S 10 E. 173 poles crossing a branch at 12 poles to a sugar tree and beech southeasterly corner to Yanceys said survey in the line of Millers said survey; thence with said line N 80 E. 158 poles crossing the lake from 60 to 130 poles to the beginning.

Thomas Southland 3
 Ebenezer O Kendrick 3 C.C.
 Matthias Bonner M.k.r.

Walter Dun D.S.
 January 15th 1820
 March 14th 1820

Surveyed for Joseph and Benjamin W Ladd and Thomas Novell a part of 100 acres of land on part of a military warrant No 5633 on the waters of Keill creek and Mad river; beginning at two poplars and a hickory westerly corner to the representatives of Swelling Jones survey No 4655 running N 38 W. 130 poles crossing a small branch at 94 poles to two beeches and an ash, thence N. 52 E. 124 poles to a sugar tree, dogwood, beech and hickory in the line of John M Donalds survey No. 5088, thence with his line S. 38. E. 130 poles to a sugar tree corner to his survey in said Jones line; thence with said line S 52 W. 124 poles to the beginning.

Edmund Mearman 3
 David Mearman 3 C.C.
 William Tinsley M.k.r.

James Gallaway Junr D.S.
 November 7th 1817
 May 22nd 1818

Surveyed for Walter Dun a part of 70 acres of land on part of a military warrant No 6218 on the waters of Mad river; beginning at a black oak in Sudlers line, westerly corner to Samuel Finleys survey No. 4493 & 4525; thence with Sudlers line N. 20 W. 188 poles passing a spring at 54 poles to two hickories in said line Southwesterly corner to Thomas McBoylers survey No. 5864, thence with Boylers line East 72 poles to a black oak in said line; thence S 20 E 162 poles to a stake in the line of Finleys said survey; thence with said line S. 70. W. 67 poles to the beginning.

Joseph Overstow 3
 James Craig 3 C.C.
 Aaron Hunt M.k.r.

Walter Dun D.S.
 January 14th 1819
 March 4th 1819

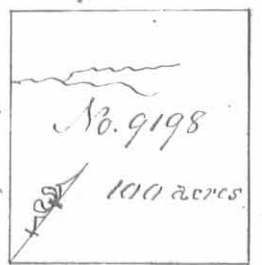

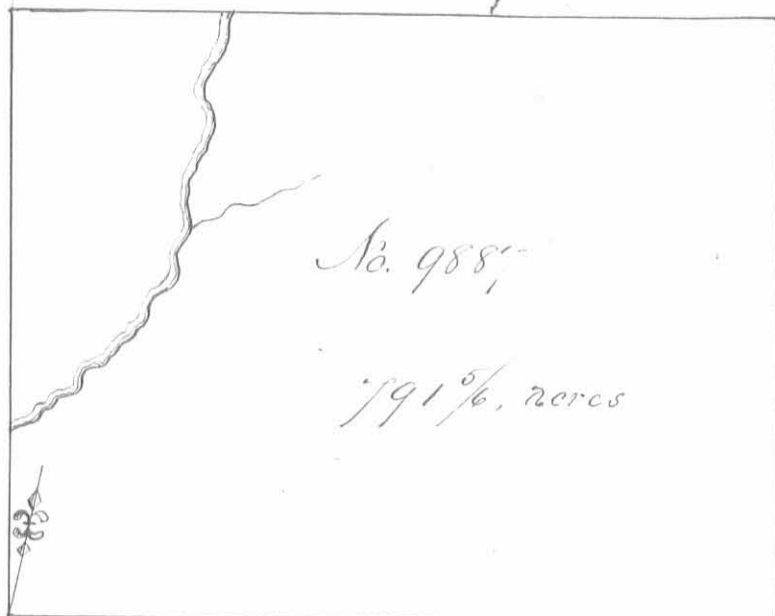

Surveyed for John Jameson, Lewis
Booker, Abraham Kite and James
Taylor Aprth 791 1/2 acres of land
on a Military warrant and
part of two, Jameson 208 1/2 acres on
part of No 5437, Booker 555 acres
on No 5423 and Kite and Taylor
28 1/2 acres on part of No 5548 on Rush
Creek: Beginning at an ash and
elm north west corner to John
Jamesons survey No 9887, thence

with his line N. 78. W. 400 poles crossing the Sandusky road at
336 poles to three beeches and two hornbeams northeast corner
to said Jamesons survey; thence N 12. W. 317 poles to a beech and
two sugar trees; thence S. 78. W. 400 poles crossing a rush Creek at
285 poles to a blue ash and beech northeast corner to Bradford
and others survey. No. 9886, thence S. 12. E. 317 poles crossing the
creek at 221 poles to the beginning.

Levi D Sharp
Melkiah Rosebrog 3 C. 6
Wilson L Thompson M. L. S.

Samuel Forrer D. S.
January 3rd 1820
May 8th 1821

* Surveyed for Luke Cannon and
James Taylor, James Williams,
Charles Pelham and James Taylor
1000 acres of land on two Military
warrants; Cannon and Taylor 148
acres on No 5444 Williams 388 1/2 acres
on No 6161 and Pelham and Taylor
463 1/2 acres on part of No. 5646 on the
waters of Pokes Creek: Beginning at
two sugar trees southeast corner to
Lewis and others entry No 9889 in
the Greenville treaty line; thence
with said line N. 78 E 400 poles
to a small cherry tree and two beeches; thence N. 12: E 400 poles to three
beeches; thence S 78 W 400 poles to a sugar tree and two beeches northeast
corner to entry No 9889, thence S, 12, E. 400 poles crossing a branch at 80
poles to the beginning.

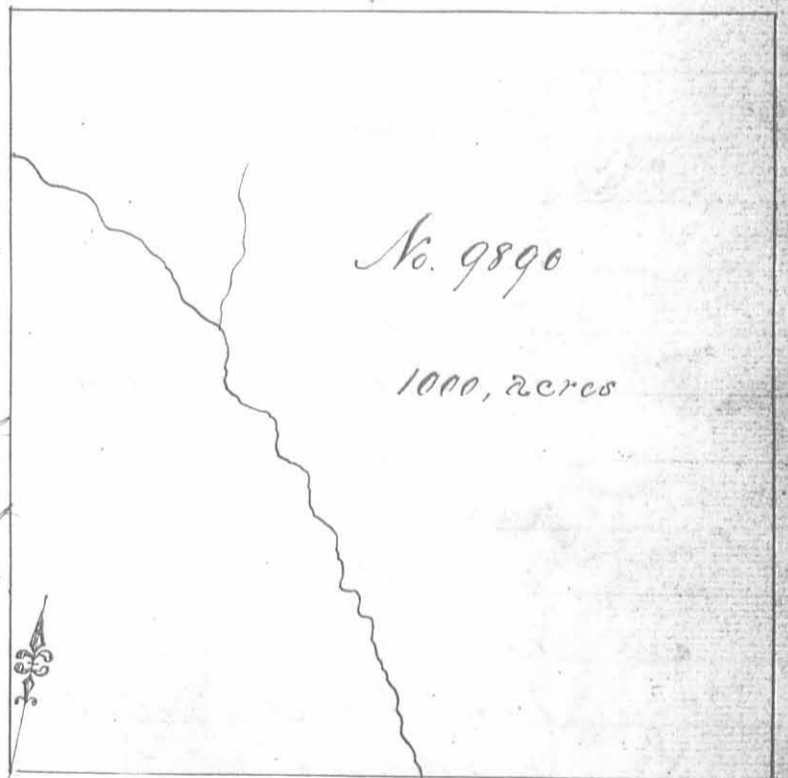

Levi D Sharp
Melkiah Rosebrog 3 C. 6.
Wilson L Thompson M. L. S.

Samuel Forrer D. S.
January 10th 1820
March 7th 1821

No. 9887. 208 1/2 acres

Surveyed for John Jameson 208 1/2
acres of land on part of a Military
Warrant No. 5437 on the waters of

Rush Creek; beginning beginning at two swamp ashes southeast cor-
ner to Bradford and others survey No 9886, thence with the Grenville tra-
ty line N 78 E 400 poles to an elm, blue ash and sugar tree; thence N
12 W 83 1/4 poles to two horn beams and three beeches; thence S. 78. W 400 poles
to an ash maple and elm in the line of Bradford and others said
survey, thence with said line S. 12 E. 83 1/4 poles to the beginning.

Levi D. Thurst

Hilkiah Rosebrog 3 C.C.

McDon S. Thompson M.S.R.

Samuel Forrer D.S.

January 3^d 1820March 8th 1821

Surveyed for Walter Dun apt^e and
John Carrion 1000 acres of land on
part of six Military warrants, Dun
500 acres, 222 acres on No 4937, 46
acres on No. 6098, 100 acres on No. 5999
100 acres on No. 6000, 32 acres on No
5998 and Carrion 500 acres on No 3221
on the waters of Scioto; beginning at
a Walnut and two small lymus south
east corner to William Paritts and
others entry No 10039, thence with
Paritts line N. 78. E 400 poles cross-
ing a branch at 11, Houlls road at

53 a branch at 86 one at 250 and a drain at 369 poles to three small
Buckeyes and an elm northeast corner to said survey and beginning cor-
ner to Dun and Keiths survey No 2820's acres; thence with their line
N 12 W. 400 poles crossing several drains to two beeches Northwest corner
thereof; thence S. 78. W. 400 poles crossing Houlls road at 100, a large
branch at 115 to 122 poles, a new road at 240 and a drain at 294 and
a branch at 365 poles to two lymus, two, sugar trees and an ash north-
east corner to Walkie's said survey; thence with his line S. 12. E. 400
poles crossing a branch at 20, one at 184, a drain at 294, a branch
at 315 at 326 and a drain at 393 poles to the beginning.

David C. Wingitt 3

Calvin Wingitt 3 C.C.

Simon Hoager M.S.R.

Thomas J. McArthur D.S.

January 15th 1821March 27th 1821

No. 9885

1000 acres

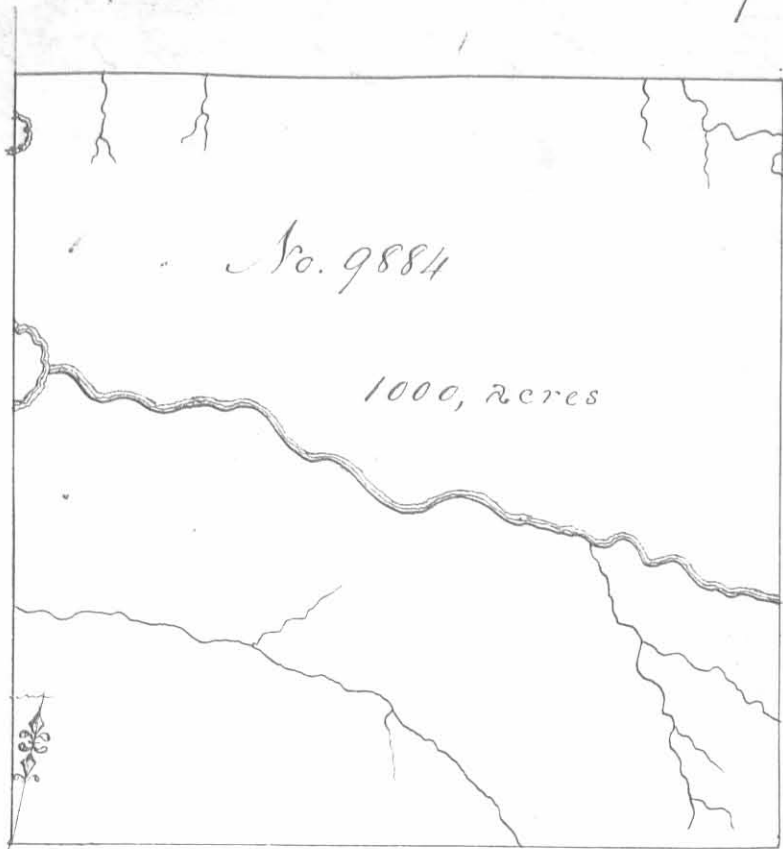

Surveyed for Joseph White 1000 acres of land on part of a Military Warrant No. 5805 on Cherokee mans run: Beginning at four Sugar trees southeast corner to Mark Hardins survey, No 9883 in the Greenville Treaty line; thence with Hardins line N. 12. W. 400 poles crossing a drain at 80 at 82 a large branch at 121, Cherokee mans run at 238, a branch at 272 one at 360 and one at 374 poles to a white oak and an ash stump northeast

corner to said survey; thence N. 77. 20' E 400 poles crossing a branch at 44 one at 100 one at 330 and one at 354 poles to a large red oak a large white oak and beech; thence S. 12. E. 400 poles crossing a drain at 28 at 36, Cherokee mans run at 314 a branch at 320 one at 328 and one at 372 poles to a beech, ironwood, blue ash and elm sapling in the Greenville Treaty line; thence with said line S 77 20' W 400 poles crossing a branch to the beginning.

George W Colloch ³/₃ C.C.
George Henry ³/₃ C.C.
Simon Hager m.k.r.

Thomas A. McArthur D.S.
January 10th 1821
March 28th 1821

Surveyed for the Representatives of Charles Porterfield 1000 acres of land on part of a Military warrant No 5455 on the waters of Mill Creek: Beginning at an elm blue ash and sugar tree in the Greenville Treaty line southeast corner of John Jamison and others survey No 9887 thence with said treaty line N. 78. E 400 poles to two beeches, thence N. 12 W. 400 poles crossing a branch at 190 and one at 318 poles to a sugar tree; thence S 78 W. 400 poles to two sugar trees and a beech northeast corner to said Jamison and others survey, thence with their line S 12 E. 400 poles to the beginning.

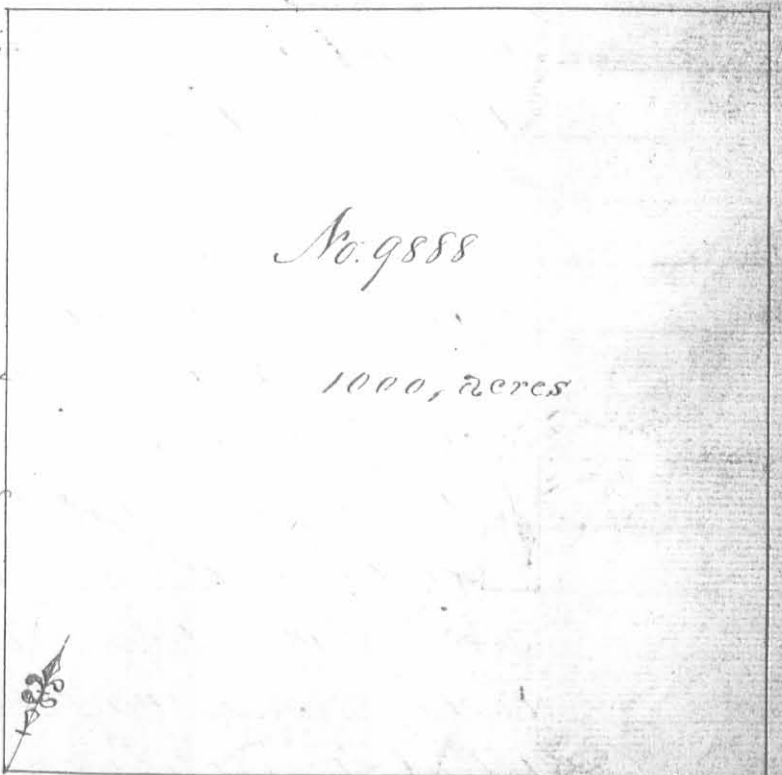

Sevi D Sharp ³/₃ C.C.
Kilkiak Rosebrag ³/₃ C.C.
Wilson S Thompson m.k.r.

Sam^l Forrer D.S.
June 3rd 1820

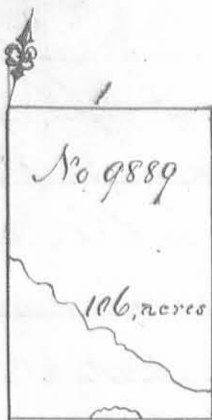

Surveyed for Robert Means and George Clark ap^{pr} 106 acres of land on part of two Military Warrants, Means 34 acres on No 4785 and Clark 72 acres on No 5513 on the waters of Meia Creek; beginning at two sugar trees N. 12. W. 400 poles from the southeast corner of Charles Porterfields survey No 9888. Thence N. 78 E. 105 poles to a lynn and beech; Thence S. 12 E. 102 poles to a lynn and beech; Thence S. 12 E 102 poles to a beech; Thence S 78 W. 105 poles crossing a large branch at 45 and at 60 poles to a stake; Thence N. 12. W. 102 poles crossing a large branch at 82 poles to the beginning.

Samuel Zane 3
Joseph Collins 3 C.C.
William Dapfänger M.k.r.

Thos S. McArthur D.S.
May 7th 1822
August 7th 1822

Surveyed for James Taylor & Francis Meier ap^{pr} 180 acres of land on part of two Military Warrants, Taylor 100 acres on No. 5447 & Meier 80 acres on No 1474 on the waters of Meia Creek; beginning at two beeches southeast corner to the representatives of Charles Porterfields survey No 9888. in the Greenville Treaty line, thence with said line N. 78. E. 160 poles crossing a branch several times to two beech and a sugar tree; Thence N. 12. W. 180 poles crossing a branch at 80 poles to two sugar trees & beech; Thence S 78 W. 160 poles crossing a branch a number of times to a beech & sugar tree in said Porterfields line; Thence with said line S. 12. E 180 poles crossing a branch to the beginning.

Kilkiak Rosbragh 3
Robert Rosbragh 3 C.C.
P. N. White M.k.r.

James Taylor D.S.
December 16. 1823
November 15. 1824

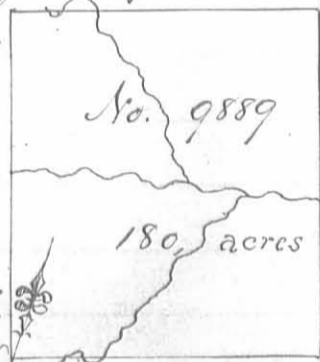

Surveyed for Allen Latham ap^{pr} 26 acres of land on part of a military warrant No 1476 on the waters of the Scioto river; beginning at two beeches North east corner of Smith Sneads survey No 10013; Thence N. 12. W. 136 poles crossing lick run at 92 poles to two beeches; Thence S. 78. W. 23 poles to two sugar trees on the south bank of a branch northeast corner to Myatts survey No. 10013; Thence with his line S 12 E 136 poles to a beech and two sugar trees southeast corner to Myatts said survey; Thence N. 78. E. 23 poles to the beginning.

Levi D. Sharp 3
Kilkiak Rosbragh 3 C.C.
Wilson L. Thompson M.k.r.

Samuel Ferrer D.S.
January 4th 1821
January 30th 1821

No. 10581
20, 24



Surveyed for Mark Hardin of
 1000 acres of land on part of a mili-
 tary warrant No 3526 on Cherokee
 mans run; beginning at two red
 oaks and a large white oak South
 east corner to Abraham Williams
 survey No 10306 in the Greenville
 treaty line, thence with said line
 N 78 E. 116 poles crossing a drain
 from 76 to 86 poles to two hickories
 an elm and large white oak thence
 with said line N 77° 20' E. 384
 poles crossing a drain at 154
 and one at 210 poles to four sugar trees southwest corner to Joseph
 Hites survey No. 9884, thence with his line N. 12 N. 400 poles cross-
 ing a drain at 80 one at 82, a large branch at 124 Cherokee
 mans run at 238 a small branch at 272 a drain at 284
 and a small branch from 360 to 374 poles to a white oak and
 ash stump; thence S. 77° 20' N. 400 poles crossing a branch at
 20 one at 80 one at 134 and one at 322 poles to five beeches
 northeast corner to McArthur and Hites survey No 10307; thence
 with their line and the line of Williams said survey S. 12. N. 400
 poles crossing a small branch at 168; Cherokee mans run at
 196 and a drain at 336 poles to the beginning.

George Henry 3
 James Henry 3 C.O.
 Simon Hager M.k.r.

Thomas S. McArthur D.S.
 January 9th 1821
 March 28th 1821

Surveyed for Nathaniel Pondlet on
 472 acres of land on part of a military
 warrant No. 5491 on Rush Creek: begin-
 ning at a blue ash and beech south
 east corner to Chiswell Barnetts survey
 No. 9908 and Northwest corner to Hite
 and others survey No 9887, thence with their line N 78 E. 400 poles crossing
 rush creek at 115 poles to a beech and two sugar trees northeast corner
 to said survey; thence N. 12 N. 189 poles to a sugar tree and two beeches
 thence S 75 N. 400 poles crossing at 76 and the creek at 110 poles to two
 white oaks and a hickory a short distance west of a maple stump; thence
 S. 12. E. 189 poles to the beginning.

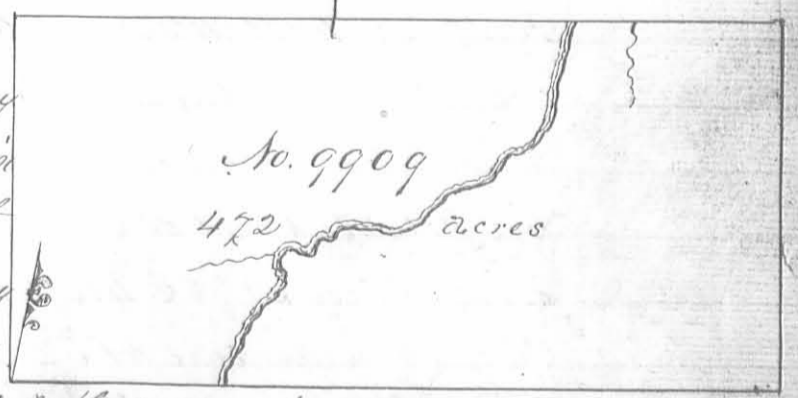

Levi D. Sharp 3
 Hilckiah Ronbrag 3 C.O.
 Wilson S. Thompson M.k.r.

Samuel Torner D.S.
 January 14th 1820
 March 13th 1821

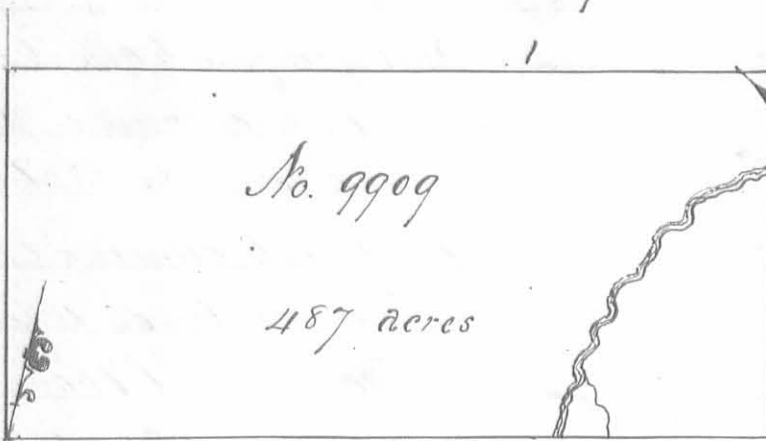

Surveyed for Nathaniel Pendleton
and James Taylor by Matthew
Gregg and the Representatives of
Whitehead Coleman 487 acres of land
on part of three military warrants:
Pendleton and Taylor 472 acres on
No 5491, Gregg 8 acres on No 4959

and Coleman 7 acres on No. 4922 on Rush Creek; beginning at two white
oaks and a hickory Northwest corner to said Pendleton survey No 9909
in a line of Cherokee Barritt's survey No 9908, thence with Pendleton
line N 78 E. 400 poles crossing Rush Creek at 290 and a branch at 324
poles to a sugar tree and two beeches northeast corner to said Pendleton
survey; thence N. 12. W. 194 poles crossing the creek at 134 poles to a buck-
eye and small sugar tree; thence S. 78 W. 400 poles crossing a branch
at 240 and one at 312 poles to a red oak elm and sugar tree north
east corner to said Barritt's survey; thence with his line S. 12. E. 194 poles
to the beginning.

Levi D. Sharp

Hilkiak Rosstrag & Co.

Wilson S. Thompson M.R.

Samuel Ferrer D.S.

January 11th 1820

March 13th 1821

Surveyed for the Representatives of Mi-
chael Rudolph 1000 acres of land on
part of a military warrant No 6310
on Cherokee mans run; beginning at a
black oak and small elm northwest
corner to Hubbard Myers survey No. 9881
and Northeast corner to Sun and Bayles
survey No 10122, 10248 and 10249, thence
with the line of their survey S. 78 W. 400
poles to two hickories; thence N. 12. W.
400 poles to two ashes and two hick-
ories; thence N 78 E 400 poles crossing
Cherokee mans run at 342 poles to a
black oak, red oak, hickory and elm northeast corner to William St. Reid
and others entry No. 9903; thence with his line S. 12. E. 400 poles, crossing
Cherokee mans run to the beginning.

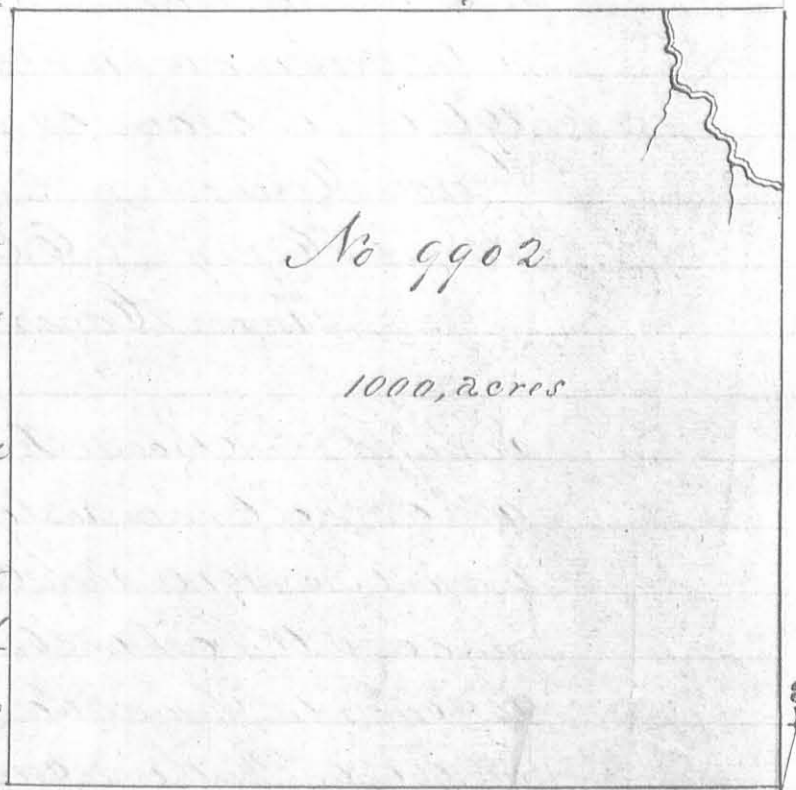

George Henry

James Henry & Co.

Benjamin McColloch M.R.

Thomas S. McArthur D.S.

January 15th 1821

March 30th 1821