

PROPOSED ANNEXATION TO THE VILLAGE OF DEGRAFF  
March 27, 1992

The following proposed corporation extension for the Village of DeGraff situated in the State of Ohio, County of Logan, Township of Pleasant, being part of Section 7, Town 2, Range 14, B.M.R.S. and more particularly described as follows:

Beginning at an angle in the existing corporation line that is in the west line of the Greenwood Cemetery that is N. 00°18'50" W. 280.50 feet from the intersection of the west line of said Cemetery with the north line of Pleasant Street.

Thence with said existing corporation line S. 88° 01' 12" W. 716.20 feet to a point in the west line of the Village of DeGraff's 4.95 acre tract as described in D. B. Vol. 353 Page 973.

Thence with said west line and the east line of David A. Reames' 20.508 acre tract as described in O. R. Vol. 116 Page 610 N. 00° 04' 30" W. 1373.28 feet to a 5/8 inch iron bar set at the northwest corner of the Village of DeGraff's 22.029 acre tract as described in O. R. Vol. 105 Page 219.

Thence with the north line of said 22.029 acre tract and the south line of Nevin Hirschfeld's 40.66 acre tract as described in O. R. Vol. 10 page 238 N. 89° 35' 39" E. 717.10 feet to a concrete corner post found at the northwest corner of the Greenwood Cemetery's 18.5 acre tract as described in D. B. Vol. 123 Page 385, said point being in the present corporation line.

Thence with said Cemetery's west line and the existing corporation line S. 00° 39' 49" W. 405.81 feet to a 5/8 inch iron bar set.

Thence with said Cemetery's west line and the existing corporation line S. 00° 18' 50" E. 947.84 feet to the place of beginning. Containing 22.350 acres more or less.

The above described 22.350 acre tract being all of the Village of DeGraff's 22.029 acre tract as described in O. R. Vol. 105 Page 219 and 0.321 acre from the Village of DeGraff's 4.95 acre tract as described in D. B. Vol. 353 Page 973.

Reference is hereby made to a plat of this survey on file with the Logan County Engineer.

Bearings are based on the west line of Greenwood Cemetery (S. 00° 18' 50" E.) in this field survey.

ANNEXATION MAP  
LOCATED IN SECTION 7, TOWN 2, RANGE 14,  
B.M.R.S., PLEASANT TOWNSHIP, LOGAN  
COUNTY, OHIO.  
22.350 AC.

VILLAGE OF DEGRAFF  
MAYOR \_\_\_\_\_ DATE 6-2-92  
COUNCIL PRESIDENT \_\_\_\_\_ DATE 6-2-92

ORDINANCE NO. 92-12

PLEASANT TOWNSHIP TRUSTEES \_\_\_\_\_ DATE \_\_\_\_\_

DEGRAFF PLANNING COMMISSION  
DATE \_\_\_\_\_

PLAT PEE-APPROVAL  
DATE 5-26-92

LOGAN COUNTY TAX MAP  
DEPARTMENT APPROVED  
DATE 6-26-92

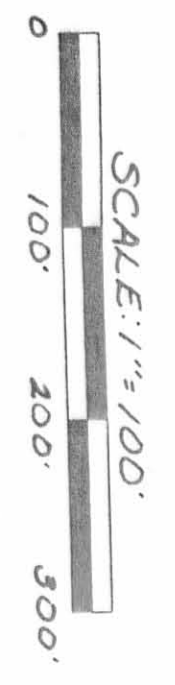
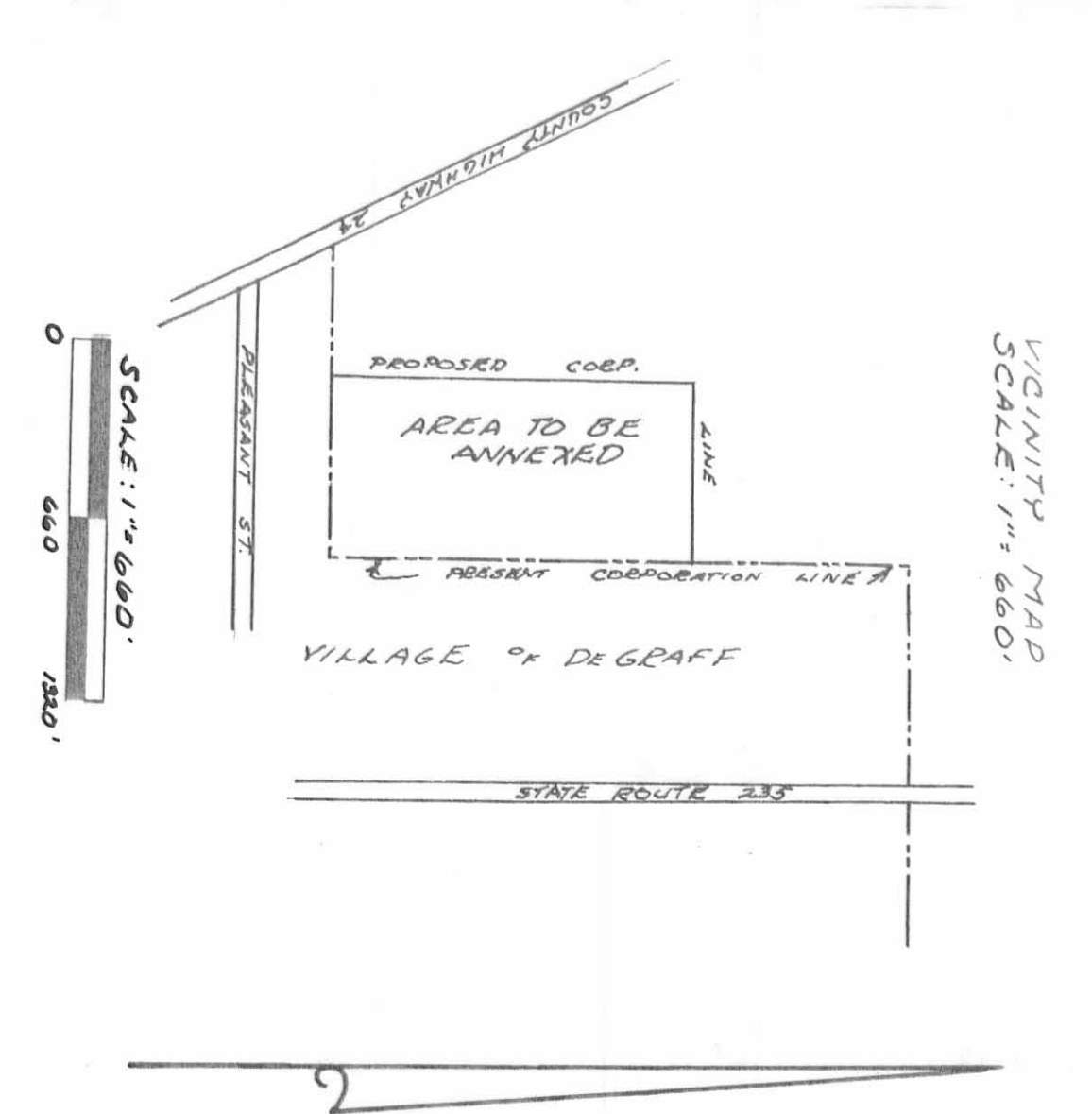

LOGAN COUNTY COMMISSIONERS  
APPROVED \_\_\_\_\_ DATE 3-2-93  
APPROVED \_\_\_\_\_ DATE 3-2-93  
APPROVED \_\_\_\_\_ DATE 3-2-93

L.U.C. REGIONAL PLANNING  
COMMISSION \_\_\_\_\_ DATE 6-19-93  
LOGAN COUNTY ENGINEER  
APPROVED \_\_\_\_\_ DATE 10-30-93

TRANSFERRED THIS 26TH DAY OF OCTOBER, 1993.  
9308137  
RECORDED IN PLAT CABINET A  
SLIDE 773B, RECEIVED FOR RECORD  
AT 4:03 O'CLOCK P.M. THIS DAY  
OF October 26, 1993.

LOGAN COUNTY TAX MAP  
DEPARTMENT APPROVED  
DATE 6-26-92

I HEREBY CERTIFY THAT THE  
ACCOMPANYING PLAT IS AN  
ACCURATE REPRESENTATION  
OF A 22.029 ACRE TRACT  
AS SURVEYED BY ME IN  
MAY, 1991 TOGETHER WITH  
0.321 ACRE AS RESEARCHED  
FROM AVAILABLE RECORDED  
DEEDS, MAPS AND OTHER  
RECORDS OBTAINED IN FILE  
IN THE LOGAN COUNTY  
RECORDS.



LESLIE H. GESLIN  
RUSHSPLELVANIA, OHIO  
PH. 513-468-2793