

Kamp A-Lott

SECTION No 3

SECTION No 3 CONTINUED



SECTION No 1

KAMP - A - LOTT

KAMP - A - LOTT SECTION No 3

143.71' S 69°30'24"E
 109.92' S 21°44'55"W
 980.18' - S 70°17'10"E
 229.44' - N 88°59'15"E
 600.97' - N 64°04'04"E
 169.67' - N 47°56'49"E

TO THE CORNER OF THE ROAD & A SOUTHEAST CORNER OF THE TRACT CONVEYED BY DEED OF RECORD IN DEED BOOK 341 PAGE 286, RECORDER'S OFFICE, LOGAN COUNTY, OHIO

Professional Seal of
 Logan County Engineer
 No. 266 3-30-73

SITUATE IN THE STATE OF OHIO, COUNTY OF LOGAN, TOWNSHIP OF JEFFERSON, IN VIRGINIA MILITARY SURVEY 3139 AND BEING A PART OF THE TRACT OF LAND CONVEYED TO C.S. & B. PARTNERSHIP AND R.C.D. INC. BY DEED OF RECORD IN DEED BOOK 341, PAGE 286, RECORDERS OFFICE, LOGAN COUNTY, OHIO.

KNOW ALL MEN BY THESE PRESENTS THAT C.S. & B. PARTNERSHIP BY ROY L. BENSON, DORIS E. BENSON, PARTNERS AND BY C.S.L. SERVICE CORPORATION PARTNER, BY ITS PRESIDENT, EARLE E. HAMMOND AND ITS SECRETARY, RICHARD A. PORTER, HAVING BEEN DULY AUTHORIZED, AND R.C.D. INC. BY ITS PRESIDENT, JOHN EDWARDS AND ITS SECRETARY, PAULA POWERS, HAVING BEEN DULY AUTHORIZED, BEING PROPRIETORS OF THE LAND INDICATED ON THE ACCOMPANYING PLAT HAVE AUTHORIZED THE PLATTING THEREOF AND DO HEREBY DEDICATE THE DRIVES, LANES AND RESERVE TO PRIVATE USE FOREVER.

Quincy M. Jensen
 Roy L. Benson
 Doris E. Benson
 Earle E. Hammond
 Richard A. Porter

John Edmond
 John Edmond - PRESIDENT R.C.D. INC.
Paula Powers
 Paula Powers - SECRETARY R.C.D. INC.

STATE OF OHIO
 COUNTY OF HANCOCK

BEFORE ME A NOTARY PUBLIC IN AND FOR SAID COUNTY PERSONALLY CAME ROY L. BENSON, DORIS E. BENSON, EARLE E. HAMMOND, PRESIDENT OF C.S.L. SERVICE CORPORATION AND RICHARD A. PORTER, SECRETARY OF C.S.L. SERVICE CORPORATION WHO ACKNOWLEDGED THE SIGNING OF THE FOREGOING INSTRUMENT TO BE THEIR VOLUNTARY ACT AND DEED FOR THE USES AND PURPOSES THEREIN EXPRESSED.

IN WITNESS WHEREOF, I HAVE HERETO SET MY HAND AND AFFIXED MY OFFICIAL SEAL THIS 14TH DAY OF FEBRUARY 1973

BY William W. Higgins
 NOTARY PUBLIC

STATE OF OHIO
 COUNTY OF

BEFORE ME A NOTARY PUBLIC IN AND FOR SAID COUNTY PERSONALLY CAME JOHN EDWARDS, PRESIDENT OF R.C.D. INC. AND PAULA POWERS, SECRETARY OF R.C.D. INC. WHO ACKNOWLEDGED THE SIGNING OF THE FOREGOING INSTRUMENT TO BE THEIR VOLUNTARY ACT AND DEED FOR THE USES AND PURPOSES THEREIN EXPRESSED.

IN WITNESS WHEREOF, I HAVE HERETO SET MY HAND AND AFFIXED MY OFFICIAL SEAL THIS 21 DAY OF FEB. 19 73

BY Jerry M. Bensen
 Notary Public Logan County, Ohio
 My Commission Expires Feb. 22, 1976

REVIEWED THIS 26 DAY OF February 1973 Walter Howe
 CHAIRMAN, TOWNSHIP TRUSTEES

APPROVED THIS 26TH DAY OF February 1973 Charles R. Wolf, P.E.
 LOGAN COUNTY ENGINEER

APPROVED THIS 28TH DAY OF February 1973 W. A. Vestalby, D.V.M.
 LOGAN COUNTY HEALTH DEPT.

APPROVED THIS 23 DAY OF February 1973 Lawrence L. Scott
 LOGAN COUNTY AUDITOR

TRANSFERRED THIS 30TH DAY OF MARCH 1973 Mary E. Stearn

212523 FILED FOR RECORD THIS 30TH DAY OF MARCH 1973 AT 11:05 A

RECORDED THIS 30TH DAY OF MARCH 1973 IN PLAT BOOK 6 F PAGE 62

Ruth Rayner
 LOGAN COUNTY RECORDER

SURVEYORS CERTIFICATE
 THE ACCOMPANYING PLAT REPRESENTS A SUBDIVISION OF LAND IN VIRGINIA MILITARY SURVEY No 3139, JEFFERSON TOWNSHIP, LOGAN COUNTY, OHIO.
 THE TRACT HAS AN AREA OF 3485 ACRES IN STREETS, 1804 ACRES IN RESERVES AND 13,905 ACRES IN LOTS MAKING A TOTAL OF 19,192 ACRES.
 ALL MEASUREMENTS ARE IN FOOT AND DECIMALS OF A FOOT. ALL MEASUREMENTS ON CURVES ARE (CHORD) DISTANCES.

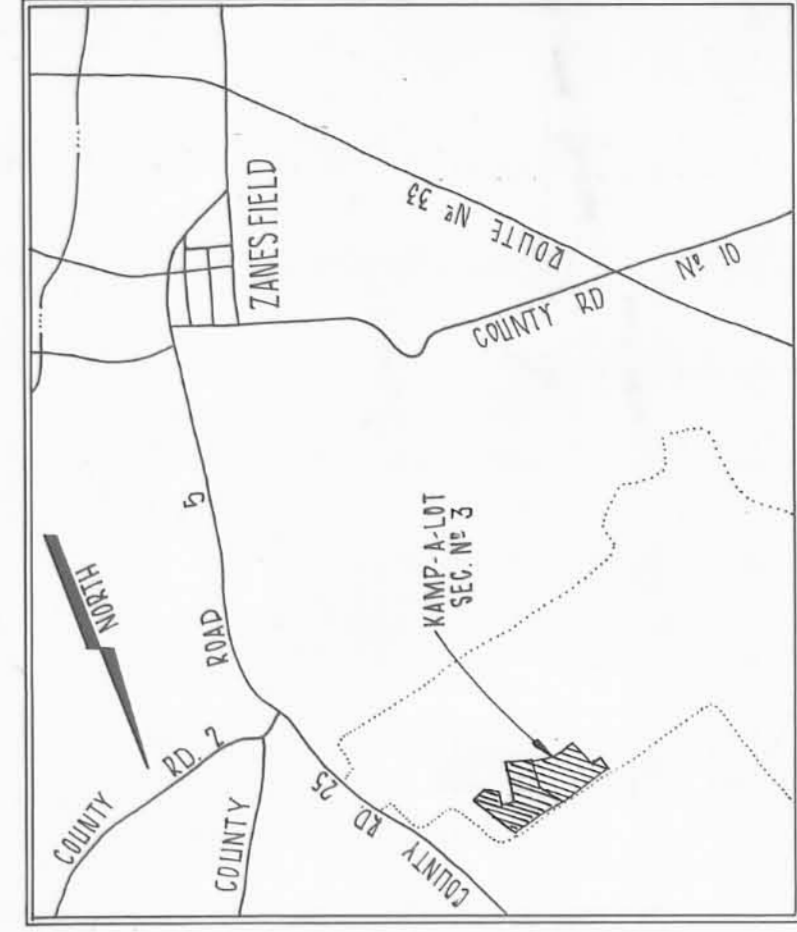

I HEREBY CERTIFY THAT THE ACCOMPANYING PLAT IS A CORRECT REPRESENTATION OF KAMP-A LOTT SECTION No 3

THE THOMAS ENGINEERING & SURVEYING CO.
 3805 SULLIVANT AVE
 COLUMBUS, OHIO
 ORDER NO. 55672
 SCALE: 1"=50'

Robert G. Webb
 REGISTERED SURVEYOR